

Revitalizing Toronto's Waterfront, Redefining Our Future



**West Don Lands Public Update Meeting
May 29, 2012**



Central Waterfront: Queens Quay Revitalization



East Bayfront Update



East Bayfront: George Brown College Waterfront Campus



East Bayfront: Monde development



East Bayfront: Bayside development

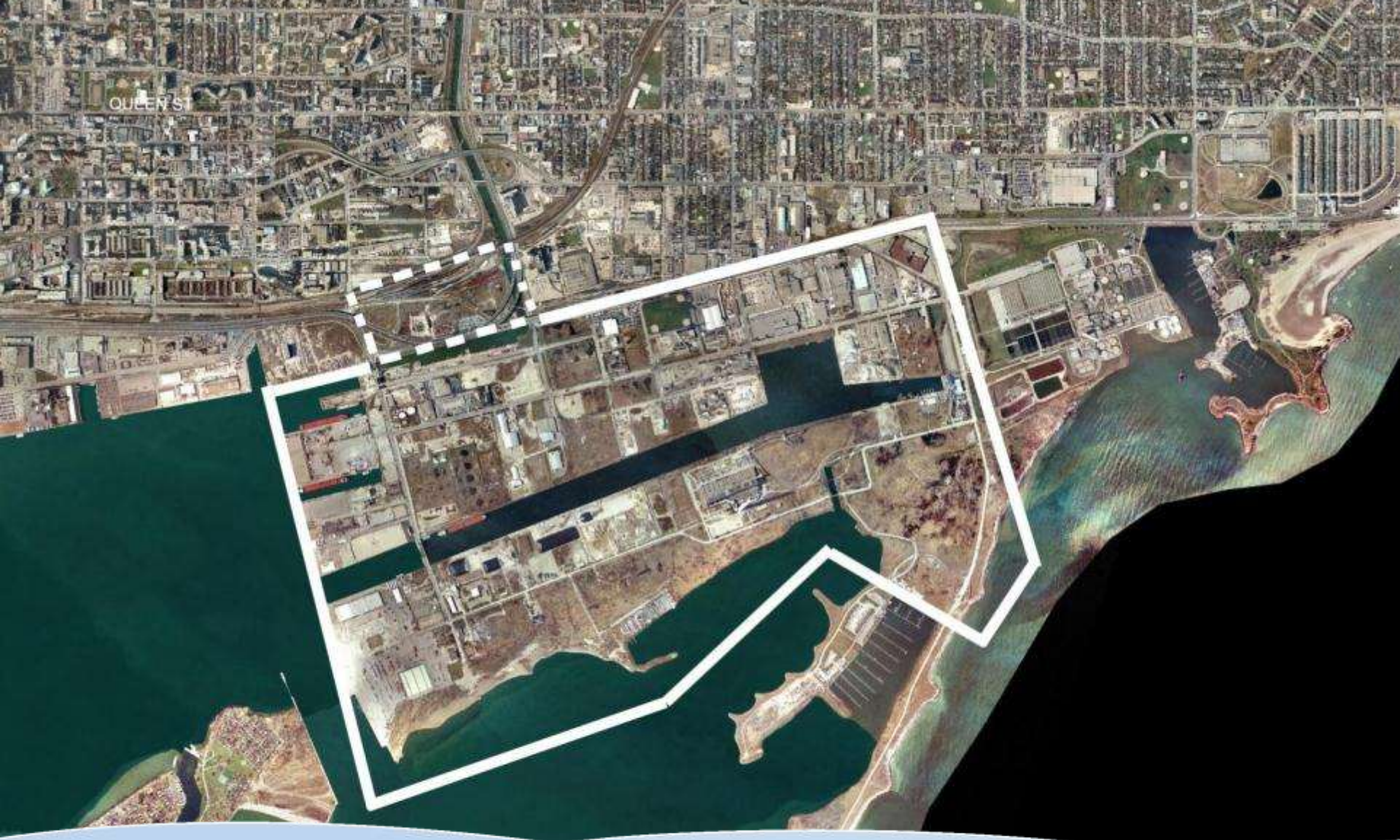

Port Lands Acceleration Initiative: www.portlandsconsultation.ca



Union Subway Station second platform



Union Subway Station second platform



Waterfront Toronto Employment Initiative



West Don Lands Overview



West Don Lands Construction: Cherry and Front streets



West Don Lands Construction: Eastern Ave.



Stormwater treatment and conveyance system



Toronto Community Housing development



TCHC construction



River City construction



Pan Am Athletes' Village/Canary District



Pan Am Athletes' Village/Canary District construction



Underpass Park



Don River Park

Flood Protection Landform Update

Jesse Zuker, Infrastructure Ontario

Flood Protection Landform (FPL) update

- Construction on the FPL began in 2007, unlocking the development potential of the West Don Lands and providing protection to 518 acres of the downtown east from flooding during a significant storm event.



Flood Protection Landform (FPL) update

- As work on the FPL progressed, opportunities arose to improve aging infrastructure in the vicinity, including the hundred year-old sanitary sewer running underneath the FPL, high-voltage overhead hydro lines and a major gas main.
- Over the summer months, crews will be working on an “armour wall” on the river or wet side of the FPL to provide additional protection against erosion.



Central
Bayview Ave.
Armouring

Flood Protection Landform (FPL) update

- Work on the FPL will be complete in fall 2012.



Sheet Piling for 1650 Back Flow Preventer under Queen Street Bridge



Permanent Closure of Bayview - River connector road for FLP construction

Parks Update

James Roche, Waterfront Toronto



Don River Park



Don River Park

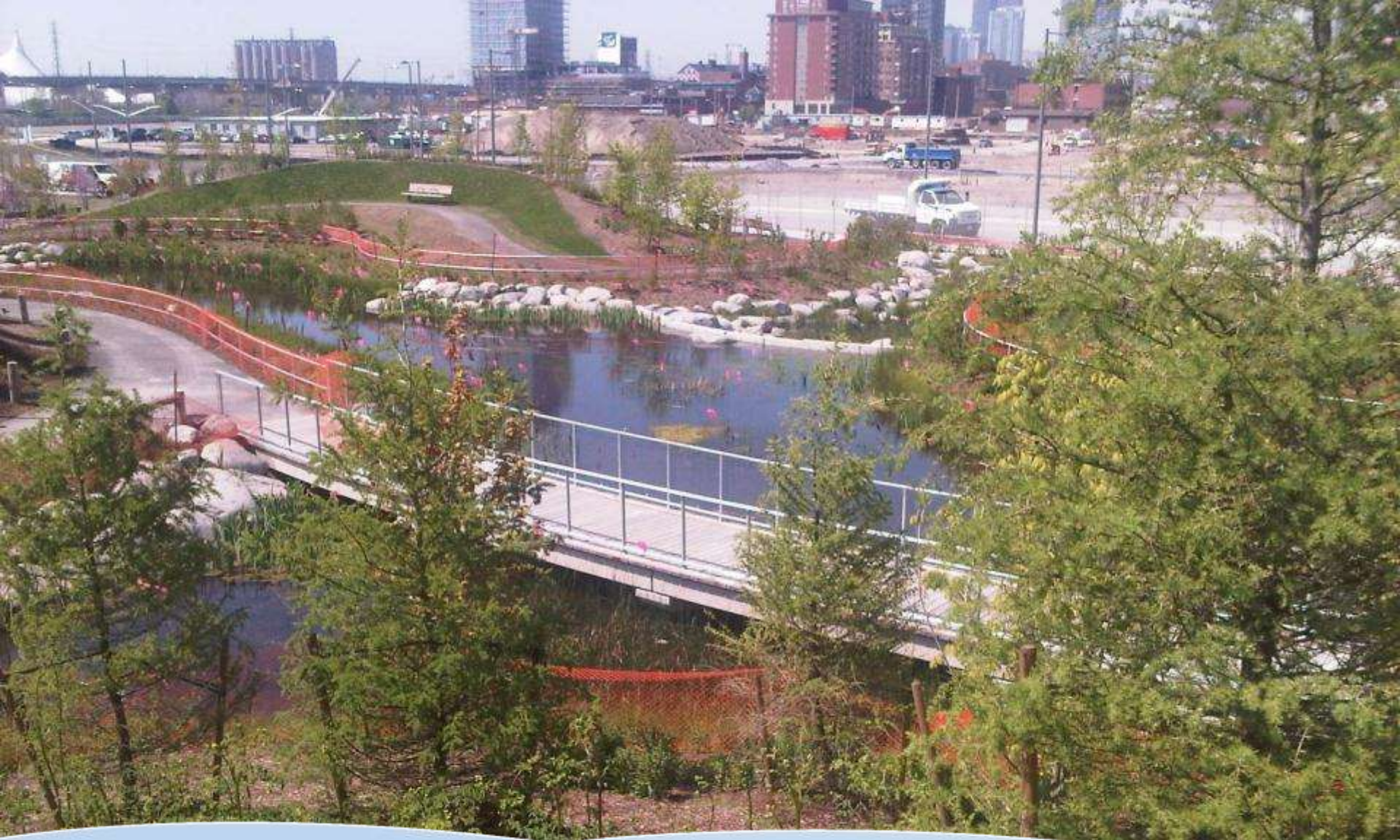

Marsh



Pavilion- Splashpad



Pavilion- Slides- Play area



Pavilion- Multi-use field



Wet side- urban prairie – “Under construction”



Public Art- "No Shoes" – Mark Di Suvero

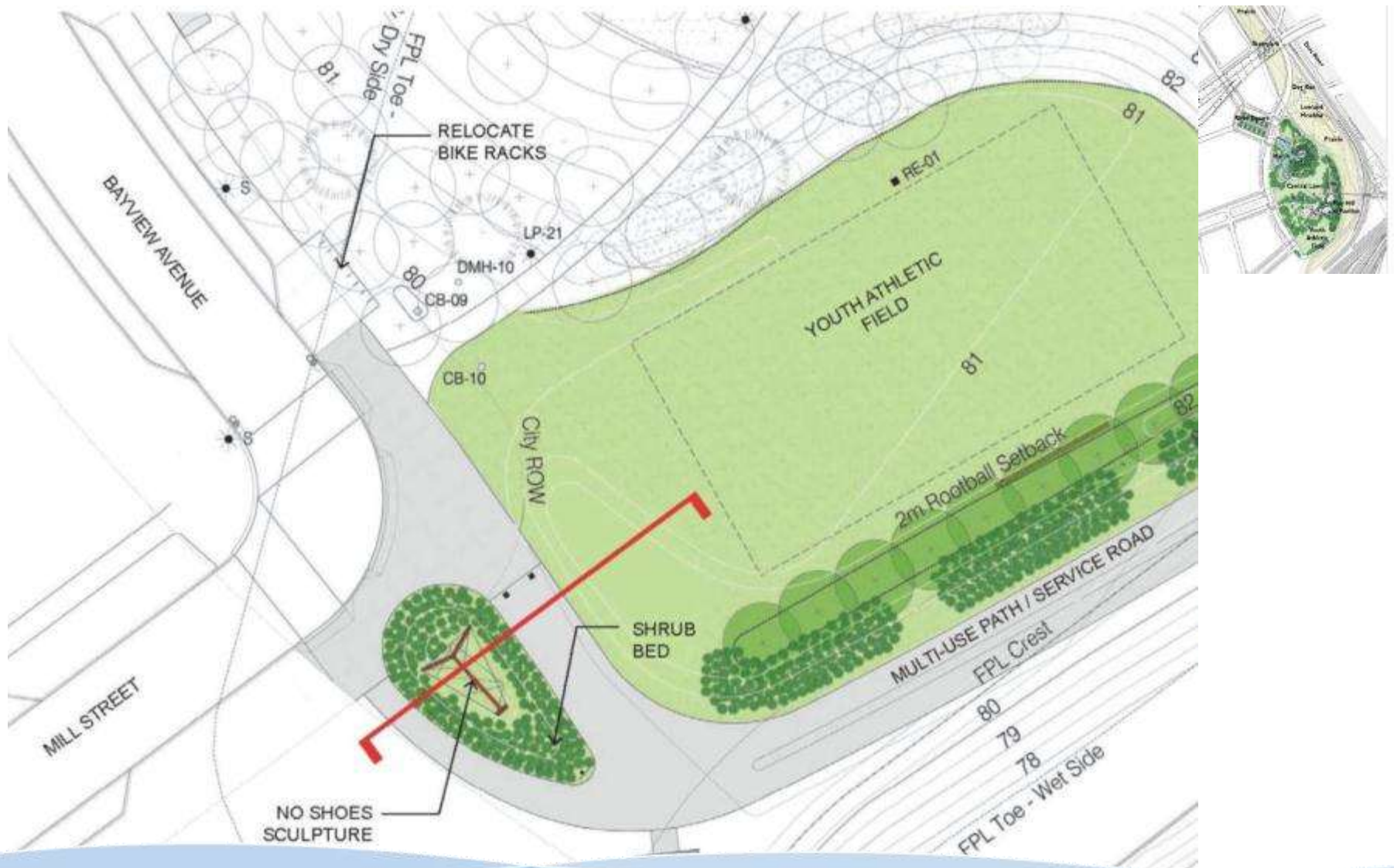

Public Art- “No Shoes” – Mark Di Suvero

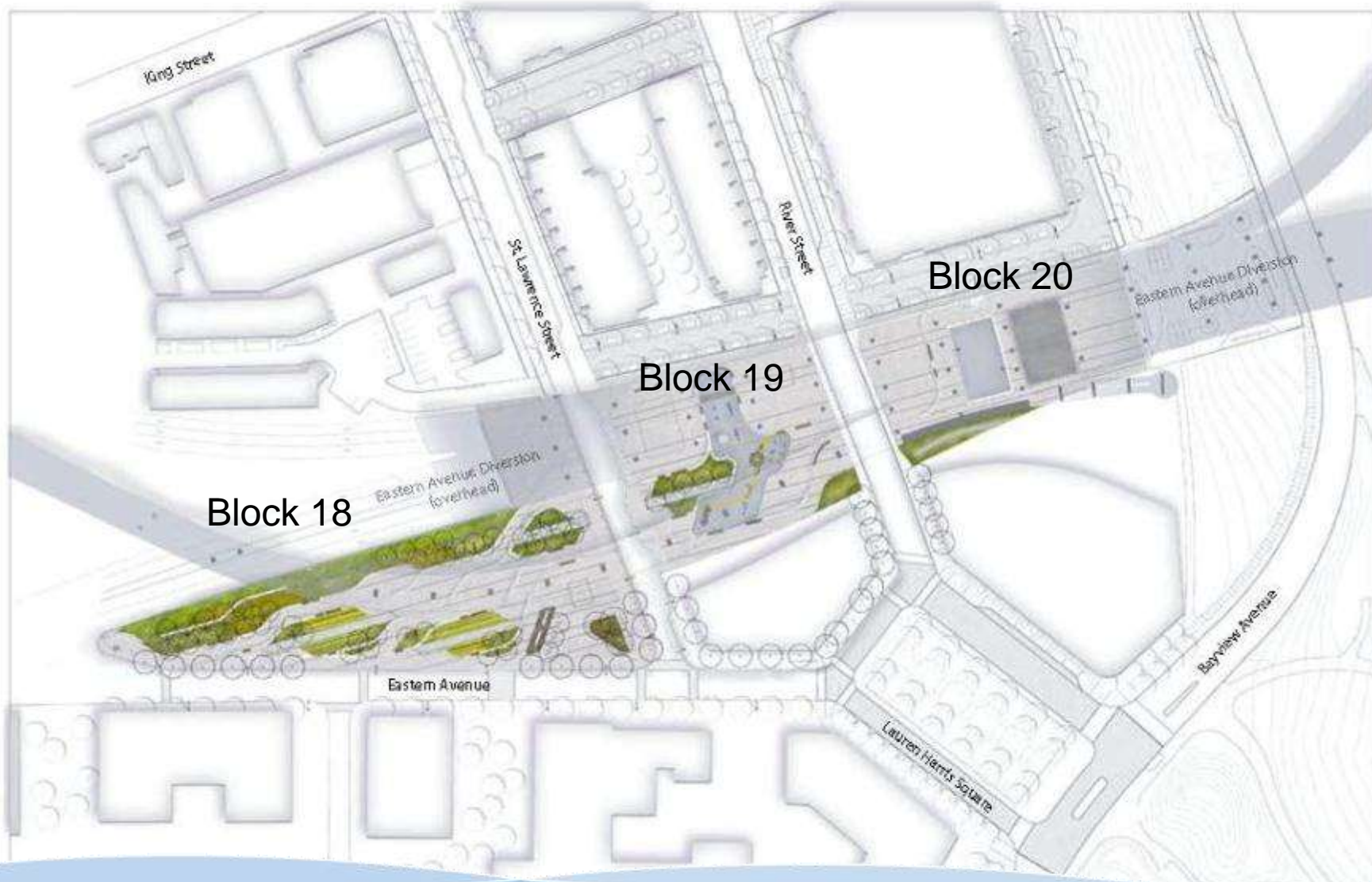

Under Pass Park



Block 20- Basketball courts



Block 20- Skateboard park



Block 19- Playground



Block 19- Playground



UPP-Lighting



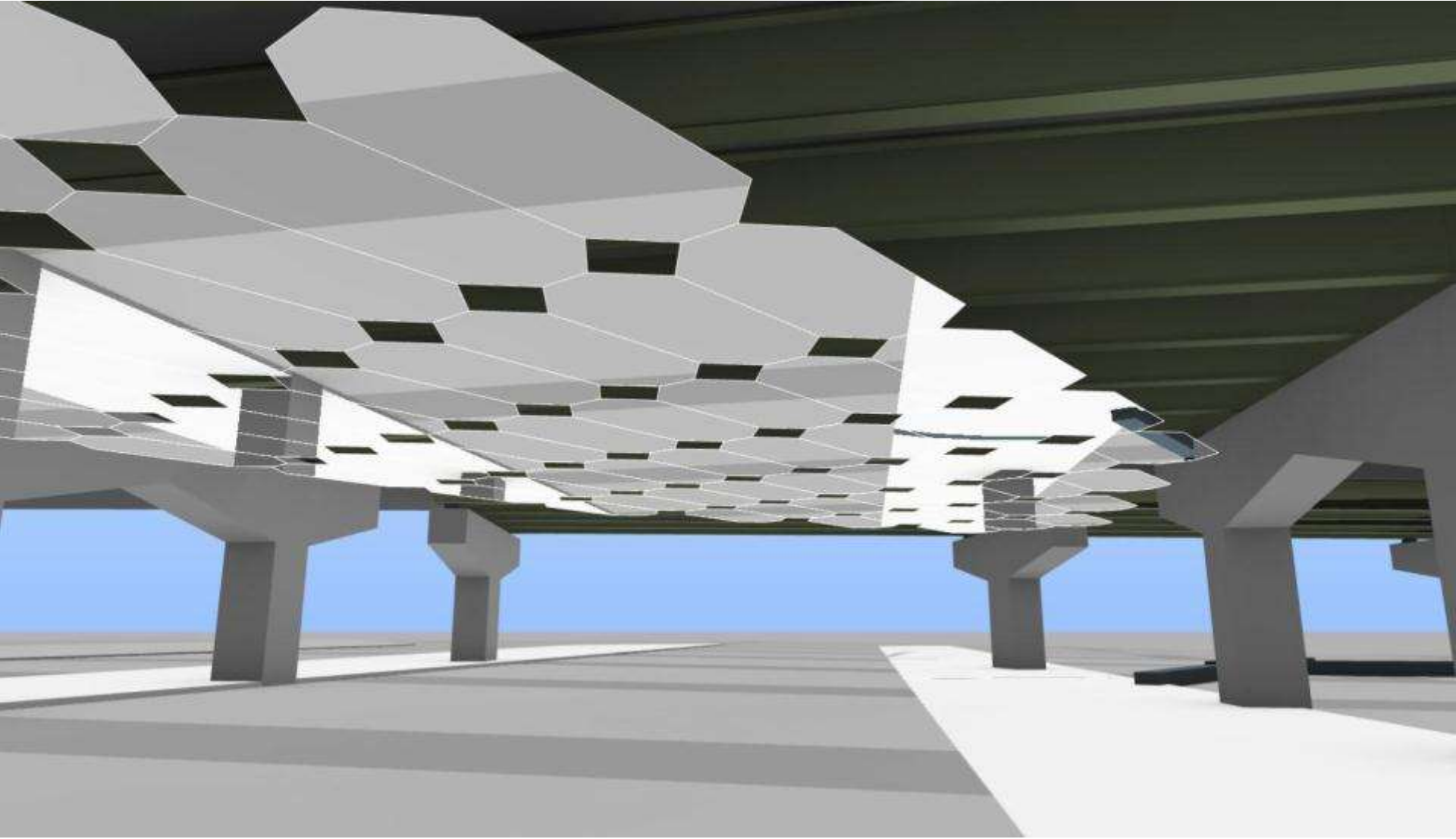

UPP- Public Art- “Mirage” – Paul Raff Studio

River City Update

Jeff Geldart, Urban Capital

river city



 URBAN CAPITAL

PHASE 1

PHASE 2

THE RAMPS

PHASE 3

PHASE 4

RIVER CITY MASTER PLAN

Phase 3

Phase 1

Phase 2



SITE PLAN INCLUDING WEST DON LANDS



PHASE 1

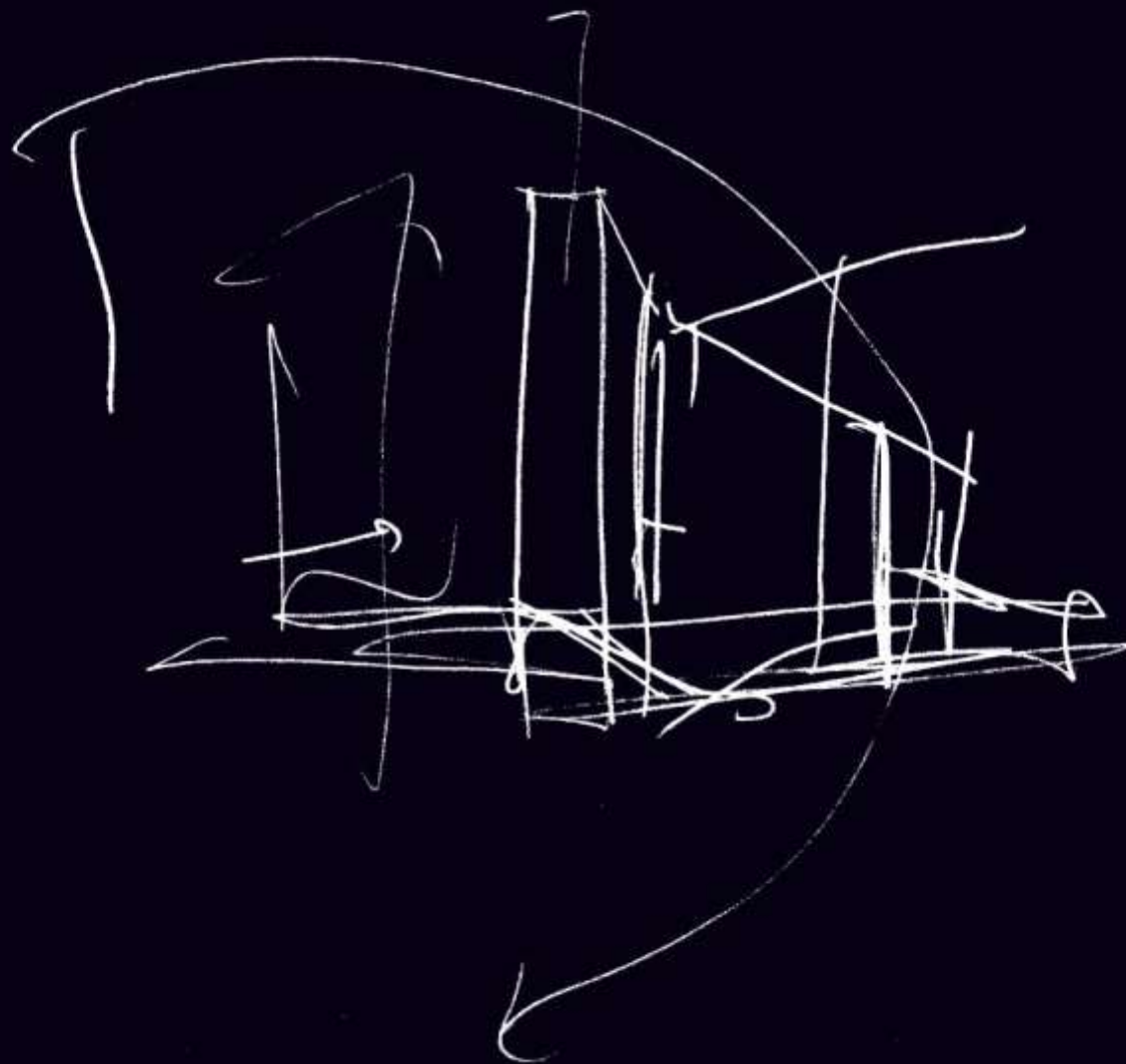

STATUS REPORT: RIVER CITY PHASE ONE, BLOCK 3 AND 4

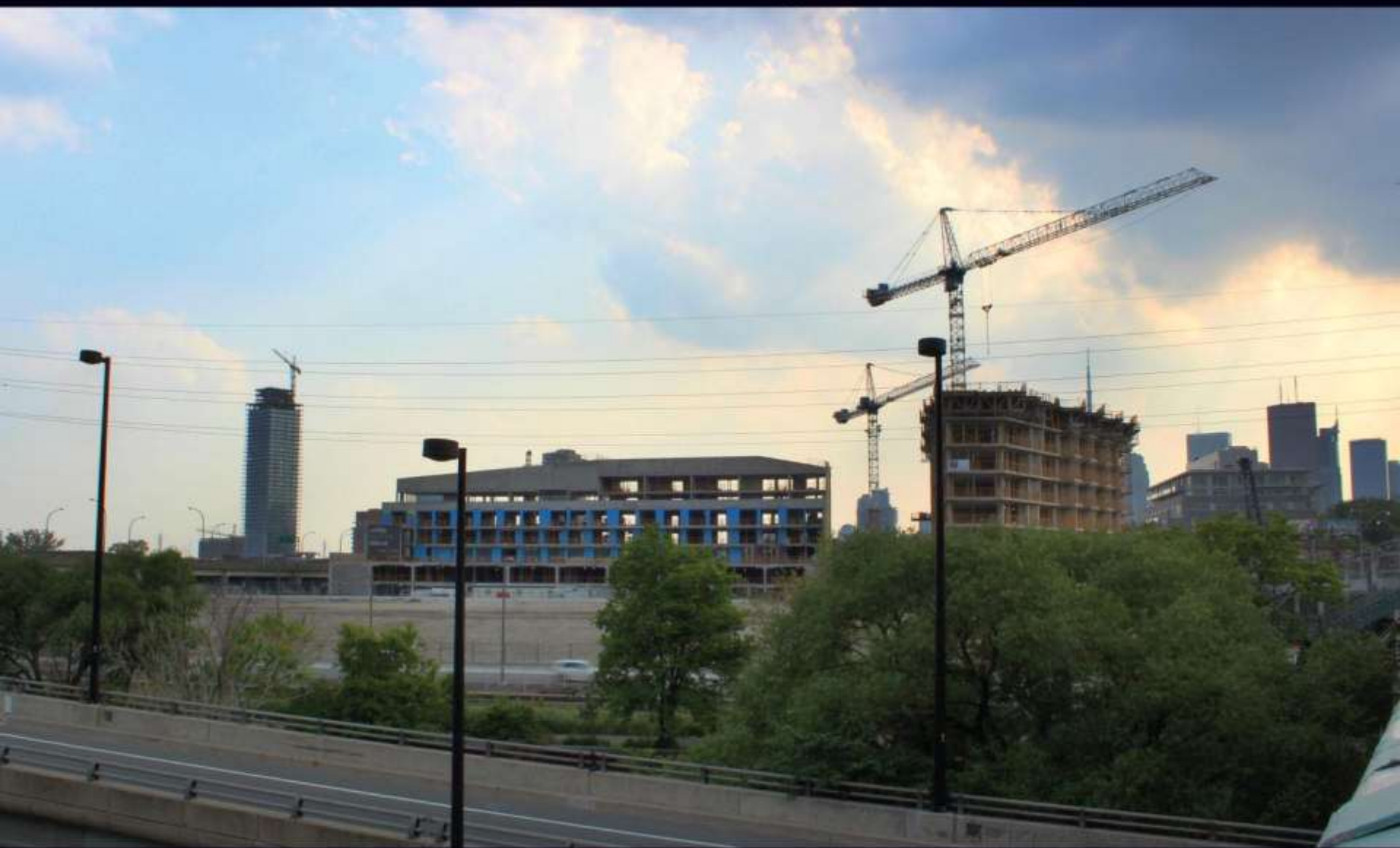

PEDESTRIAN
BRIDGE AND
LOBBY OF
BLOCK 4



STATUS REPORT



STATUS REPORT



STATUS REPORT: RETAIL SPACE FOR PHASE ONE



STATUS REPORT: AMENITY SPACE PHASE ONE



STATUS REPORT: VIEW ALONG RIVER STREET



PHASE 2

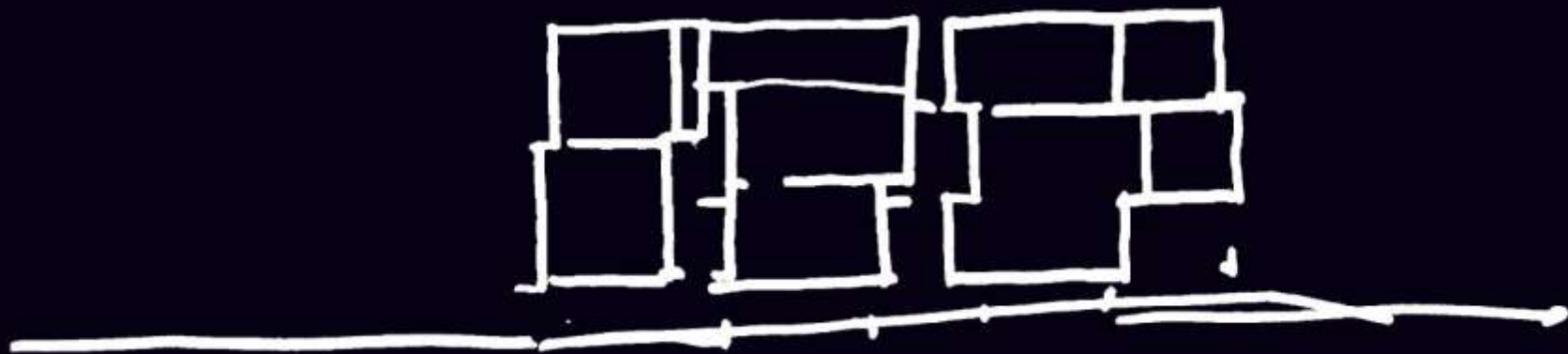

THE JEWEL OF RIVER CITY



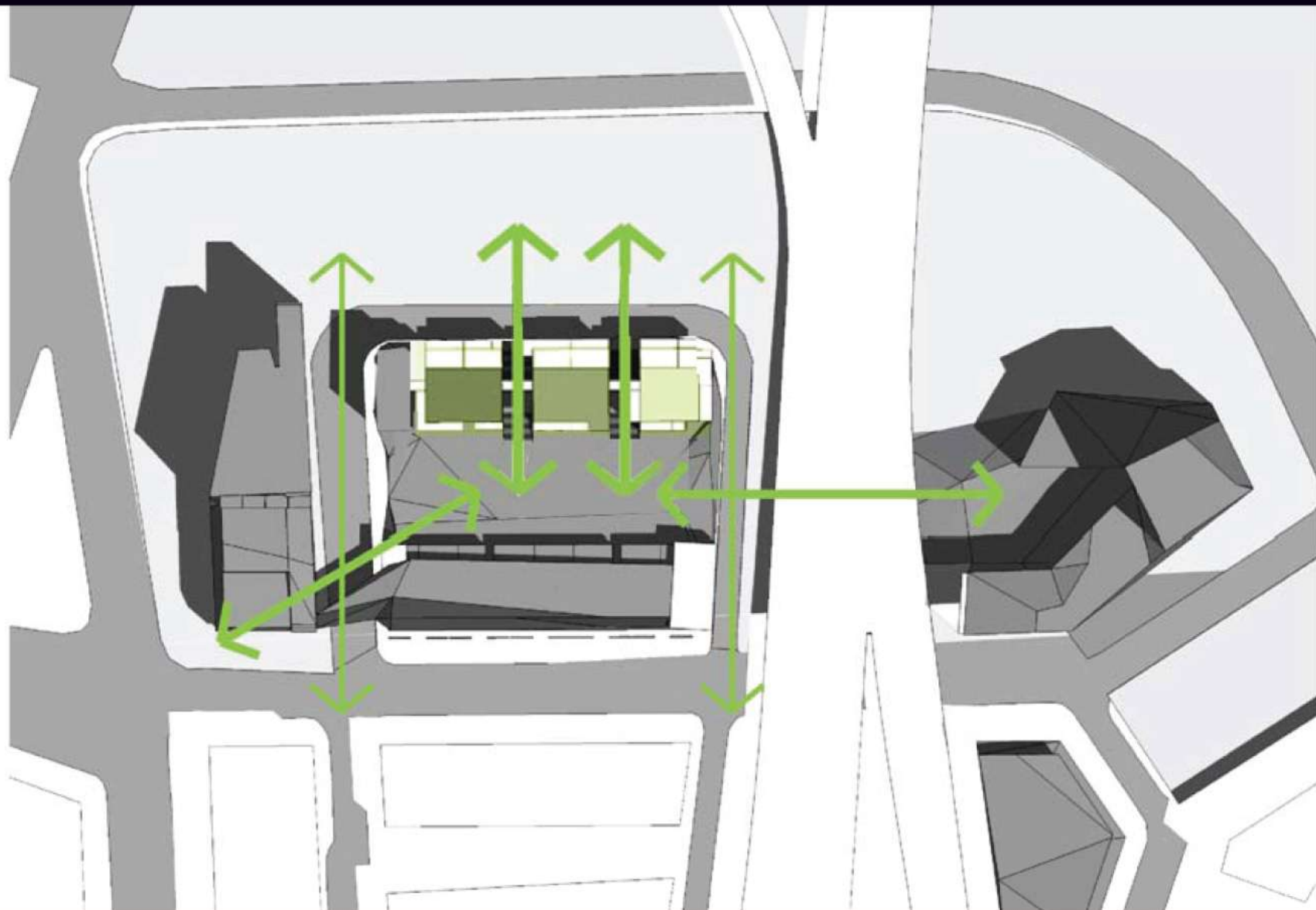

ENTRY TO LOBBY AND LOFTHOUSES

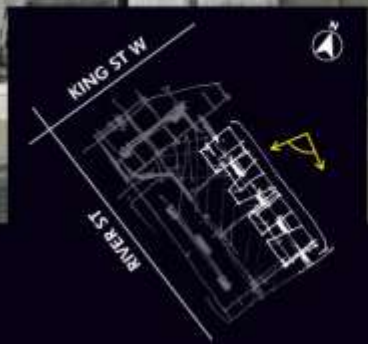

SECLUDED LOFTHOUSES ALONG WOONERF



WEST VIEW
REVEALING
EXTERIOR
AMENITIES



SHARED AMENITY SPACE INCLUDING POOL



TWO-STOREY LOFT PENTHOUSE







PAN AM Athletes' Village Overview



Renee Gomes, Waterfront Toronto

West Don Lands Development



West Don Lands Development



Legend

-  River City (Urban Capital)
-  Toronto Community Housing



West Don Lands Development





Legend

-  River City (Urban Capital)
-  Toronto Community Housing



West Don Lands Development



Legend

-  River City (Urban Capital)
-  Toronto Community Housing
-  Permanent buildings temporarily used for Athletes' Village
-  Future Dundee Kilmer development (temporary use of land for Athletes' Village)
-  Future West Don Lands development (temporary use of land for Athletes' Village)



West Don Lands Development





Legend

-  River City (Urban Capital)
-  Toronto Community Housing
-  Permanent buildings temporarily used for Athletes' Village



West Don Lands Development

Legend

-  River City (Urban Capital)
-  Toronto Community Housing
-  Permanent buildings temporarily used for Athletes' Village
-  Future West Don Lands development (temporary use of land for Athletes' Village)

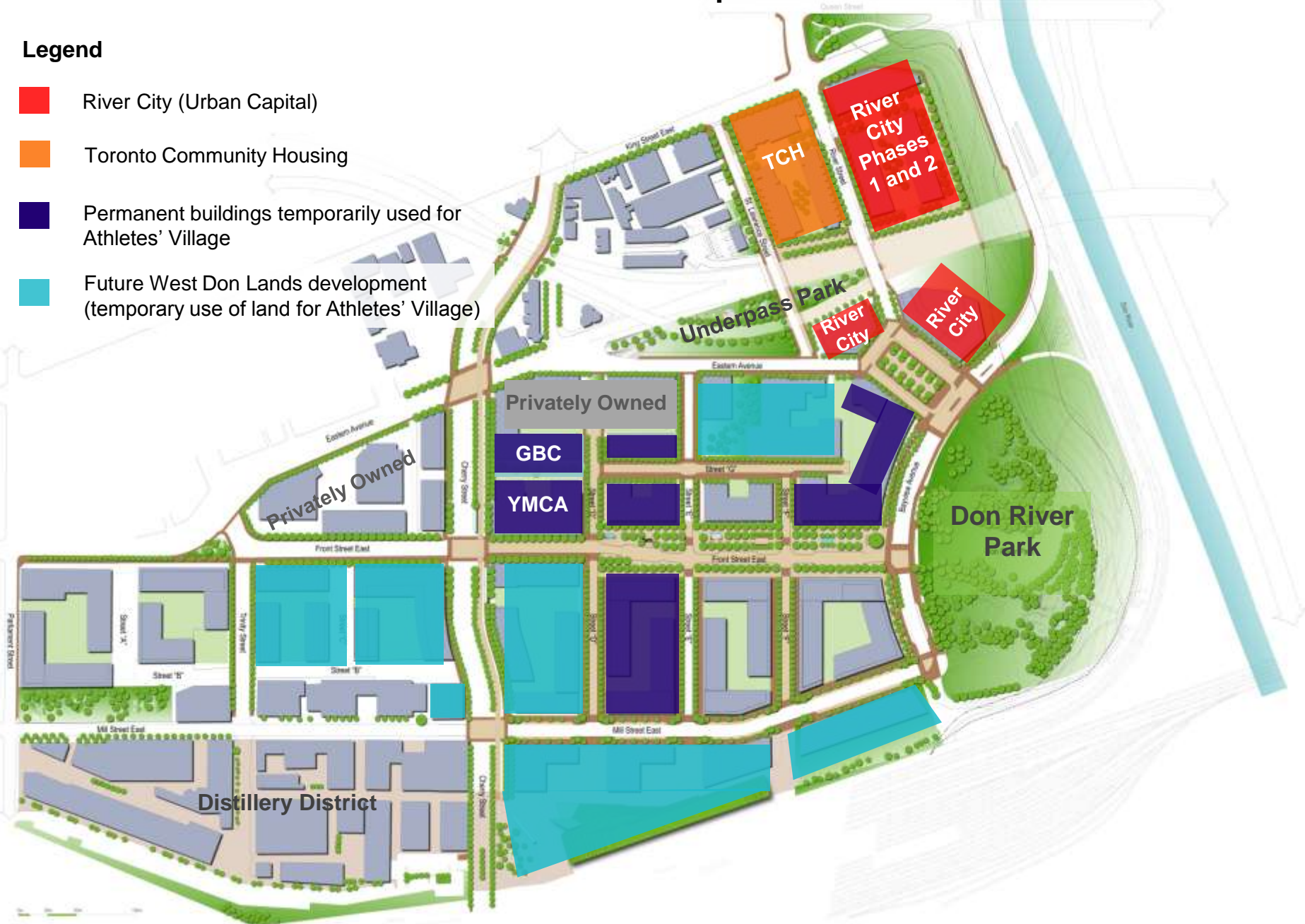

West Don Lands Development

Legend

-  River City (Urban Capital)
-  Toronto Community Housing
-  Permanent buildings temporarily used for Athletes' Village
-  Future West Don Lands development (temporary use of land for Athletes' Village)
-  Future Dundee Kilmer development (temporary use of land for Athletes' Village)



West Don Lands Development

Legend

-  River City (Urban Capital)
-  Toronto Community Housing
-  Permanent buildings temporarily used for Athletes' Village
-  Future Dundee Kilmer development (temporary use of land for Athletes' Village)



Canary District Overview

Jason Lester, Dundee Kilmer Developments





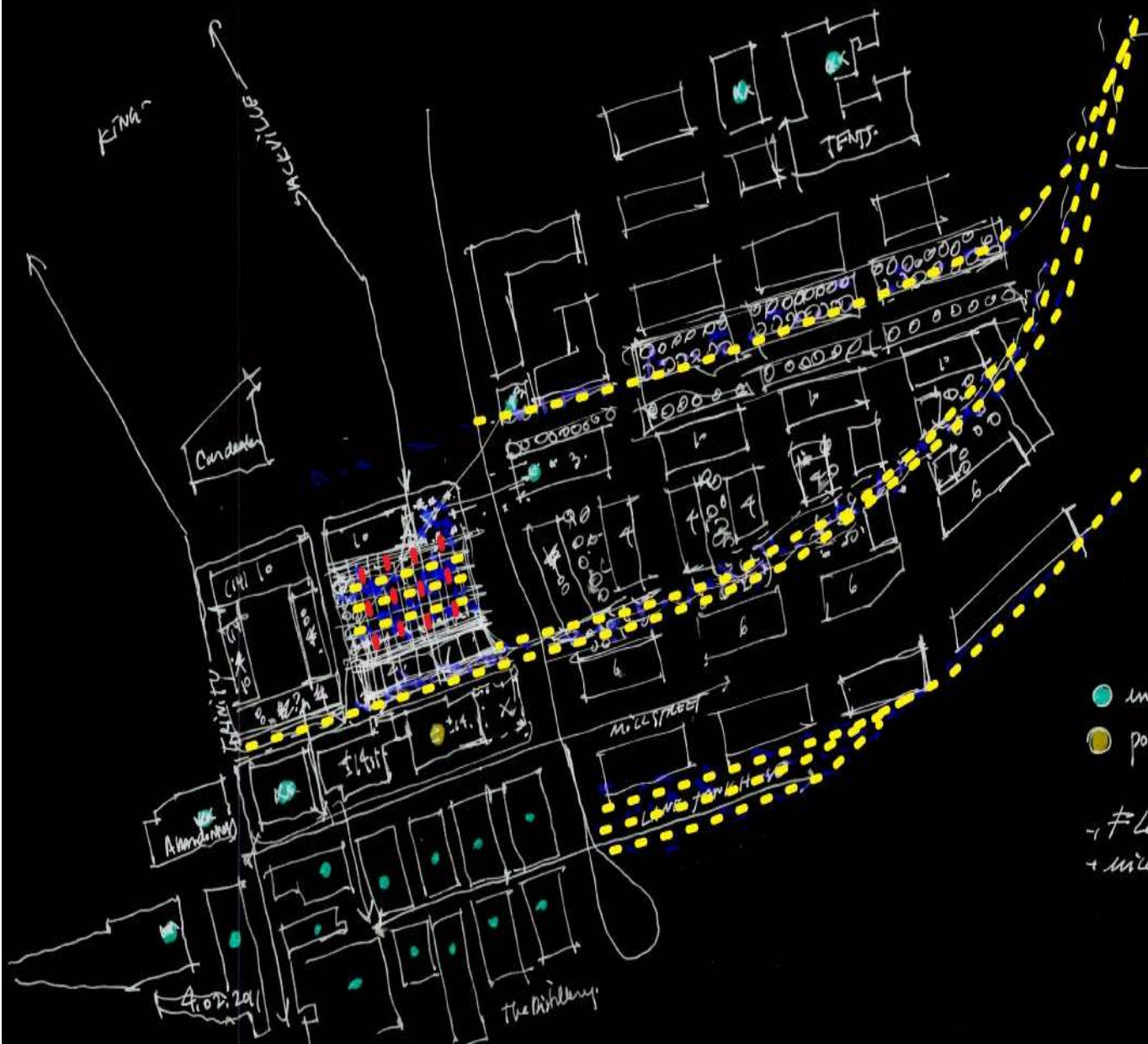

River
city

- 50 m.
- Place J.P. Niquelle
- Example from MITL
- layout
- Plan
- Pictures
- Rent?
- Market place
- PAN Am. / Courthouse

- 4m. wide
+ 6m

- interesting buildings
- poor architectural buildings

- Flood?
+ MILL STREET

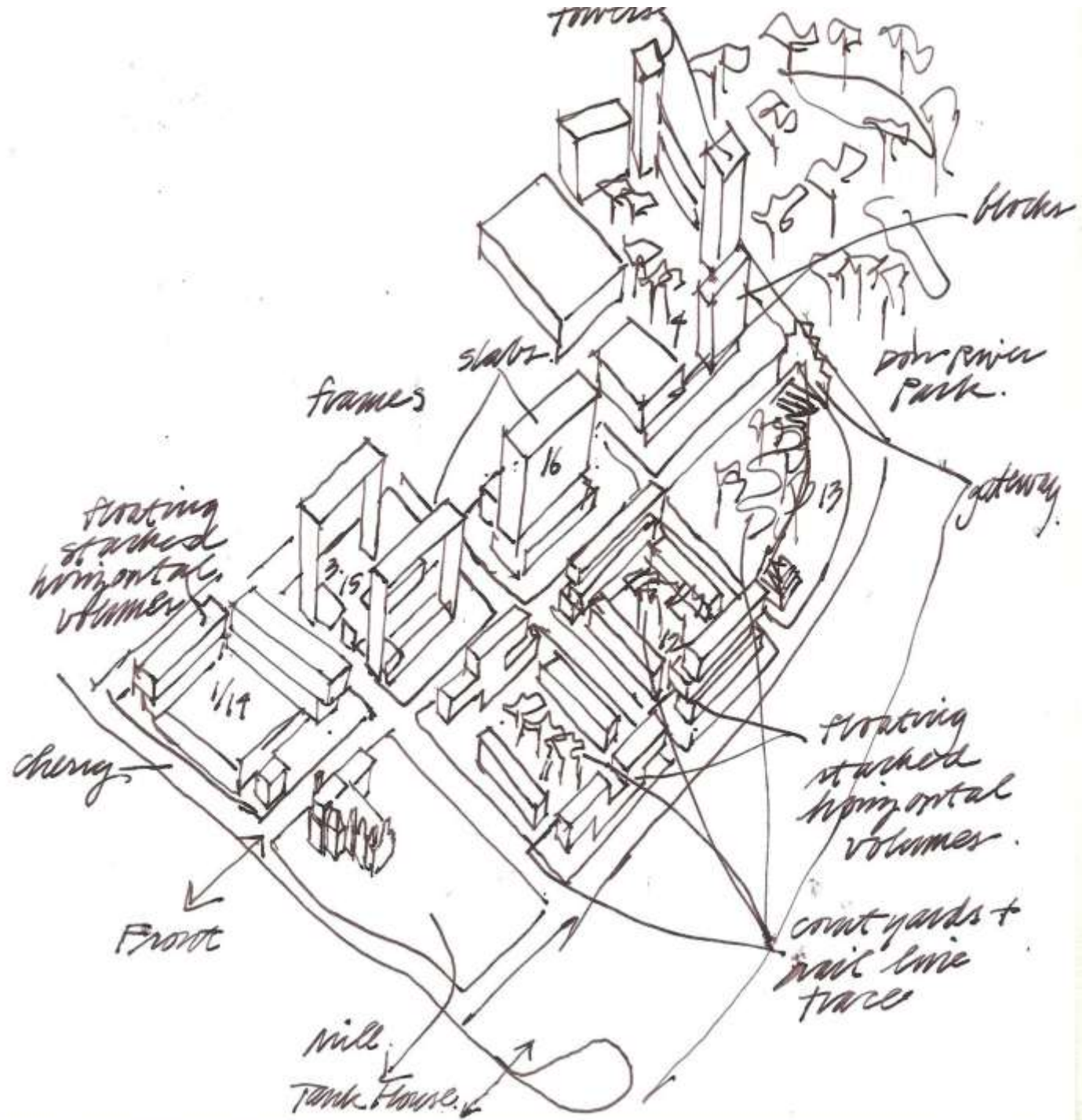

VIDEO









Canary
RESTAURANT

STEAKS & CHOPS

BAR GRILL

CANARY

RESTAURANT

BAR GRILL

CANARY

RESTAURANT







TO DVP

OLD EASTERN AVENUE

CHERRY STREET

CHERRY STREET

BAYVIEW AVENUE

FRONT STREET PROMENADE

18-ACRE
DON RIVER
PARK

Canary
DISTRICT

MILL STREET



Illustration is artist's concept © CBC





BLOCK 1/14











BLOCK 11











BLOCK 3/15









BLOCK 4









District/Pan Am Athletes' Village – Project Schedule

ITEM	2011				2012				2013				2014														
	S	O	N	D	J	F	M	A	M	J	J	A	S	O	N	D	J	F	M	A	M	J	J	A	S	O	N

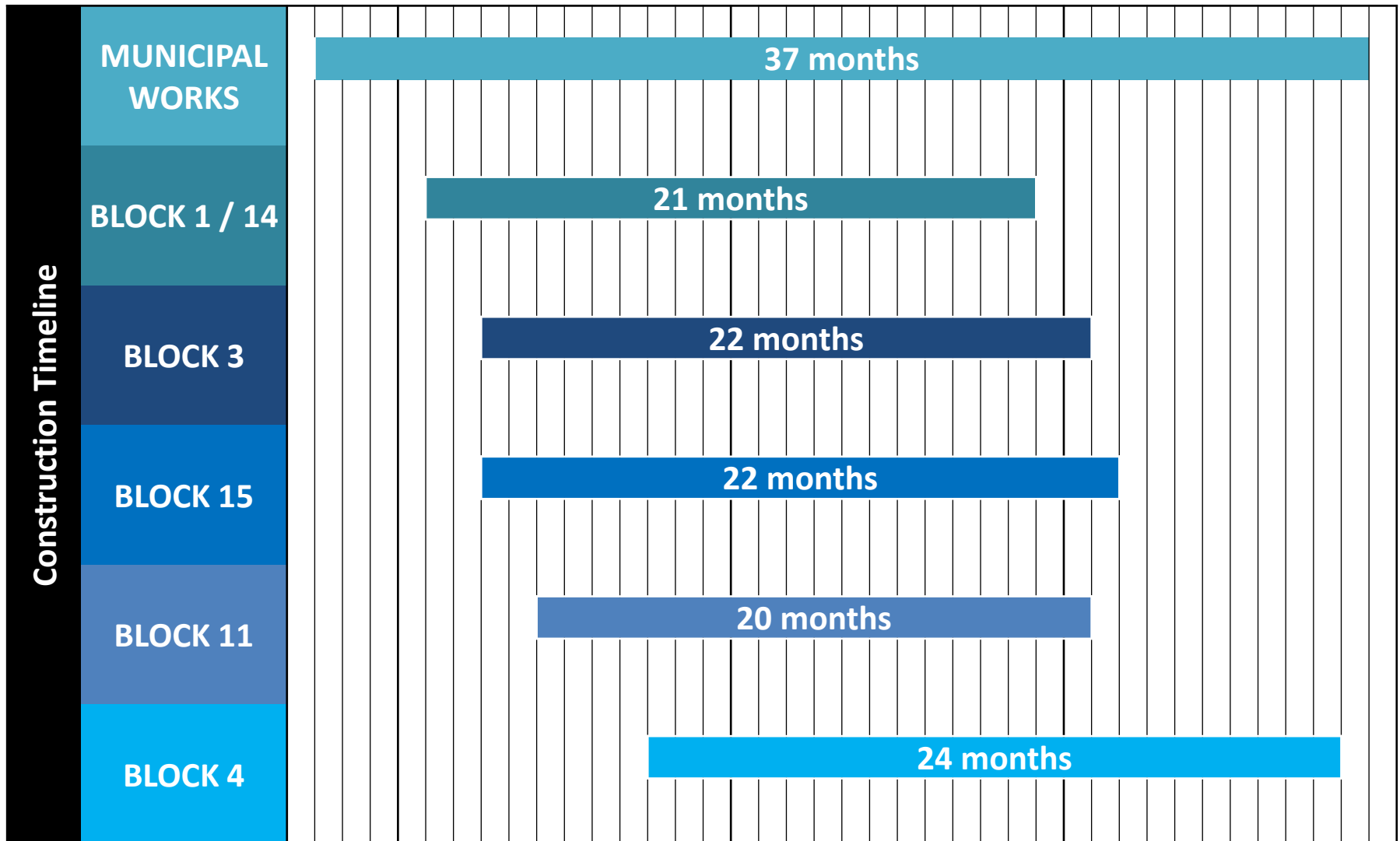

Canary DISTRICT

DUNDEEKILMER
Developments L.P.



WATERFRONToronto

Questions

Building our new blue edge



WATERFRONTToronto



www.waterfronttoronto.ca