



Port Lands Flood Protection: Promontory Park South

Schematic Design

February 26, 2020

Project Description and Background

- 290 hectares of southeastern downtown Toronto are at risk of flooding from the Don River watershed
- The Port Lands Flood Protection and Enabling Infrastructure Project is a comprehensive solution to flood protection
- Items that will be presented today:
 1. Promontory Park South



Parks

- A** Cherry Street Stormwater and Lakefilling
- B** Poison Slip Naturalization
- C** Flood Protection - River Valley
- D** Don Greenway (Spillway & Wetland)
- E** Don Roadway Valley Wall Feature
- F** East Harbour Flood Protection Land Form
- G** Sediment and Debris Management Area
- H** Flow Control Weirs
- I** Eastern Avenue Flood Protection
- J** Villiers Island Grading
- K** Keating Channel Modifications
- L** **Promontory Park South**
- M** River Park
- N** Lake Shore Road and Rail Bridge Modifications
- O** Cherry Street Bridge North
- P** Cherry Street Bridge South
- Q** Commissioners Street Bridge
- R** Old Cherry Street Bridge Demolition
- S** Site Wide Municipal Infrastructure
- T** Don Roadway
- U** Hydro One Integration
- V** Commissioners Street
- W** Cherry Street Re-alignment

-  Port Lands Flood Protection and Enabling Infrastructure Boundary
-  Earthworks/Flood Protection
-  Parks
-  Bridges & Structures
-  Roads and Municipal Infrastructure

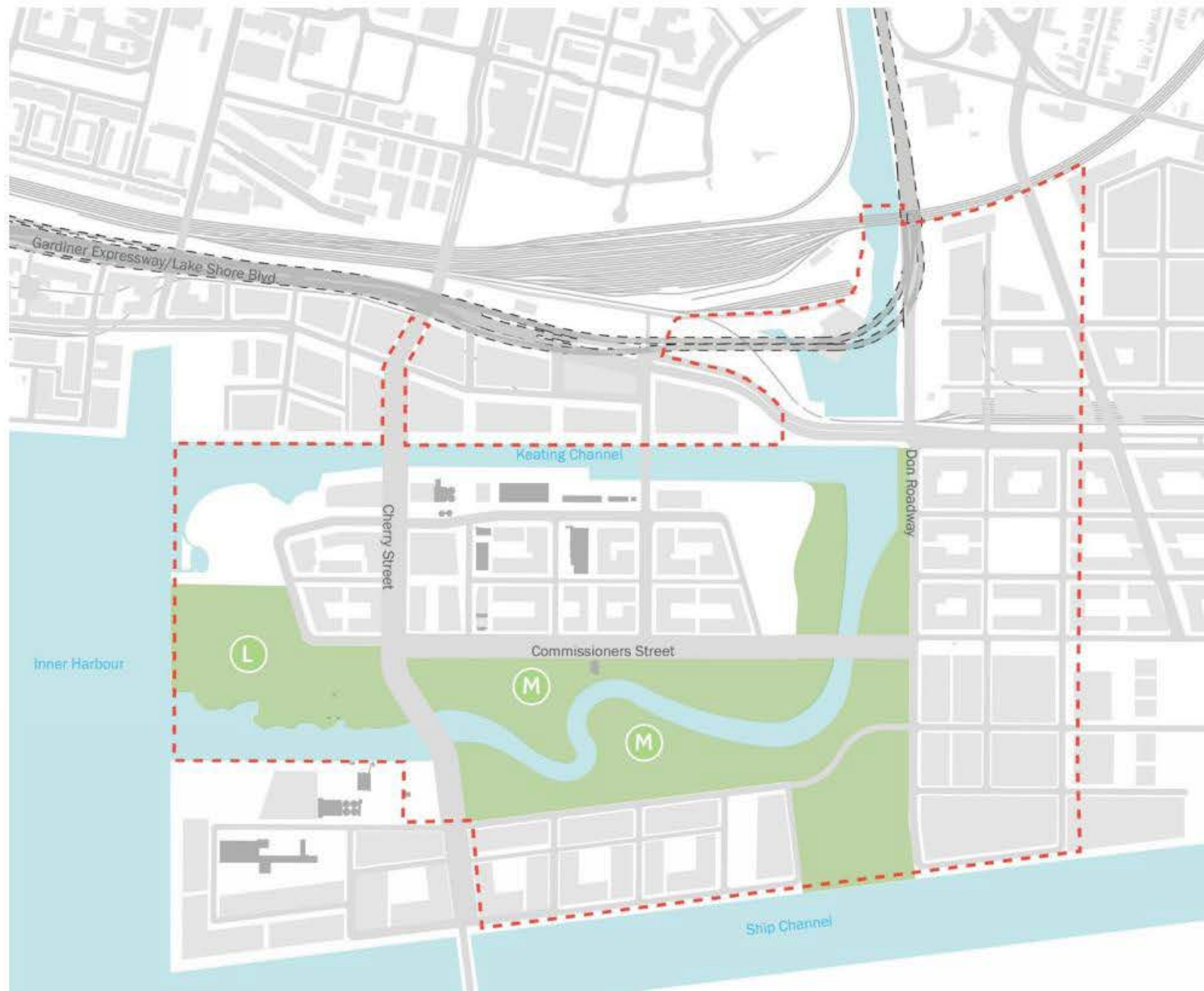

Team Structure

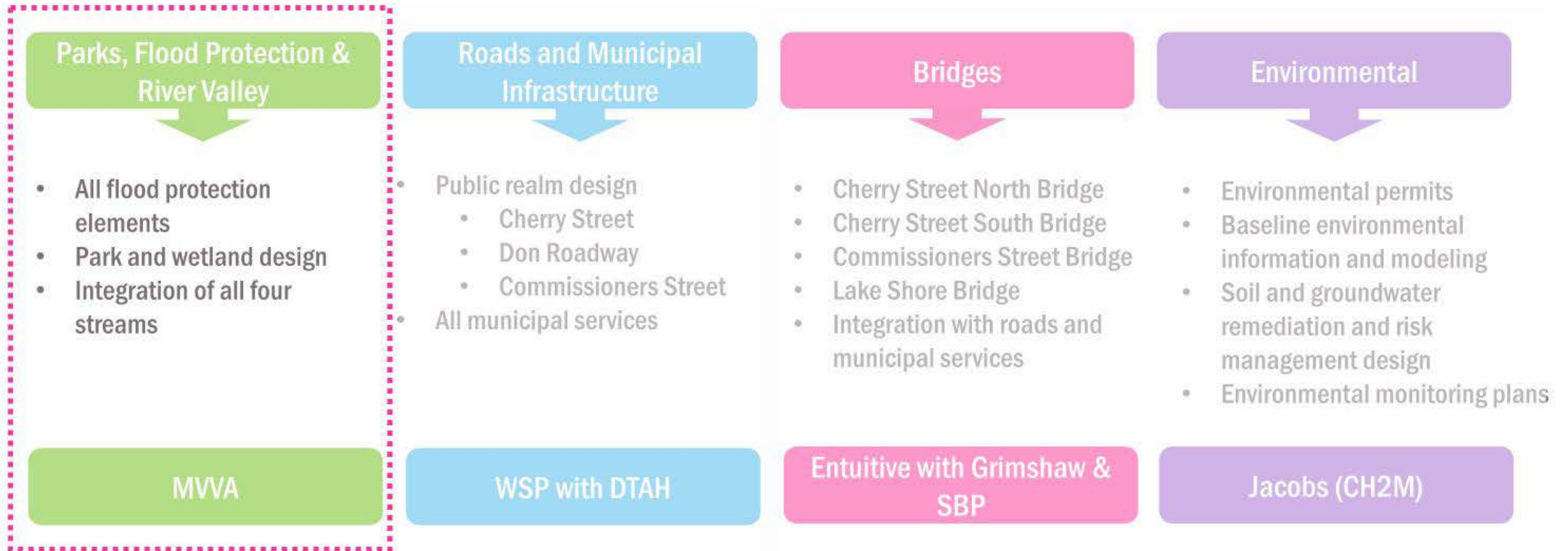

Project Schedule – Anticipated Design Schedule

- 10/10/2019- 60% Design Submission (River Valley Park North/River Valley Park South) Work Package #9
- 10/31/2019- 95% IFT Submission (River) Work Package #8
- 01/23/2020- 100% Design IFC Submission (River) Work Package #8
- 02/26/2020- **DRP Review- Promontory Park South Schematic Design**
- 04/22/2020- **DRP Review- Promontory Park South and River Park (North and South) Detail Design**
- 05/07/2020- 60% Design Submission (Promontory Park South/Canoe Cove) Work Package #9.1
- 07/30/2020- 90% Design IFT Submission (Canoe Cove/ Promontory Park South Earthwork) Work Package #9.1
- 10/31/2020- 90% Design IFT Submission (River Valley Park North/River Valley Park South/ Promontory Park South) Work Package #9/#9.2

Promontory Park South Overall Design

February 2020

Review Stage: Schematic Design

Proponent: Waterfront Toronto

Design Team: MVVA (Parks and River)



Recap – Integration

June 2019:

- Develop a strategy on how to achieve continuity and leverage discrete elements in the park.
- Consider bringing concrete paving on the entry paths all the way to the interior circulation paths.
- Consider a larger, stronger and more direct entrance to the park, at the corner of Commissioners and Cherry St.

Recap – Parks and River

September 2018

- Consider retaining more of the industrial heritage features in the revised design.
- Accommodate both a destination playground and a significant cultural institution in the plan.

April 2018:

- There needs to be a good balance between the constructed nature of the park and the landscape. Reconsider the number of paths proposed near the greatest habitat areas.
- Integrating the industrial heritage and city into the park is important and this piece has been lost too much. Work with Waterfront Toronto to reconsider how MT35 will be expressed.

Public Art Plan Update: Goals

1. A changing and permanent art platform that speaks to the story of the water
2. To identify a potential open-air route that will create multiple opportunities for the public to discover and engage with art



Sky Mirror by Anish Kapoor

Public Art Plan Update: Story of the Water

A flexible art platform that will engage with the multiple layers of histories and stories of the site's waterways:

- Histories and stories
- Engineered nature
- Ecology
- Site physiography and geology
- Hydrology and hydrodynamics
- Sustainability and the environment



Nymphéa by Ange Leccia

Public Art Plan Update: Implementation

- Provide a variety of environments to which art can respond
- Provide a variety of anchoring conditions and infrastructure
- Facilitate a streamlined permitting system with PF&R



Bird Blind by Maya Lin

Public Art Plan Update: Next Steps



Areas for Panel Consideration

Parks and River:

- Balance between programmed space and designed nature
- Clear articulation of the path network within the parks
- Balance of response to site technical constraints and achieving design objectives
- Appropriate integration of playscape within overall park programming
- Sensitive integration of heritage elements within the park

Port Lands Flood Protection & Enabling Infrastructure Promontory Park South Schematic Design Review #2C

Waterfront Design Review Panel
February 26, 2020

DRAFT

Michael Van Valkenburgh Associates, Inc.
Landscape Architects

DRAFT

Design Evolution

The Port Lands - 2024



Promontory Park and Canoe Cove - Schematic Design Review



- ① Central Lawn
- ② Passive Use Lawn
- ③ Promontory
- ④ Esplanade
- ⑤ Water Access
- ⑥ Atlas Crane Island
- ⑦ Pedestrian Bridge
- ⑧ Entry Plaza
- ⑨ Future Park Drop Off
- ⑩ Future Destination Play

Toronto Inner Harbour

Centre Street

Trinity Blvd.

Cherry Street

West Cove

Canoe Cove

Polson Slip

WDRP 2B - April 2018



Project Feedback

Design Review Panel

- Find a clear balance between **constructed nature and programmed space**
- Some part of the **MT-35 building should be reconsidered**. Enough of it to celebrate its history
- Strong juxtaposition of **industrial past and landscape**
- Find a role for **public art** within the design
- **Increase porosity** of park edges and **enhance park entrances**
- Develop signage and wayfinding
- Create a family of materials and furnishings
- **Consider future conditions** in and around the park
- Consider experience of bridge underpasses

Community (Survey + Consultations)

- Feeling immersed in nature comes from ability to wander while discovering new views or un-manicured vegetation
- **Variation of landscape and ecology** was noted as “nice to have”
- People expressed a desire for **clear information about access points** (lighting and signage indicating formal paths)
- Emphasis on **views and variety of landscape types**
- **Create views of Inner Harbour and City**
- **All season use** support winter programming
- Facilitate public water activities and **connections/access to the water**
- **Integrate history** through preserving local heritage and culture (adaptive reuse, art)

SAC

- **Water access** and watercraft storage
- **Youth/school group** camp program space
- **Flexibility of spaces** to accommodate economic diverse population
- Recognition of **First Nations**
- **Universal access**
- Retaining **industrial heritage**
- Important to recognize this park space is unusual in an urban setting. **Use of the park should be prioritized above vehicular access or transit movements**
- Consider that park access off Commissioners Street will be in high demand
- Wherever possible, **introduce less typically urban materials and shapes** – e.g., unpaved pathways.

Canoe Cove - Detailed Design Review



WDRP 3A - September 2018



Constructing a Waterfront Landmark from River Excavation

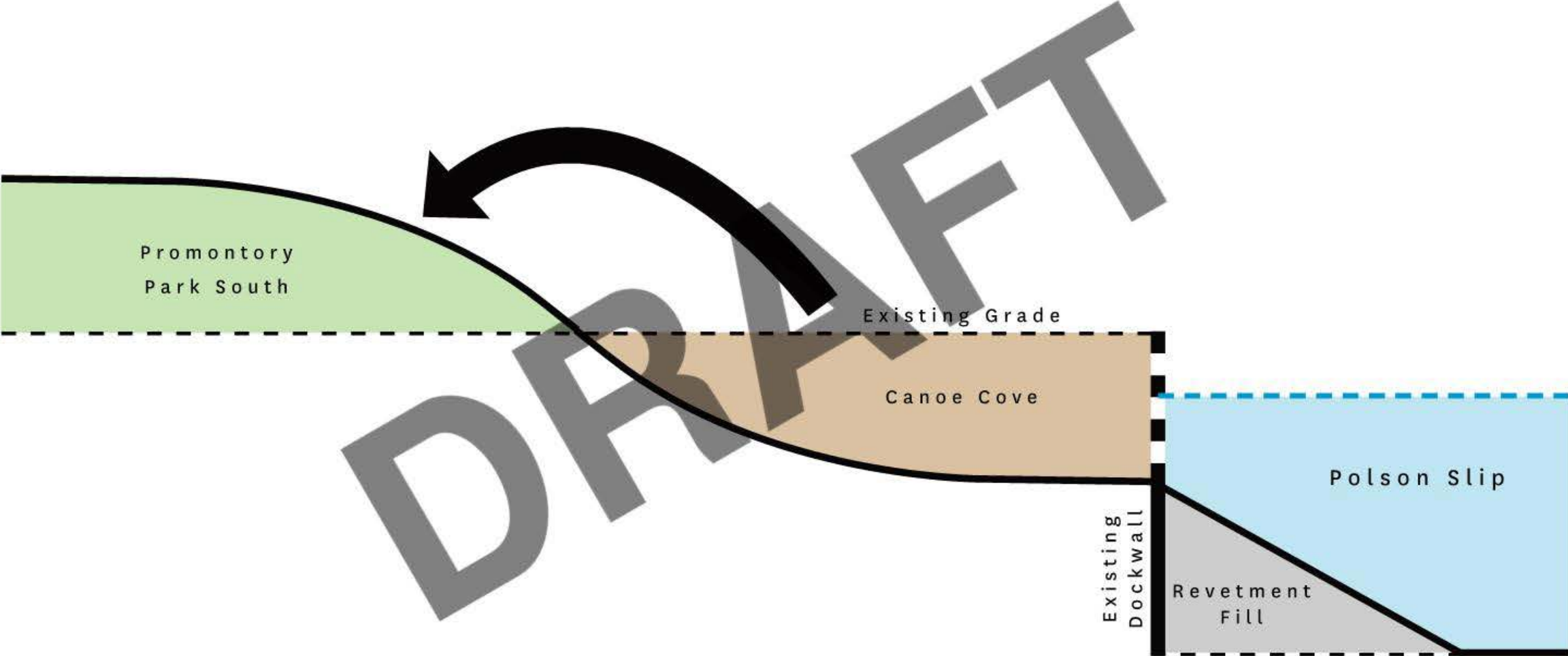

Responding to Existing Site Structural and Geotechnical Conditions

25m No Fill Zone Without Dockwall Reinforcement, 16m No Fill Zone with Dockwall Reinforcement

Toronto Inner Harbour

83m +/- Existing MT-35 Dockwall Reinf.

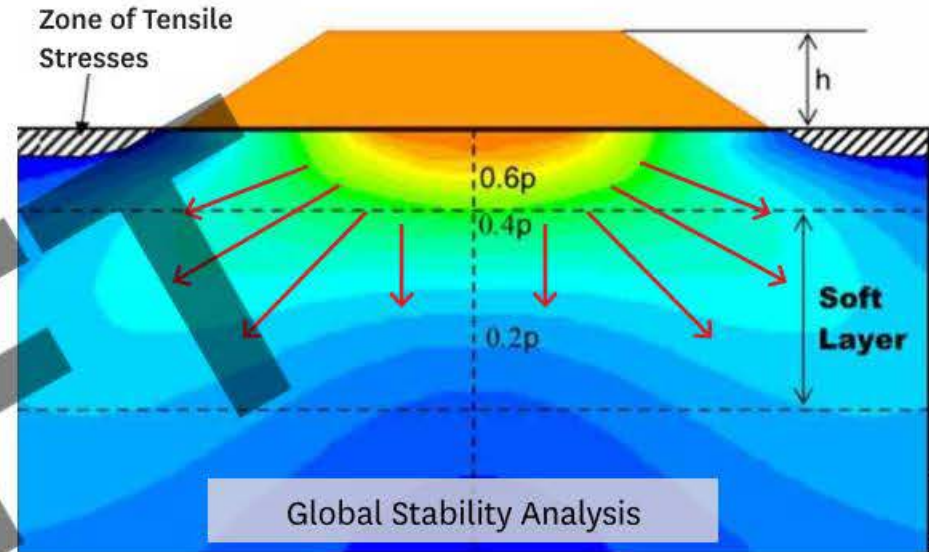
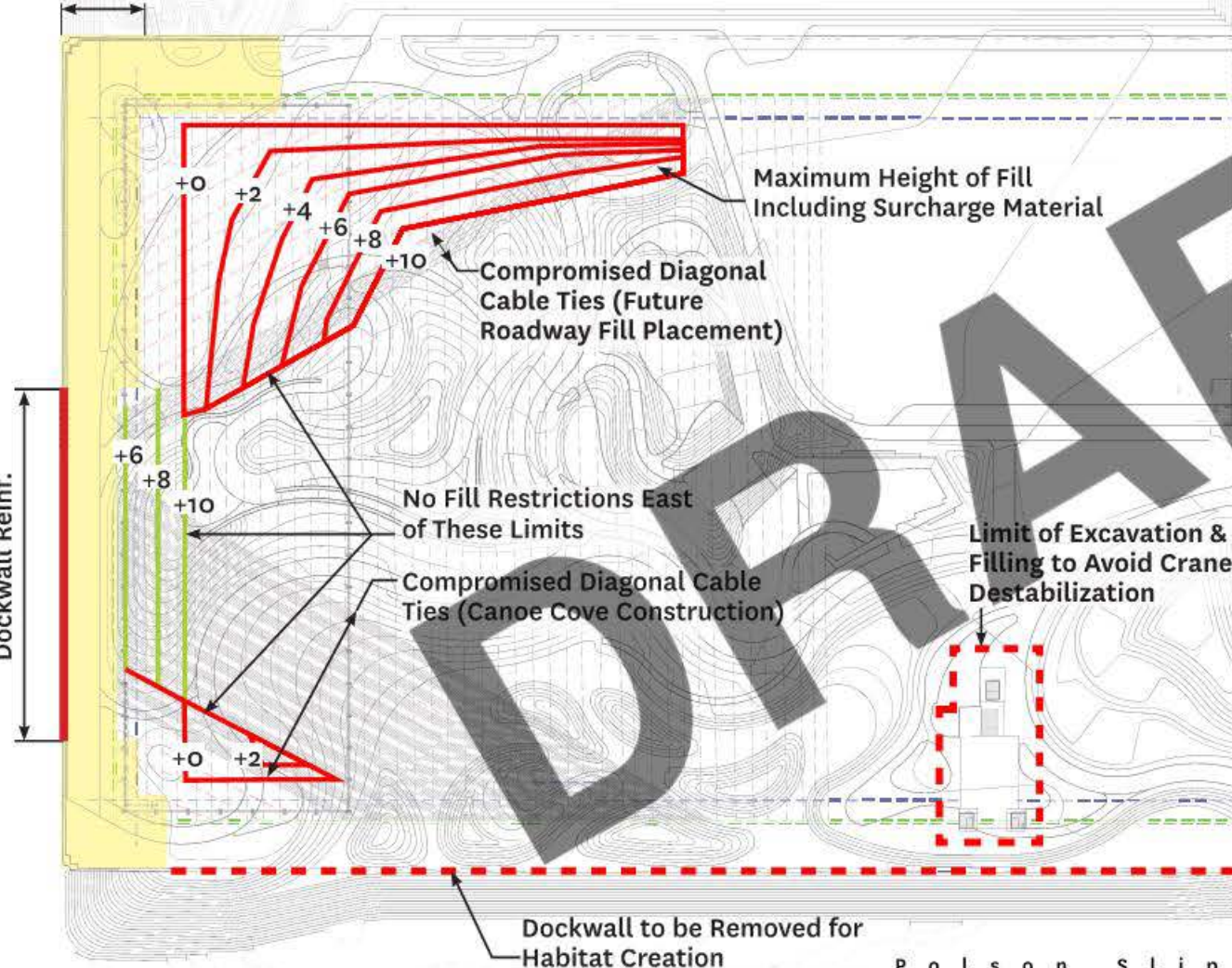

P o l s o n S l i p



Promontory Park South - Concept Diagram

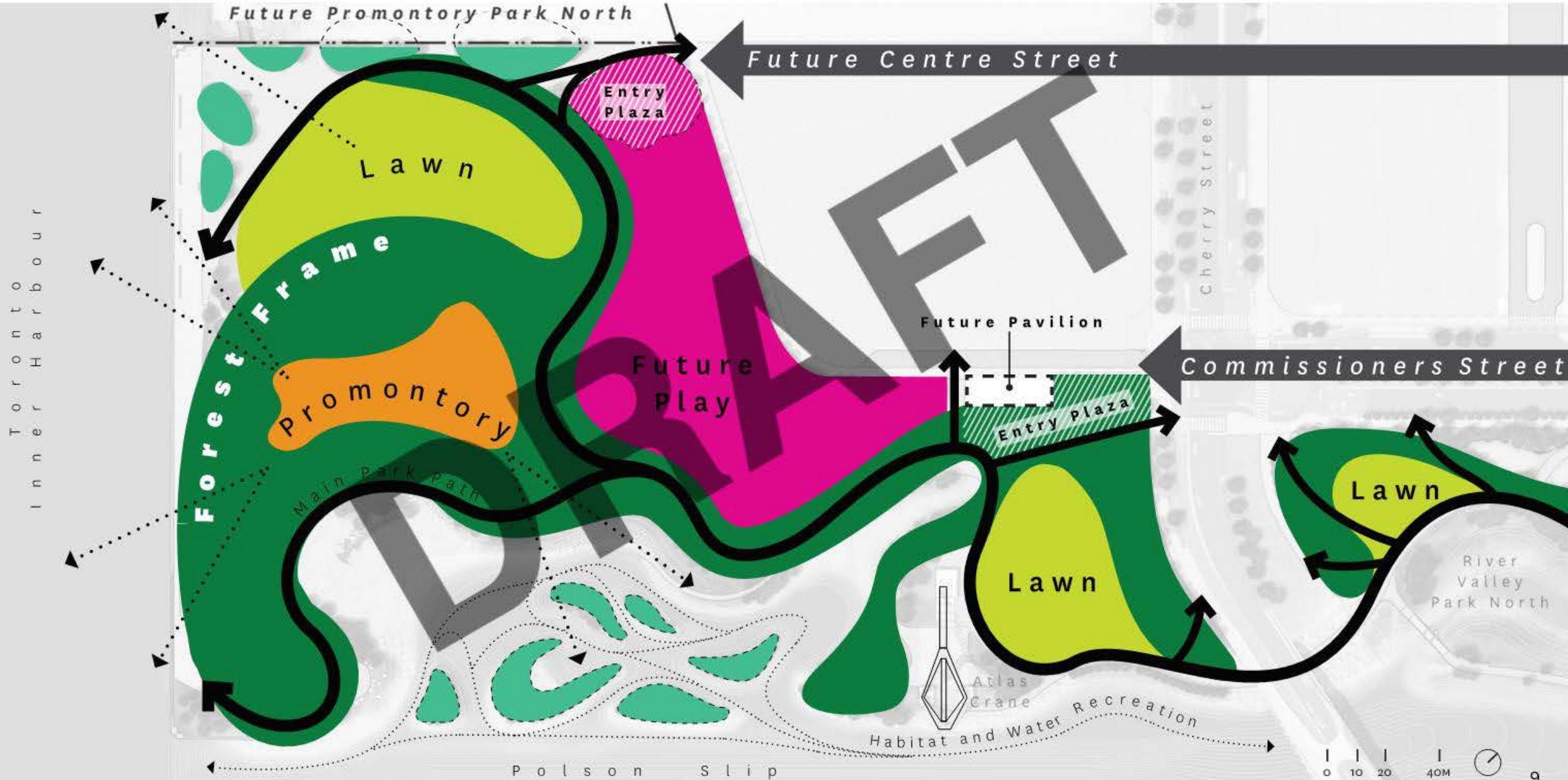

Updated Design - February 2020



- ① Central lawn
- ② Play Lawn
- ③ Upper Promontory
- ④ Promontory River View
- ⑤ Promontory Harbor View
- ⑥ Esplanade
- ⑦ Gravel Beach
- ⑧ Atlas Crane Peninsula
- ⑨ Crane Lawn
- ⑩ Rocky Scramble
- ⑪ MT-35 Commemoration
- ⑫ Entry Garden
- ⑬ Future Play Pavilion / Comfort Station
- ⑭ Future Park Drop Off
- ⑮ Future Destination Play Area

Toronto Inner Harbour

Polson Slip



DRAFT

Design Updates

Park Character

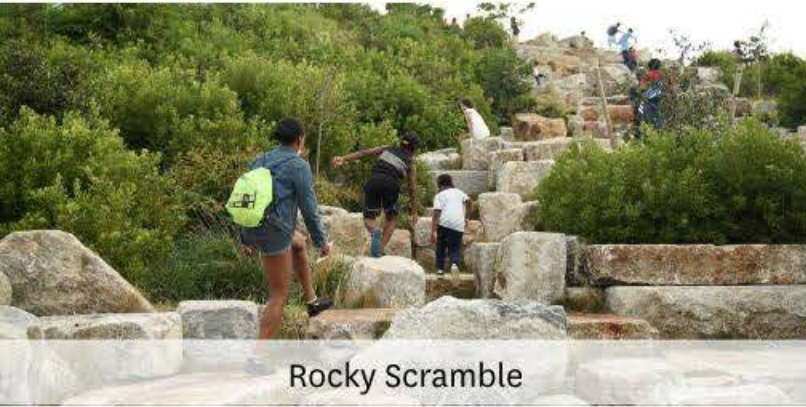

Rocky Scramble



Passive Use Lawn



Prospect Overlook



Canoe/Kayak Launch



Waters Edge Esplanade



Upland Forest



Play Lawn



Atlas Crane



Destination Play

The Promontory



An Enfolded Landscape Experience

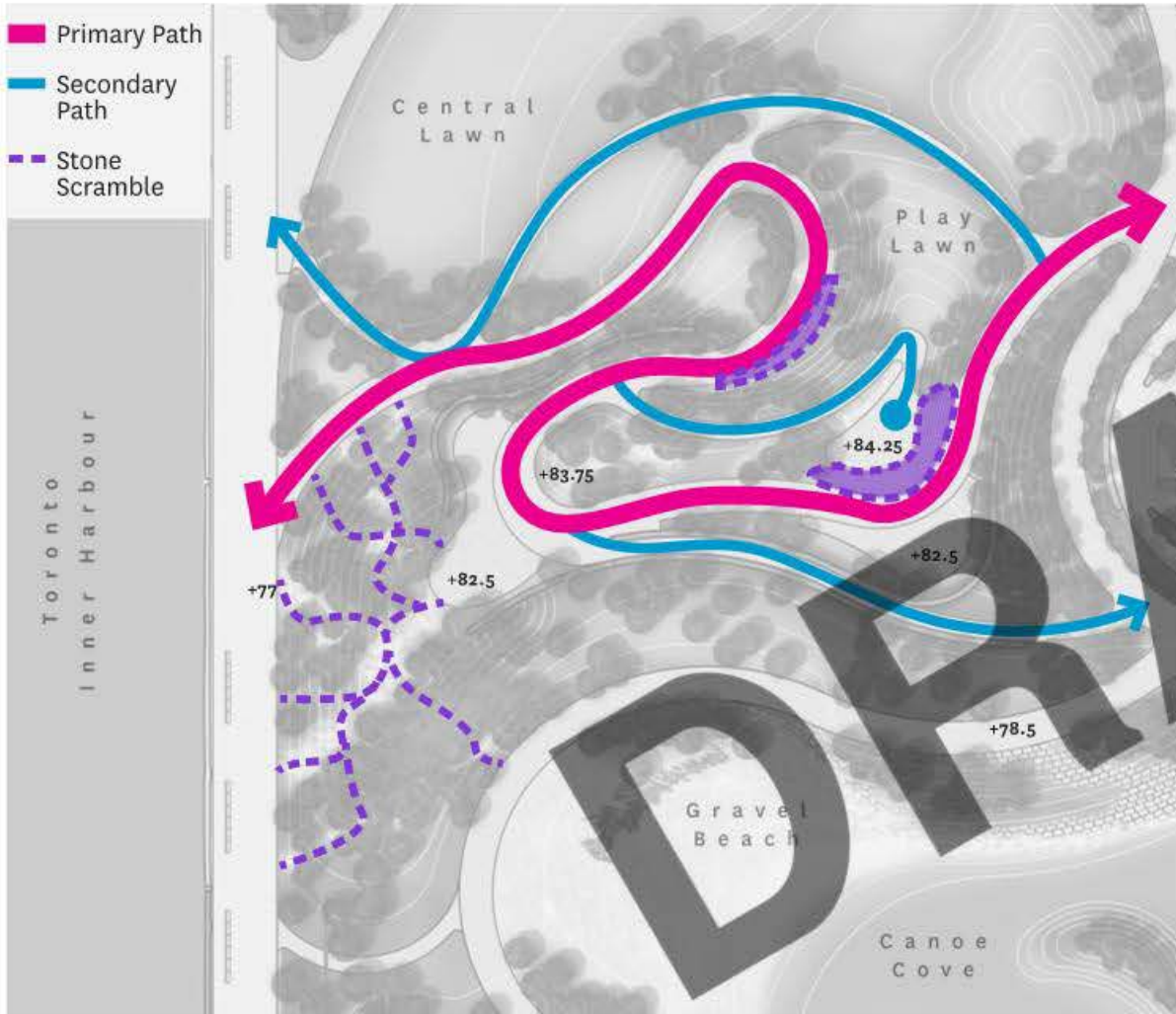

Path Network to Promontory

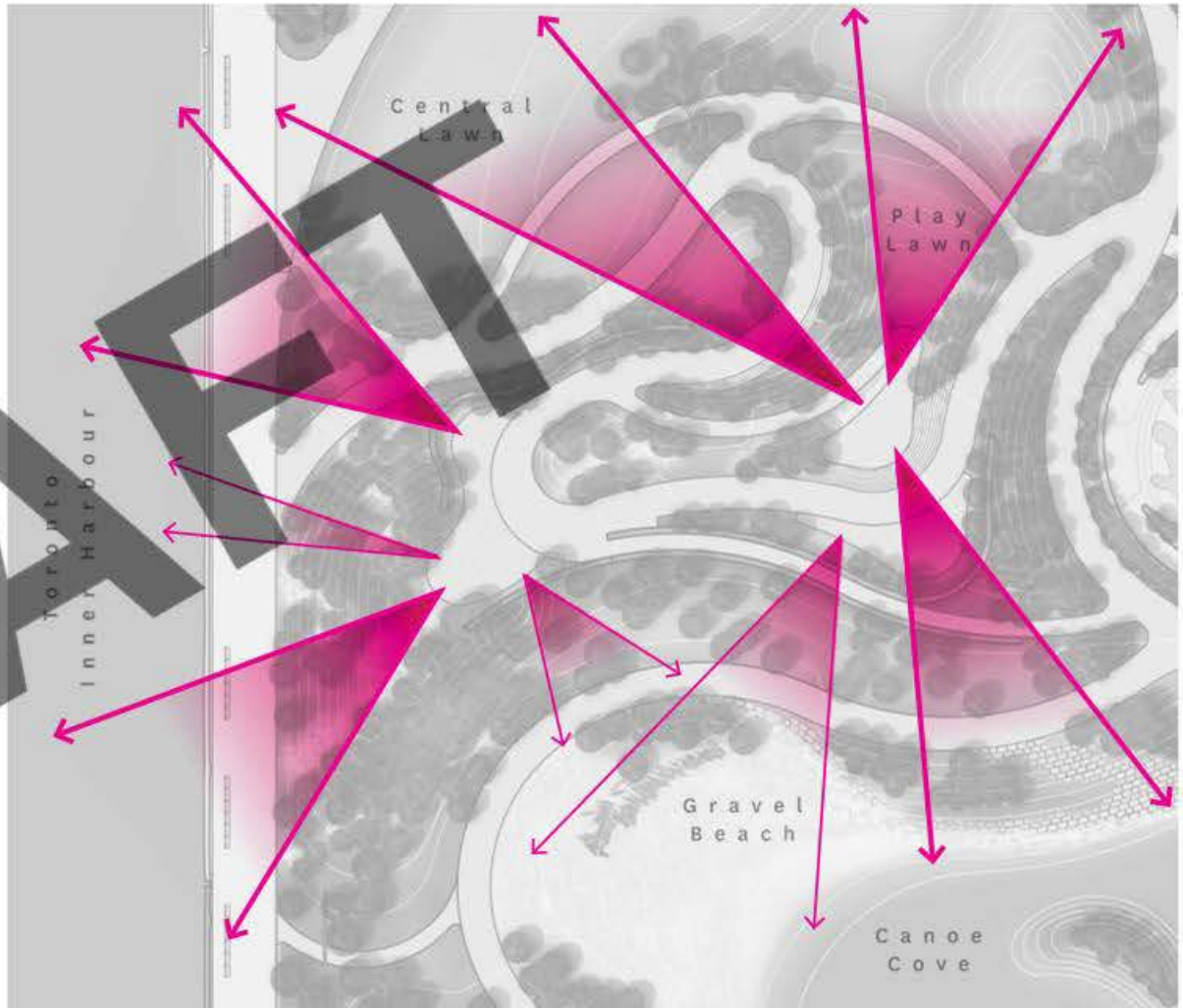

Choreographing Views of Toronto



The Promontory - Section

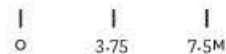
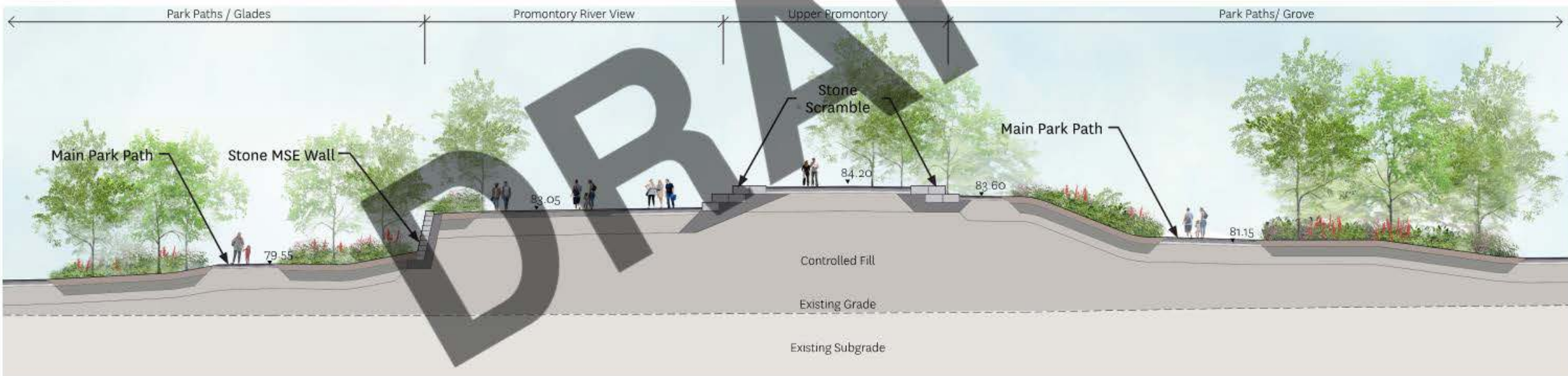

Programming to Attract City Wide Users



Movie Night- Brooklyn Bridge Park

Event Lawn Programming Diagrams



Movie Night



Large Concert



Outdoor Recreation Programming Diagrams

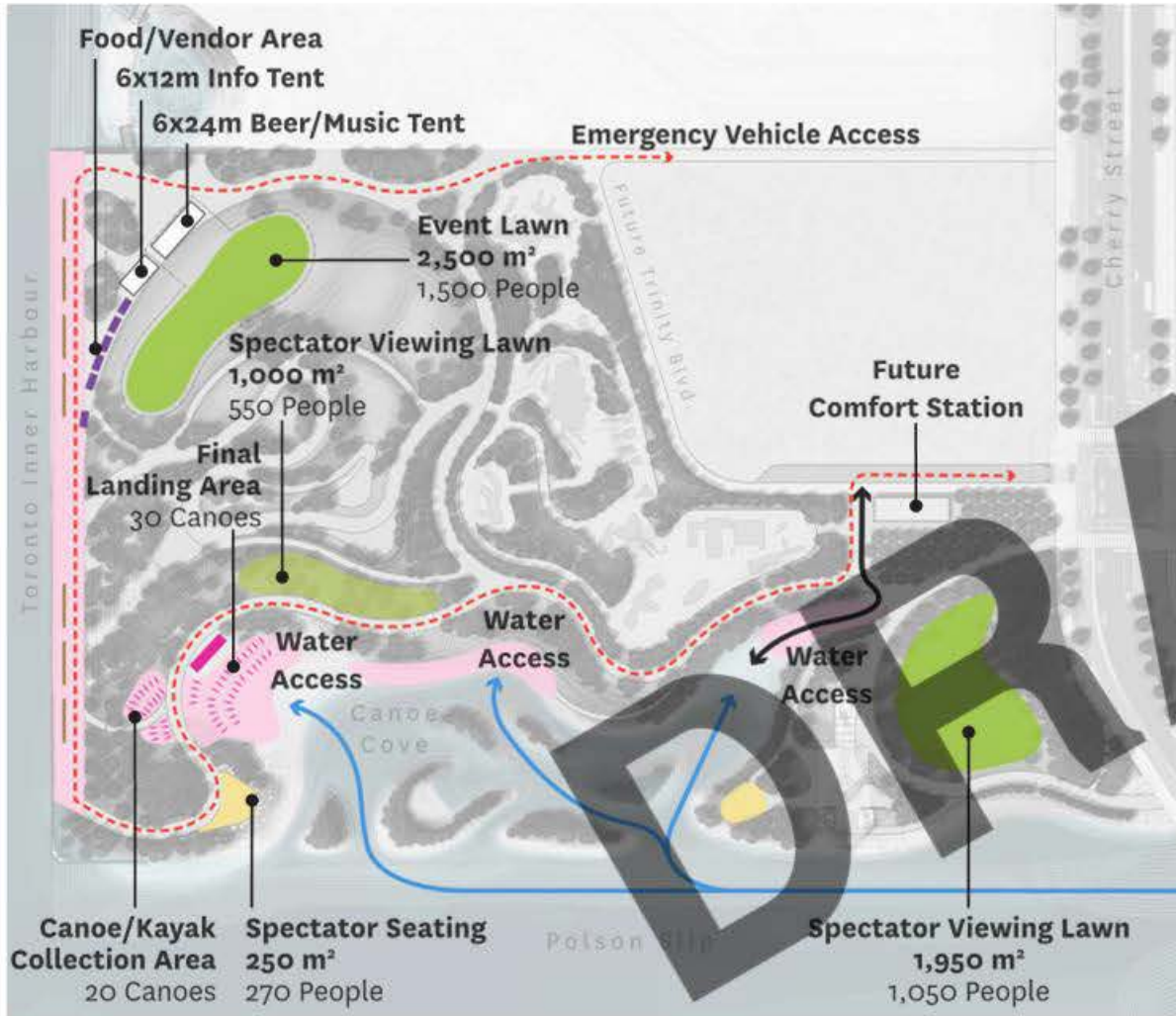

Paddle The Don

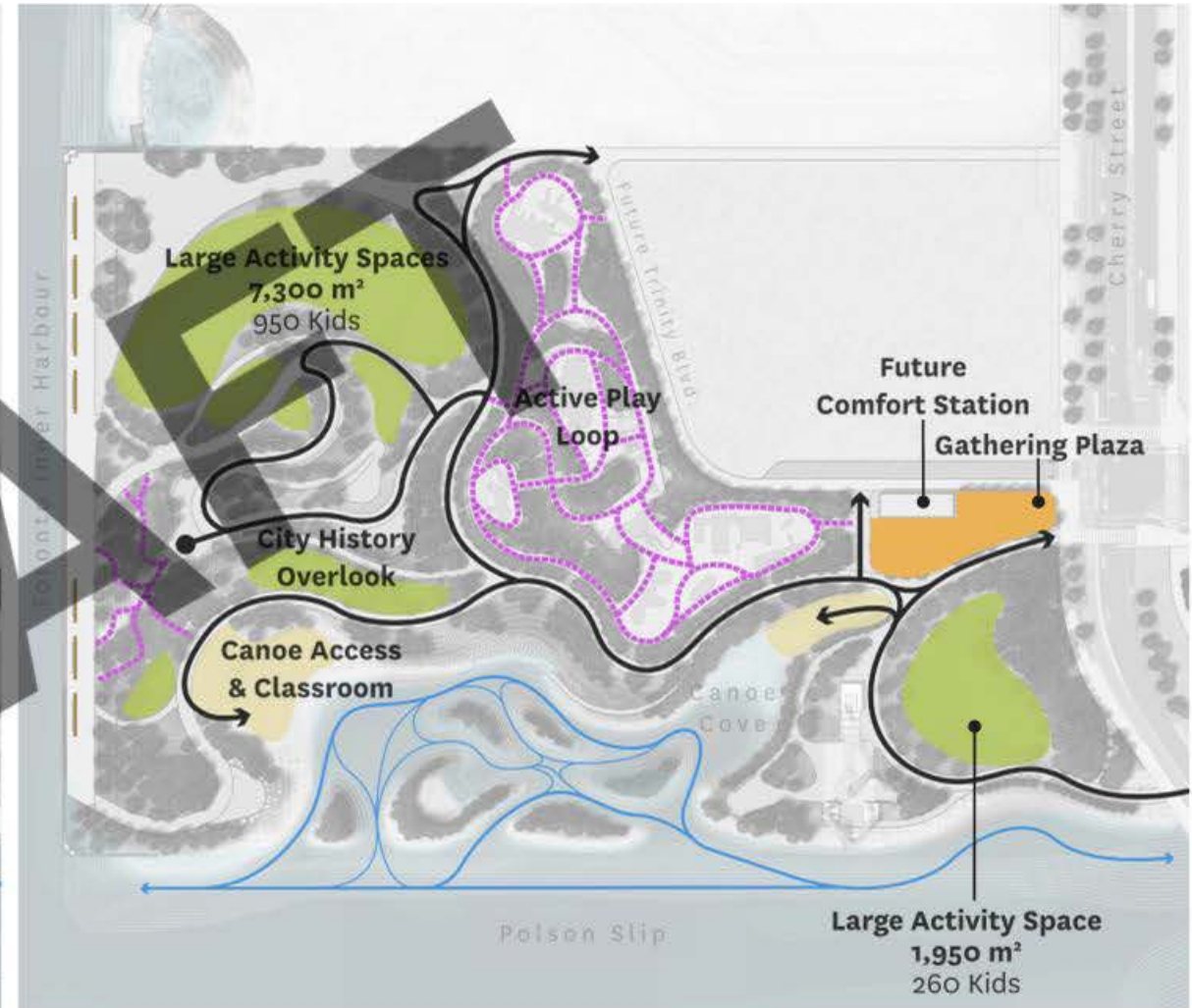

PFR Summer Camp

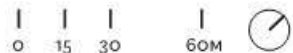

Aspirations for Destination Play Area



Gathering Space, Tulsa OK

Destination Play Area Scale Comparison



Maggie Daley Park, Chicago IL



Future Destination Play Area

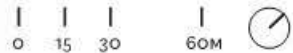

Retaining and Commemorating Industrial Heritage

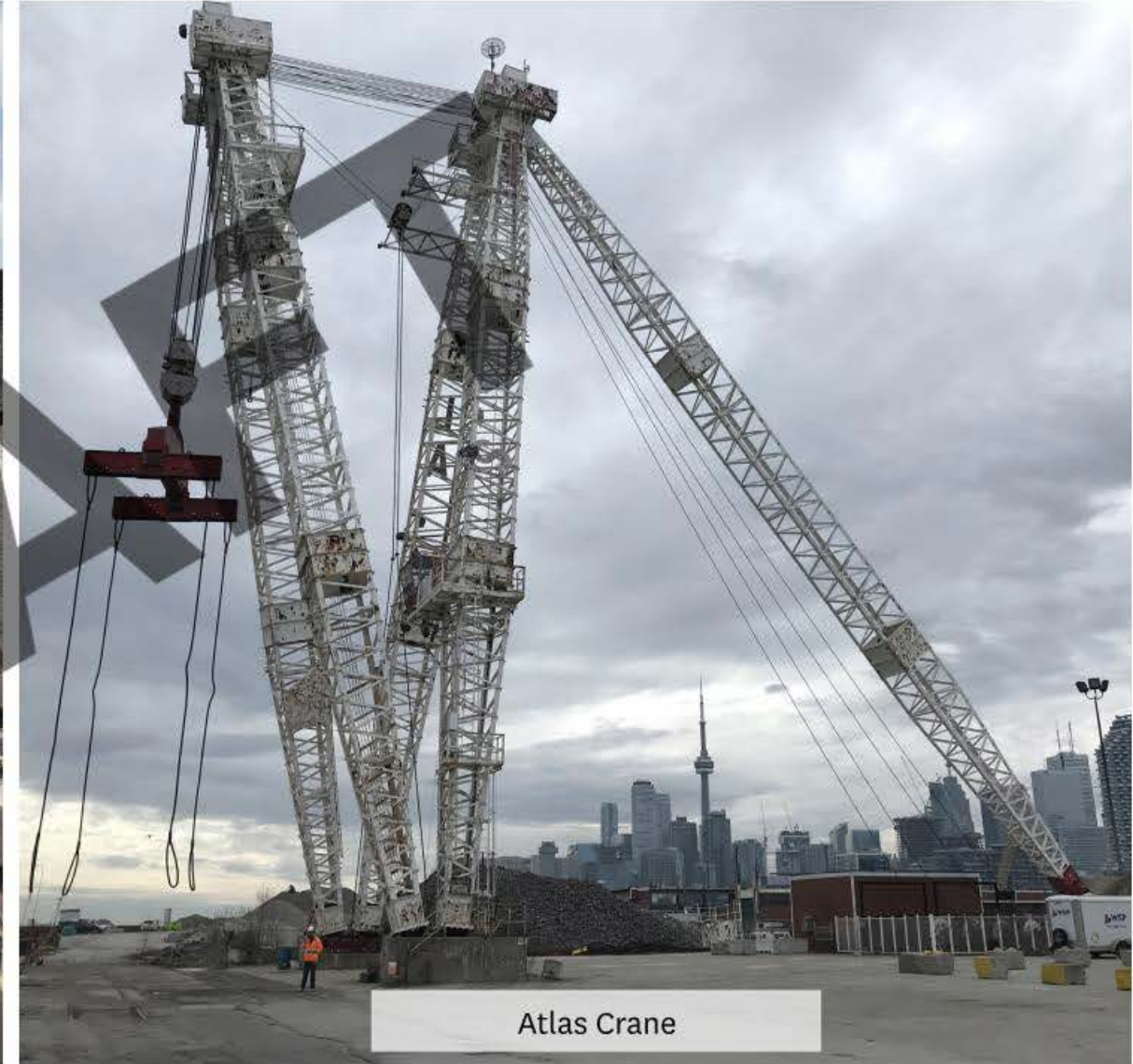

Topography and Path Network Diagram

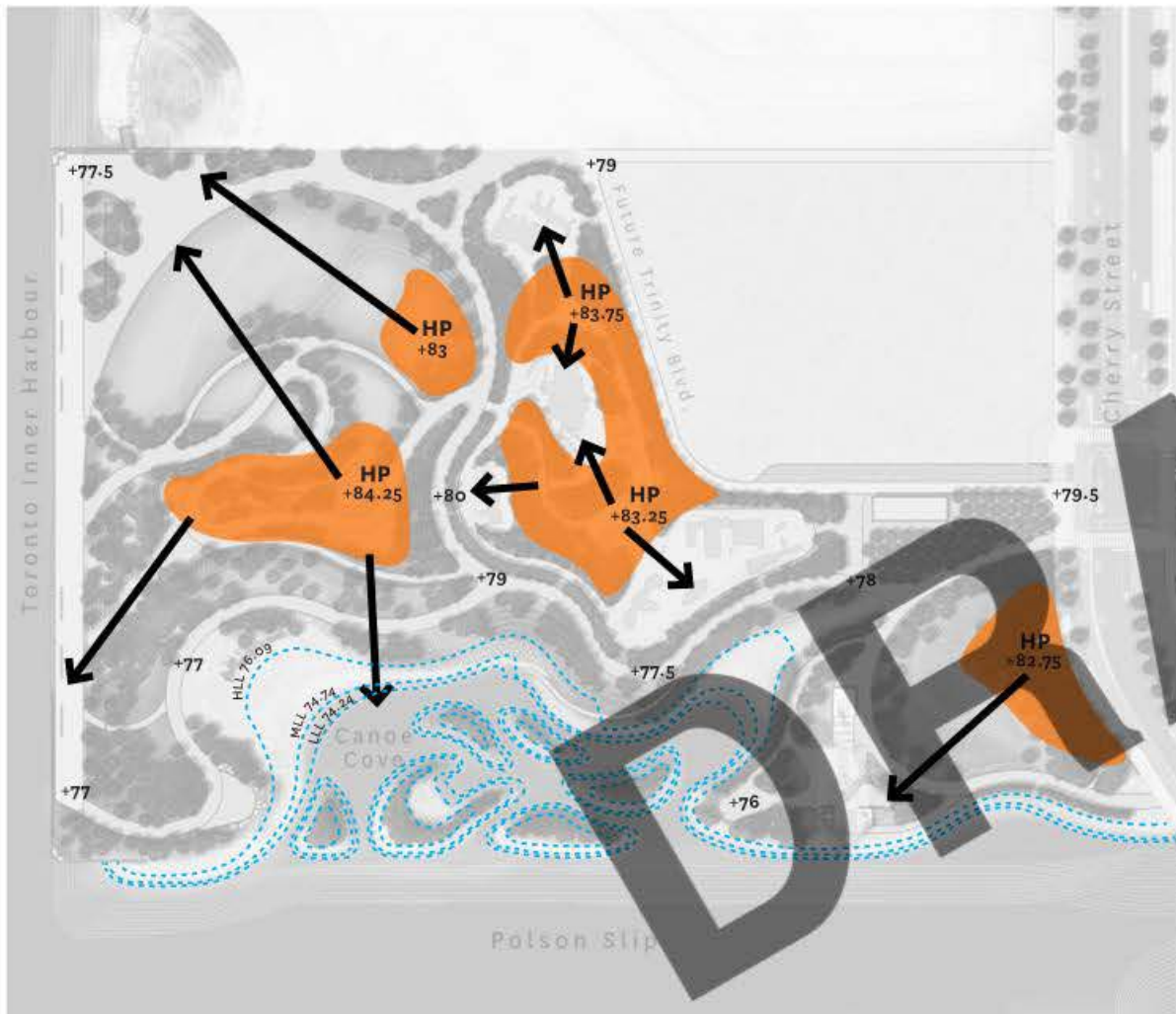

Topography



Path Network



Vegetation Buffer and Wind Comfort Diagram

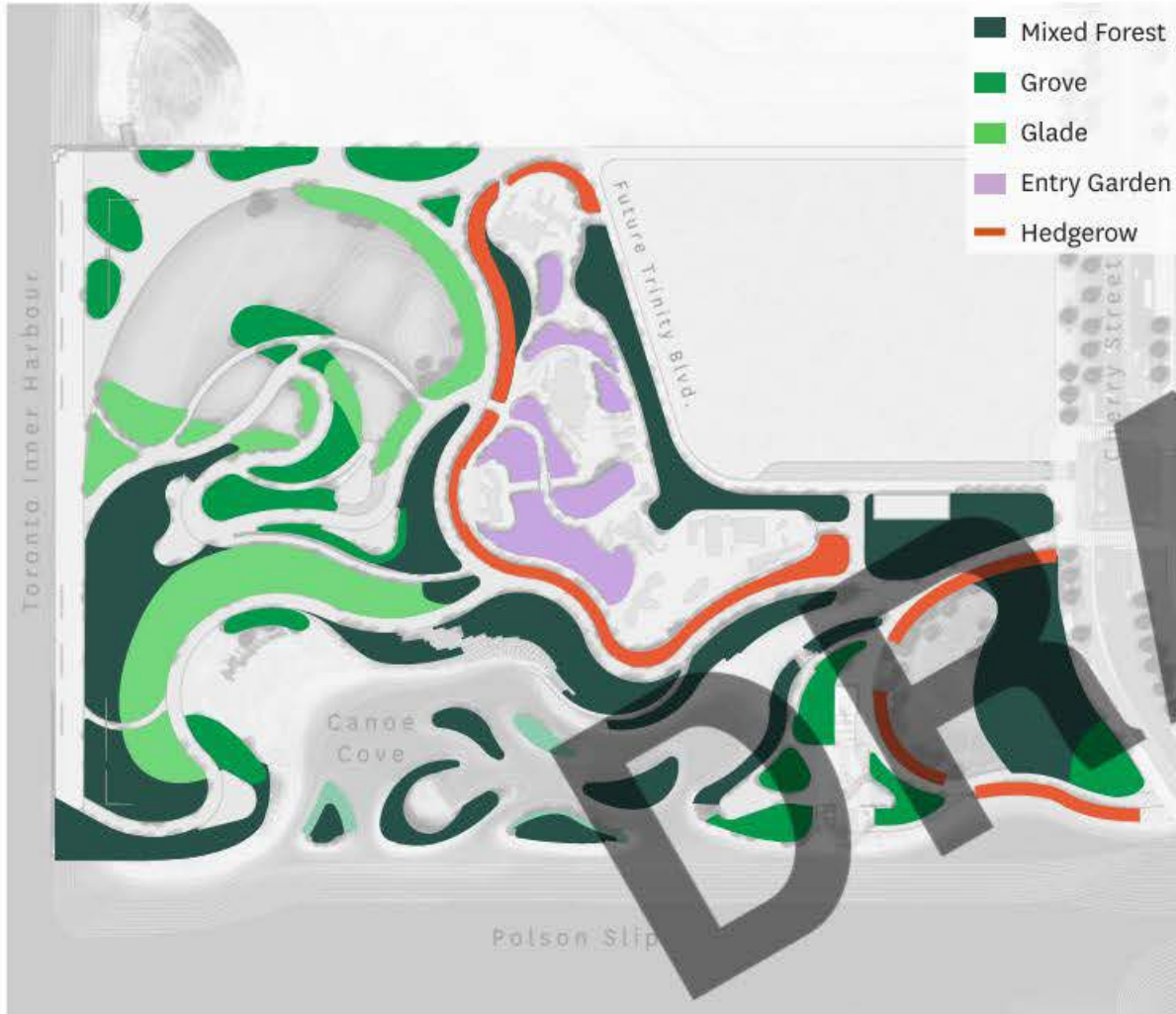

Vegetation Types

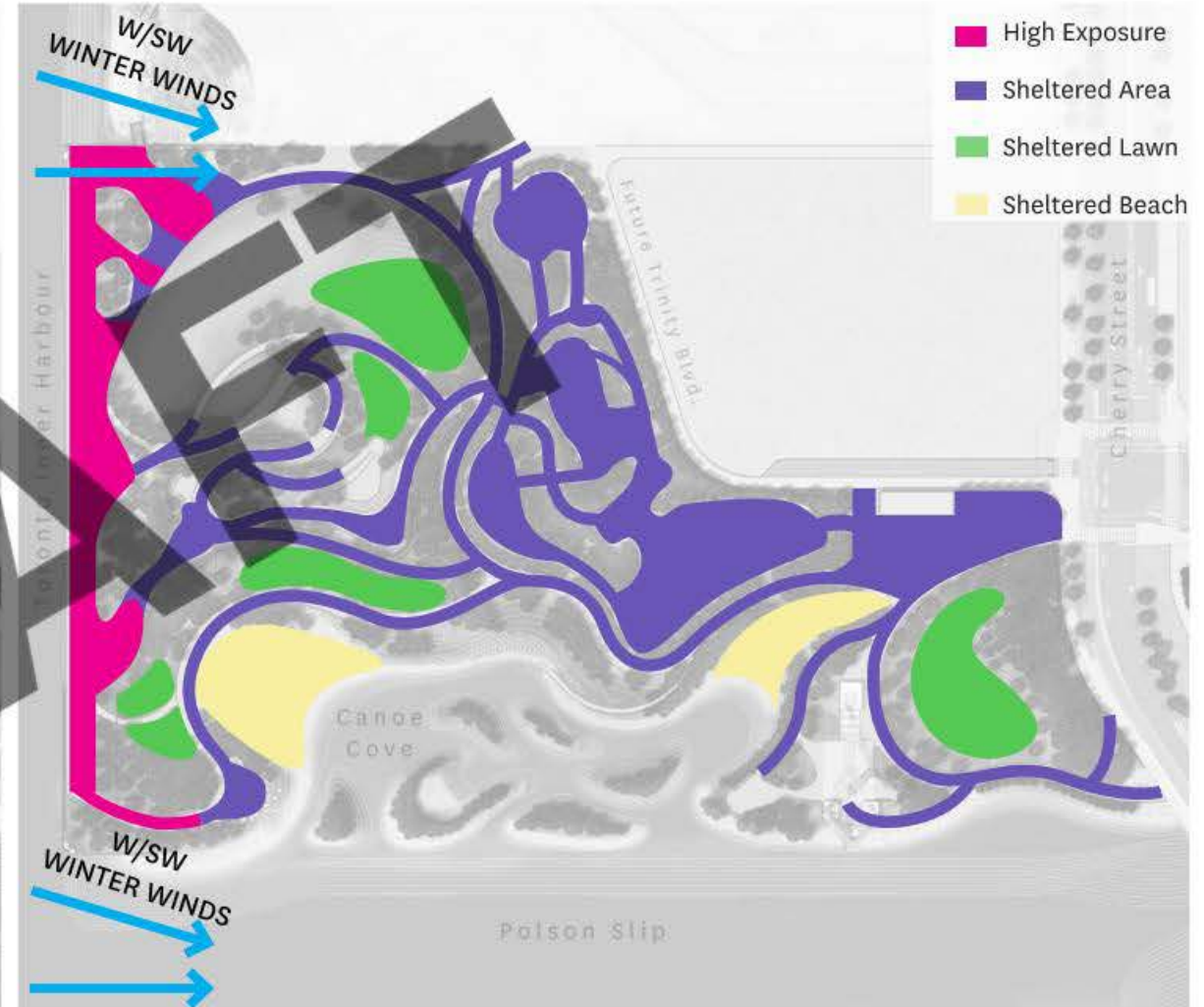

Wind Comfort



Updated Design - February 2020



Canoe Cove to Esplanade Site Section

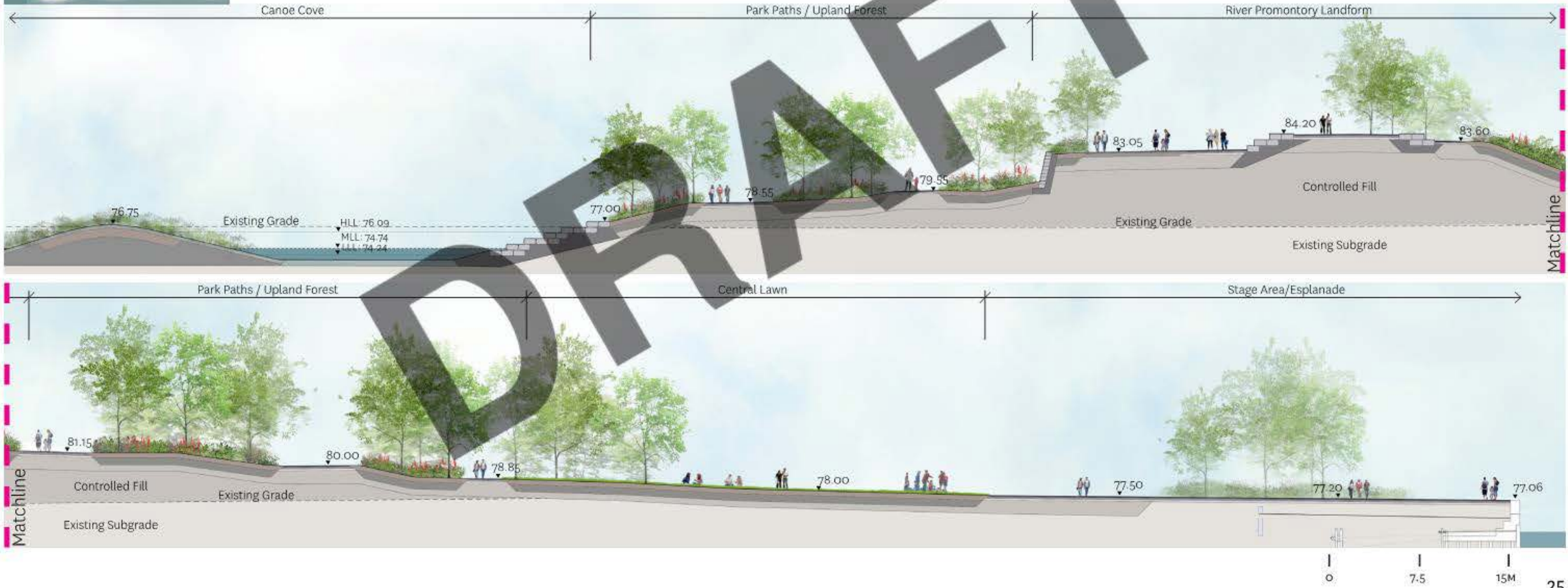

Esplanade to Centre Street Site Section

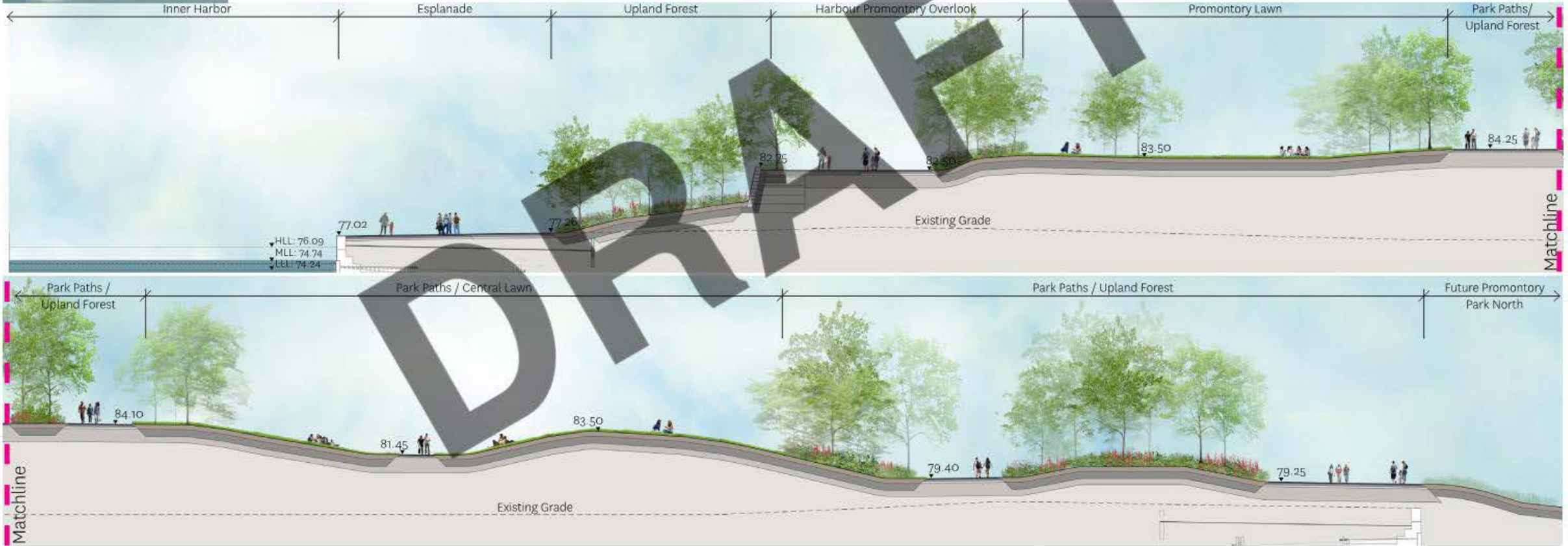

View from Centre Street looking Southwest towards Central Lawn



View from Central Lawn looking Northwest towards Downtown Toronto



View from Cherry Street Park Entrance looking Southwest towards Canoe Cove



View from Polson Slip Overlook looking Northwest to Harbour Promontory



Connecting to the Larger Project Context

DRAFT

Bringing The Don River Valley to the City

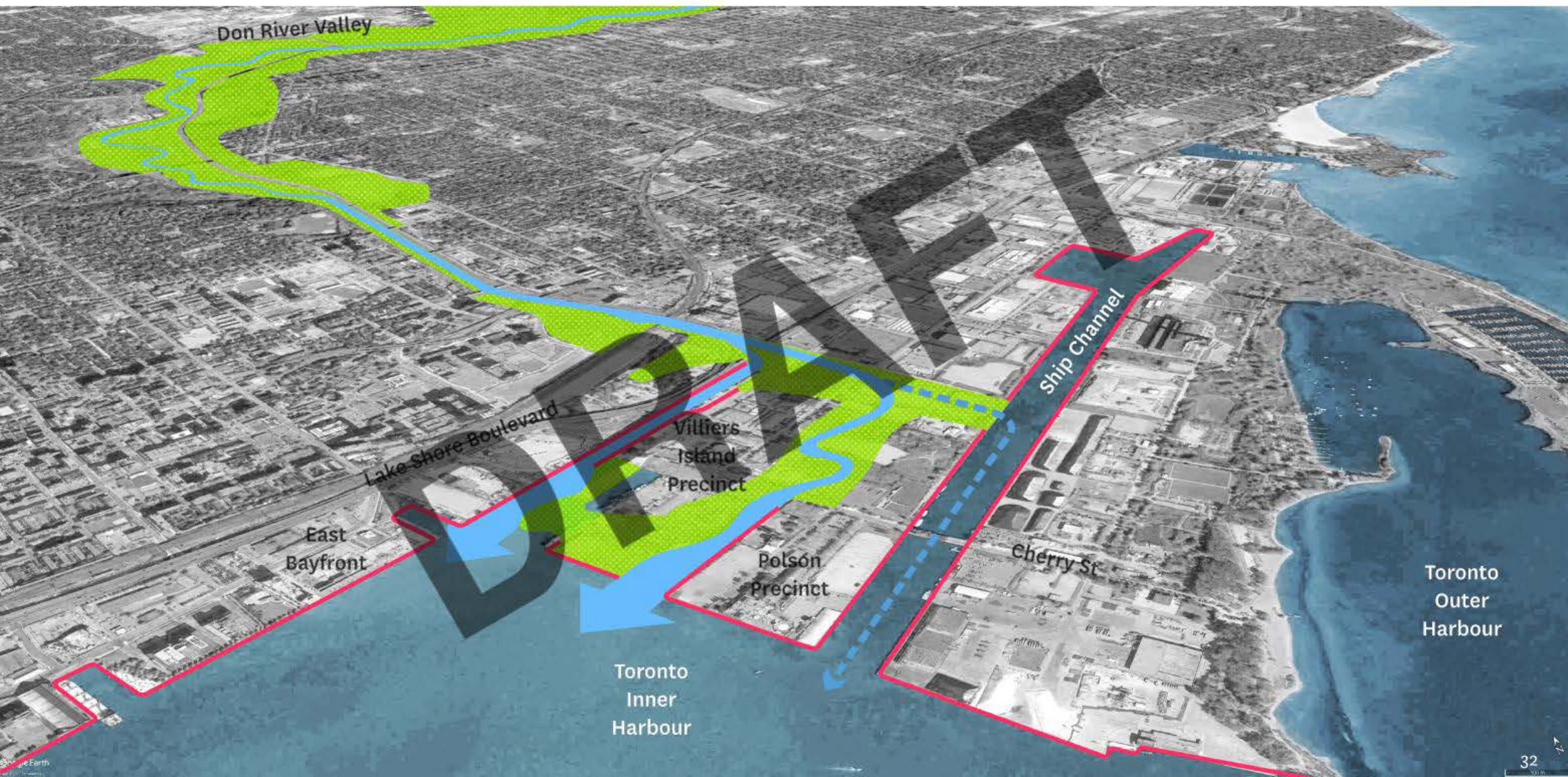

Don River Valley

East Bayfront

Lake Shore Boulevard

Villiers Island Precinct

Polson Precinct

Cherry St

Ship Channel

Toronto Inner Harbour

Toronto Outer Harbour

Constructing an Urban River Park

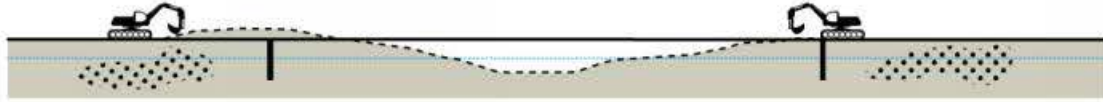

1. Earthworks + Remediation



2. Engineering + Armoring



3. Systems Ecologies



4. Human Landscapes (Program)



5. Urban Massing

Framing a Comprehensive Park Program

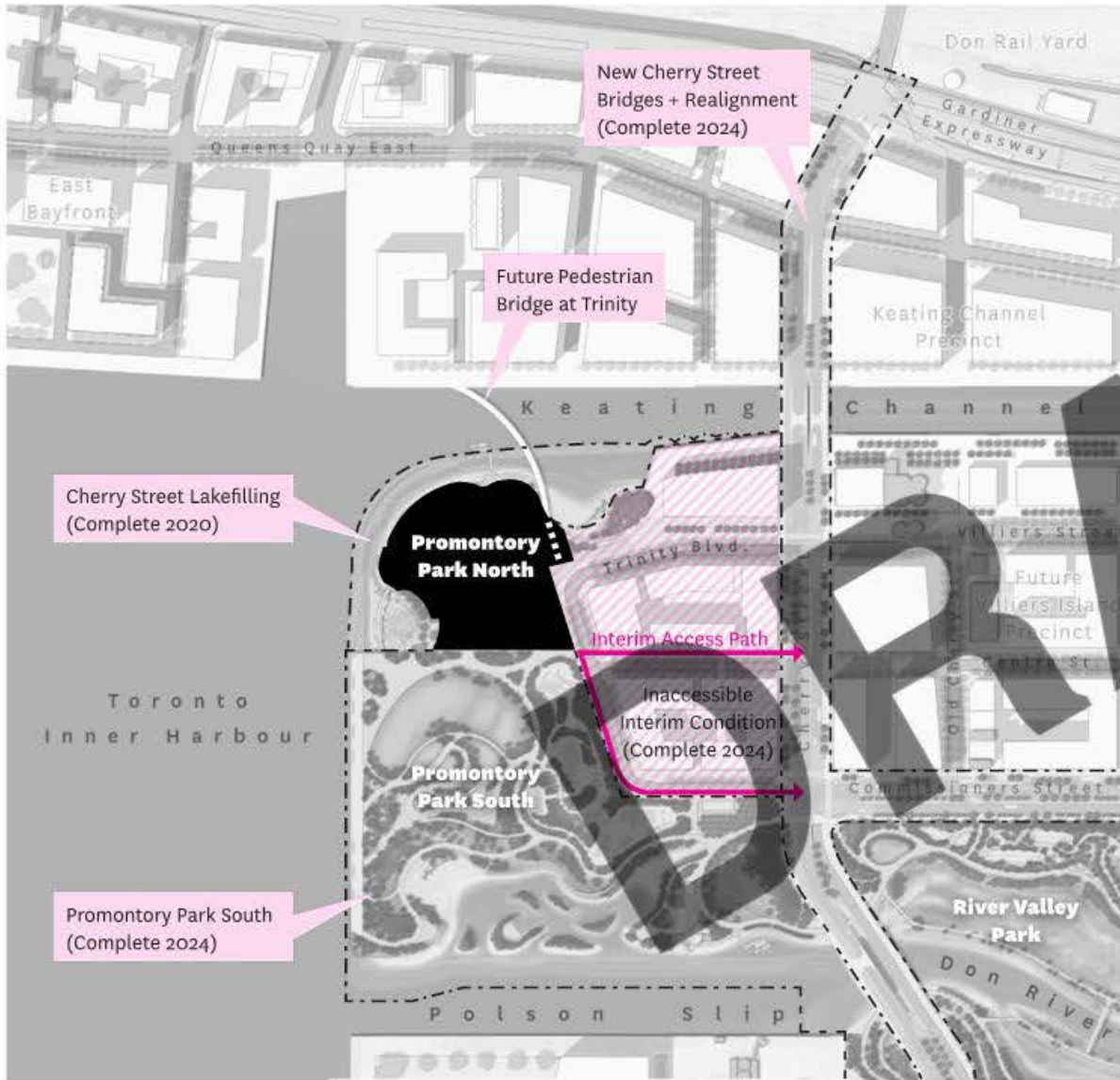

2024



Full Vision



Park Programming Types - 2024

- Playscape
- Dogs Off Leash Area
- Overlook
- Picnic Area
- Urban Promenade
- Plaza
- Event Lawn
- Passive Use Lawn
- Rocky Edge
- Submergent Marsh
- Emergent Marsh
- Vernal Pool
- Planted Armour Stone
- Wooded Upland
- Gravel Beach
- Canoe/Kayak Access
- Bird Watching
- Overlook
- Eco Education / Interpretation
- Fishing Node
- Nature Exploration
- Nature Trail
- Snowshoeing
- Cross Country Skiing



Envisioning a Park with Year Round Programming



Fire Pits



Event Lawn



Kids Camps



Water Recreation



Destination Play



Picnic Area



Cross Country Skiing



Nature Play



Lawns

An Integrated Network of Paths and Trails

- Main Park Path: 5-6m
- Secondary Park Path: 3-4m
- Recreational Trails: 2.8m
- Lower Don Trail: 3.6m
- Commuter Bike Lane: 2m
- Martin Goodman Trail: 4m
- Interim Paths: 4m
- City Sidewalks: 3-5m

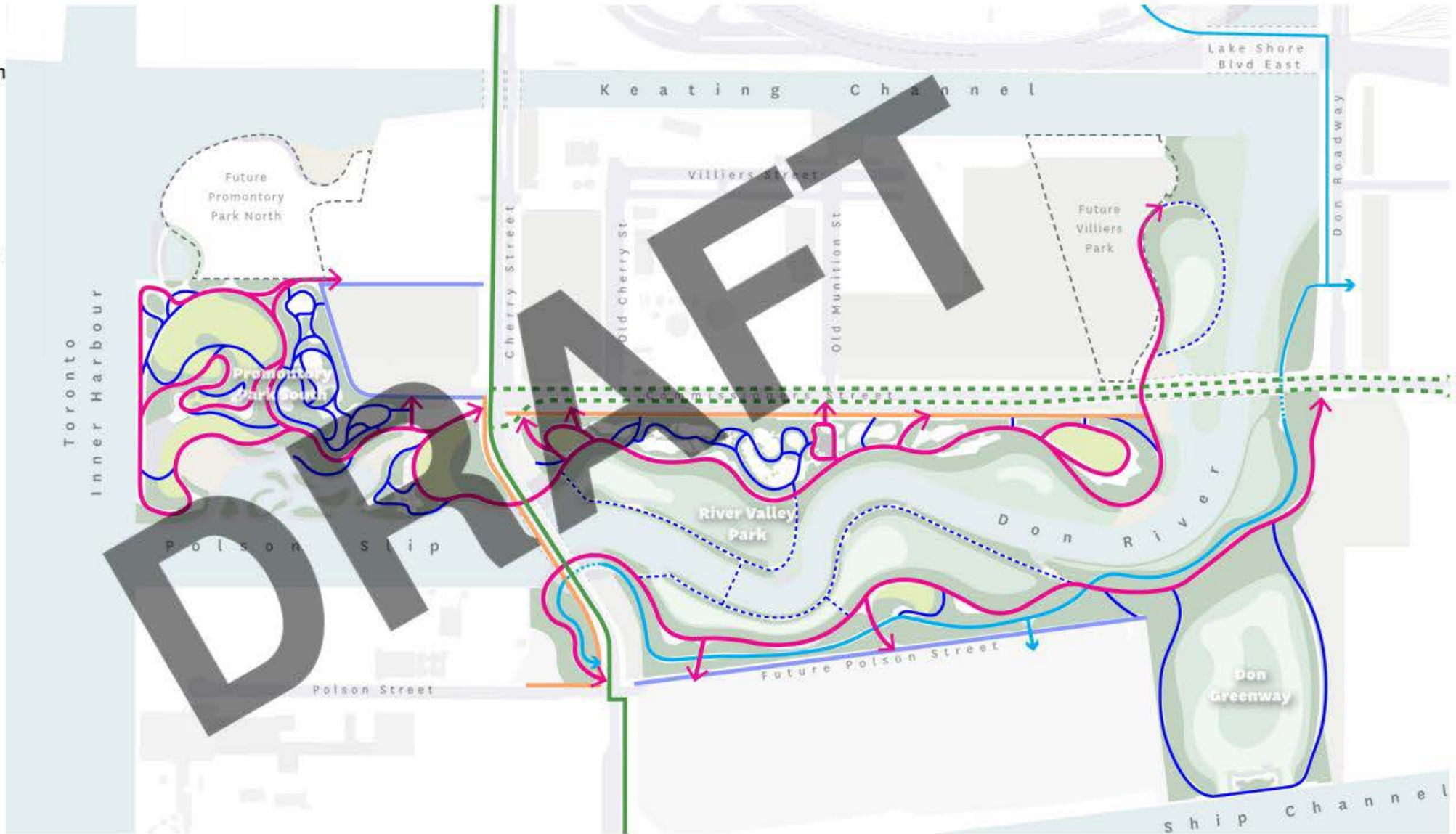

River Valley and Forest Frame



Creating a Park within the Forest Frame

- Mixed Forest
- Grove
- Glade
- Entry Garden
- Lawn
- Floodplain
- Hedgerow

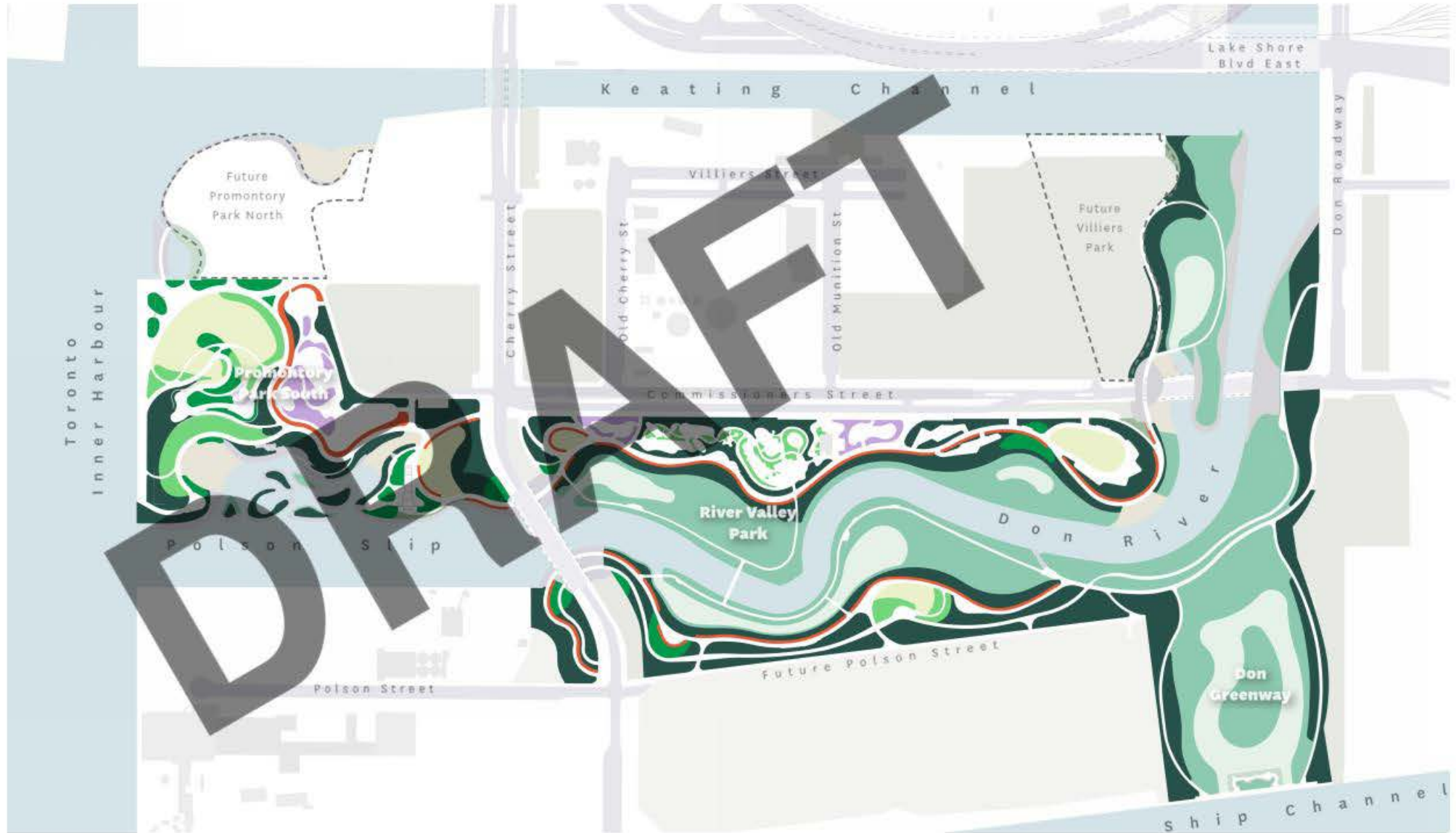

A Range of Landscape Experiences

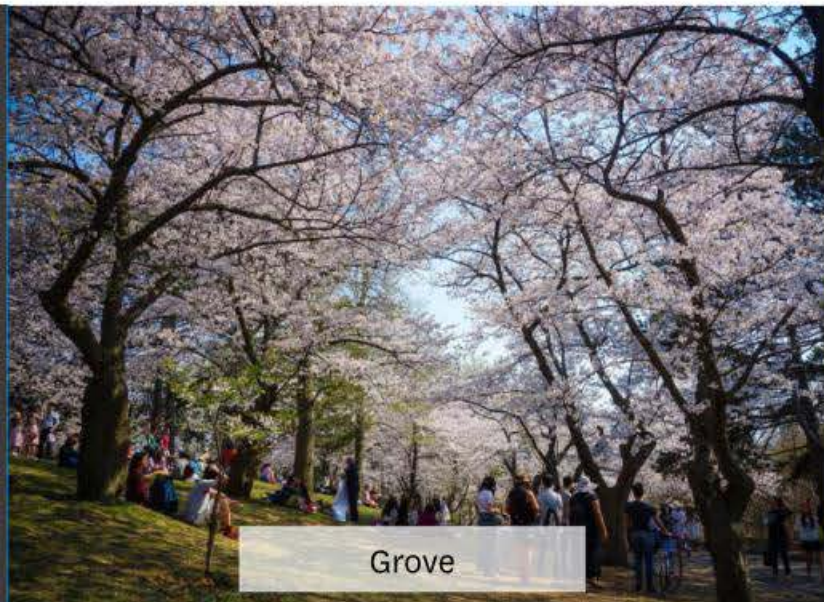

Grove



Glade

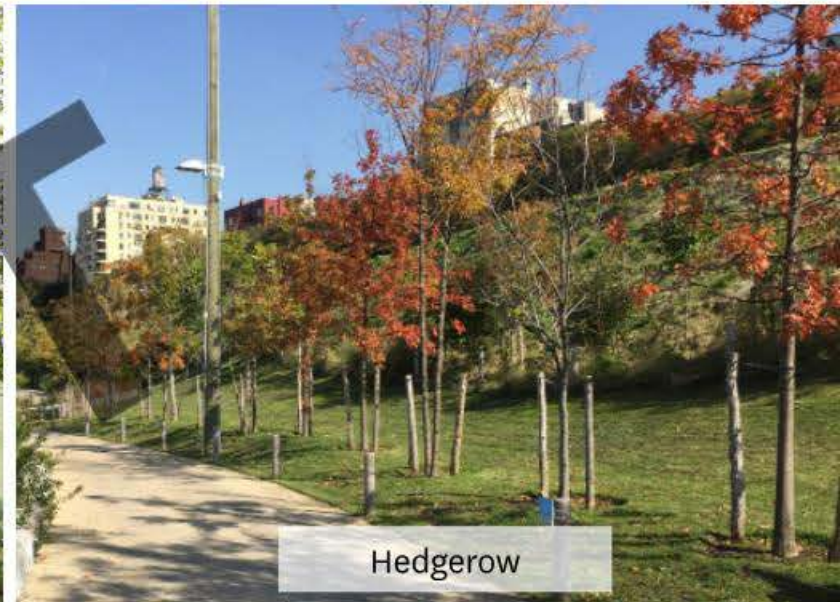

Hedgerow



Entry Garden

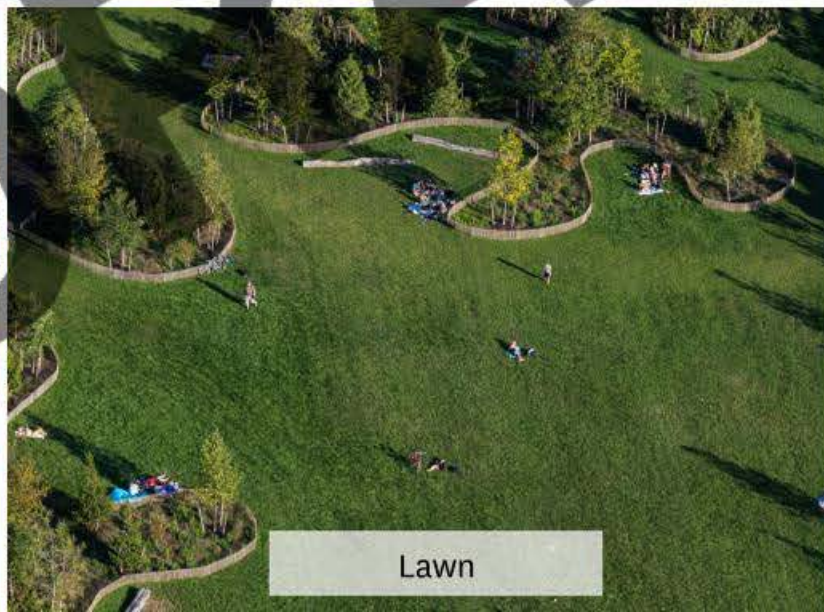

Lawn



Mixed Forest

