

MARTIN GOODMAN TRAIL – Ontario Place Landscape Master Plan and Detailed Trails Design

January | 24 | 2008

Public Open House # 1



INTRODUCTION: The Team



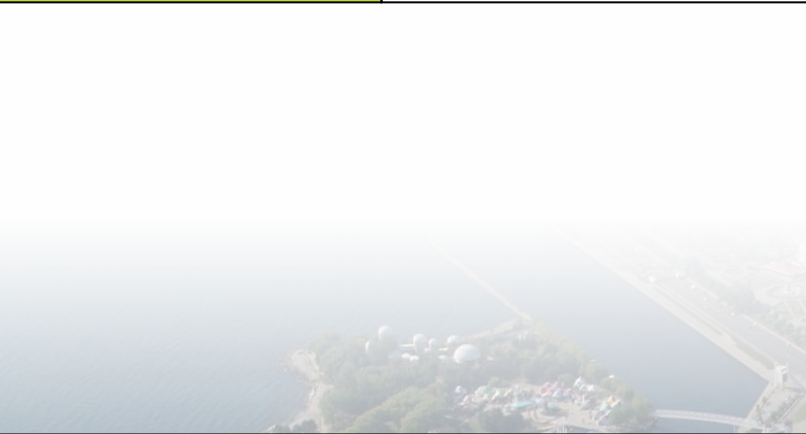

Janet Rosenberg + Associates

Office for Urbanism

BA Consulting Group Ltd.



PROJECT LEAD
Landscape Architecture + Urban Design



Planning + Urban Design
+
Public Consultation

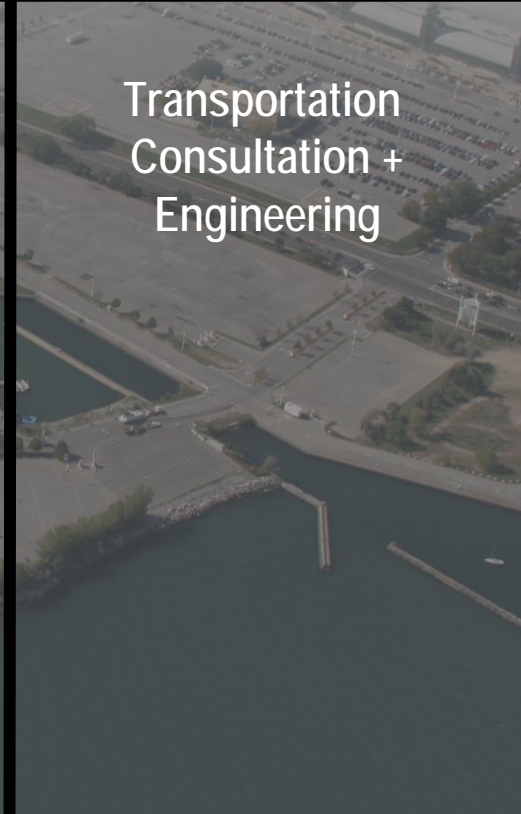

Transportation
Consultation +
Engineering

THE PROCESS: Project Scope



| | | | | | | | | | | | | | | |
|------|-----|-----|-----|-----|-----|-----|-----|-----|-----|------|-----|------|-----------|------------------|
| Sept | Oct | Nov | Dec | Jan | Feb | Mar | Apr | May | Jun | July | Aug | Sept | Oct - Dec | Mar – May - 2009 |
|------|-----|-----|-----|-----|-----|-----|-----|-----|-----|------|-----|------|-----------|------------------|

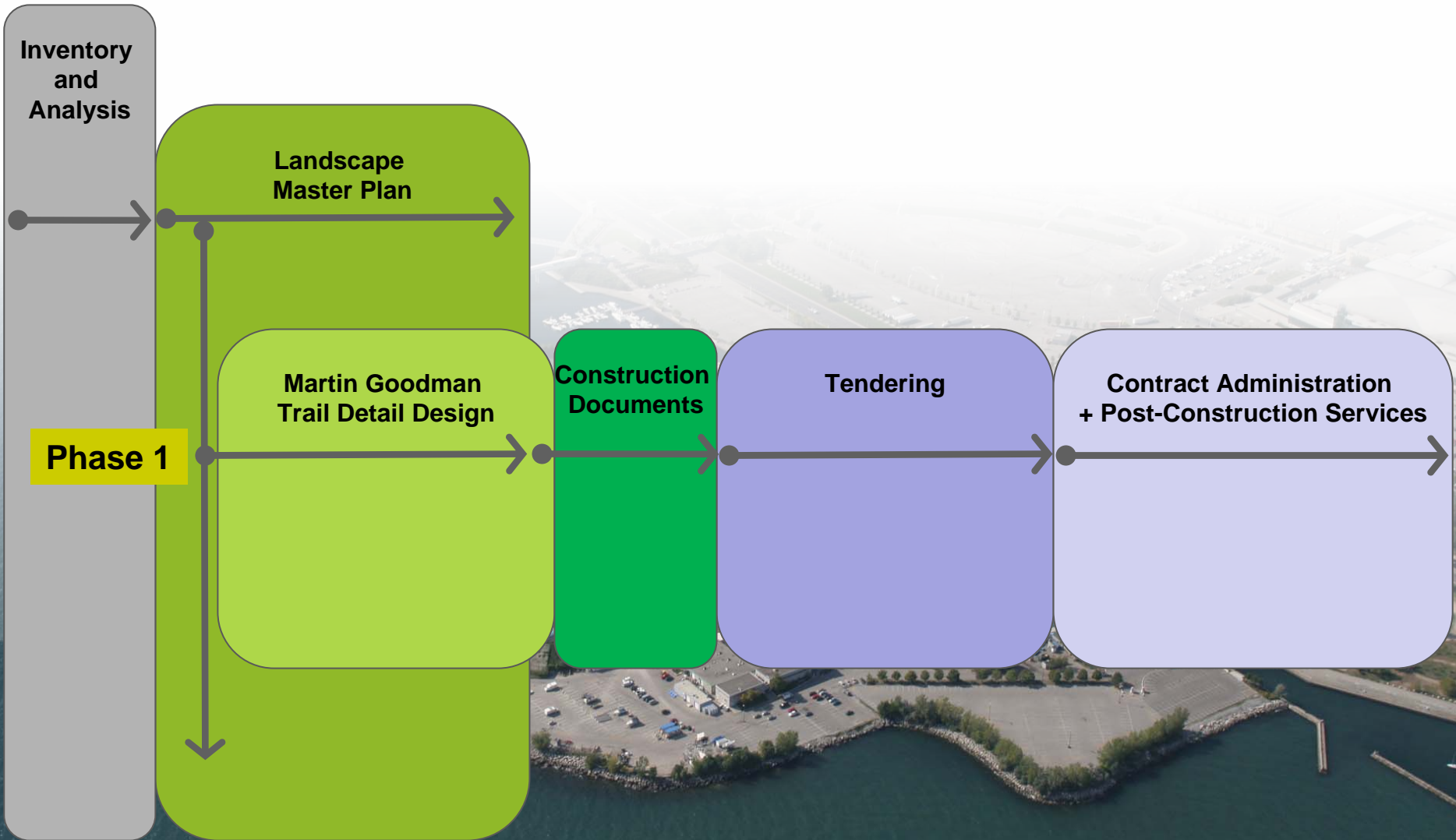

| | | | | | | | |
|------|-----|-----|-----|-----|-----|-----|-----|
| Sept | Oct | Nov | Dec | Jan | Feb | Mar | Apr |
|------|-----|-----|-----|-----|-----|-----|-----|

Stakeholder Interviews

- Waterfront Regeneration Trust
- City of Toronto Parks, Forestry and Recreation
- City of Toronto, Transportation
- Exhibition Place
- West 8 – Central Waterfront consultants
- Grand Prix
- Councillor Joe Pantalone
- Toronto Cycling Advisory Committee

Public Open Houses

Jan 24

spring

Steering Committee Meetings

Waterfront Toronto – Design Review Panel

Ontario Place Board Meetings

OBJECTIVES:



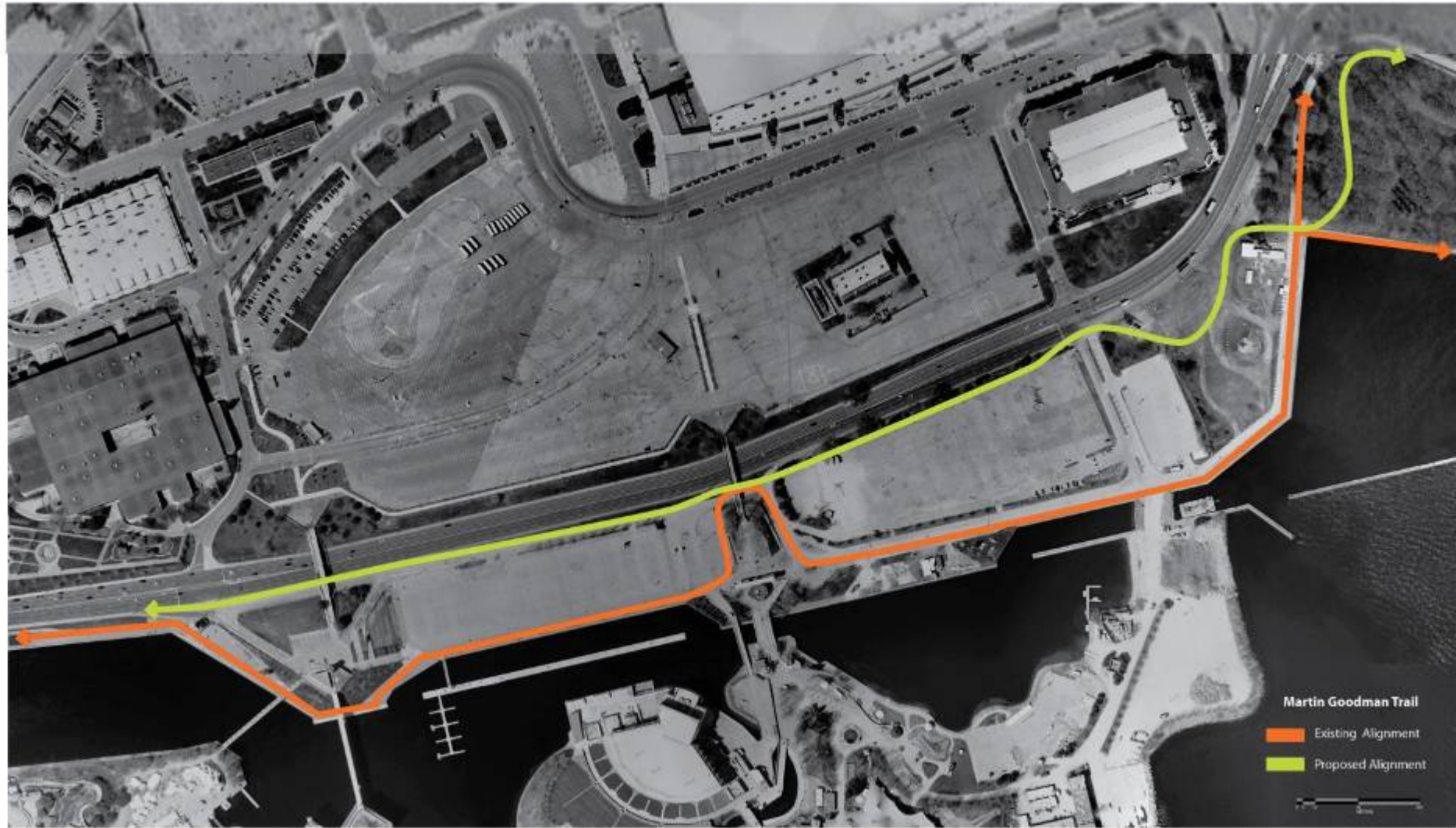

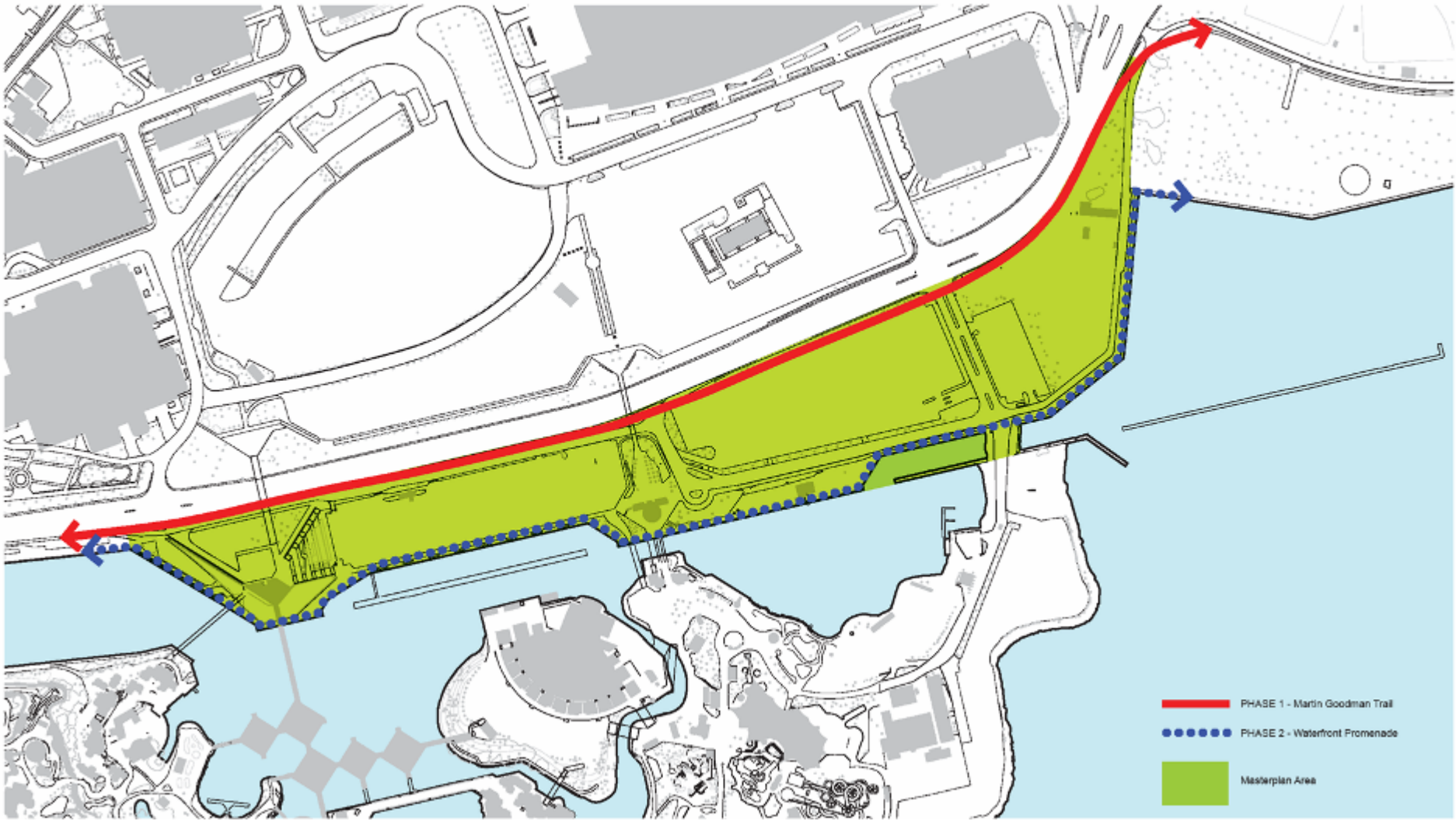

Objectives

- To **establish a connection** for the Martin Goodman Trail across Ontario Place, between Marilyn Bell Park and Coronation Park
- To provide a Landscape Master Plan that **enables the design and construction of the Martin Goodman Trail** in front of Ontario Place, as a multi-use recreational trail
- To provide a Landscape Master Plan Concept that enables the **future design and construction of a waterfront trail**
- To **improve safety**, by reducing the points of conflict between vehicles, pedestrians, and cyclists and by improving the access and configuration of parking lots, servicing and drop-offs
- To propose a **phasing** strategy
- To **engage the public and stakeholders** through the stages of analysis and design

Additional Opportunities and Considerations for the Landscape Master Plan

- To use the redesign of the MGT to **improve the image, identity and character of Ontario Place**
- To improve Ontario Place's **access and parking**
- To **increase and improve the public realm**
- To maintain the site's ability to engage large scaled **events**, and the event-based closure of Lakeshore

PRECEDENTS:



place a dot on your favorite images









ANALYSIS:



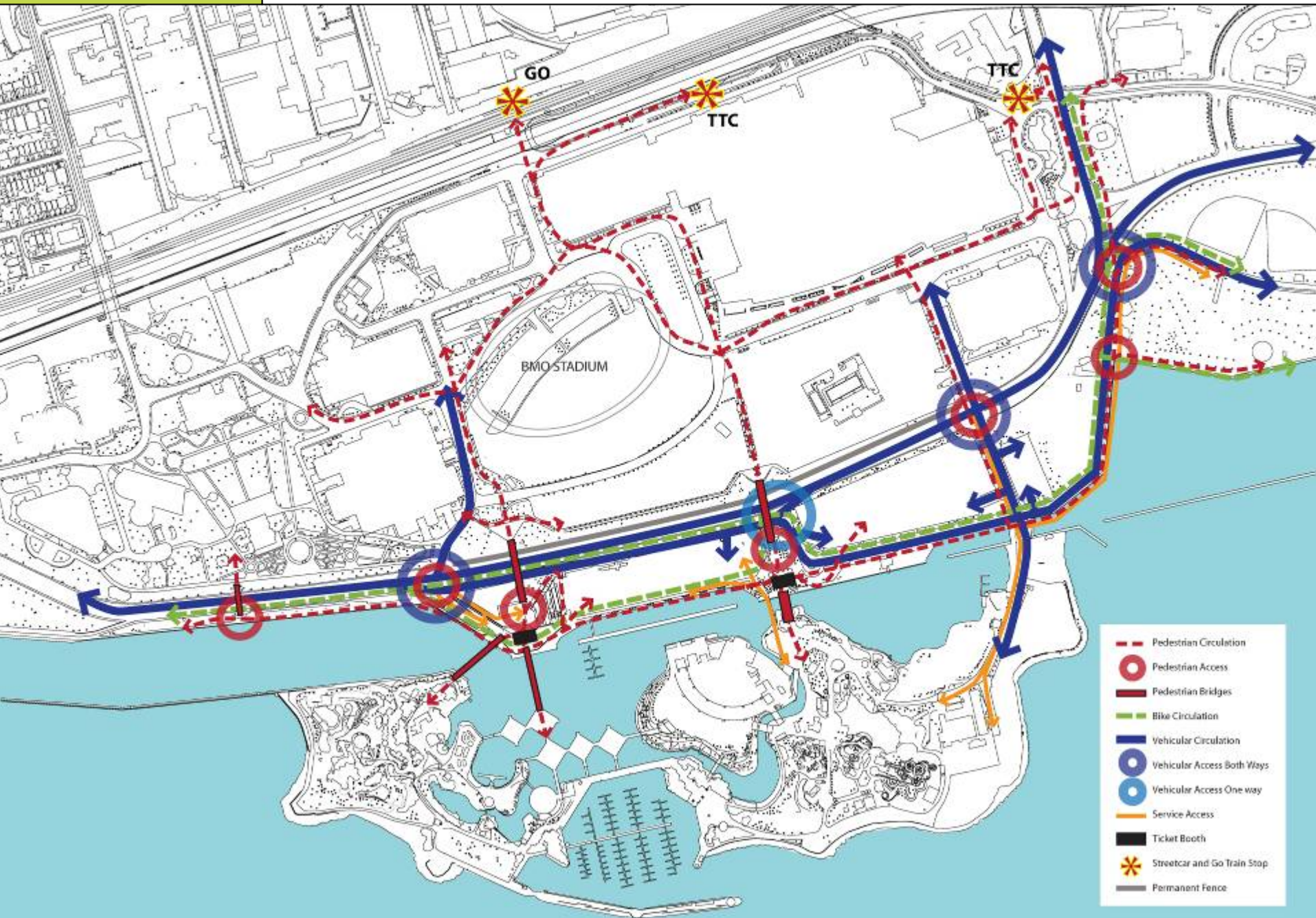

- Pedestrian Circulation
- Pedestrian Access
- Pedestrian Bridges
- Bike Circulation
- Vehicular Circulation
- Vehicular Access Both Ways
- Vehicular Access One way
- Service Access
- Ticket Booth
- ★ Streetcar and Go Train Stop
- Permanent Fence

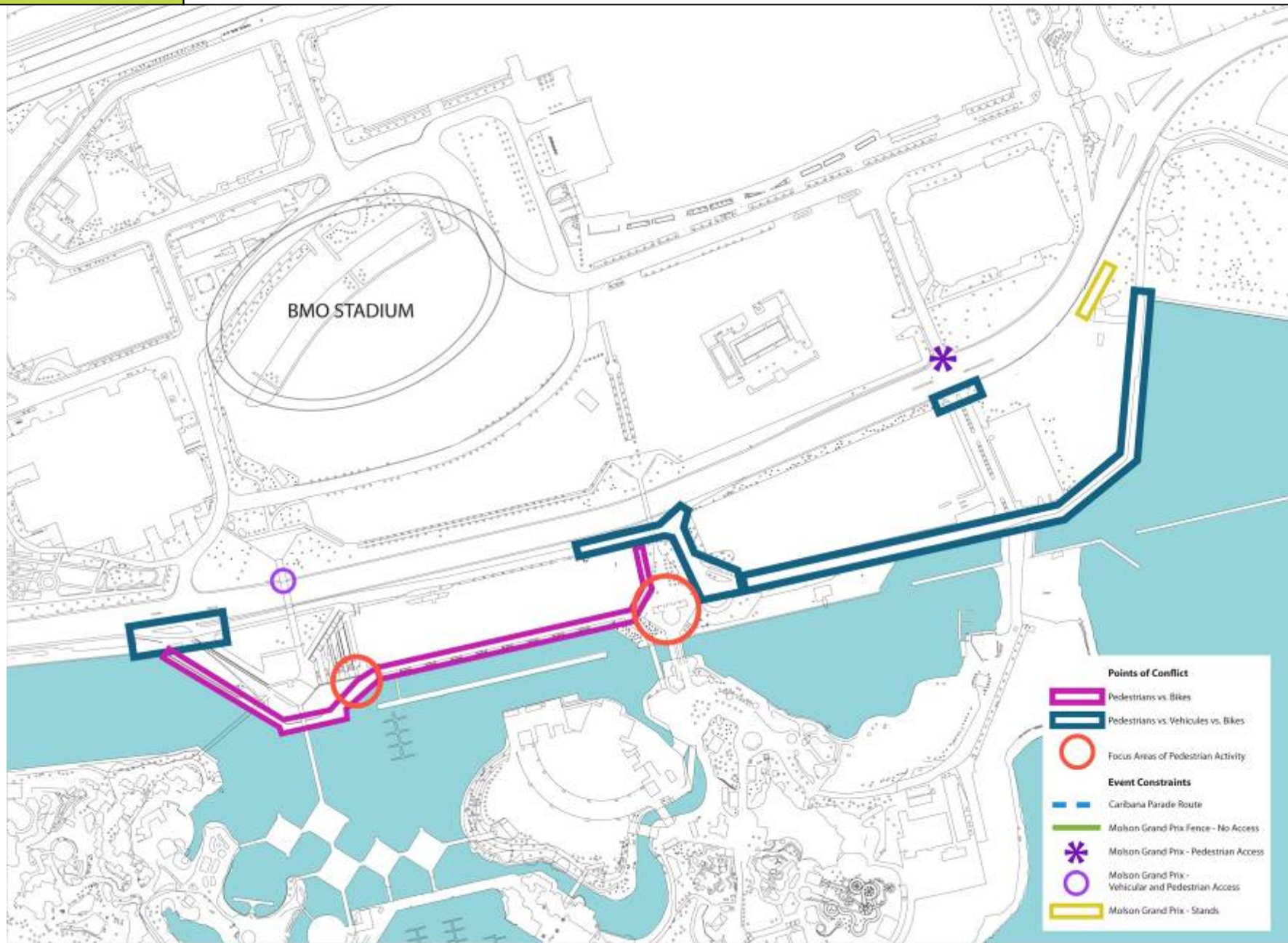

- Points of Conflict**
-  Focus Areas of Pedestrian Activity
 -  Pedestrians vs. Bikes
 -  Pedestrians vs. Vehicles vs. Bikes
- Event Constraints**
-  Caribana Parade Route
 -  Molson Grand Prix Fence - No Access
 -  Molson Grand Prix - Pedestrian Access
 -  Molson Grand Prix - Vehicular and Pedestrian Access
 -  Molson Grand Prix - Stands

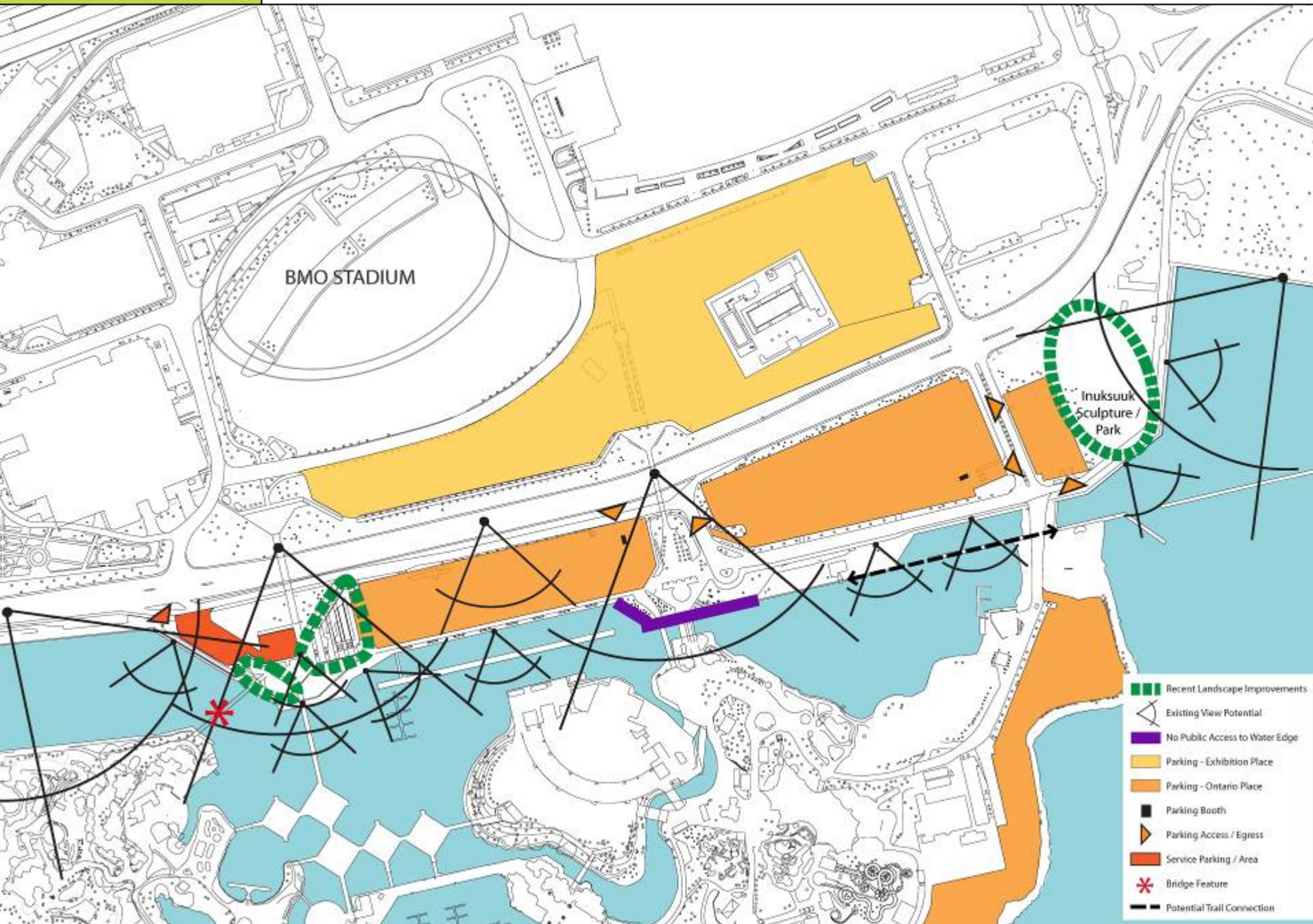

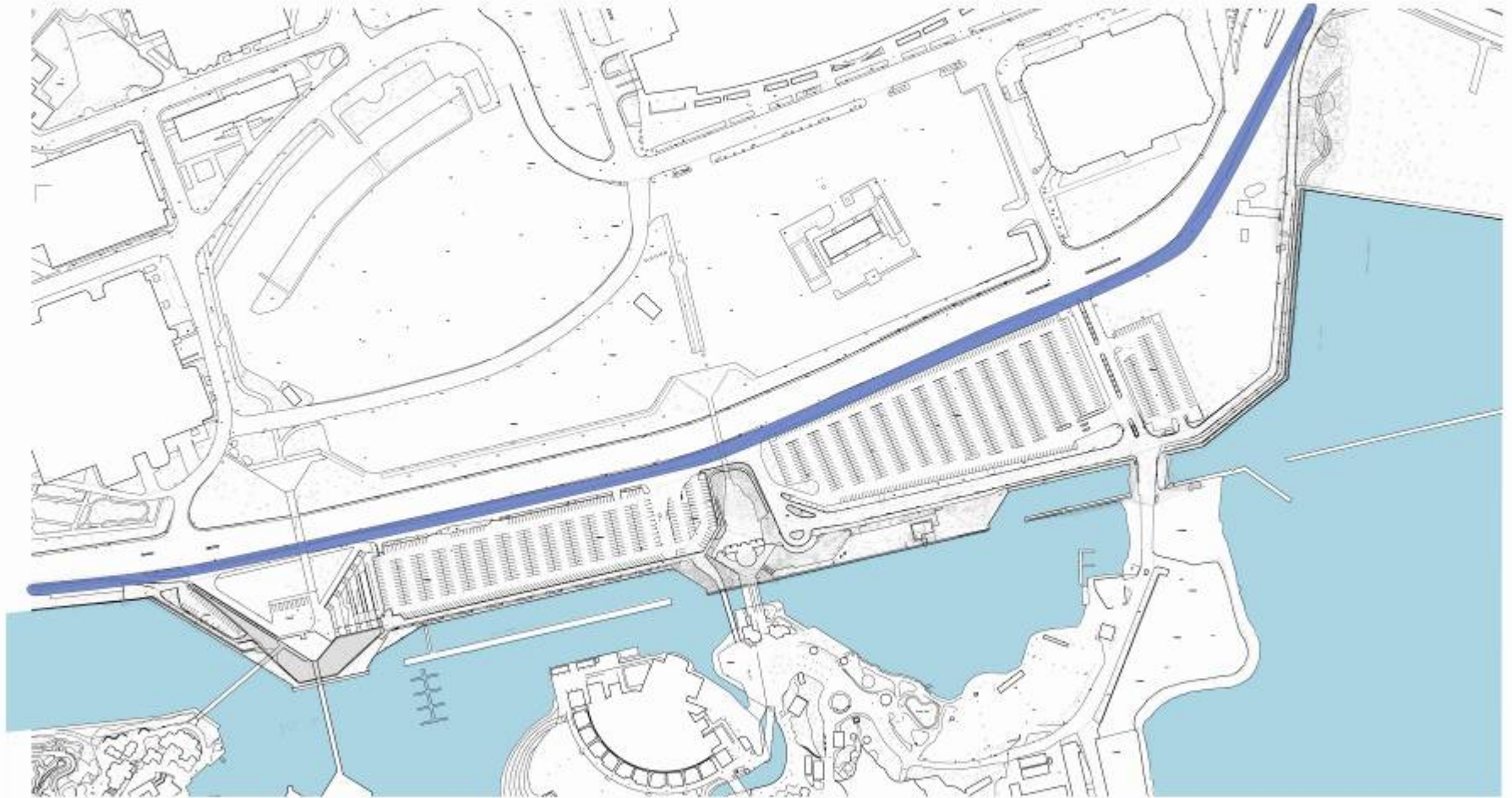

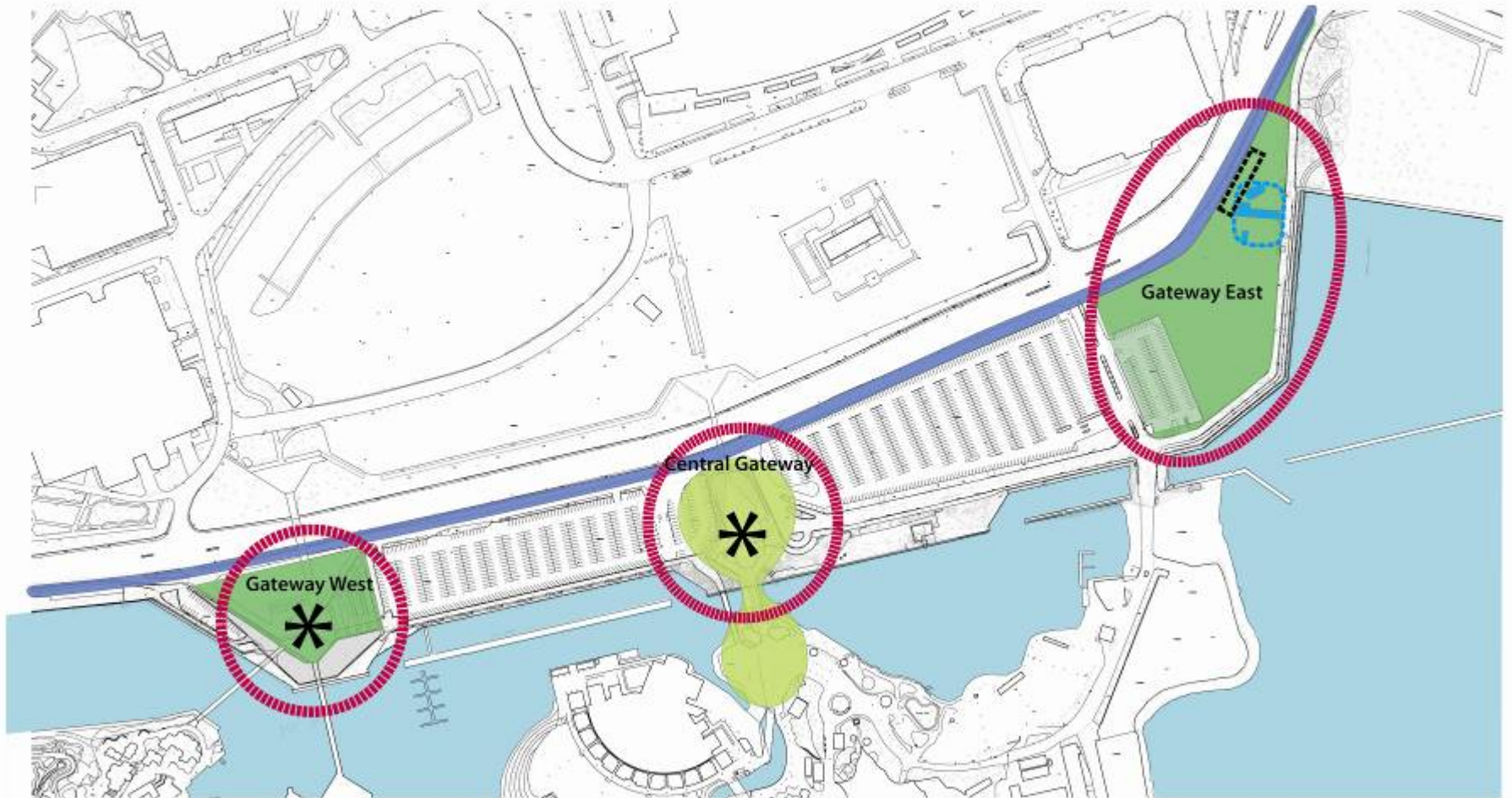



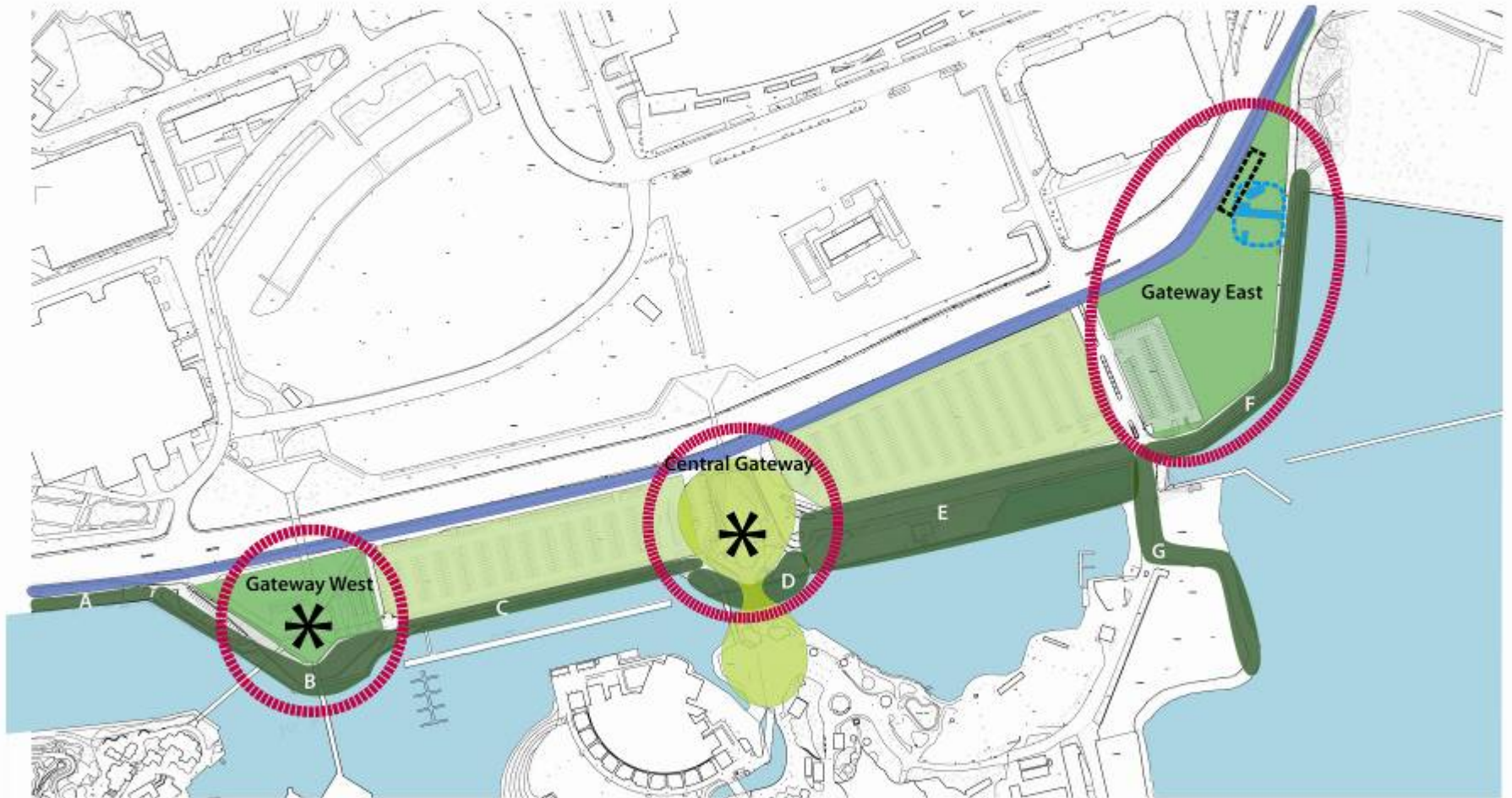

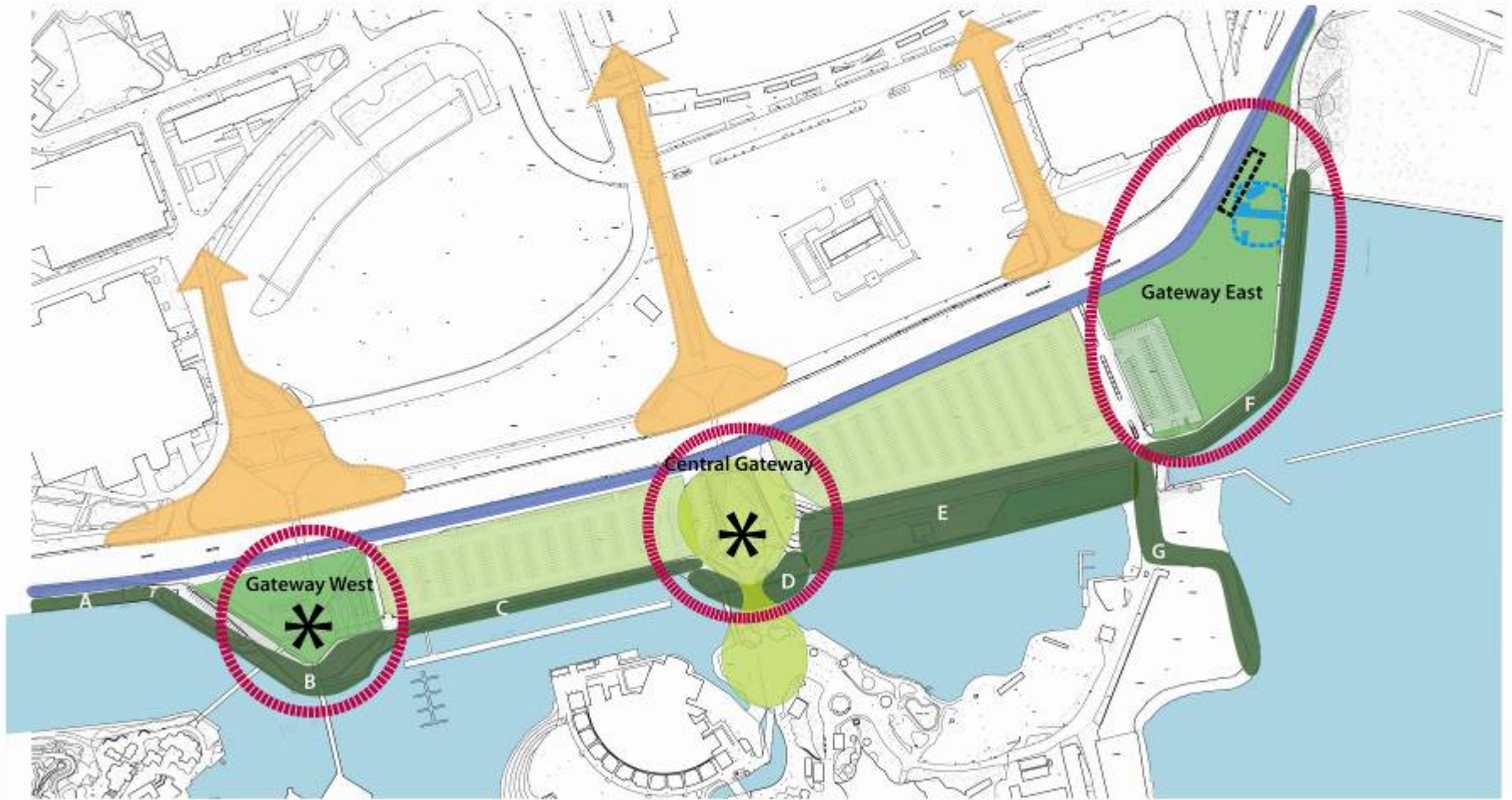

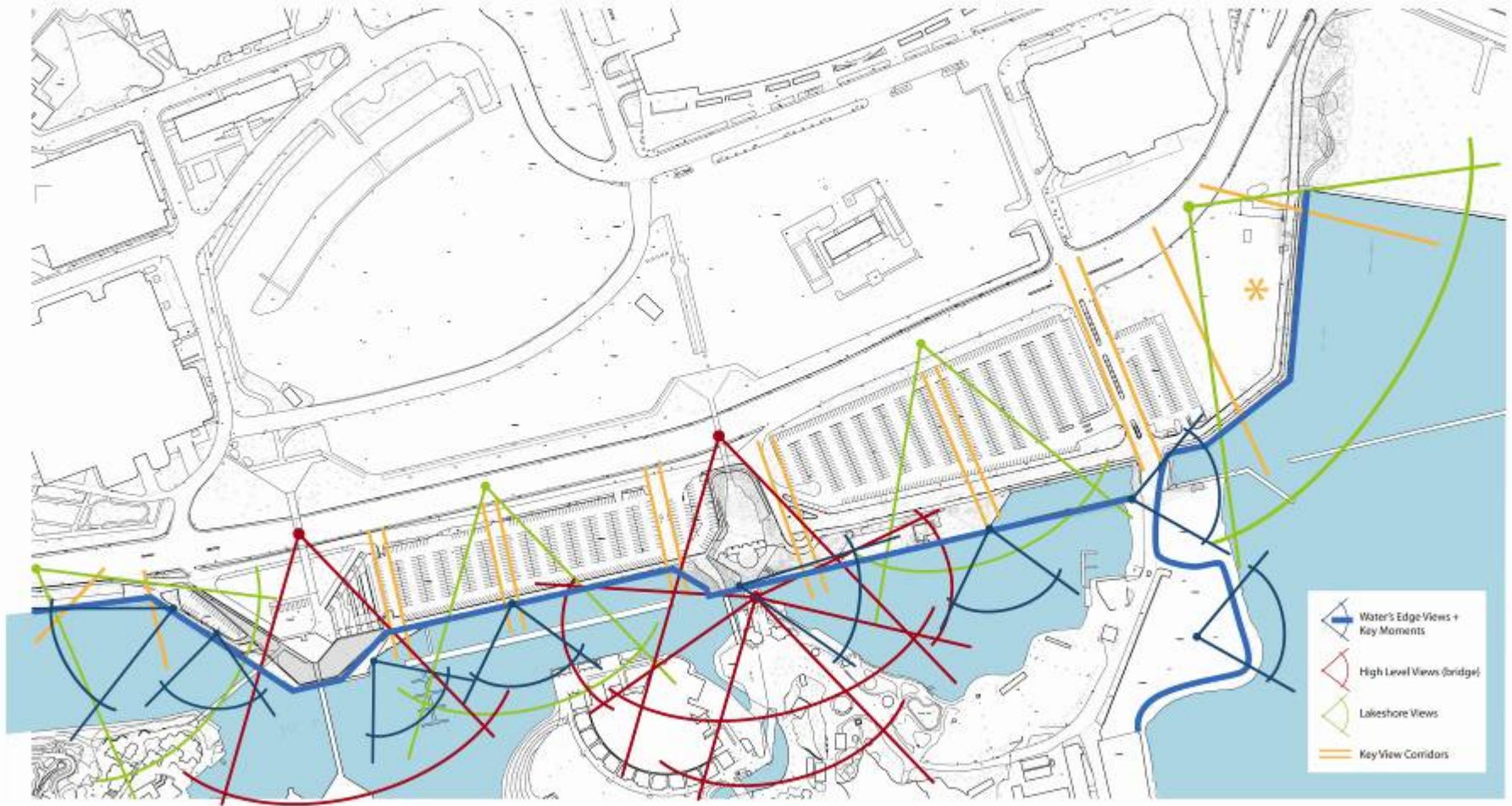



SITE CONFIGURATION

opportunities & trade-offs



Current Conditions

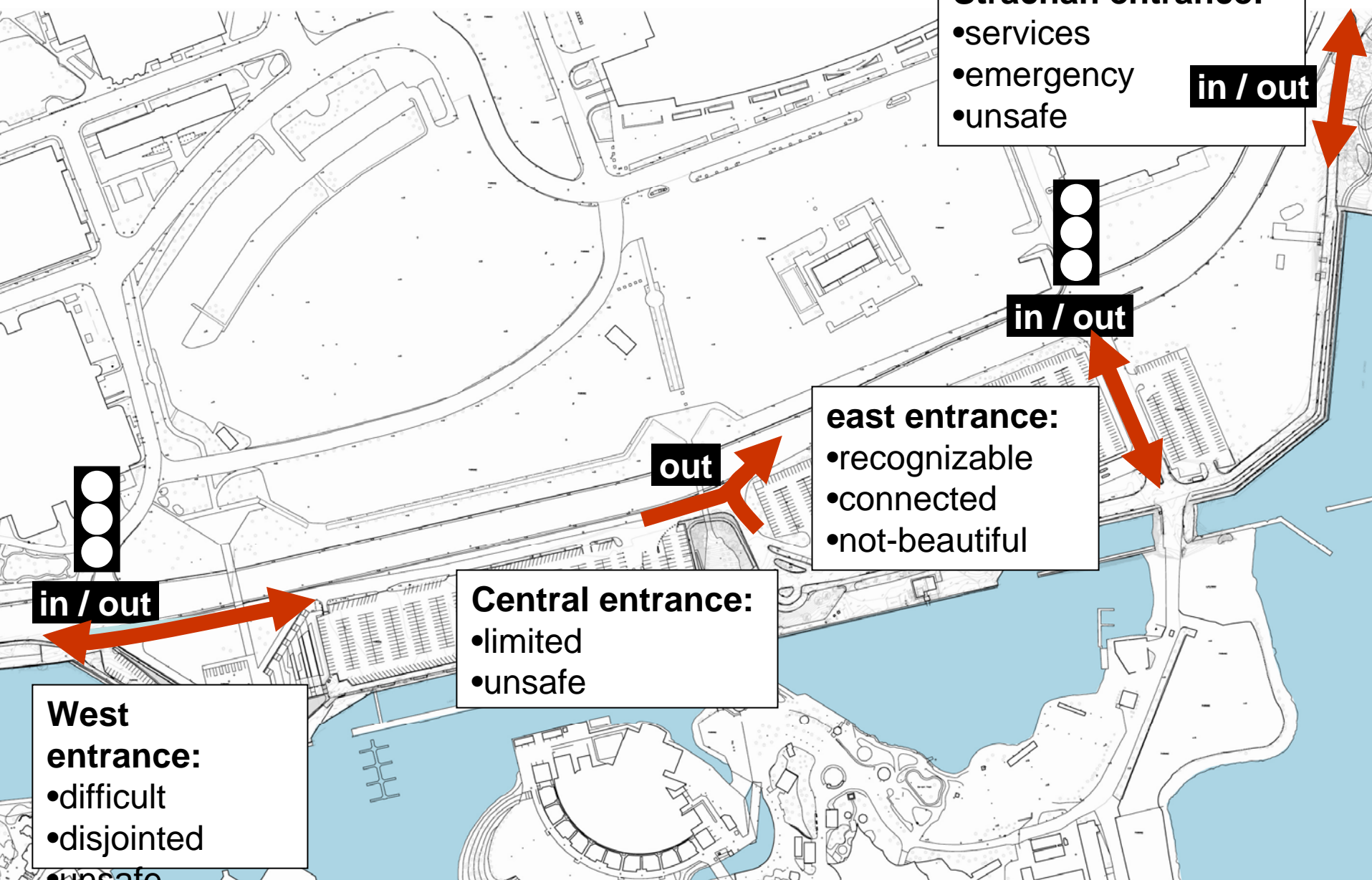

Current Conditions

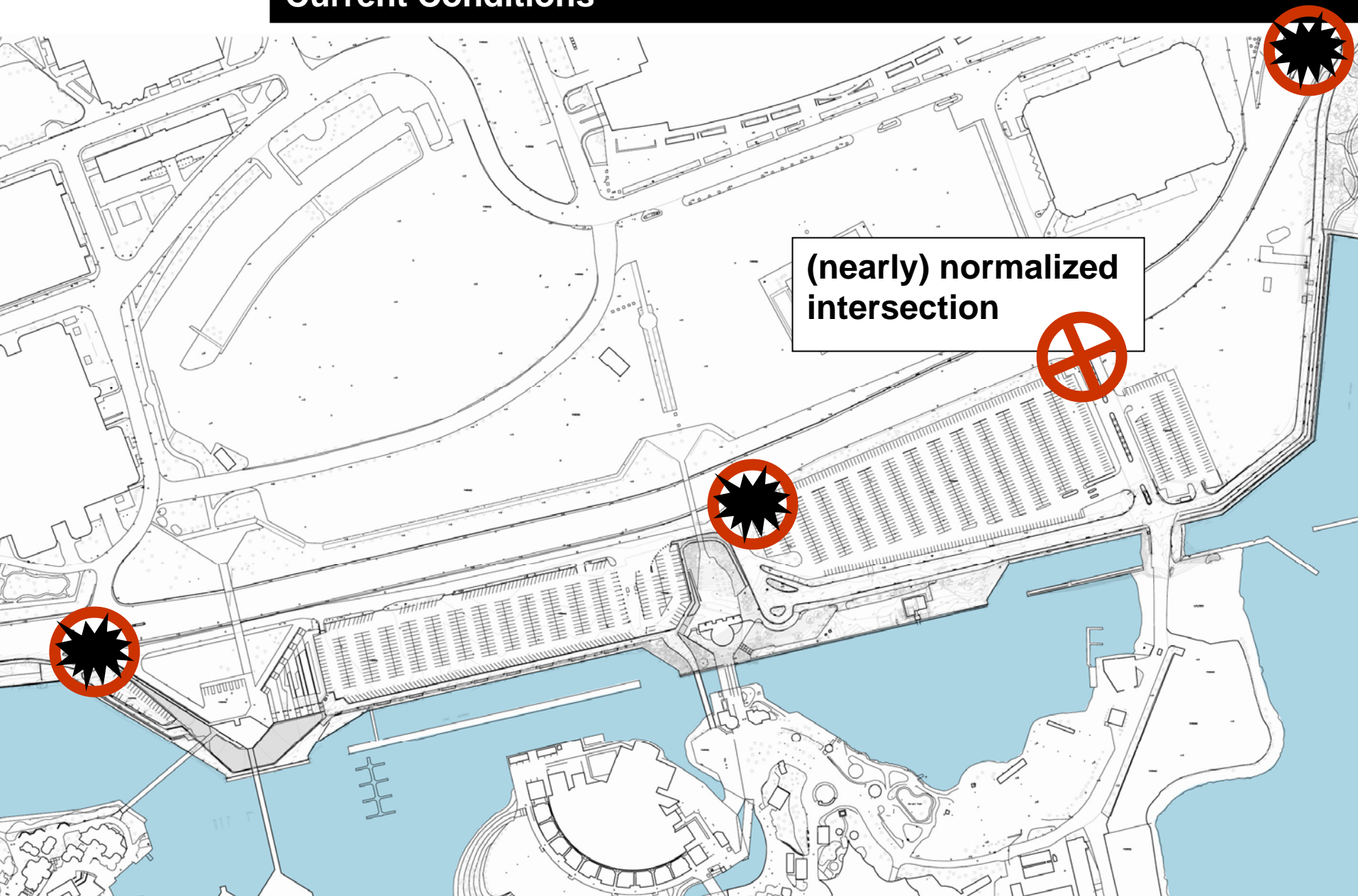

**(nearly) normalized
intersection**

Current Conditions

East/west entrances required for Lakeshore closure (Grand Prix)



Rationalizing the parking = additional open space...

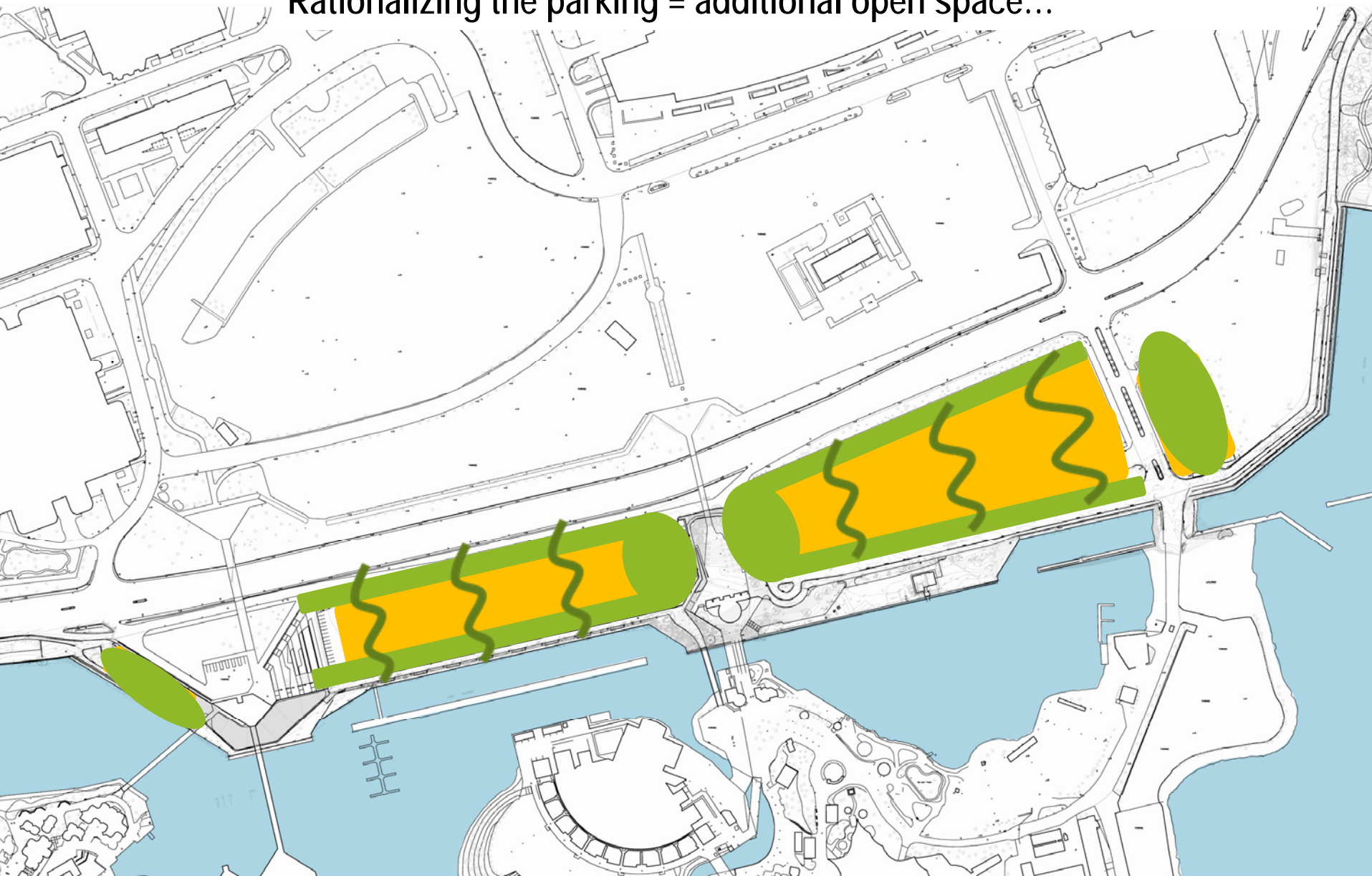

Parking lots need to be connected

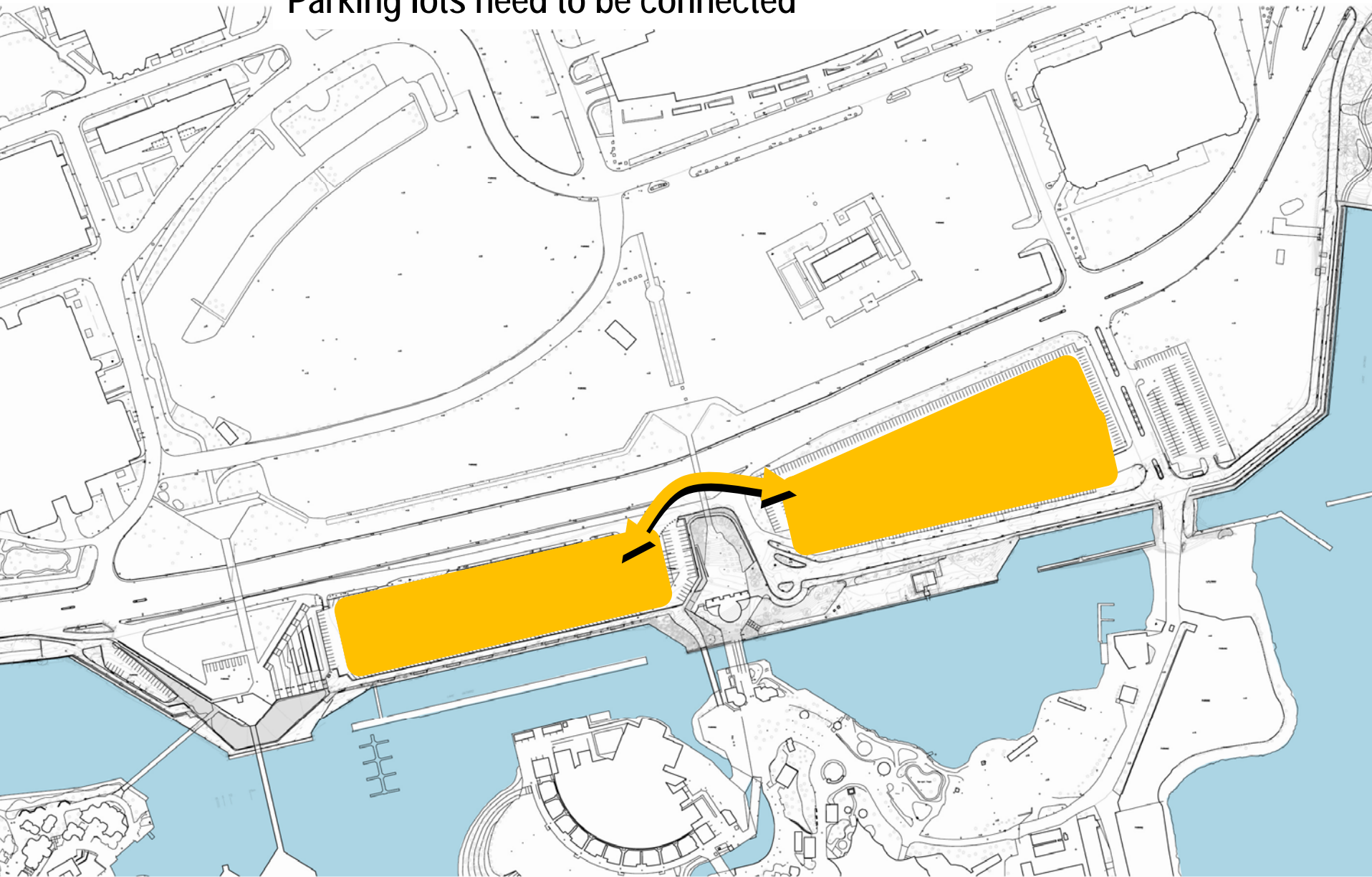

Design



take a post-it and make a comment

West Atlantis Gateway Park

- West gateway feature to Ontario Place with landscape improvements and enhancements
- West entrance to Water's Edge Promenade entrance
- Widened Water's Edge Promenade
- Sitting area with open views to water
- Opportunity for art/gateway treatment
- Revised building/expansion opportunities as gateway feature and improved pedestrian receiving area
- New pedestrian circulation and trail connections
- Increased opportunities for pedestrian use of and access to the Atlantis Gateway

Gathering and Wayfinding Nodes

- Meeting and orienting places along the Water's Edge Promenade with enhanced landscaping that provide places to linger, gather and enjoy the views
- Opportunity for Art/Gateway treatment
- Clear access points to the Water's Edge

Central Plaza Gateway

- Improved and expanded plaza and ticket queuing area
- New water's edge boardwalk under bridges
- Improved trail and landscaping around plaza
- Opportunity for water/art features
- Opened views and access to Water's Edge Promenade

Main Entry + CNE Connection

- Improved landscape entrance and gateway treatment to Ontario Place
- Improved internal intersection and water's edge trail connection
- Water feature opportunities as gateway to Water's Edge Promenade
- Improved parking access and configuration

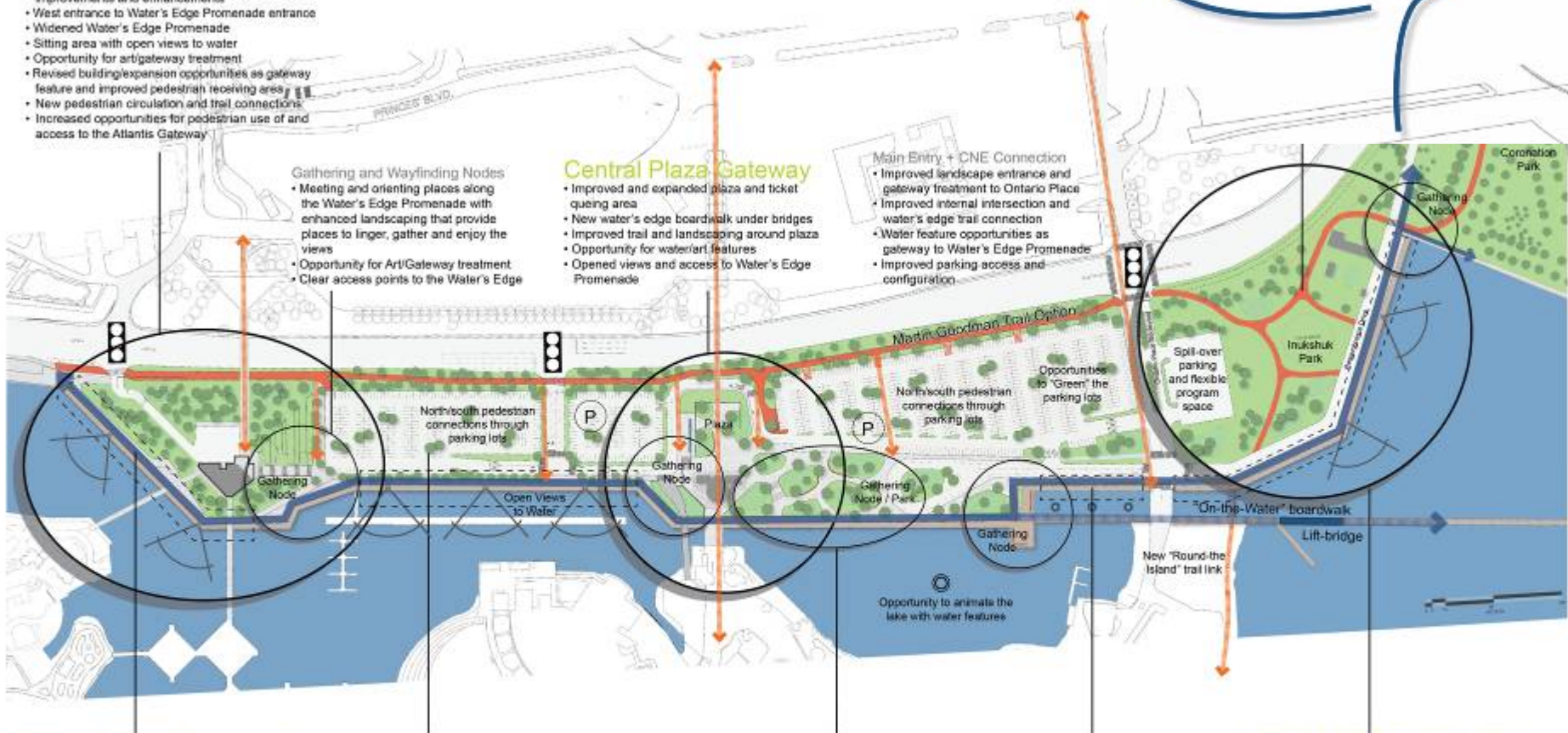

Water's Edge Promenade

- Continuous promenade and boardwalk along the water's edge
- Promenade intersects a series of gathering and wayfinding nodes that have benches, lighting and open views to the water
- Connects to adjacent Martin Goodman Trail System
- Increased opportunities to be and sit at the water's edge and on the water
- Improved landscaped edge to the parking lots

Parking Lots Improvements

- North/south Pedestrian connections through the parking lots with clear views to the water
- Improved vehicular circulation
- Opportunities to "Green" the parking lots
- Improved access from parking lots to the trails
- Opportunity for added pedestrian oriented amenities such as bike lock facilities and signage

Water's Edge Park

- New landscaped expansion of the Central Plaza
- Opportunity for pick-up and drop-off area = configuration based on parking scenario options
- Opportunity to view water features on the lake

Stepped Seating Along The Promenade

- Stepped seating and viewing areas along the Water's Edge Promenade
- Tree planting and landscape enhancements

East Inukshuk Park Gateway

- Landscape and trail improvements to Inukshuk Park as eastern gateway and Water's Edge Promenade
- Opportunity for route MGT through the park
- Re-located spill-over parking and flex space - "Green" surface parking treatment
- New trail connection through Inukshuk Park to "On-the-Water" boardwalk and opportunity to connect to a new "Round-the-Island" trail
- Opportunity for a lift-bridge connection to extend the "On-the-Water" boardwalk experience
- Open views and improved access to water's edge

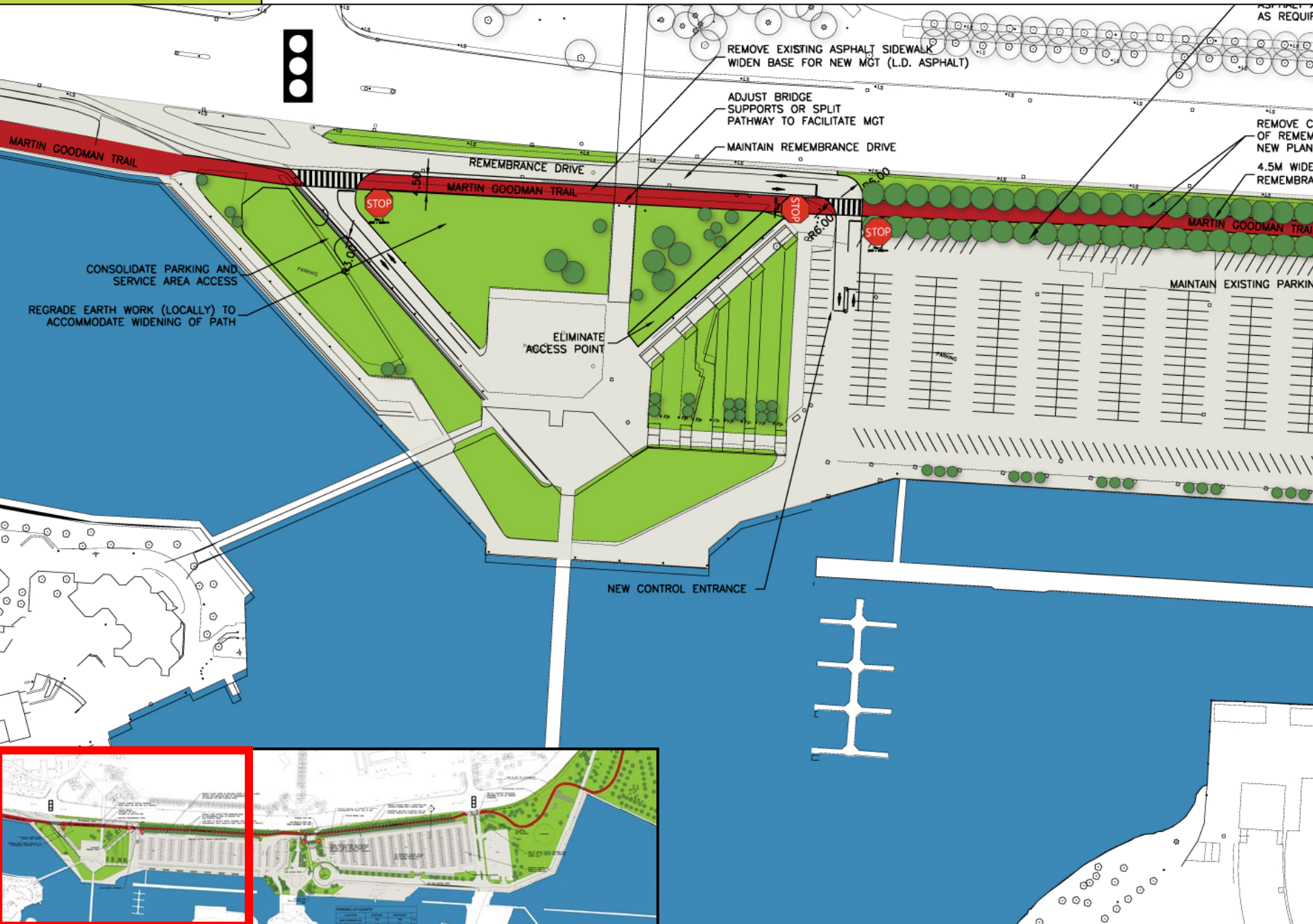



PARKING LOT COUNTS

| LOCATION | EXISTING | P |
|------------------|----------|---|
| EAST PARKING LOT | 750 | |
| WEST PARKING LOT | 550 | |
| TOTAL | 1300 | |





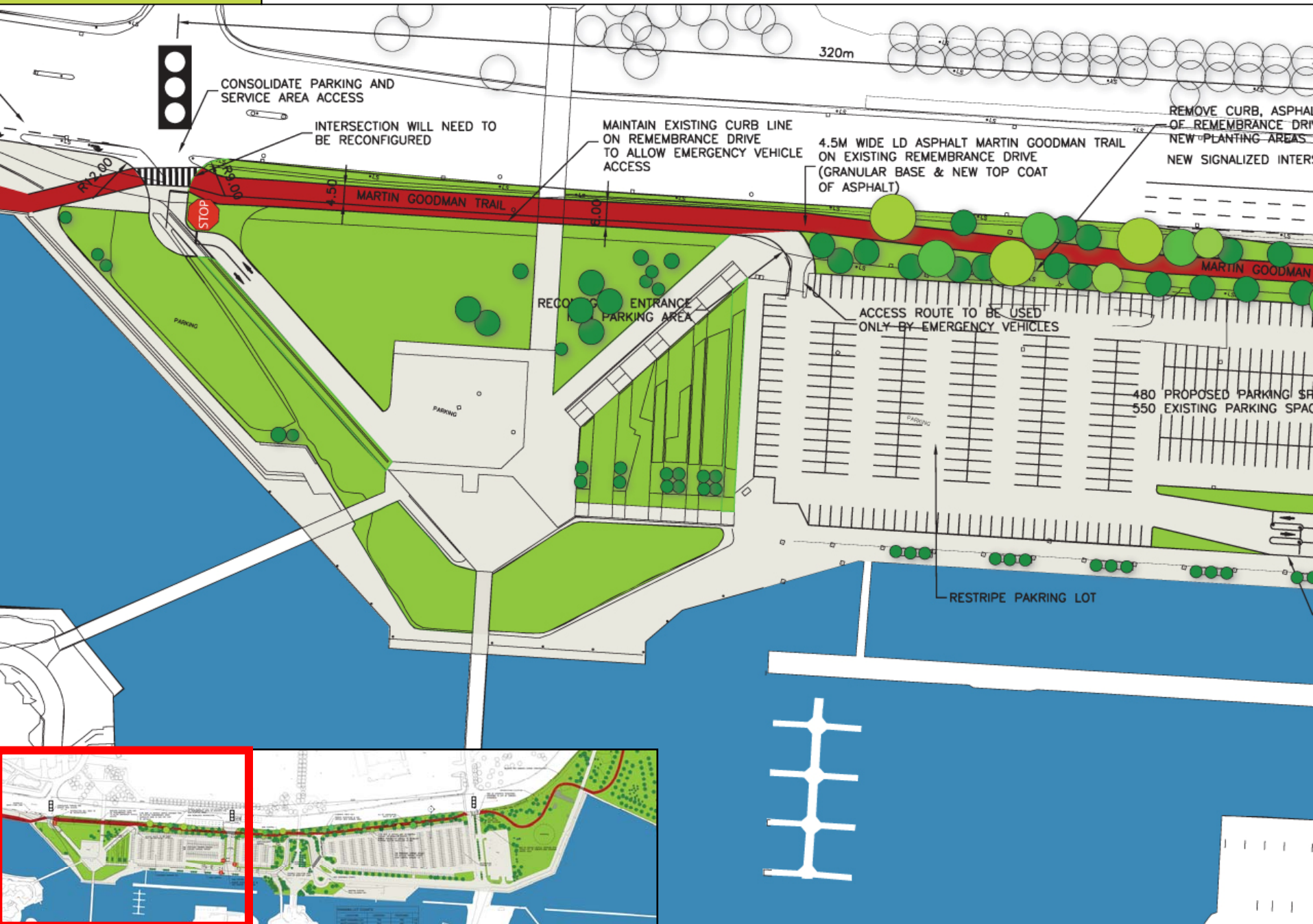

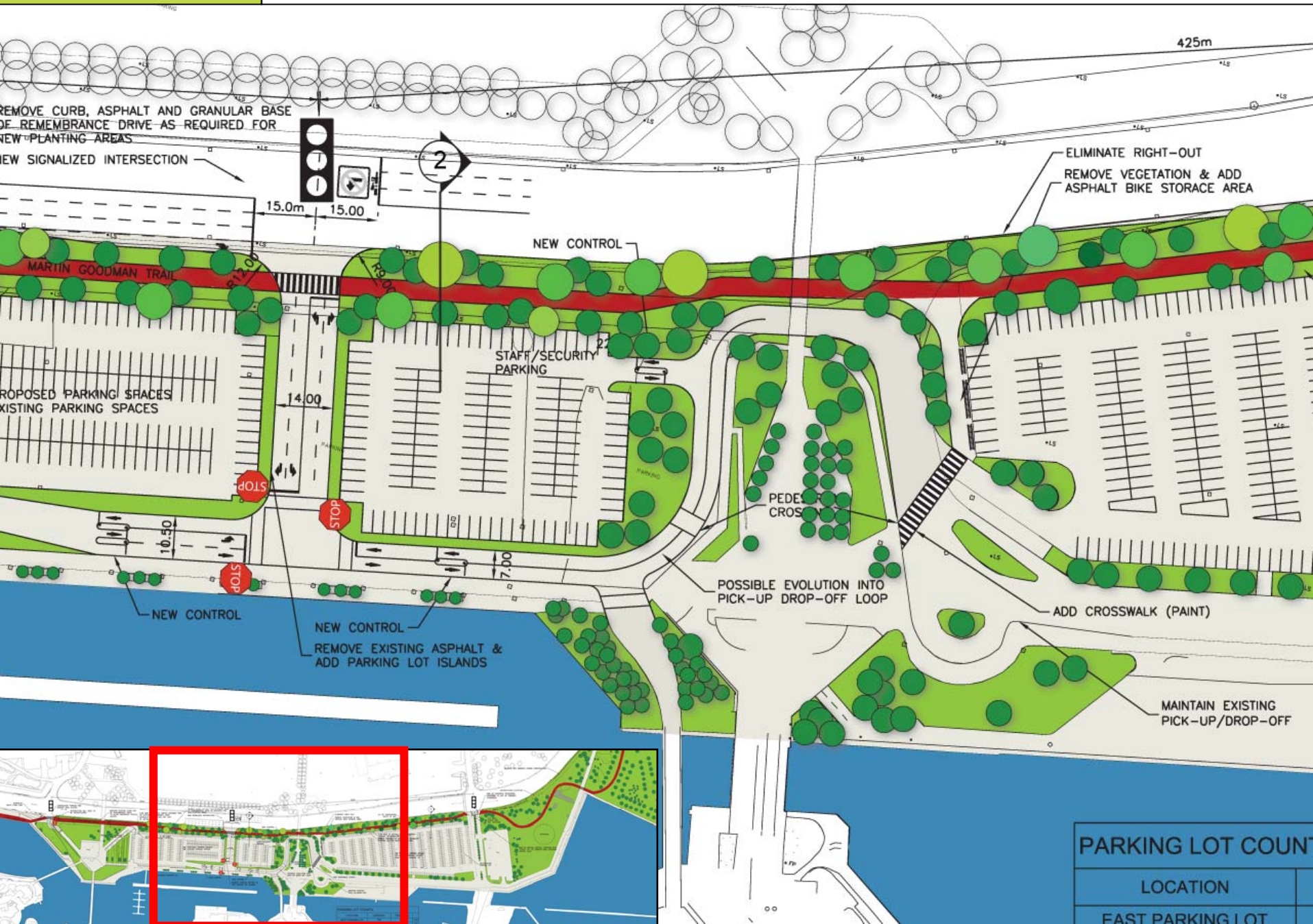

| PARKING LOT COUNT | |
|-------------------|--|
| LOCATION | |
| EAST PARKING LOT | |

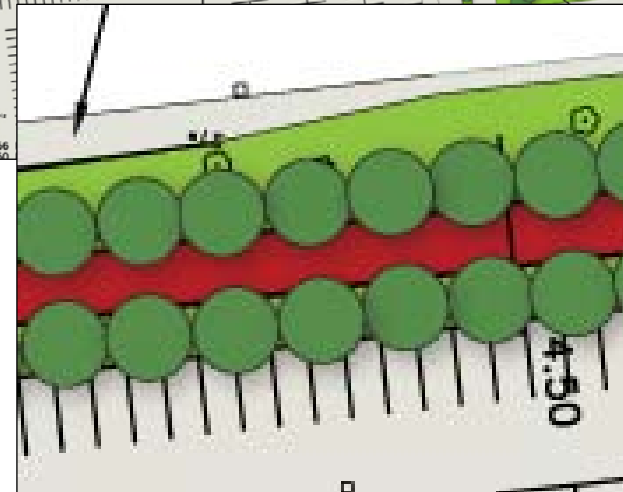
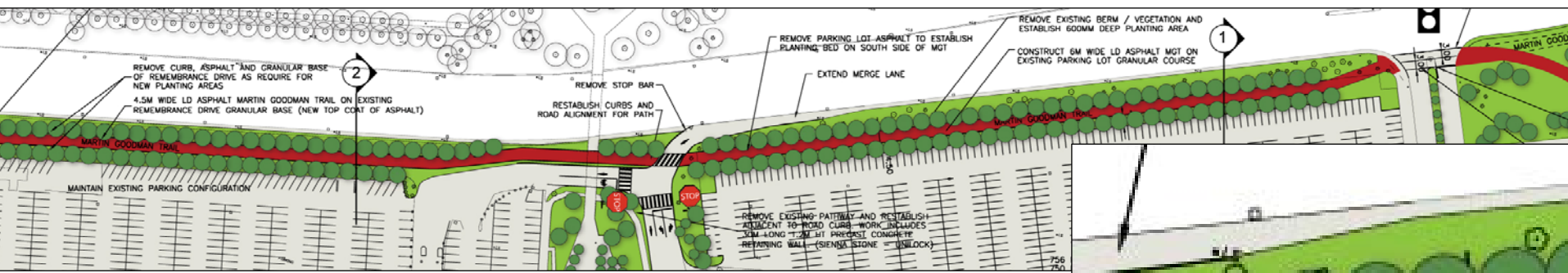
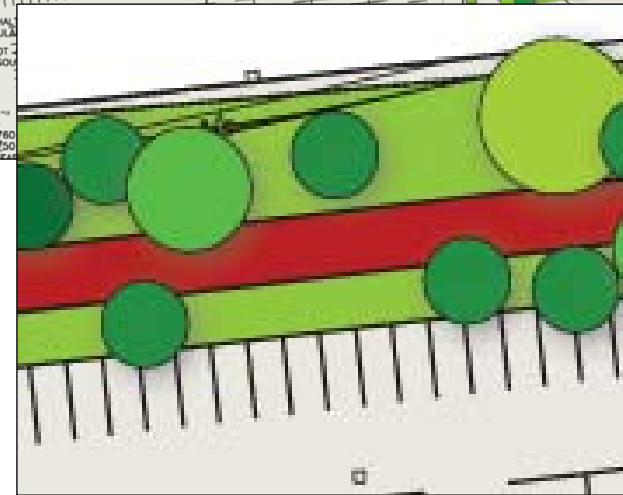
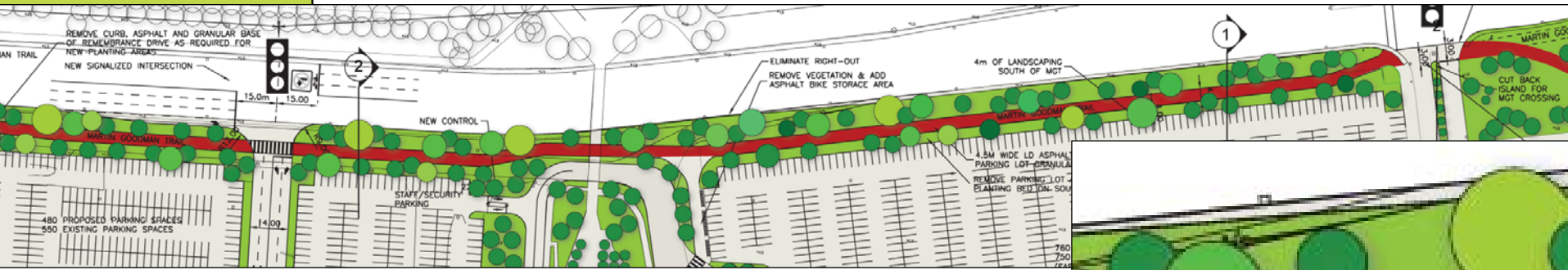

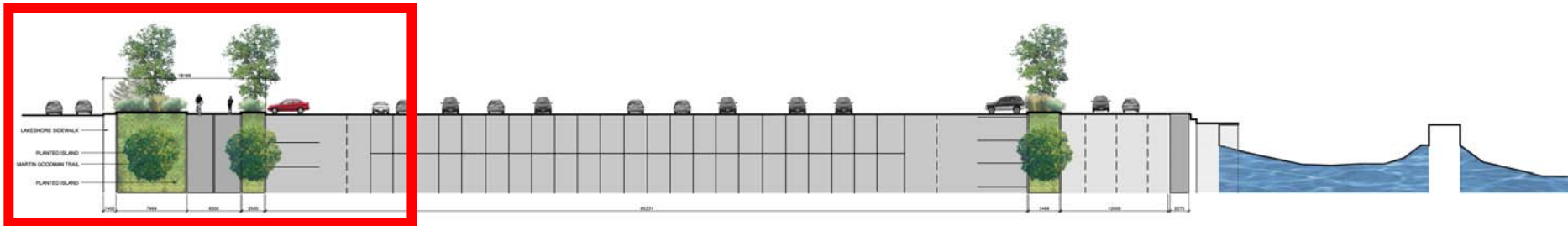
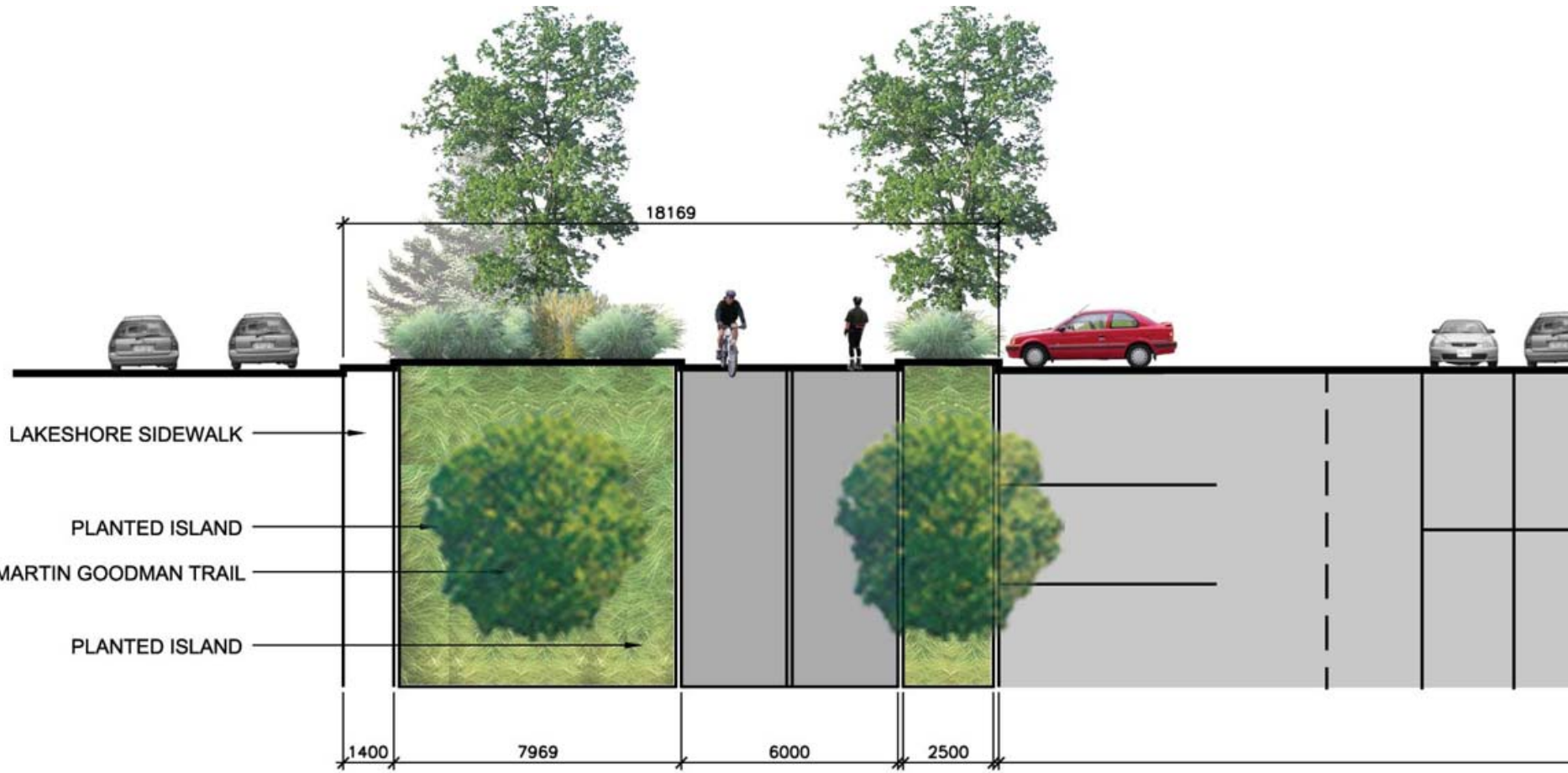

EAST PARKING LOT - MGT AT LAKESHORE WITH ENLARGED WATERS EDGE PROMENADE - REDUCED PARKING

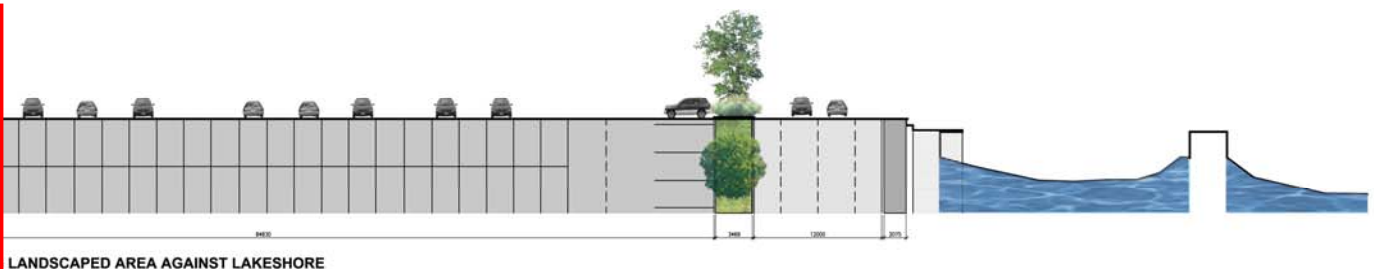
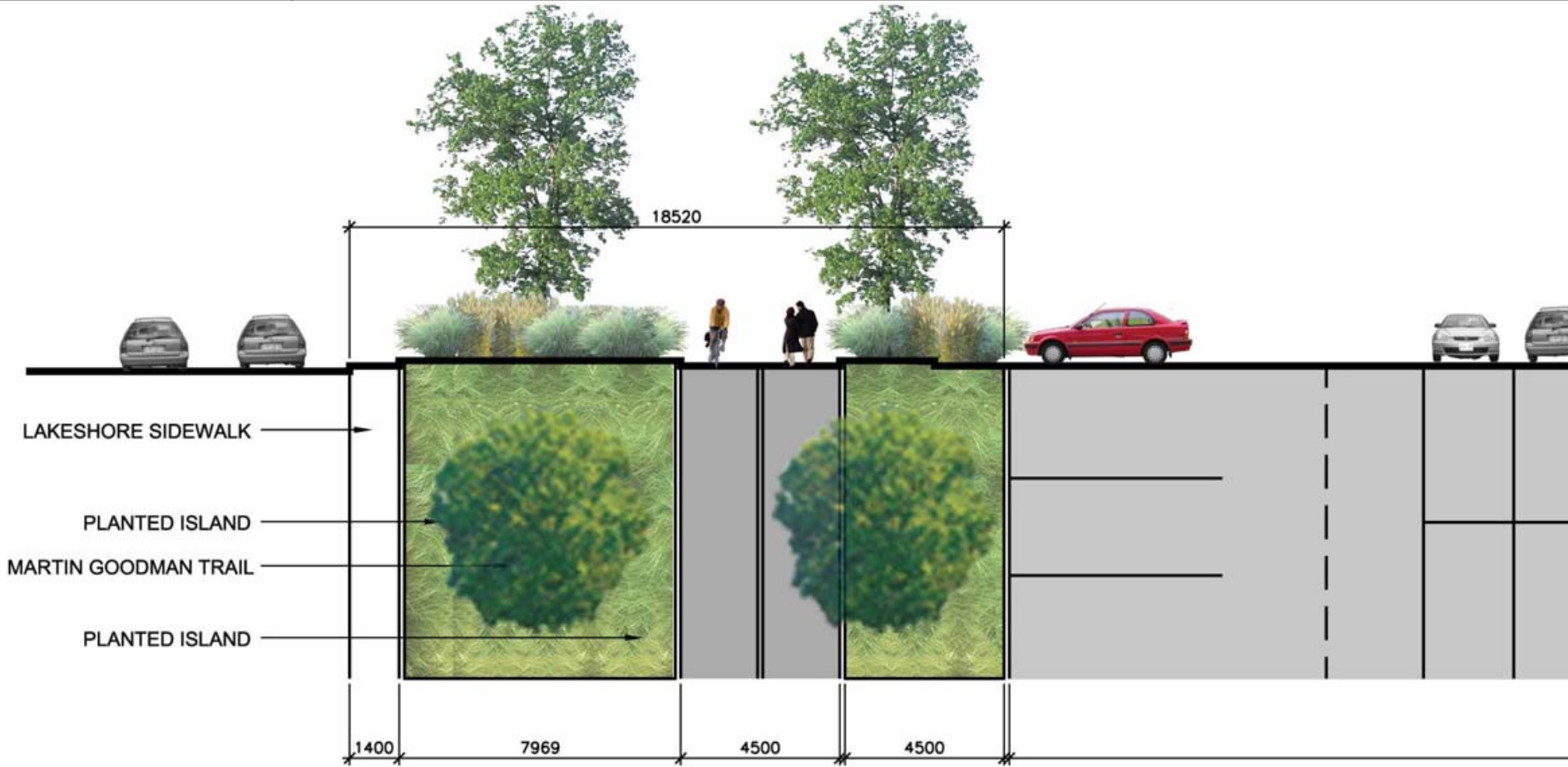

LANDSCAPED AREA AGAINST LAKESHORE

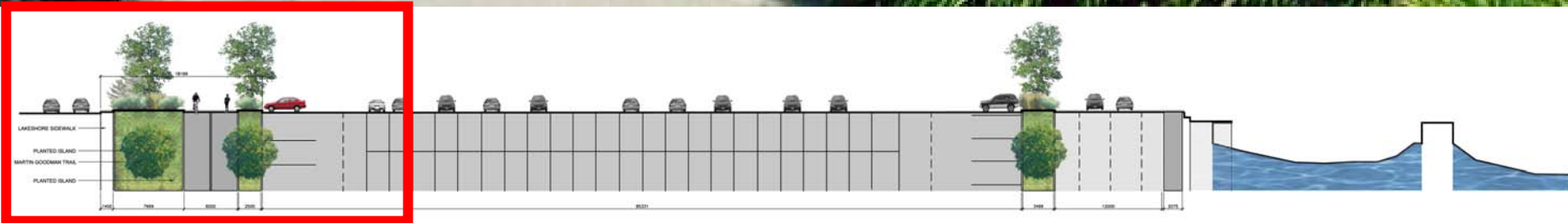

EAST PARKING LOT - MGT AT LAKESHORE WITH ENLARGED WATERS EDGE PROMENADE - REDUCED PARKING

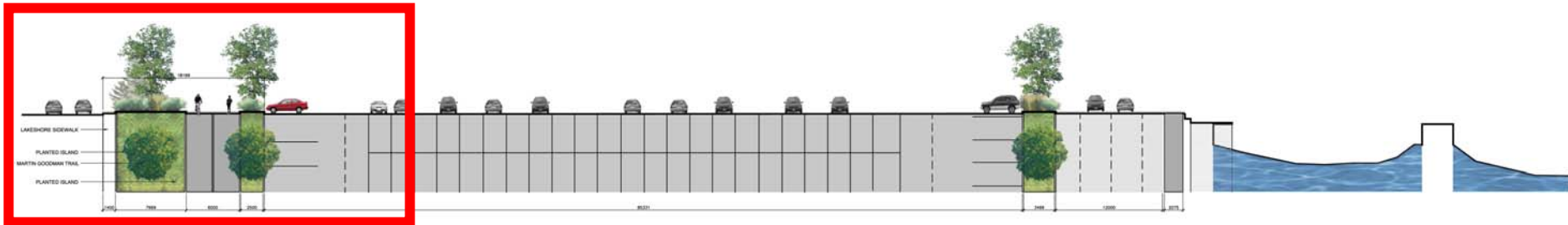

EAST PARKING LOT - MGT AT LAKESHORE WITH ENLARGED WATERS EDGE PROMENADE - REDUCED PARKING

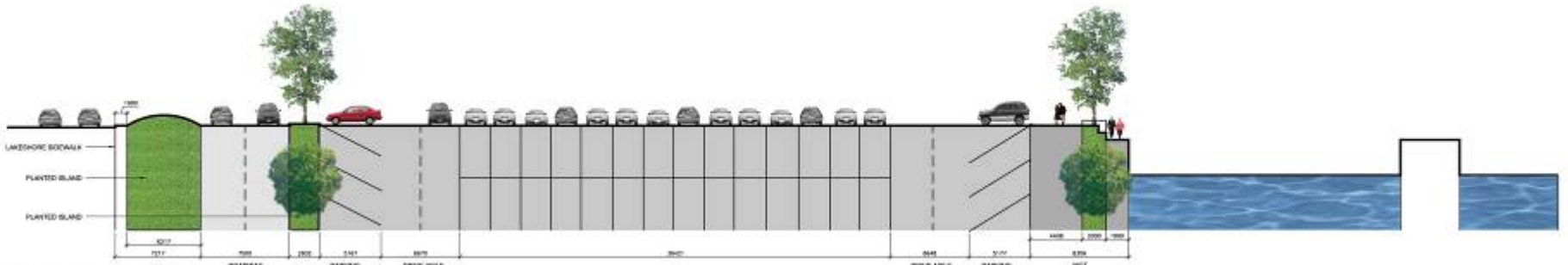

WEST PARKING LOT - EXISTING CONDITIONS

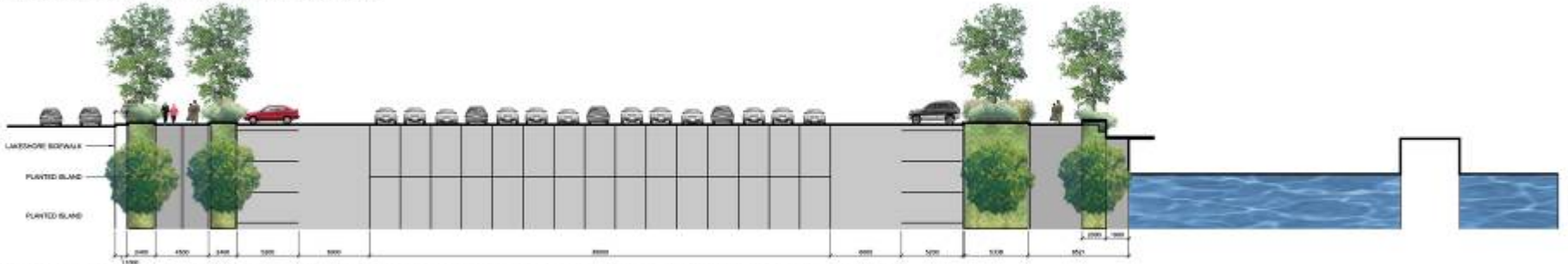

WEST PARKING LOT - CURRENT MGT EXTENDED ALONG LAKESHORE WITH OPTIMIZED PARKING LOT LAYOUT

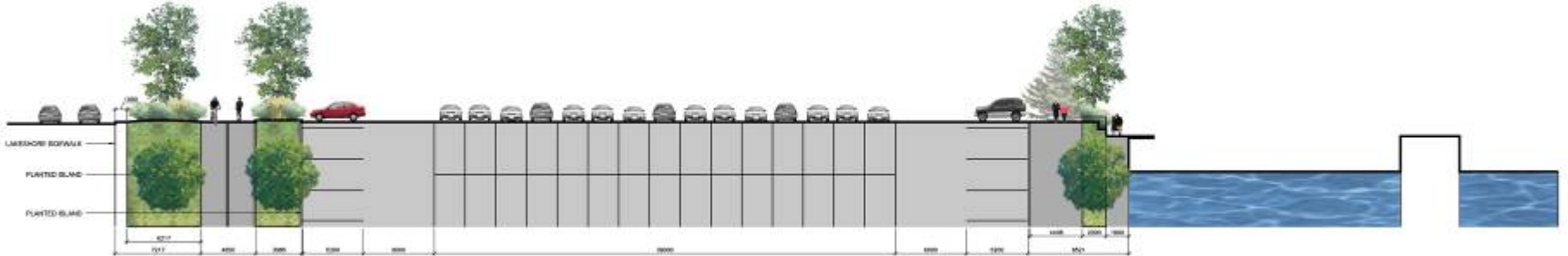

WEST PARKING LOT - MGT AT LAKESHORE MAINTAINING EXISTING LANDSCAPED AREA AGAINST LAKESHORE

MGT Next steps



Landscape Master Plan

Martin Goodman - Trail Detail Design

Public Open Houses

Jan 24

spring

Please:

- fill in a comment sheet
- ensure you have signed in – we will keep you in the loop
- come to the next event, in the spring

We will:

- refine concepts
- developed a preferred option
- present a draft Landscape Master Plan and MGT design

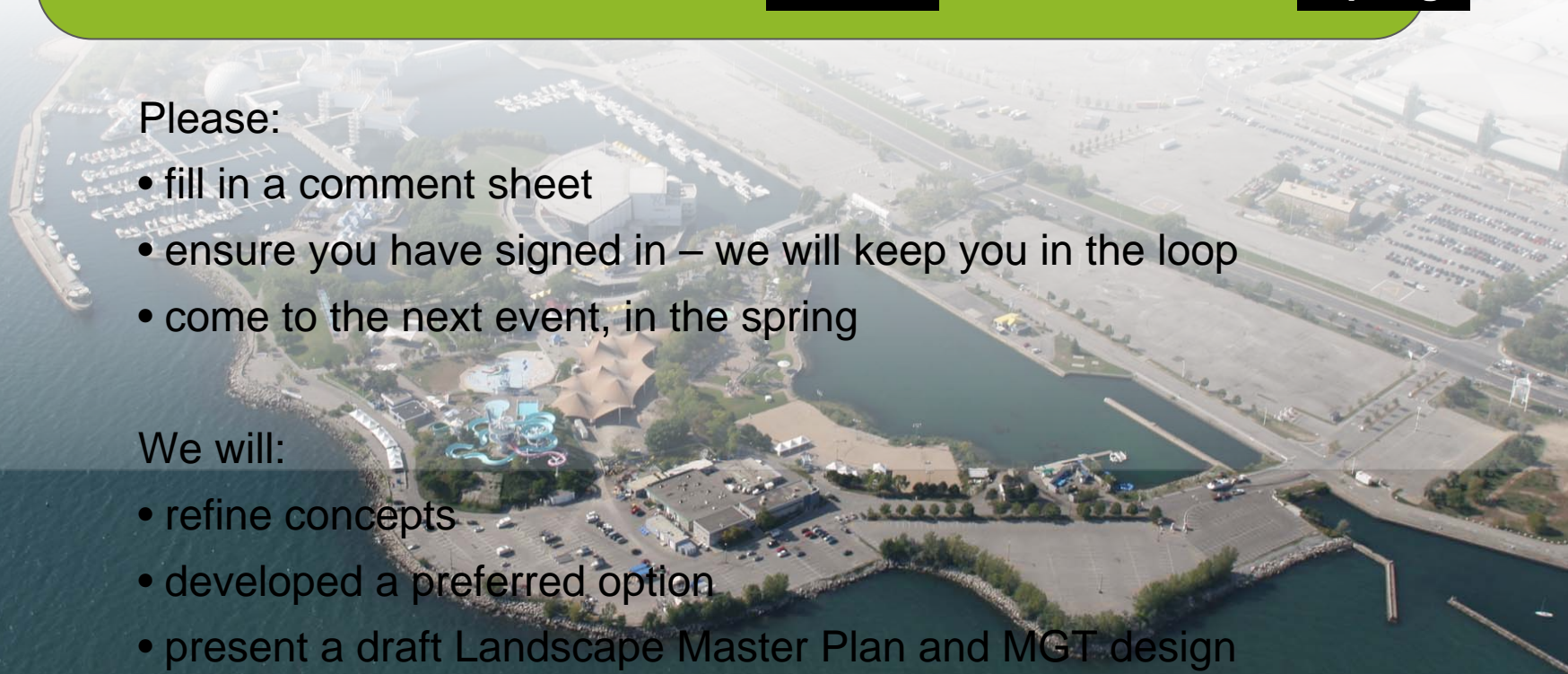

MGT Your questions...?



For further info contact Amanda Flude, Waterfront Toronto

416.214.1344 | info@waterfrontoronto.ca | www.waterfrontoronto.ca

MARTIN GOODMAN TRAIL – Ontario Place Landscape Master Plan and Detailed Trails Design

January | 24 | 2008

Public Open House # 1



