

Martin Goodman Trail

W E L C O M E

WATERFRONT TRAIL PUBLIC MEETING #2

November 23, 2005 6:00 to 9:00 pm

Improvement Update



Martin Goodman Trail is an important and well loved pedestrian and cycling connection across the waterfront. Today, many areas are in need of repair...

Beginning in 2005 / 2006, the Toronto Waterfront Revitalization Corporation is undertaking a number of Trail Improvements in the areas of Marilyn Bell Park to Coronation Park, and near Leslie Street and Unwin Avenue with interim improvements in the Portlands.

Tonight's meeting is an important opportunity to engage the public and the community in an update on the current trail development as the design process proceeds.



Tonight's Agenda

- 6:00 – 7:00** **Tour the exhibits**, with members of the Toronto Waterfront Revitalization Corporation and the design consultants
- 7:00 – 7:10** **Welcome and Opening Remarks** - John Campbell, TWRC
- 7:10 – 7:15** **Overview of Agenda and Introductions** - Pam Hubbard
- 7:15 – 7:50** **Presentation** – Victor Ford, Victor Ford and Associates Inc - Landscape Architects & John Hillier, du Toit Allsopp Hillier - Landscape Architects
- **Update: Trail Development on the Waterfront**
 - **Eastern and Western Improvements, Timing and Construction**
 - **Design Principles**
 - **Conceptual Design for Marilyn Bell Park and Exhibition Place**
 - **Next Steps**
- 7:50 – 8:30** **Feedback, Questions and Comments**
- 8:30 - 9:00** **Tour the Exhibits and Adjourn**

Trail Program Development

Program 1 Marilyn Bell to Coronation

Program 1: 2005 – 2007
Victor Ford and Associates Inc

Program 3 Waterfront Core

Program 3: 2006 – 2008
To Be Determined

Program 1,2,3 Portlands Precinct

Program 1: 2005 – 2007
Victor Ford and Associates Inc

Program 2: 2005 – 2007
TRCA
du Toit Allsopp Hillier

Program 3: 2006 – 2008
To Be Determined

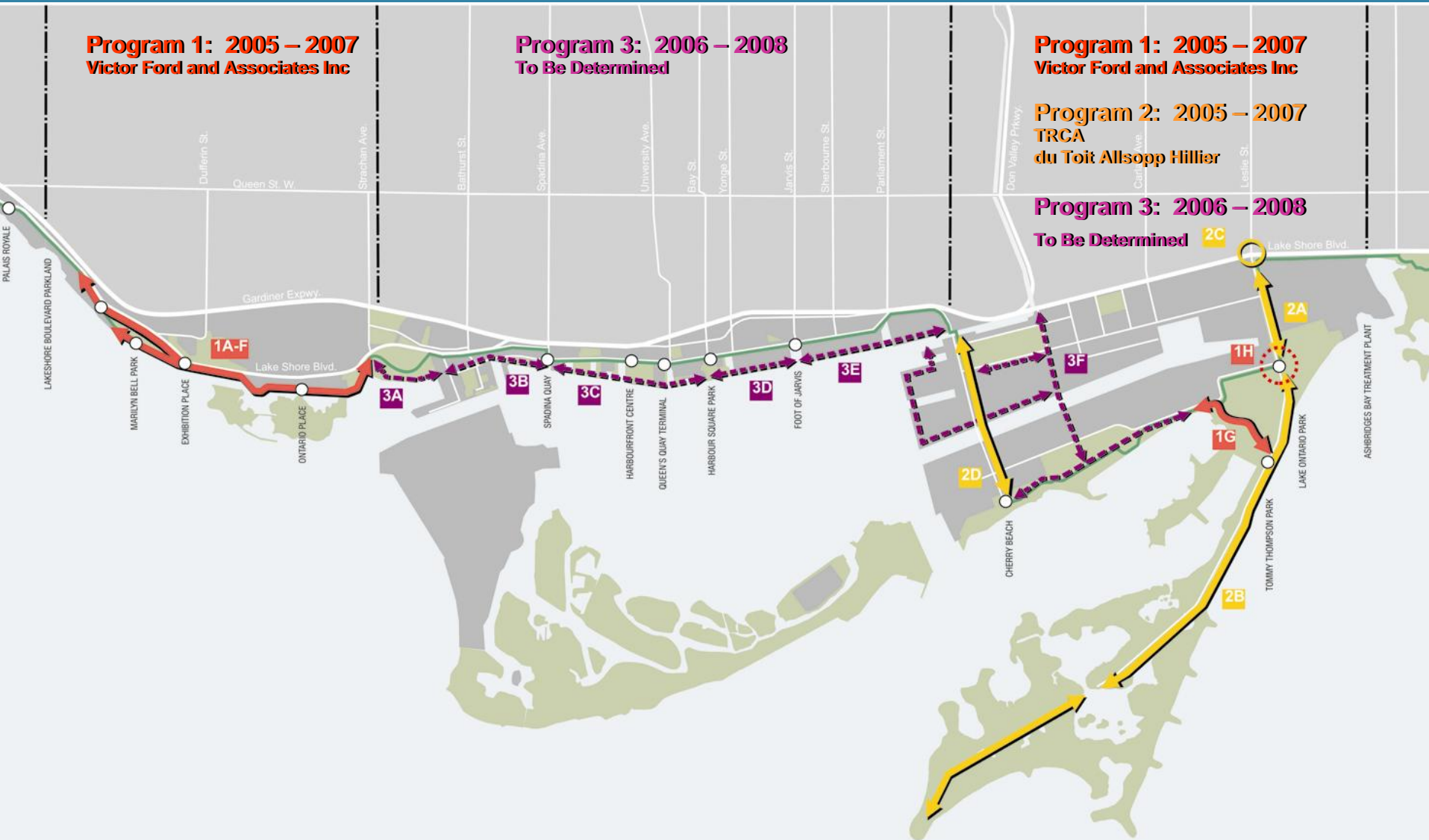

2005 - 2006 Trail Improvements

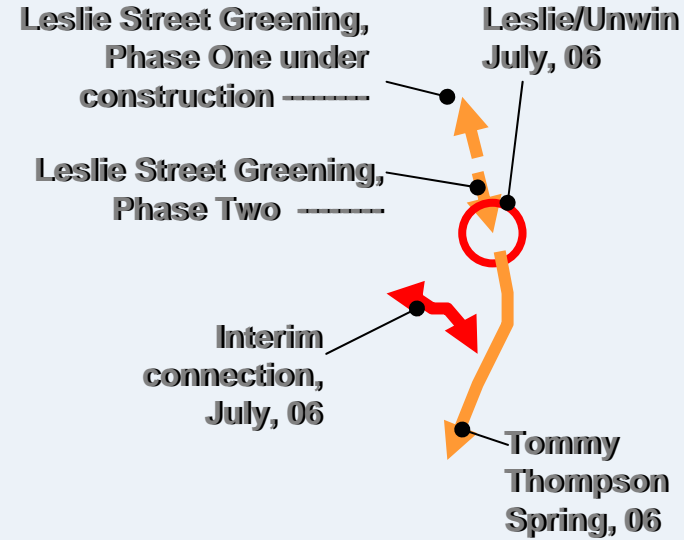
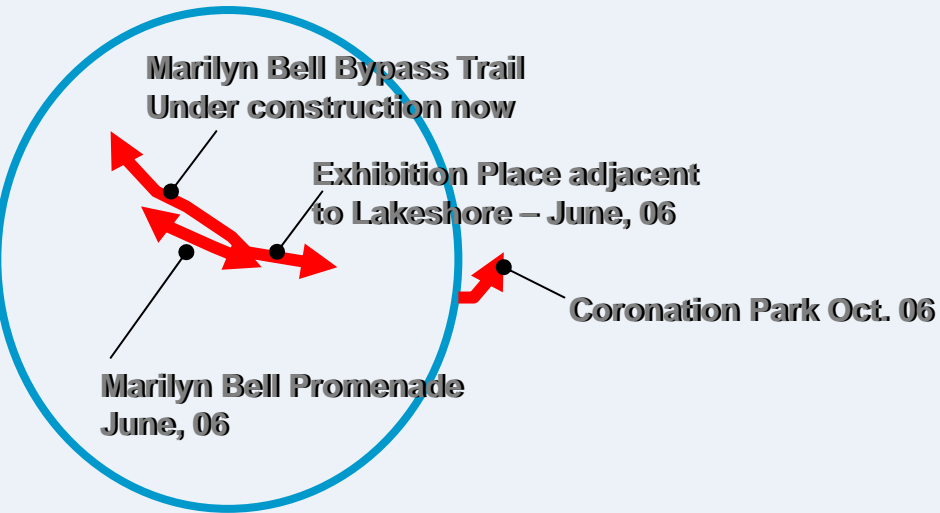

**Our Focus this evening:
Improvements at Marilyn
Bell Park & Exhibition Place**

Timeline - Trail Segments

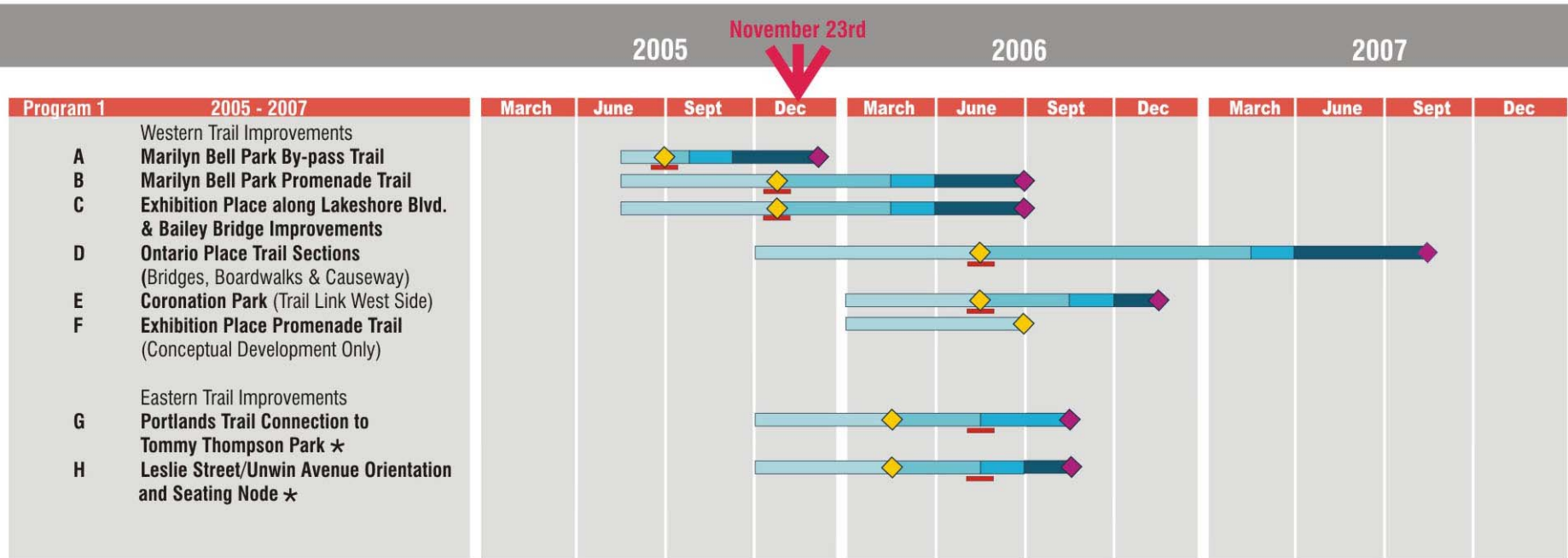

- Conceptual Design
- Construction Documents Preparation
- Tender Period
- Construction
- Completion of Construction
- Community Information/Consultation Meeting
- CEAA/TWRC Approvals
- Phasing in coordination with Lake Ontario Park Design Team

Program Goal Examples

- **Reduce conflicts between trail users and vehicles**
- **Provide continuous trail access along the waterfront**
- **Enhance user experience and enjoyment of the trail**
- **Enhance enjoyment of the waterfront**

Design Principles

To achieve these goals and guide decision making, 10 Design Principles have been established...

Design Principles



1. PROVIDE CONTINUOUS ACCESS

Provide a continuous multi-use trail along the waterfront.

Design Principles



2. ACCOMMODATE DIFFERENT USERS

Provide a minimum 4.5m width trail to accommodate walkers, joggers, cyclists in-line skaters and wheelchair users etc. Ensure accessibility along the trail. Some segments of the trail could provide space for a pedestrian boardwalk.

Design Principles



3. ACCOMMODATE FLEXIBLE USE

Twin the trail to accommodate flexible use. During special events one trail should always be available for use.

Design Principles



4. CELEBRATE THE WATER

**Strengthen our City's connection to the water.
Contribute positively to the transformation of our
waterfront.**

Design Principles



5. GREENING AND BEAUTIFICATION

Increase and enhance the urban forest.

Design Principles



6. IMPROVE USER EXPERIENCE

Enhance the character and quality of the waterfront through innovative design and quality of materials and amenities.

Design Principles



7. VARIETY AND CONSISTENCY

Not all segments of the trail are the same. Unify the overall trail through consistency of design elements.

Design Principles



8. SUSTAINABILITY

Support the Toronto Waterfront Revitalization Corporation's sustainability framework.

Design Principles



9. LIGHTING

Provide lighting for frequently used trail segments.

Design Principles

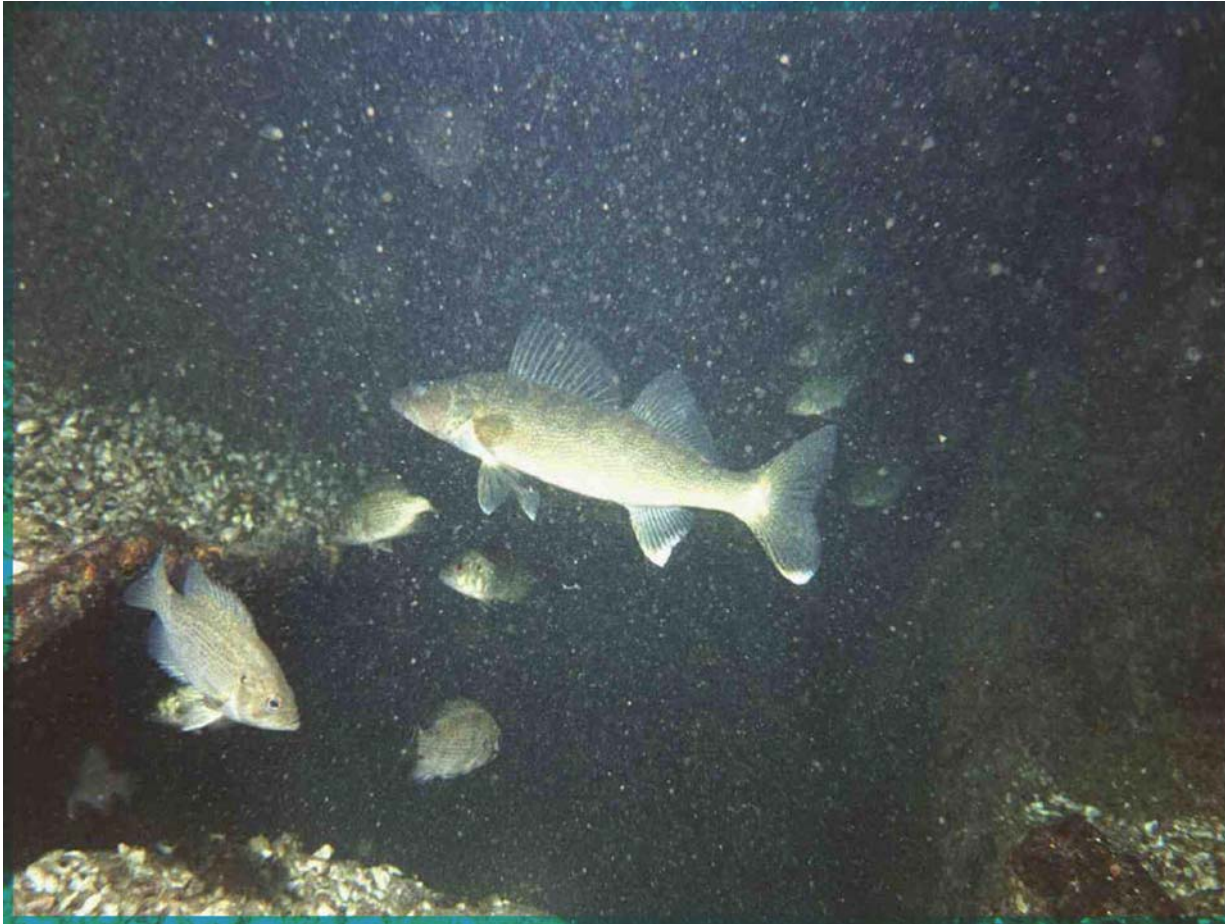

10. PARTNERSHIPS

Seek opportunities to partner with other agencies to enhance the waterfront, such as working with the Toronto and Region Conservation Authority to improve shoreline and fish habitat.

Eastern Trail Improvement Areas



Martin Goodman Lake Ontario Trail - Eastern Section - The Portlands



TRAIL IMPROVEMENT SEGMENTS Program 1 2005 - 2006

-  **G. Portlands Trail Connection to Tommy Thompson Park**
Combination of interim use of existing Marina Rd. and a new section 4.5 meter wide asphalt, multi-use trail
-  **H. Leslie Street/Unwin Avenue Orientation/Seating Node**
Permanent or interim improved trail connections from Unwin Ave. to Leslie Street and Tommy Thompson Park with seating and orientation node

ADDITIONAL TRAIL IMPROVEMENTS AREAS Program 2 2005 - 2007

-  **Leslie Street Greening**
4.0 meter wide asphalt path with decorative planting, lighting and pedestrian sidewalks along the east and west sides of Leslie street
-  **Tommy Thompson Park Trail - Planned Improvements through T.R.C.A.**
Existing asphalt roadway that is open weekends and evenings as an asphalt multi-use trail

-  **Martin Goodman Trail**
Existing trail sections currently not planned for further improvement



Tommy Thompson Park - Trails Master Plan



Figure 3

Tommy Thompson Park - Trails Master Plan



Portlands - Interim Improvements: Leslie / Unwin



Portlands - Interim Improvements – Linkage



- **Create an Interim Trail on Marina Road and a new section of 4.5m wide asphalt multi-use trail between Unwin Avenue / The Circulating Channel and Tommy Thompson Park**
- **Create a new Orientation / Seating node at Leslie Street and Unwin Avenue**

Leslie Street Greening

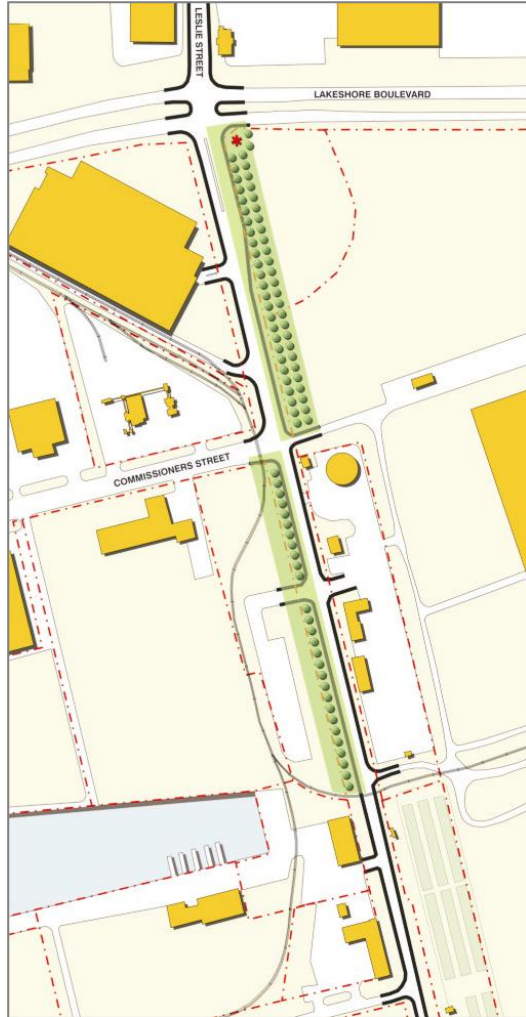

Phase 1

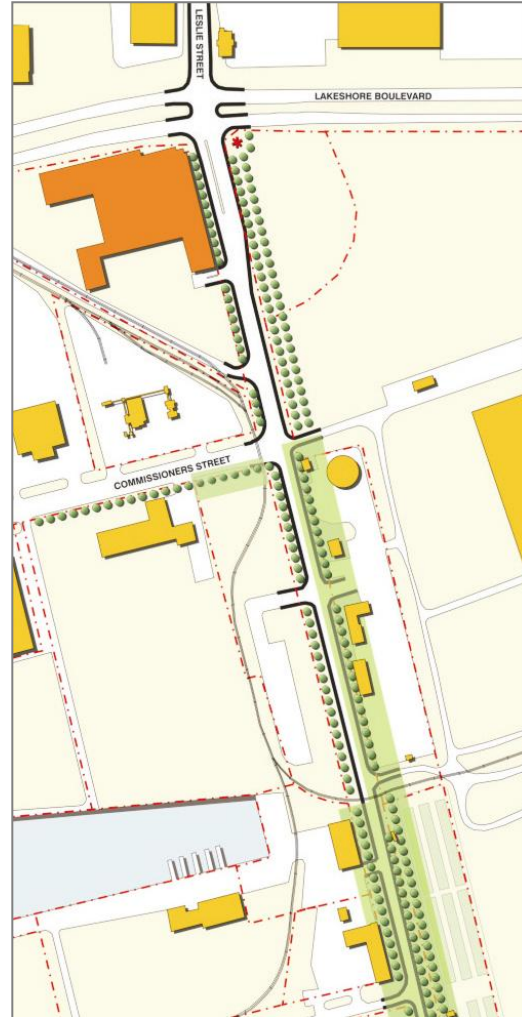

Future work



- **New 4m wide asphalt path on east side**
- **Addition of concrete sidewalks (east and west side of Leslie St.)**
- **Benches**
- **Pedestrian lighting**
- **New trees and planting beds**
- **Adjust allotment gardens and Works Yard to facilitate greening**

Leslie Street Greening - Phase 1 Improvements

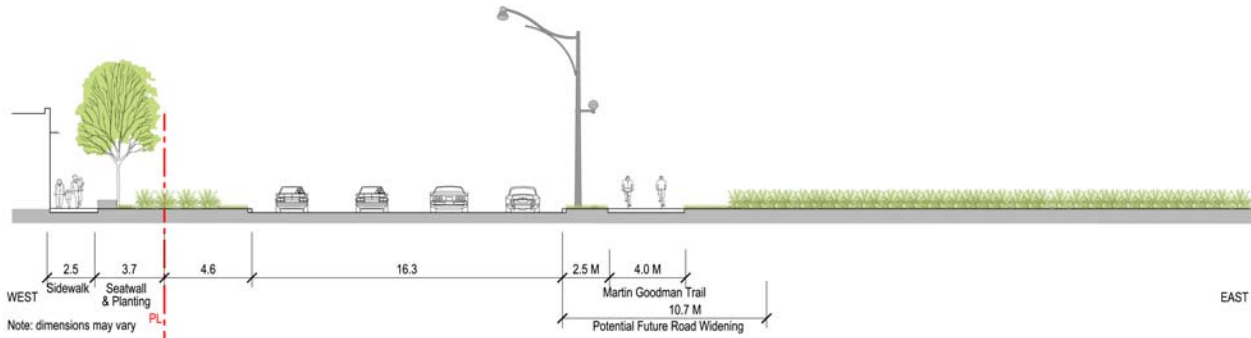

existing

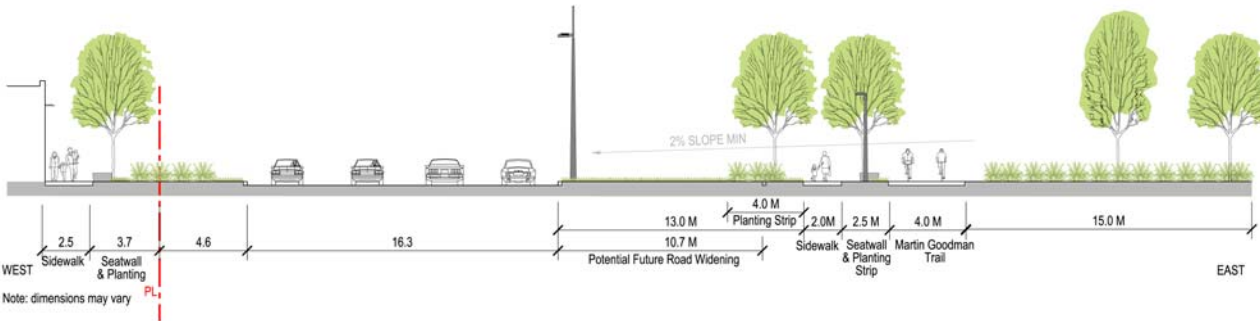

future

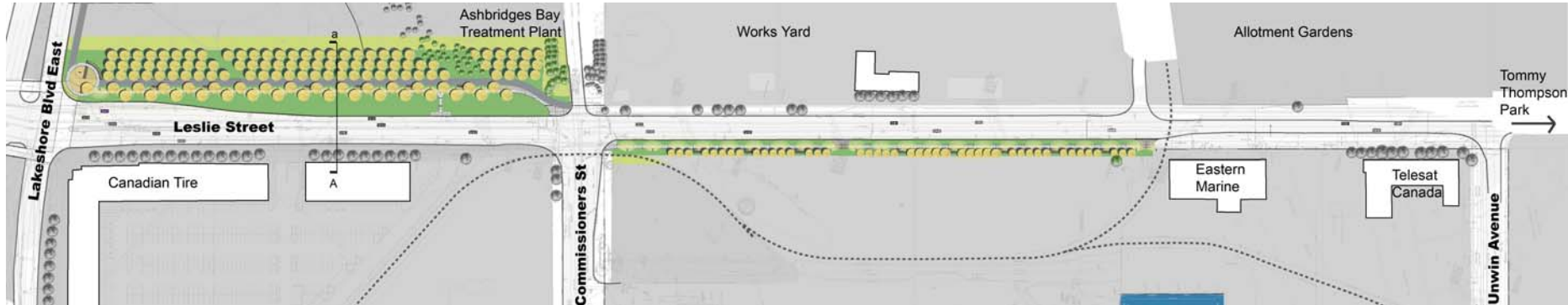

Leslie Street Greening - Phase 2 Improvements

B

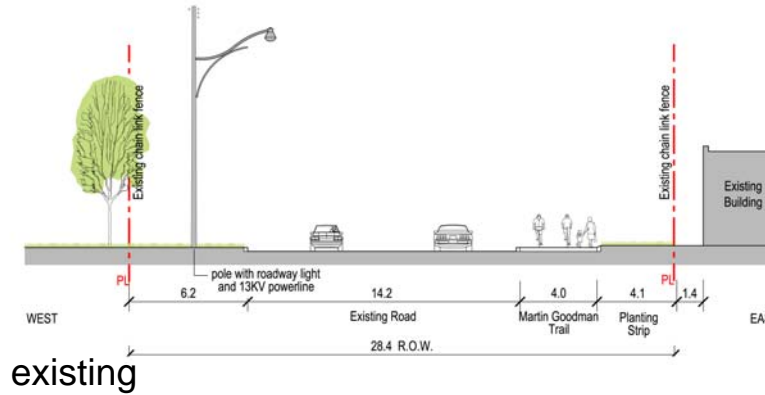

b



B

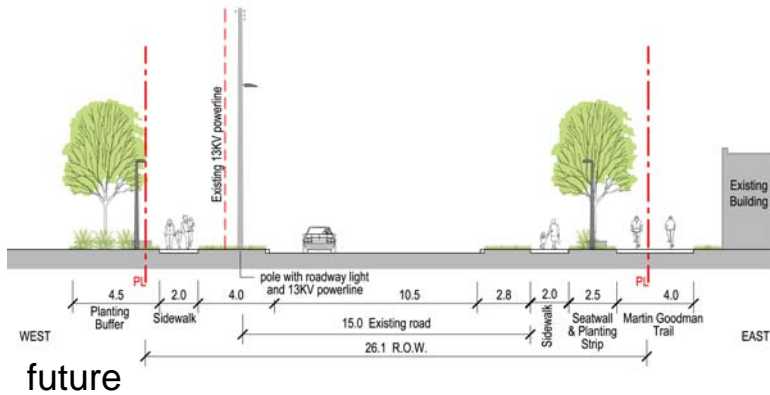

b

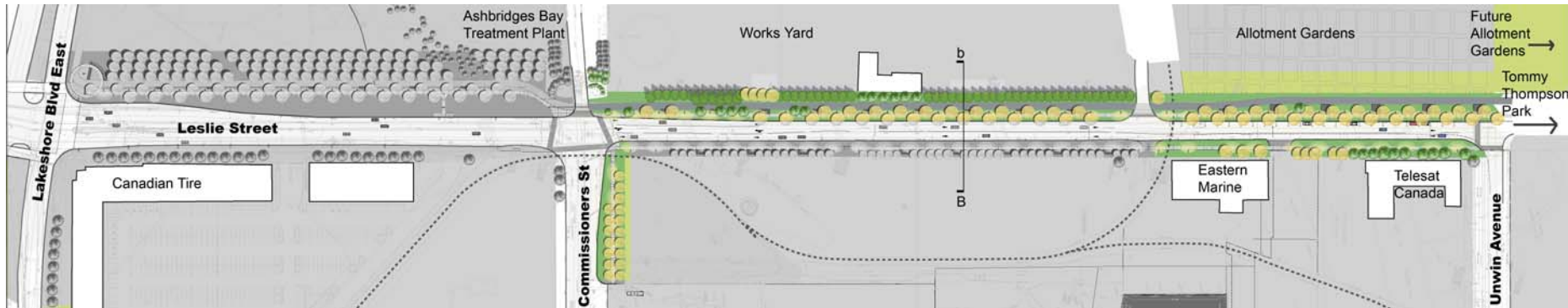

Leslie Street Greening

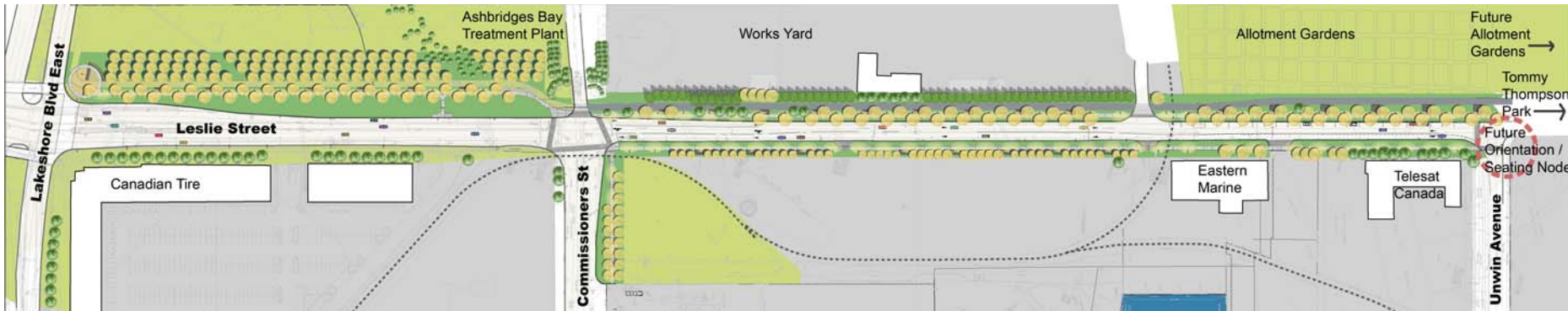

Western Improvements

Martin Goodman Lake Ontario Trail - Western Section - Marilyn Bell Park to Coronation Park

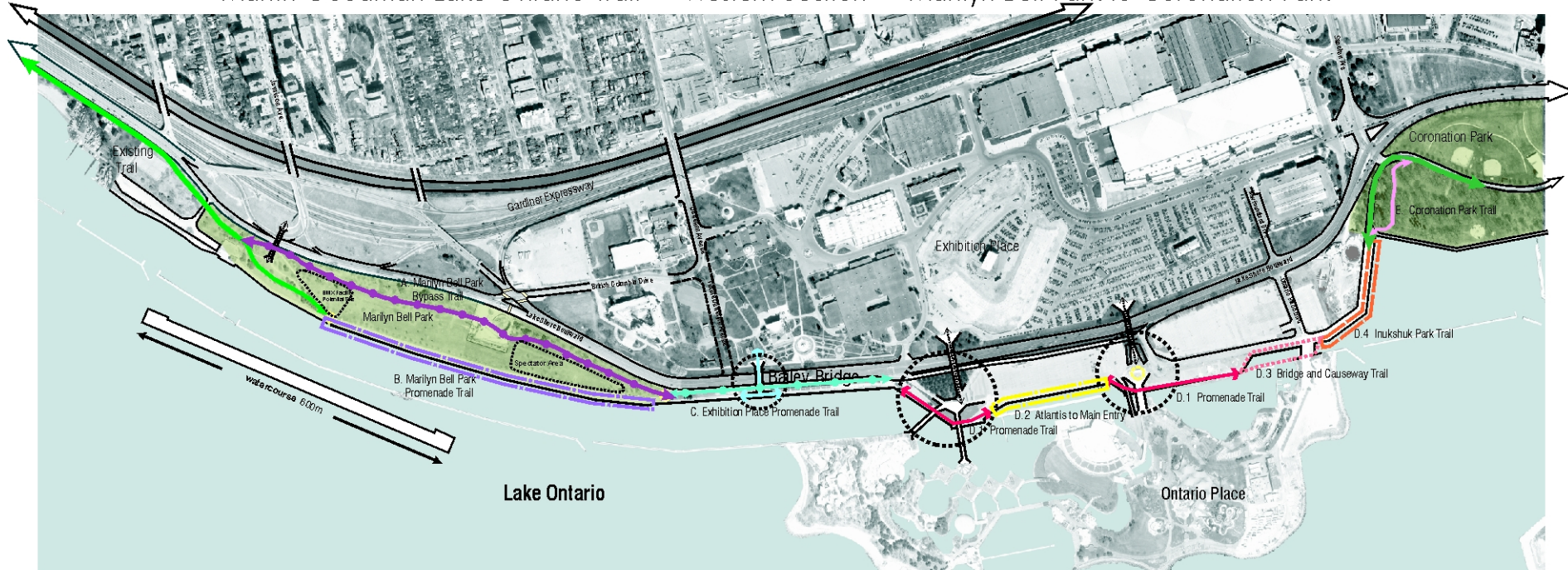

TRAIL IMPROVEMENT SEGMENTS



A. Marilyn Bell Park Bypass Trail
4.5 m wide asphalt multi-use trail in a park setting



B. Marilyn Bell Park Promenade Trail
A generous multi-use promenade with multiple components: 2 m wide water's edge pedestrian boardwalk, street furnishings / decorative planters and a 7 m wide asphalt multi-use trail and a 4 m wide promenade / events viewing areas with space for temporary bleacher seating



C. Exhibition Place along Lakeshore Blvd.
4.5 m wide asphalt multi-use trail parallel to Lakeshore Blvd., open year round



Martin Goodman Trail
Existing trail section currently not planned for further improvements



D. Ontario Place Trail Improvements
D.1 Promenade Trail
5.0 m wide water's edge multi-use trail



D.2 Atlantis to Main Entry
5.0 m wide water's edge multi-use boardwalk trail with adjacent street furnishings / planters separating the trail from parking lots



D.3 Bridge and Causeway Trail
5.0 m wide causeway trail elevated over a section of Brigadier Bay





D.4 Inukshuk Park Trail
5.0 m wide water's edge multi-use boardwalk trail with adjacent street furnishings / planters separating the trail from road



E. Coronation Park Trail
4.5 m wide asphalt multi-use trail in a park setting



 Existing pedestrian bridge

 Area with complex connections requiring detailed design resolution

Marilyn Bell Park - Proposed Site Plan



Marilyn Bell Park - Bypass Trail

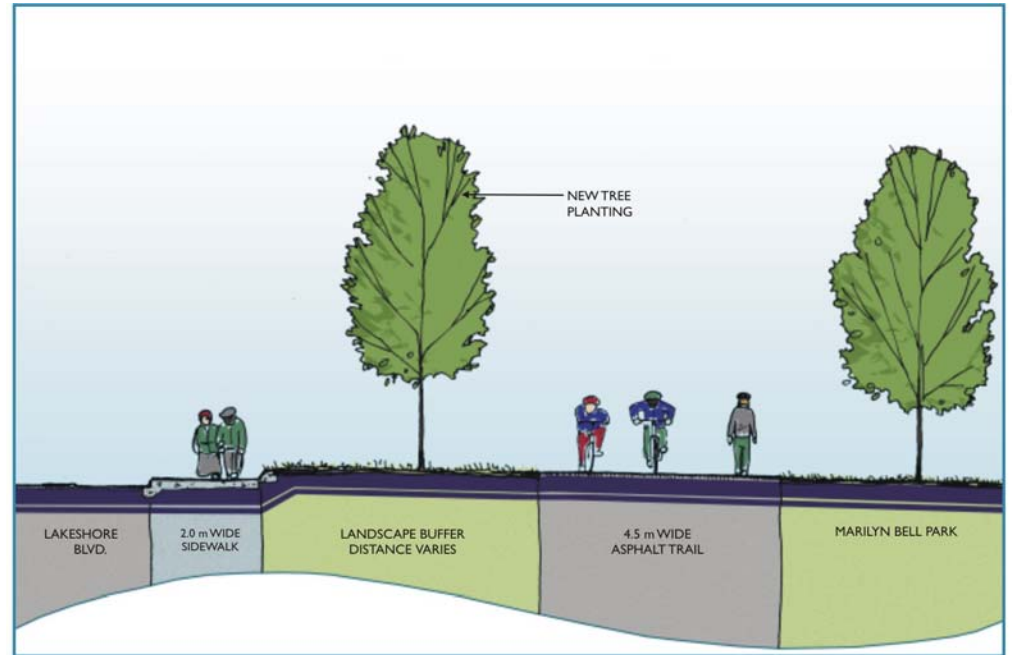
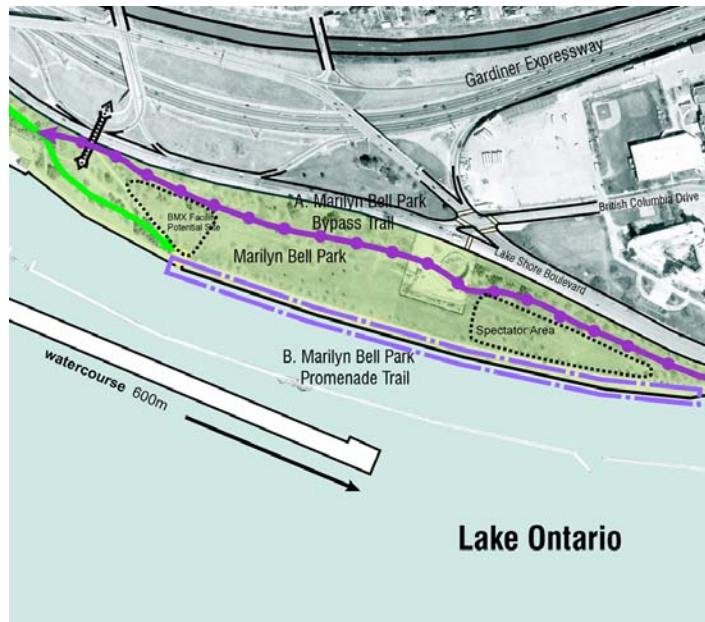

MARILYN BELL PARK BYPASS TRAIL - CROSS-SECTION



- **Creates a direct year-round alternative to the waterfront promenade**
- **By-passes events such as the air show and dragon boat races**
- **Construction has started!**

Marilyn Bell Park - Bypass Trail



MARILYN BELL PARK BYPASS TRAIL ELEMENTS:

- 4.5 metre Wide Asphalt Pathway (offset from Lakeshore Boulevard)
- Connections to Existing Martin Goodman Trail
- Tree planting

MARILYN BELL PARK BYPASS TRAIL - TYPICAL

Marilyn Bell Park - Promenade

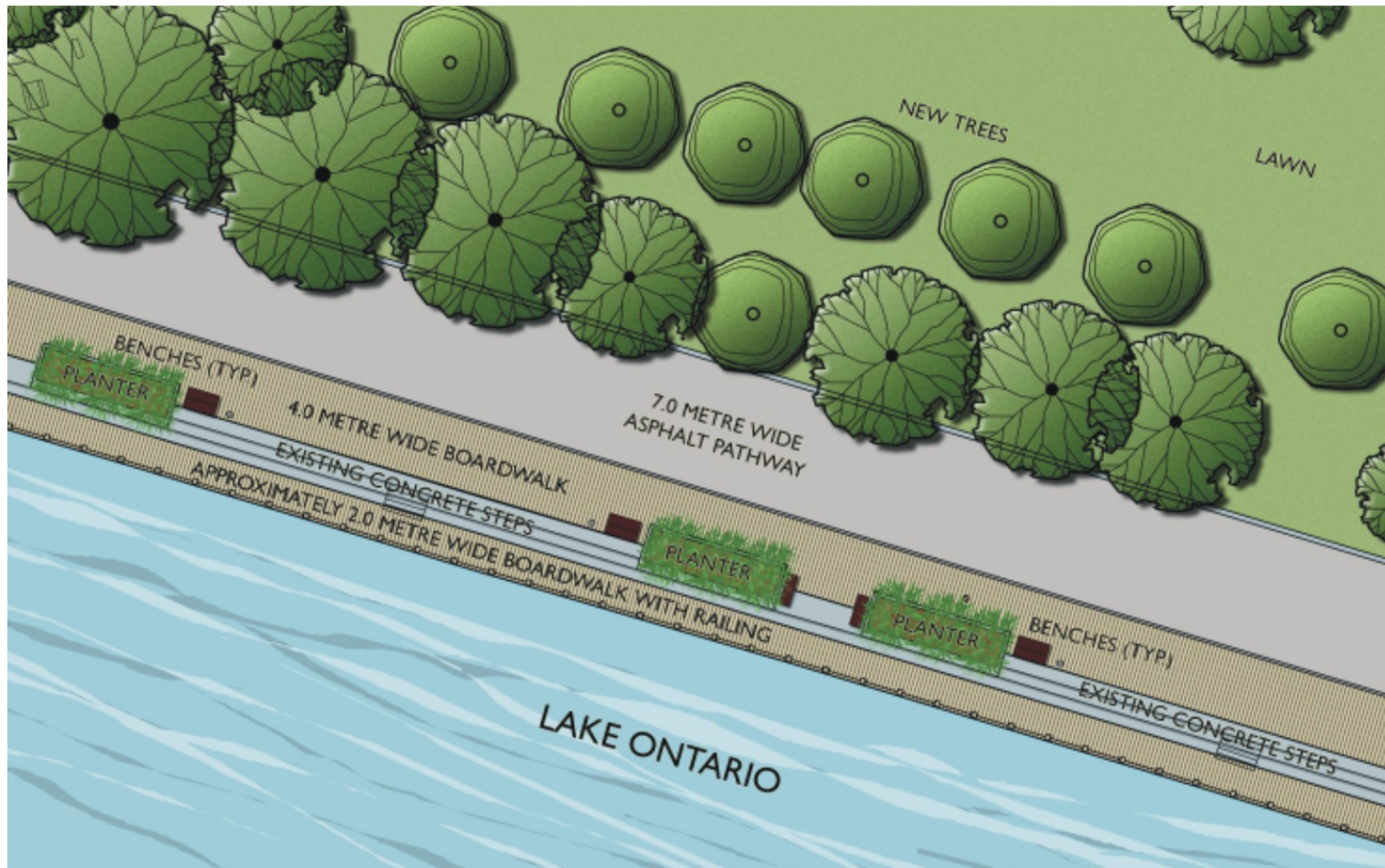

PROMENADE ELEMENTS:

- 7.0 metre Wide Asphalt Multi-Use Pathway
- 4.0 metre Wide Boardwalk Adjacent to Asphalt Pathway
- Approx. 2.0 metre Wide Boardwalk at Water's Edge (with railing)
- Tree Planting along North Side of Promenade
- Ornamental Planting Areas and Tree Plantings in Planters in Boardwalk Area
- Lighting
- Seating and Viewing Areas
- SOS Stations and Life-Saving Equipment
- Pathway Signage

I. TYPICAL PROMENADE AREA - PLAN

Marilyn Bell Park - Promenade



PROMENADE - TYPICAL CONDITION "BEFORE"

- **Creates a high quality multi-use space and trail accessible for most of the year**
- **Provides viewing of the dragon boat course and air show, etc.**
- **Creates opportunities for enhanced waterfront greening**



PROMENADE - TYPICAL CROSS SECTION "AFTER"

Marilyn Bell Park - Promenade

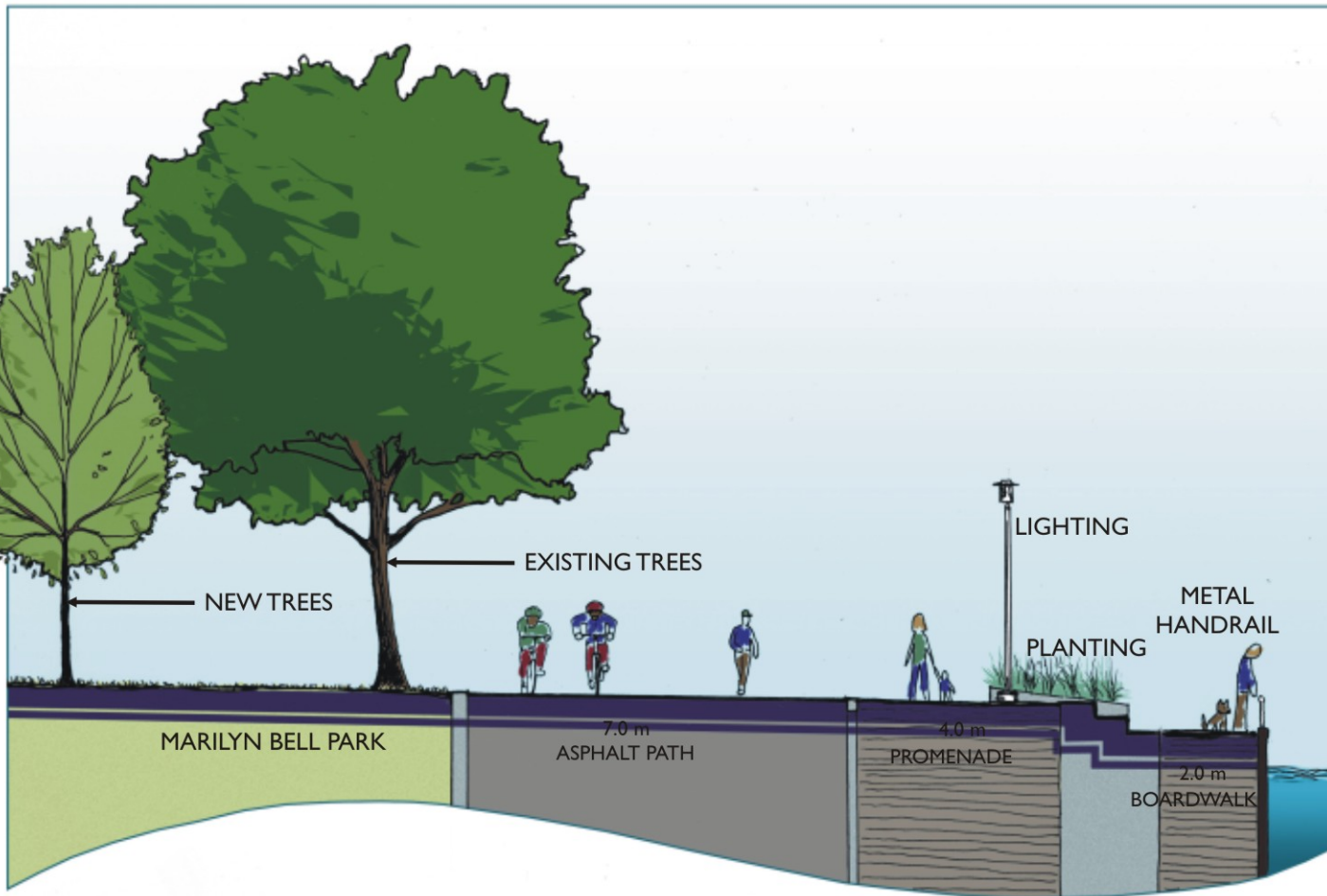

PROMENADE ELEMENTS:

- 7.0 metre Wide Asphalt Multi-Use Pathway
- 4.0 metre Wide Boardwalk Adjacent to Asphalt Pathway
- Approx. 2.0 metre Wide Boardwalk at Water's Edge (with railing)
- Tree Planting along North Side of Promenade
- Ornamental Planting Areas and Tree Plantings in Planters in Boardwalk Area
- Lighting
- Seating and Viewing Areas
- SOS Stations and Life-Saving Equipment
- Pathway Signage

Marilyn Bell Park – Promenade - Before



PROMENADE - TYPICAL CONDITION “BEFORE”

Marilyn Bell Park – Promenade After



PROMENADE - TYPICAL CROSS SECTION "AFTER"

Marilyn Bell Park – Promenade Seating

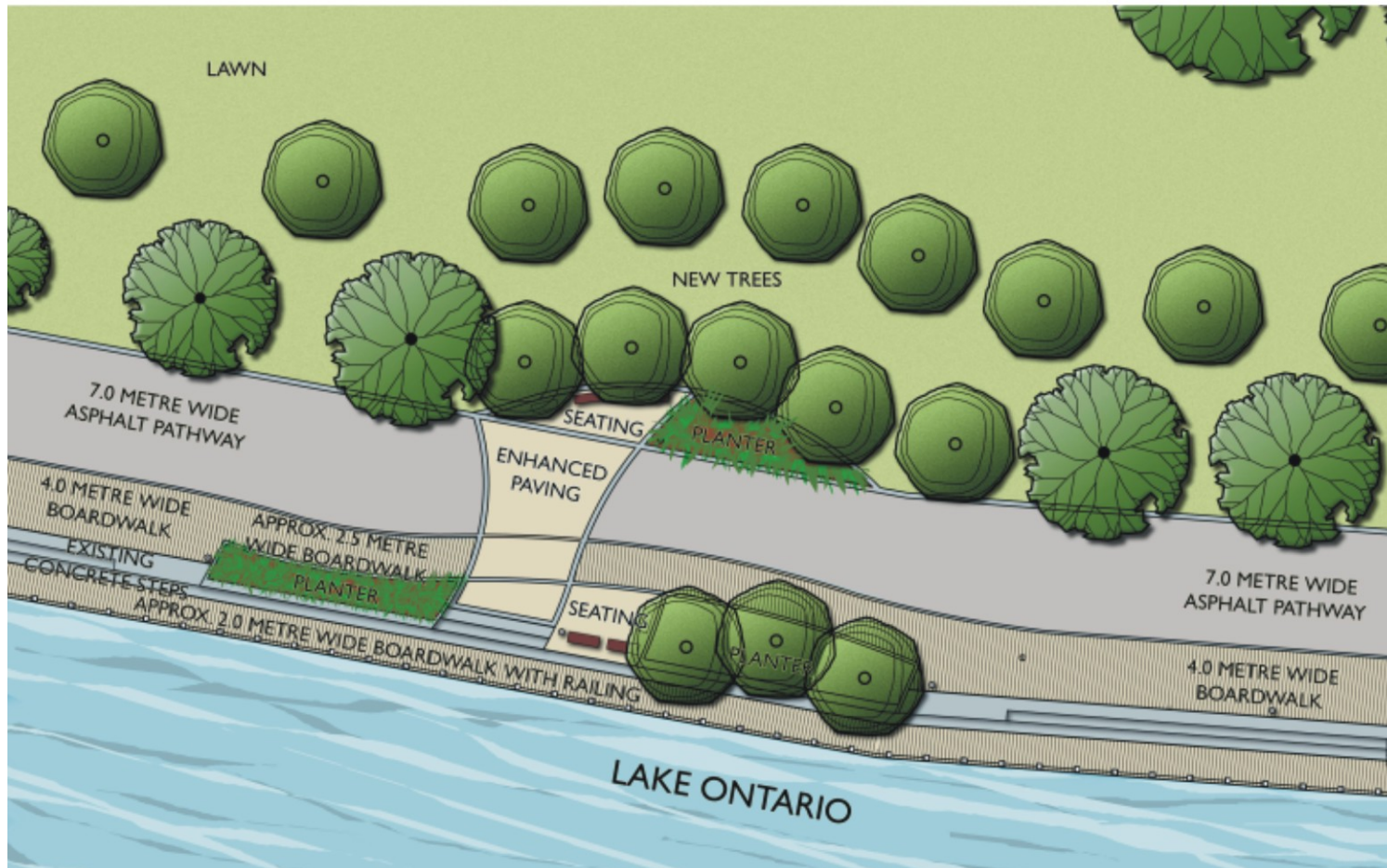

SEATING AREA ELEMENTS:

- Seating and Viewing Areas
- Tree Planting
- Ornamental Planting
- Enhanced Paving
- Bicycle Lock-Ups
- Waste Bins/Recycling
- Lighting
- Pathway and Orientation Signage

2. TYPICAL SEATING AREA - PLAN

Marilyn Bell Park – Promenade Seating



SEATING AREA ELEMENTS:

- Seating and Viewing Areas
- Tree Planting
- Ornamental Planting
- Enhanced Paving
- Bicycle Lock-Ups
- Waste Bins/Recycling
- Lighting
- Pathway and Orientation Signage

Marilyn Bell Park – Promenade Western Terminus

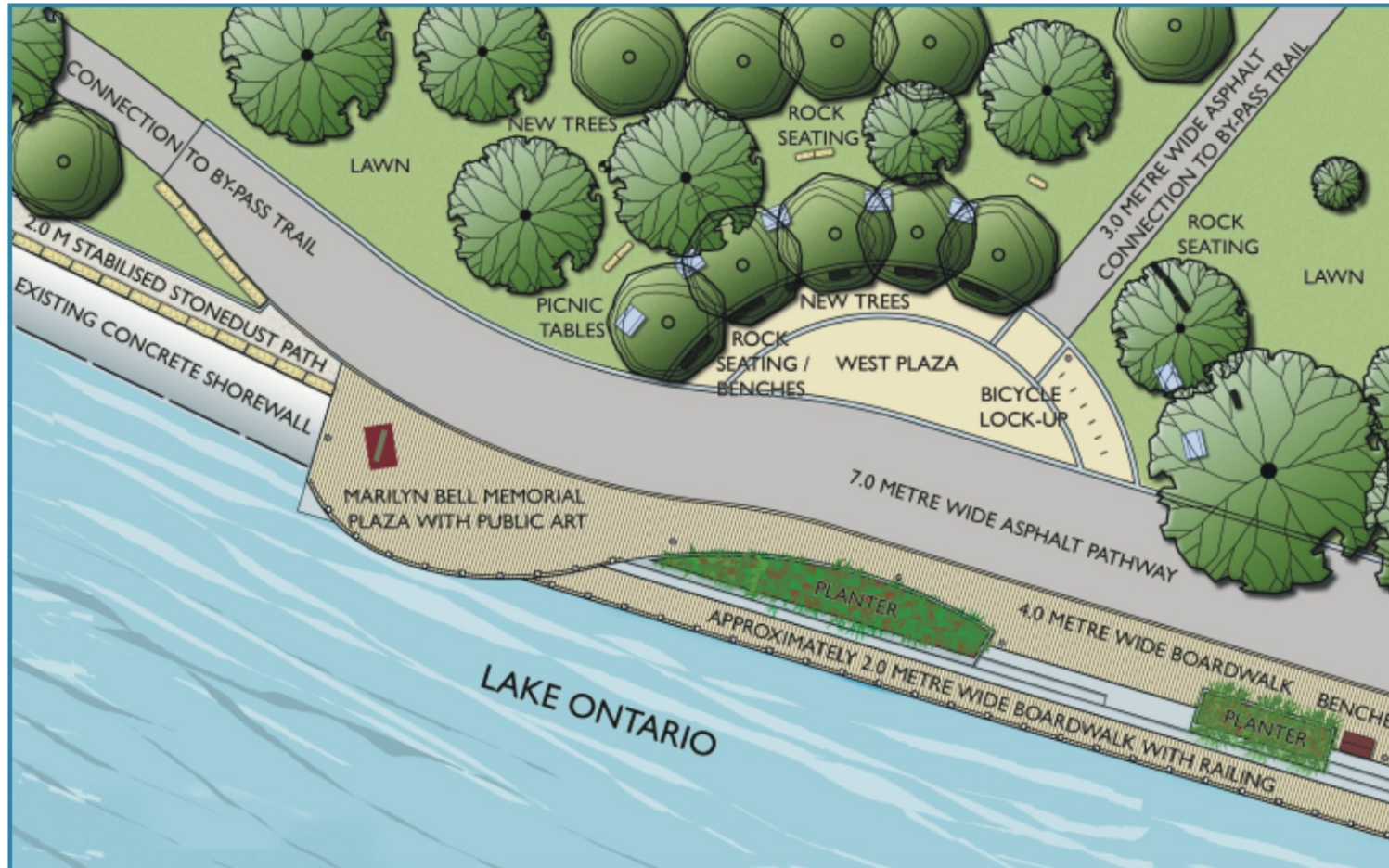

WESTERN TERMINUS ELEMENTS:

- Paved 'Event Area'
- Connections to Marilyn Bell Park Bypass Trail and West to Existing Martin Goodman Trail
- Tree Planting
- Ornamental Planting Areas
- Bicycle Lock-Ups
- Lighting
- Seating and Viewing Areas (benches and seating rocks)
- Picnic Areas
- Waste Bins/Recycling
- Public Art Opportunities
- Marilyn Bell Memorial
- Pathway and Orientation Signage

3. WESTERN TERMINUS - PLAN

Marilyn Bell Park - Promenade Western Terminus



WESTERN TERMINUS ELEMENTS:

- Paved 'Event Area'
- Connections to Marilyn Bell Park Bypass Trail and West to Existing Martin Goodman Trail
- Tree Planting
- Ornamental Planting Areas
- Bicycle Lock-Ups
- Lighting
- Seating and Viewing Areas (benches and seating rocks)
- Picnic Areas
- Waste Bins/Recycling
- Public Art Opportunities
- Marilyn Bell Memorial
- Pathway and Orientation Signage

Marilyn Bell Park - Promenade Eastern Gateway

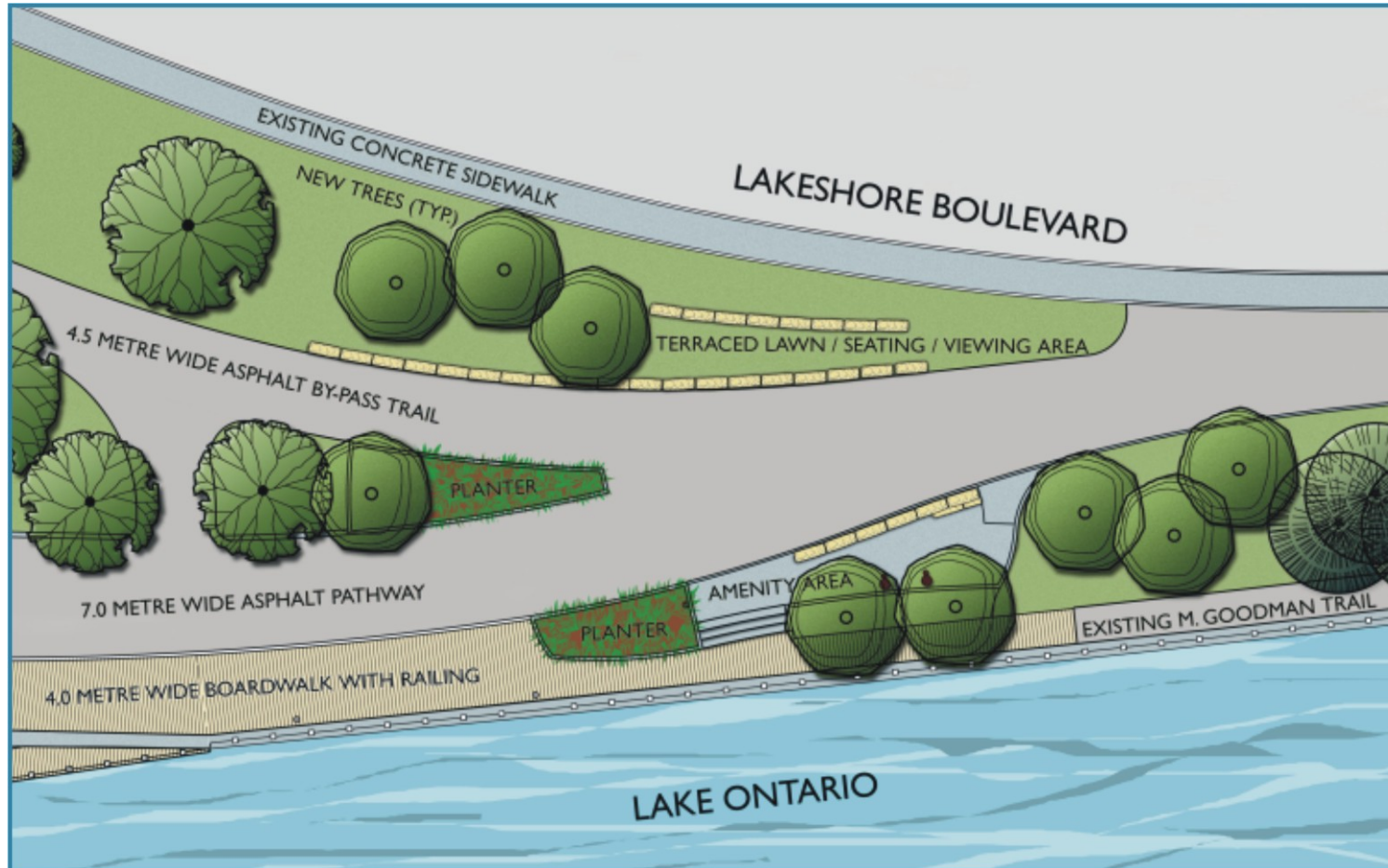

EASTERN GATEWAY ELEMENTS:

- Seating and Viewing Areas (benches and seating rocks)
- Connections to Marilyn Bell Park Bypass Trail and East to Exhibition Place Bypass Trail and Existing Martin Goodman Trail
- Tree planting
- Ornamental Planting Areas
- Enhanced Paving
- Lighting
- Bicycle Lock-Ups
- Drinking Fountains
- Waste Bins/Recycling

4. EASTERN GATEWAY - PLAN

Marilyn Bell Park - Promenade Eastern Gateway

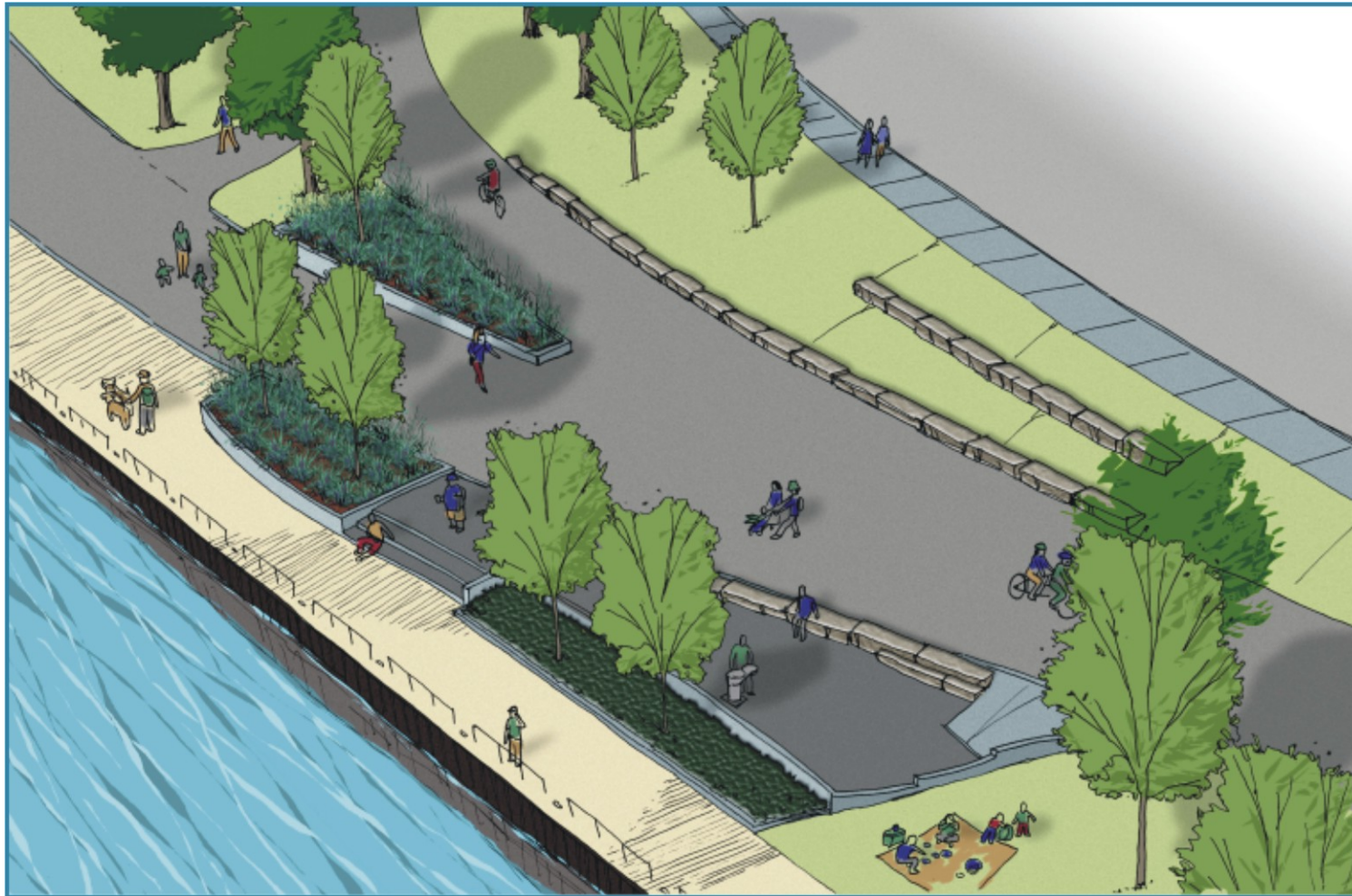

EASTERN GATEWAY ELEMENTS:

- Seating and Viewing Areas (benches and seating rocks)
- Connections to Marilyn Bell Park Bypass Trail and East to Exhibition Place Bypass Trail and Existing Martin Goodman Trail
- Tree planting
- Ornamental Planting Areas
- Enhanced Paving
- Lighting
- Bicycle Lock-Ups
- Drinking Fountains
- Waste Bins/Recycling

Marilyn Bell Park - Promenade Terrace

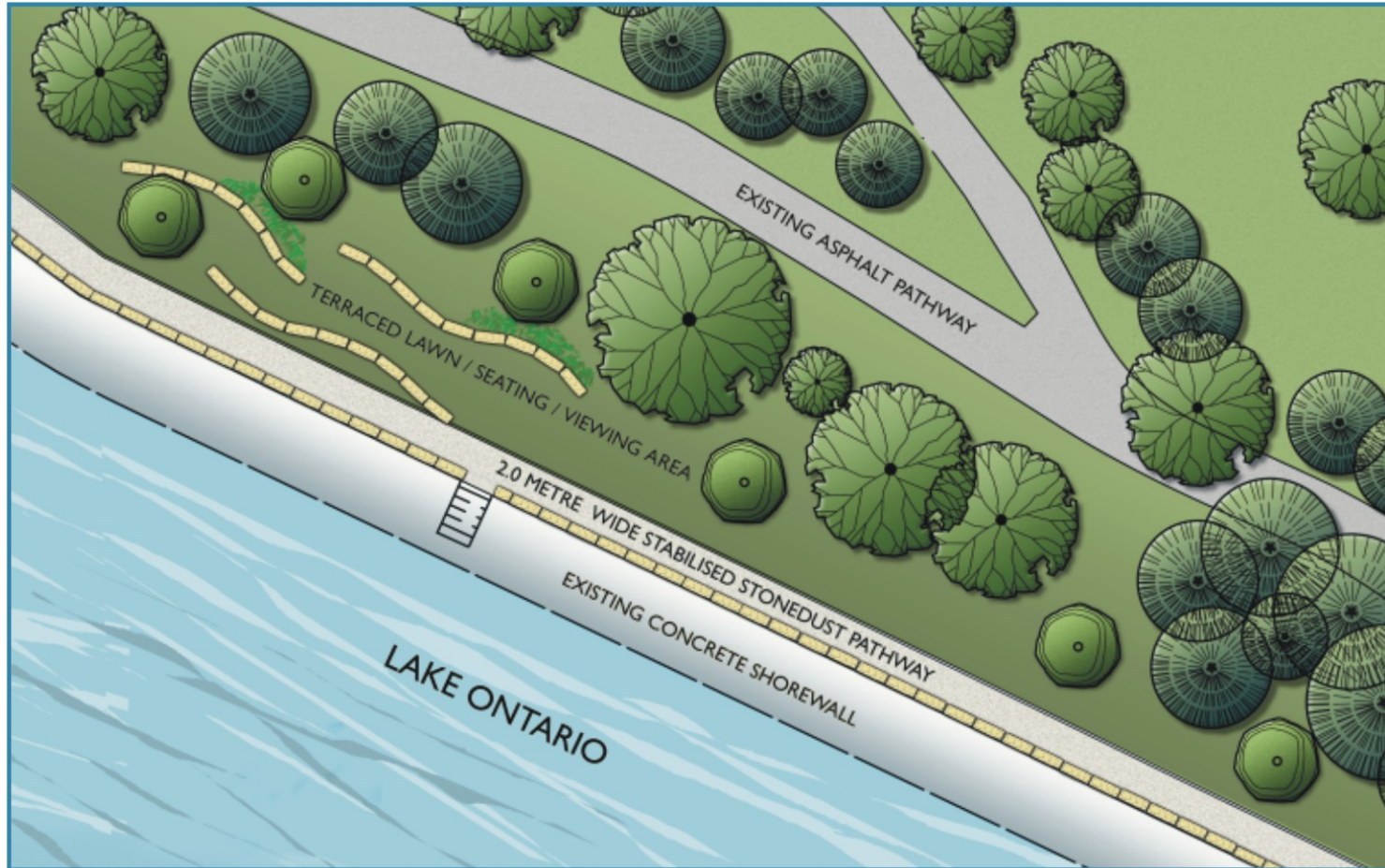

WEST OF PROMENADE ELEMENTS:

- Tree Planting
- Stabilized Stonewall Pathway
- Event Viewing Area
- Rock Seating Terraces

5. TERRACE/LANDSCAPE AREA - PLAN

Marilyn Bell Park - Material Selections



"TREX" RECLAIMED WOOD AND PLASTIC BOARDWALK.
LOW GALVANISED METAL RAILING.



NATURAL STONE SEATING BOULDERS.



PAVING COLOUR SCHEME PRECEDENT.



PLANTERS WITH BOLD GRASSES, PERENNIALS AND
SMALLER TREES.



GALVANISED METAL RAILING ALONG
BOARDWALK EDGE.



COMFORTABLE, ELEGANT AND STURDY BENCHES.
PICNIC TABLES FOR INFORMAL GATHERINGS.
BICYCLE PARKING AT CONVENIENT LOCATIONS.



CAFÉ STYLE TABLES AND CHAIRS FOR WEST END PLAZA.



DURABLE METAL DRINKING FOUNTAINS WITH BOTTLE
REFILL OPTION AND DOG DRINKING BOWL AT
EASTERN AMENITY AREA.



MODERN LIGHT FIXTURES WITH "DARK SKY" LUMINAIRES
AND ENERGY EFFICIENT, LOW EMISSION LIGHTS.

Exhibition Place Trail Adjacent to Lakeshore



- **Bypass trail creates a year-round alternative to the waterfront promenade**
- **The waterfront promenade can be readily contained when gates are closed**
- **The Bailey bridge will be improved**

Exhibition Place Trail Adjacent to Lakeshore

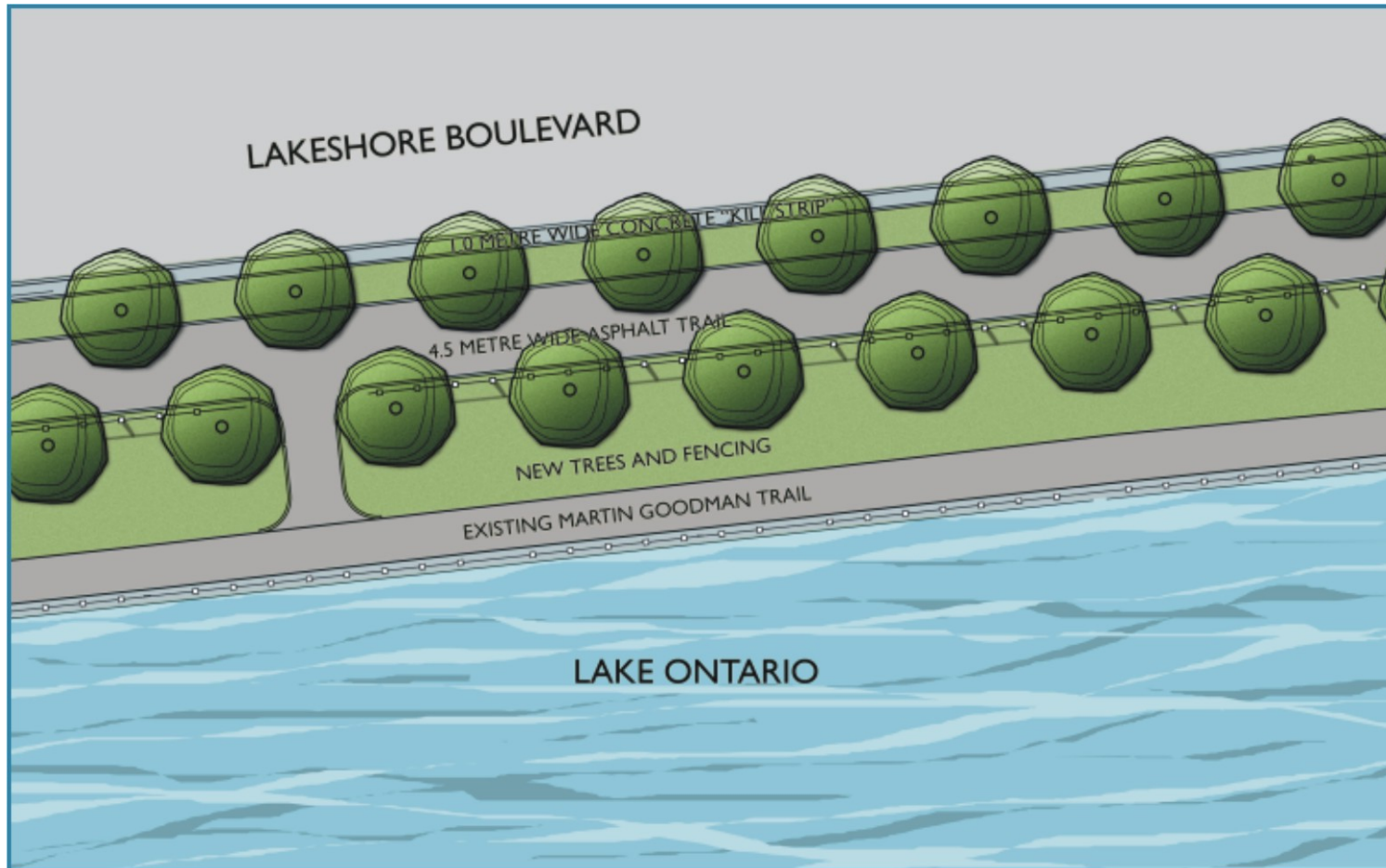

EXHIBITION PLACE BYPASS TRAIL ELEMENTS:

- 4.5 metre Wide Asphalt Pathway adjacent to Lakeshore Boulevard, with 'kill strip' and tree-planting separation
- Connections to Existing Martin Goodman Trail
- Tree planting

EXHIBITION PLACE BYPASS TRAIL - PLAN

Exhibition Place Trail Adjacent to Lakeshore

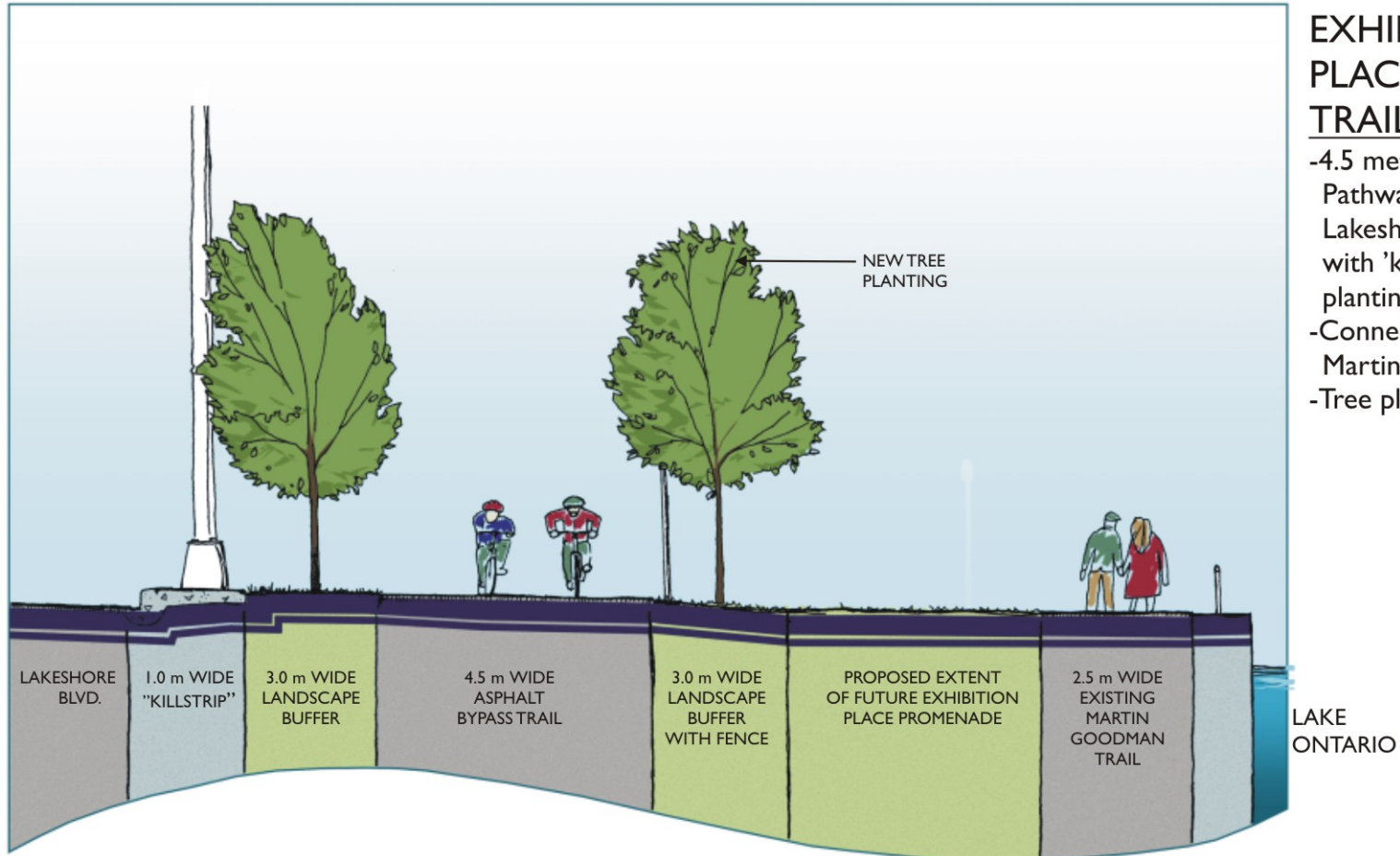

EXHIBITION PLACE BYPASS TRAIL ELEMENTS:

- 4.5 metre Wide Asphalt Pathway adjacent to Lakeshore Boulevard, with 'kill strip' and tree-planting separation
- Connections to Existing Martin Goodman Trail
- Tree planting

EXHIBITION PLACE BYPASS TRAIL - CROSS SECTION

Ontario Place – Some Challenging Conditions

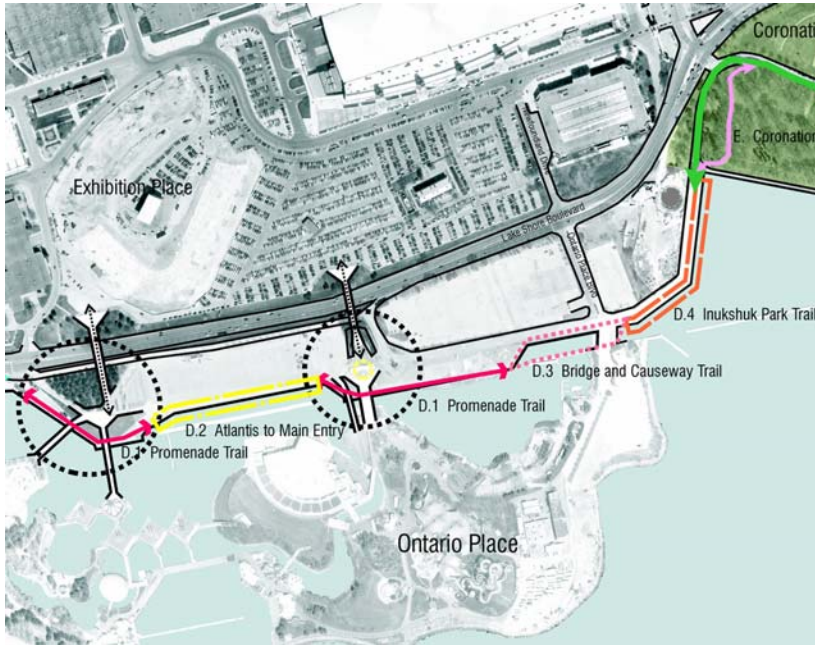

- **Poor Condition and poor separation of trail users from the roadway at the east end**
- **Conflicts with pedestrians and stairs at the ticket area. Relocate trail under the bridge across the water.**

Ontario Place – Some Challenging Conditions



- **Circuitous, confusing route around the ticket area**
- **Trail not clearly defined. Poor separation from vehicular traffic**
- **Narrow and unsafe pathway alignments**

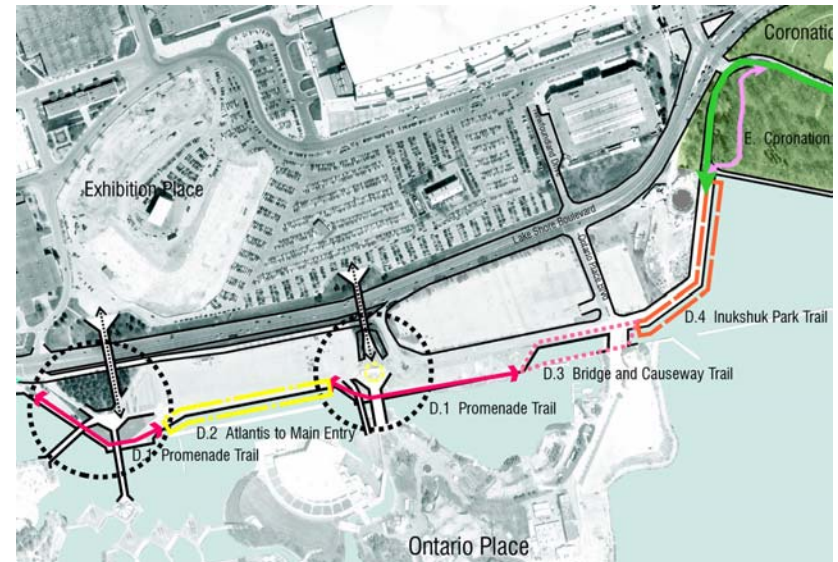

2005 - 2006 Trail Improvements

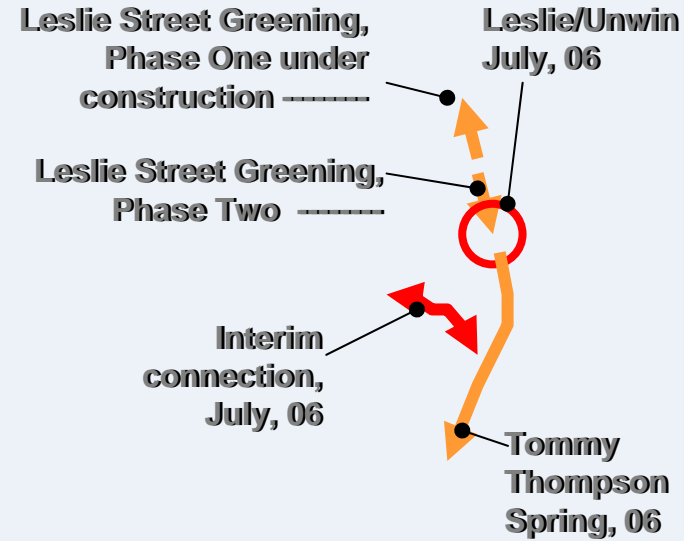

Martin Goodman Trail

Improvement Update

F E E D B A C K

Here is how you can provide your thoughts, comments and feedback

- Participate in the Question and Comments Session to follow
- Tour the exhibits and speak with the TWRC and Consulting team after the Comments Session
- Fill out a Workbook Comment Sheet
- Forward your comments by Email; kfindlay@towaterfront.ca





TORONTO WATERFRONT
REVITALIZATION CORPORATION

www.towaterfront.ca