

Nov 2025

Construction Notice #: 64

Port Lands Flood Protection & Lake Shore Boulevard East Projects



Construction Manager: EllisDon



Traffic Notice

Westbound Lake Shore Bridge Closed for up to 10 Days for Construction Starting November 28

Beginning 9:00 pm on Friday, November 28, the westbound Lake Shore Bridge located at Lake Shore Boulevard East will be closed for up to 10-days to install a new water main crossing and expansion joint work. This work is to support the final stages of construction for the Lake Shore Bridge as the project moves towards substantial completion by December 2025.

Traffic impacts will include a lane reduction on the eastbound Lake Shore Bridge to create a temporary westbound lane. Two eastbound lanes and one westbound lane will be maintained, with 24/7 traffic control personnel managing the intersection at Lake Shore Boulevard East and Don Roadway throughout the closure. Heavy trucks are not permitted to turn right from the Don Roadway off-ramp onto Lake Shore Boulevard East westbound; due to the limited turning radius and safety considerations, trucks may only continue south on Don Roadway or turn left onto Lake Shore Boulevard Eastbound.

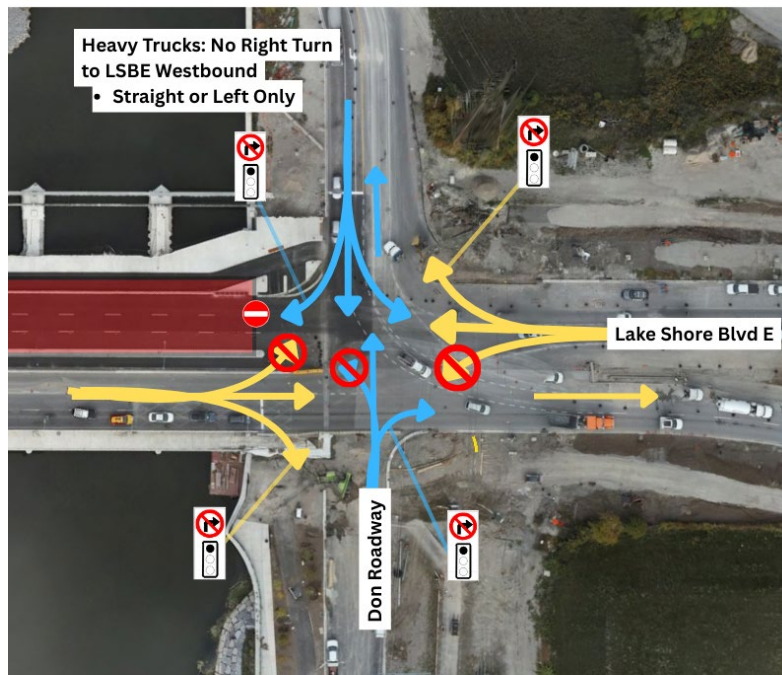

Above: an aerial photo of the Lake Shore Boulevard East and Don Roadway intersection, illustrating the turn restrictions and the westbound Lake Shore Bridge closed. Please note that this map is for illustration purposes and does not replicate the exact traffic conditions of the intersection.

Don Roadway Open as of November 28 2025 at 9:00 pm

Don Roadway South will open to pedestrians, cyclists, and drivers on November 28 at 9:00 pm. The newly constructed roadway has been raised to a higher elevation for flood protection and redesigned with dedicated pathways for walking and cycling, providing a new connection to the Biidaasige Park trail system. Turn restrictions will be in place at Lake Shore Boulevard East and Don Roadway until the end of 2025.

Traffic restrictions are as follows:

- Going Eastbound:
 - Left turns onto the DVP ramp
- Going Westbound
 - Left turns onto Don Roadway
- Going Northbound on Don Roadway
 - Left turns on to Lake Shore Boulevard
- Going Southbound off the Don Valley Parkway ramp
 - Heavy trucks are not permitted to make a right turn due to the limited turning radius; trucks must continue southbound on Don Roadway and detour via Commissioners Street.

Questions?

To learn more about this project, please visit the [Lake Shore Boulevard East Project Webpage](https://www.waterfronttoronto.ca/our-projects/lake-shore-boulevard-east-project) (<https://www.waterfronttoronto.ca/our-projects/lake-shore-boulevard-east-project>)

To send us questions or concerns about construction, use this [online inquiry form](https://bit.ly/PL-LSBE-form) (bit.ly/PL-LSBE-form).

You can also email us at plfp@ellisdon.com.

Waterfront Toronto

251 Queens Quay East, Suite #301, Toronto, Ontario, M5A 0X3.
416-214-1344 | www.waterfronttoronto.ca | info@waterfronttoronto.ca

