

May 11, 2023

A sneak peek at the future eastern waterfront

Welcome

Meg Davis, Chief Development Officer
Waterfront Toronto

Agenda

1. **Welcome and Land Acknowledgement**
Meg Davis, Chief Development Officer, Waterfront Toronto
2. **Indigenous Ceremony**
Shelley Charles, Ojibwe Elder, MinoKamik Collective
3. **Opening Remarks**
Leslie Woo, Waterfront Toronto Board of Directors
George Zegarac, CEO, Waterfront Toronto
4. **Project Presentations**
 - Waterfront East LRT: Nigel Tahair, City of Toronto
 - Quayside Public Realm: Pina Mallozzi, Waterfront Toronto
 - Quayside Development: Tony Medeiros, Quayside Impact
 - Destination Playground: Chris Glaisek, Waterfront Toronto
5. **Thank You and Wrap Up**

Open House!





Land Acknowledgement

Waterfront Toronto acknowledges that the land upon which we are undertaking our revitalization efforts is part of the traditional territory of the Mississaugas of the Credit First Nation and that Toronto is covered by Treaty 13 with the Mississaugas of the Credit First Nation.

In addition, Waterfront Toronto acknowledges that Toronto has historically been a gathering place for many Indigenous people, including the Mississaugas of the Credit, the Anishnabeg, the Chippewa, the Haudenosaunee and the Wendat peoples, and is home to many First Nations, Inuit and Métis peoples today.

Indigenous Opening

Shelley Charles, Ojibwe Elder

MinoKamik Collective

Opening Remarks

Leslie Woo, Board Member

Waterfront Toronto

Waterfront Toronto Introduction

George Zegarac, CEO

Waterfront Toronto



2005

Waterfront East LRT

Nigel Tahair, Program Manager, Transportation Planning
City of Toronto

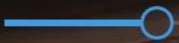
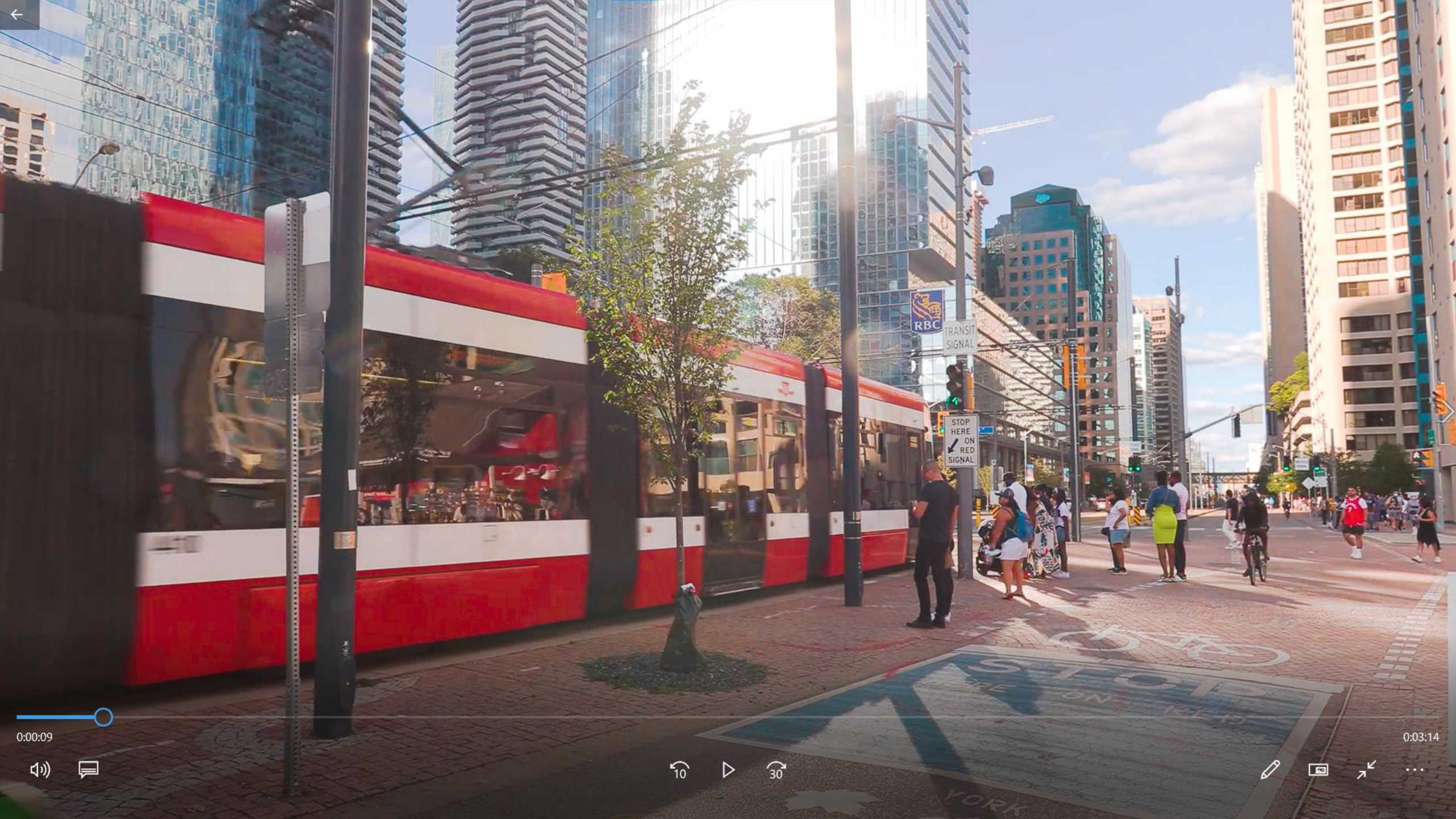

0:00:09

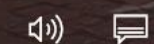

0:03:14

Quayside Infrastructure and Public Realm

Pina Mallozzi, Senior Vice President, Design
Waterfront Toronto

Quayside Context



Quayside Components

- Quayside Infrastructure & Public Realm
- Quayside Development
- 1

Parliament Street
- 2

Parliament Grove
- 3

North-South Streets
- 4

Queens Quay East
- 5

Water's Edge Promenade
- 6

Silo Park
- 7

Parliament Slip
- 1

The Western Curve
- 2

Timber House
- 3

The Overstory
- 4

Community Forest
- 5

Urban Farm
- 6

Future Development Blocks
- 7

Block 5





Parliament Street

Community Forest

Parliament Grove

Queens Quay East

Parliament Slip

Silo Park

Keating Channel

Port Lands & Villier's Island

A Continuous Green Edge

Queens Quay East



North-South Streets



Neighbourhood Groves



Opportunists



Elders

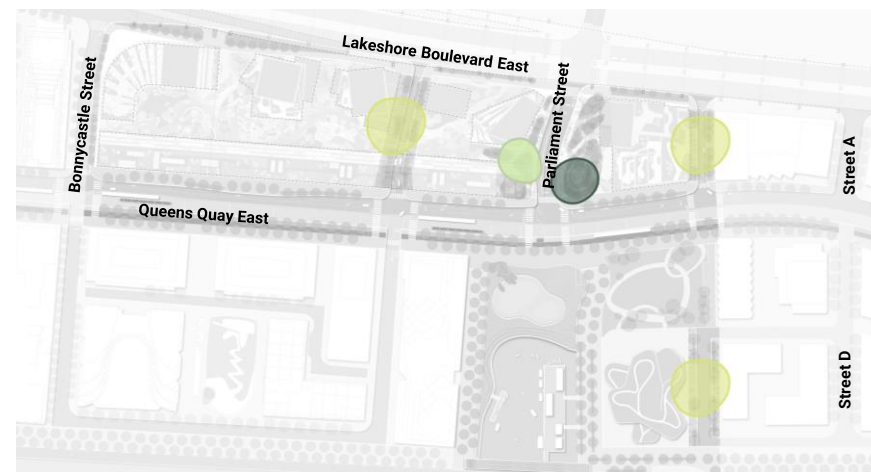

Small Street



Street A



Street D

Parliament Grove



Plan view of Parliament Grove and Parliament Street



Artist's rendering of "Lookout"



Artist's rendering of "Rock Scramble"

Parks and Public Spaces



Proposed Water's Edge Promenade at Quayside



East Bayfront Water's Edge Promenade

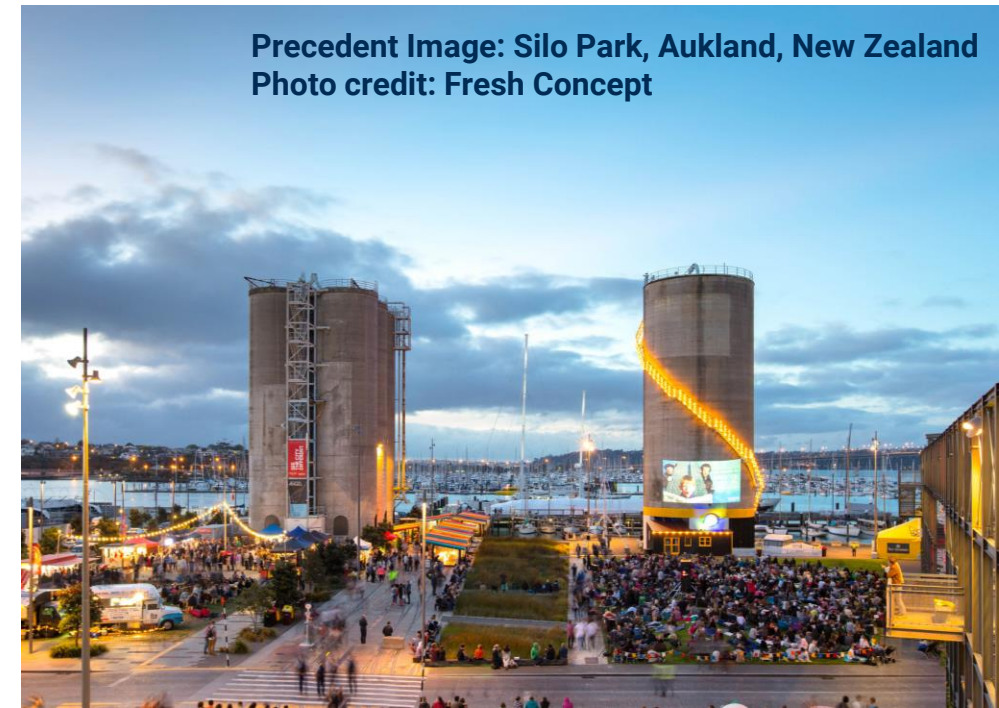

Precedent Image: Silo Park, Auckland, New Zealand
Photo credit: Fresh Concept

Keating Channel Bridge

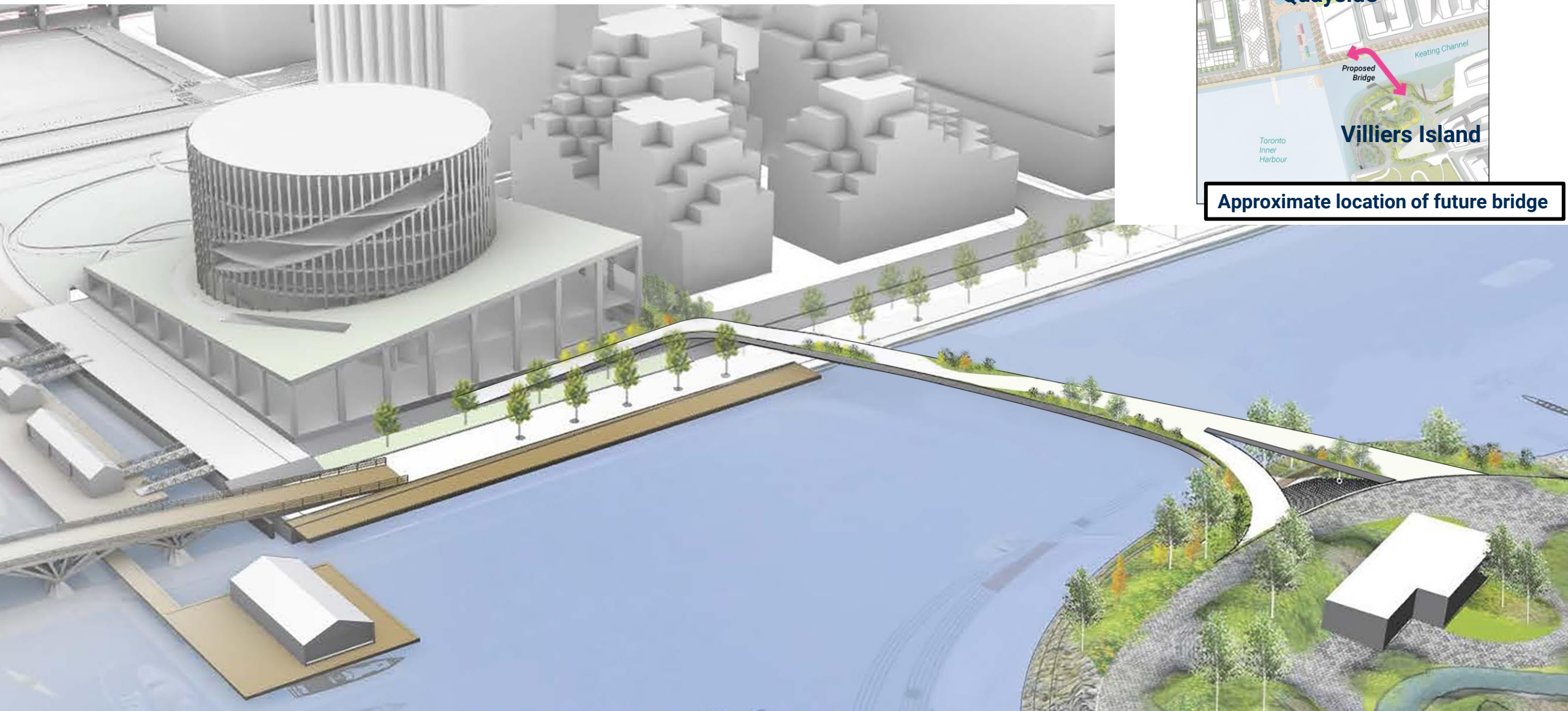

Approximate location of future bridge

Conceptual rendering of future bridge

Quayside Development Planning

Tony Medeiros, Development Lead, Dream

Adidharma Purnomo, Great Gulf

Quayside Impact Limited Partnership (Dream & Great Gulf)

Quayside – Where the city meets the water

An aerial sketch map of the Quayside area in London. The map shows the city skyline with numerous buildings, the river, and various districts. The Quayside area is highlighted in yellow. The map is divided into several sections by dashed blue lines. The districts labeled are East Bayfront, Quayside, Distillery District, West Don Lands, Villiers Island, and Don River. The Inner Harbour is also labeled. The map is a hand-drawn style with green trees and blue water.

East Bayfront

Quayside

**Distillery
District**

**West Don
Lands**

Inner Harbour

Villiers Island

Don River

Team



Development Partner



Quayside Impact LP



Community Partners



Host Nation



Block 3 + Affordable Housing



Adjaye Associates
Architects



Alison Brooks Architects
Architects



Henning Larsen
Architects



Two Row Architects
Architects



SLA
Landscape
Architects



Mixed-Use Community: ~3,800 affordable and market units, 300,000 sf of non-res, Cultural space on Block 5

Inclusive, not exclusive: 800+ affordable housing units, aging-in-place strategy, barrier-free open space network

Great place to live, work and play: Two-acre forested green space, rooftop urban farm, a multi-use arts, Indigenous-centered cultural celebrations

Vibrant economic activity supporting retail and economic activity: Strong social and workforce benefits + significant social procurement opportunities for MCFN

Environmental leadership: Canada's first all-electric, net-zero community at this scale, one of Canada's largest residential mass timber buildings

Iconic architecture: a visually striking focal point on Toronto's waterfront

Master Plan

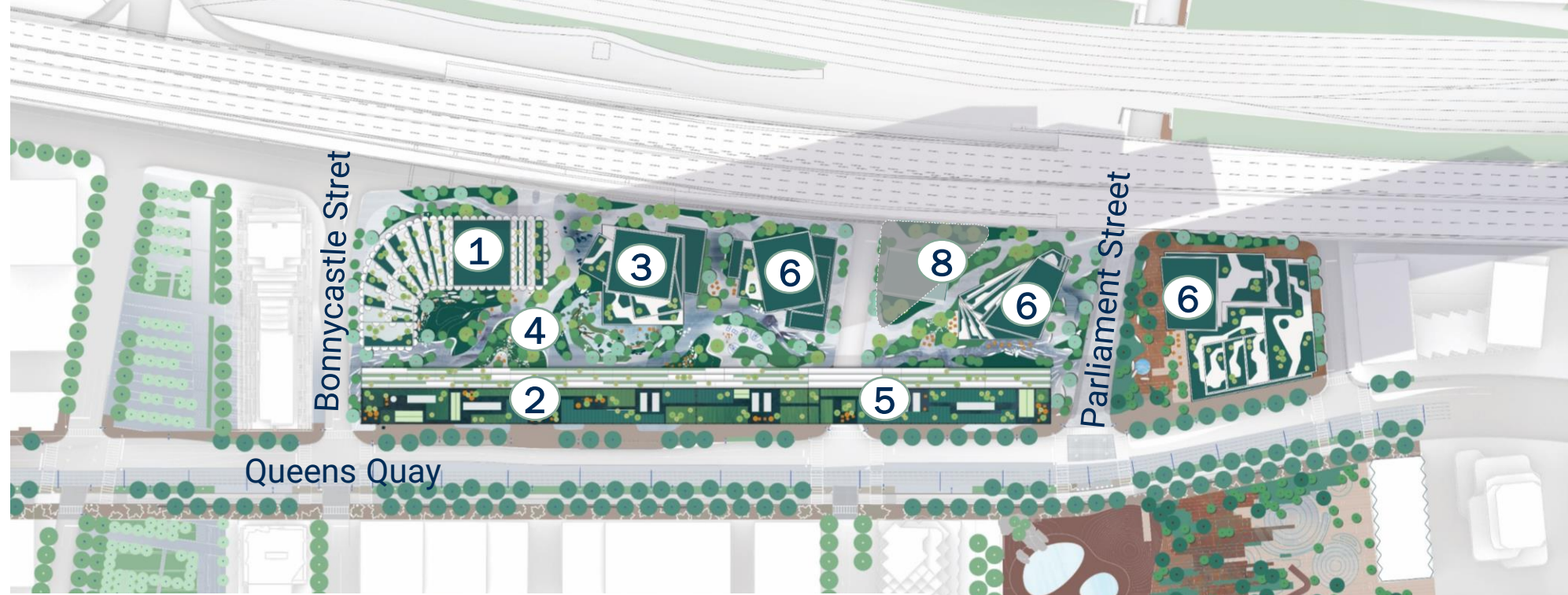

1. The Western Curve (Alison Brooks Architects)
2. Timber House (Adjaye Associates)
3. The Overstory (Henning Larsen)
4. Community Forest (SLA)
5. Urban Farm (atop Timber House)
6. Future development blocks, subject to design competitions
7. Block 5 (Cultural destination/Potential school site)
8. Privately-owned development site (307 Lake Shore Blvd.)



The Western Curve (Alison Brooks Architects)



The Western Curve & Community Forest (SLA)



Community Hub (Henning Larsen)



Timber House (Adjaye Associates)



Urban Farm/ Community Forest (SLA)



Destination Playground

Chris Glaisek, Chief Planning and Design Officer
Waterfront Toronto

The Heart of a Riverside Park System

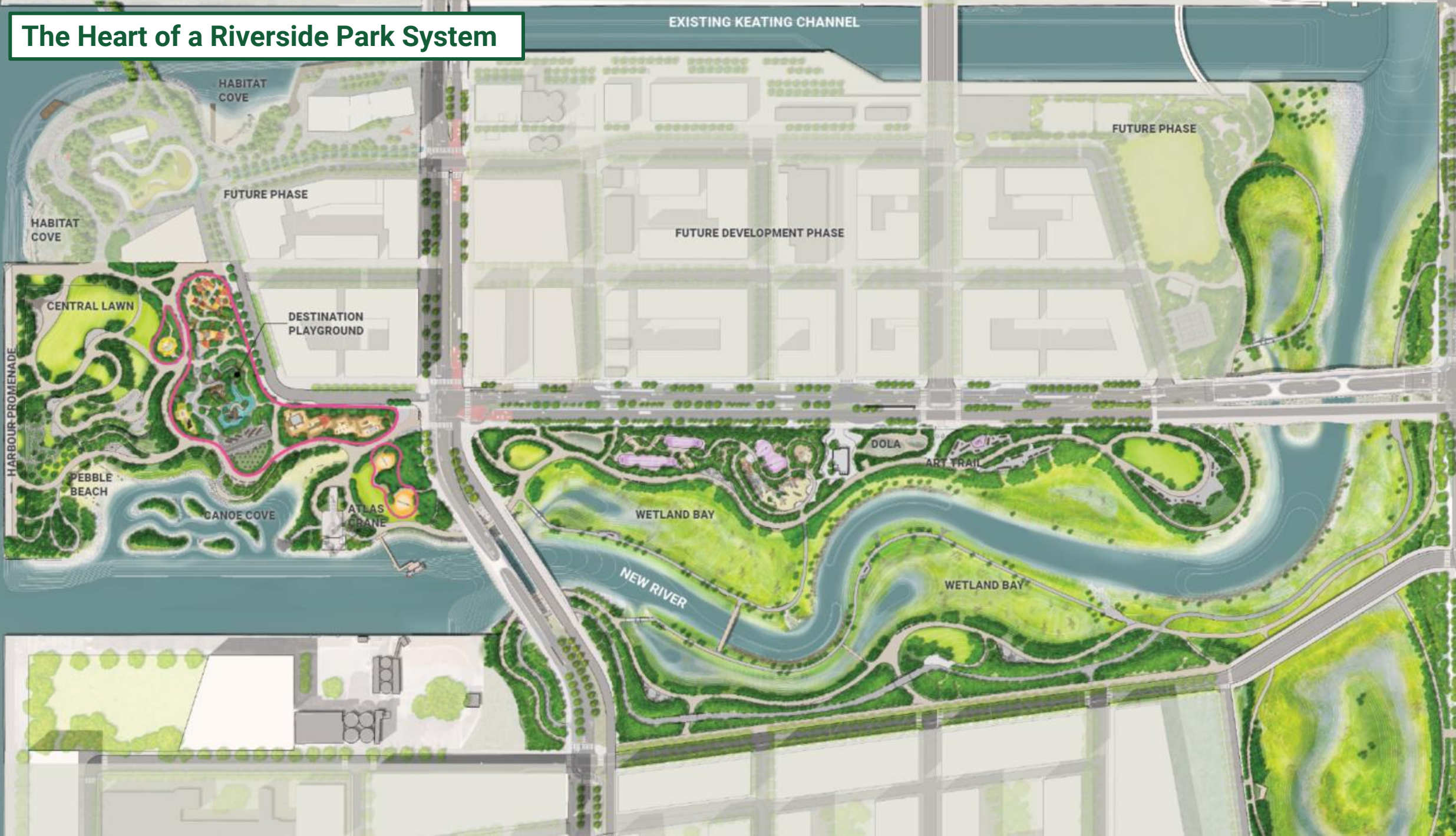

TORONTO HARBOUR

Maggie Daley Park, Chicago



Gathering Place, Tulsa



Eight Garden Rooms



1. Mighty Moose Adventure Area



2. Black Bear Campsite



3. Harbour Master Marina



4. Fireboat Splash Zone



5. Swing Garden



6. Learning Centre, Café and Terrace Building



7. Sunrise Garden



8. Toronto Tower Lookout



Thank You!

We are hard at work creating
a waterfront that belongs to everyone.



The background is a complex abstract composition of various geometric shapes. Large green circles and semi-circles are prominent at the top. A yellow square is in the top left. The middle section features a grid of green and light blue squares on the left, and a series of overlapping blue triangles and circles on the right. A dark blue semi-circle is at the bottom right. The entire composition is set against a light blue background.

a waterfront for everyone