



Destination Playground Schematic Design November 30, 2022

Site Context – Existing Conditions

Destination Playground

Review Stage: Schematic Design

Proponent: Waterfront Toronto

Design Team: MVVA



Site Context – Full Buildout

Destination Playground

Review Stage: Schematic Design

Proponent: Waterfront Toronto

Design Team: MVVA



Project Background

Destination Playground
Review Stage: Schematic Design
Proponent: Waterfront Toronto
Design Team: MVVA

- The Destination Playground and Pavilion are located within Promontory Park South. Promontory Park South is being delivered as part of the larger Port Lands Flood Protection project.
- **The Destination Playground is unfunded** and anticipated to be delivered through philanthropic funding. **This project is scalable based on the success of the fundraising initiative**
- We are completing 30% schematic design and a phased implementation strategy to support our fundraising efforts.
- The playground was previously reviewed by the Panel (April 2020) in-camera, due to ongoing procurement negotiations with the play design manufacturers

Project Background – Precedent Study

Gathering Place, Tulsa Oklahoma

Destination Playground
Review Stage: Schematic Design
Proponent: Waterfront Toronto
Design Team: MVVA

- From July 9 – 12, 2022 WT and PF&R staff traveled to Tulsa to learn about the Gathering Place
- Meetings were held with a focus on design, operations and fundraising to help gain insight into how we might deliver a Destination Playground in Toronto.
- The following slides provide a summary of some of the lessons learned from the trip



Design Observations

Gathering Place, Tulsa Oklahoma

Destination Playground
Review Stage: Schematic Design
Proponent: Waterfront Toronto
Design Team: MVVA

- 7.5-acre Chapman Playground, situated within the 66-acre Gathering Place Park in Tulsa, Oklahoma.
- Opened in 2018, the park and playground draw more than 2 million visitors a year, far exceeding initial projections.
- The \$460M Gathering Place Park was made possible entirely by philanthropy, with nearly 90 individual philanthropic contributions totaling \$210M matched by a \$350M donation from the George Kaiser Family Foundation.
- The Gathering Place has been named as USA Today's Best New Attraction and one of National Geographic's 12 Mind Bending Playgrounds, and an Urban Land Institute Global Excellence Award in 2019



Cohesive Play Experience

- Playground is dispersed throughout the 65 acre Gathering Place Park site but experienced as one place



Best in Class Access to Play

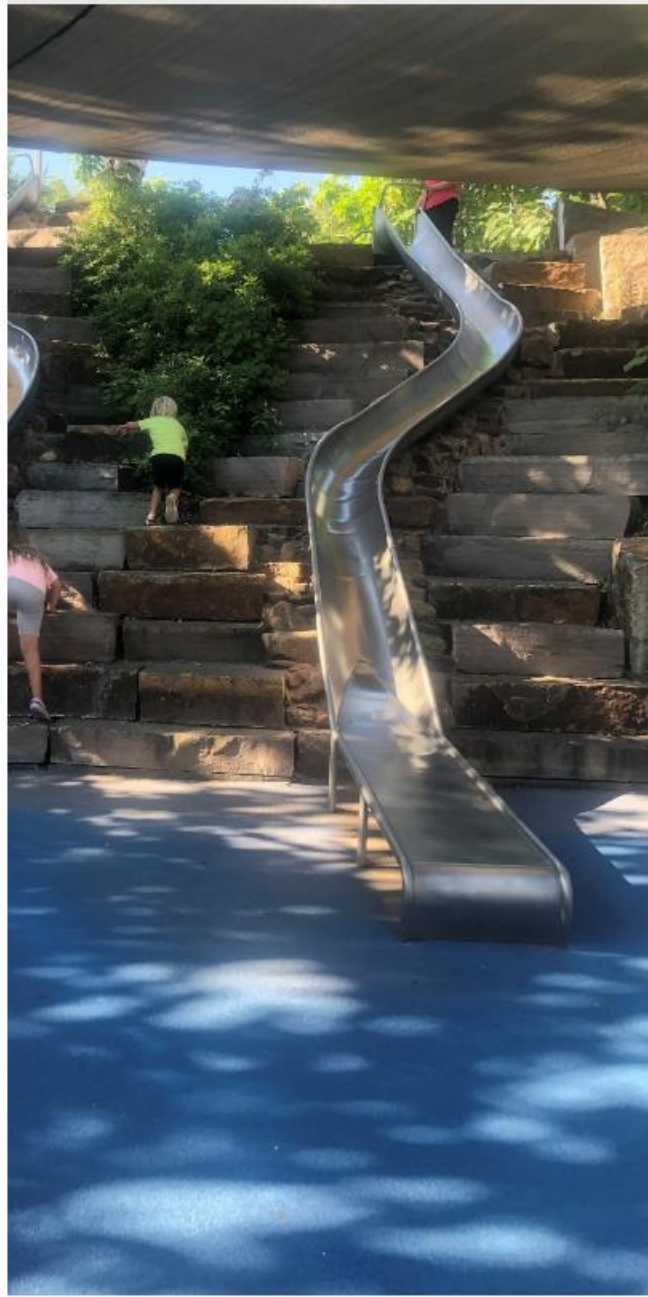

Integrate Nature and Play



Design for User Experience (seating, shade)



Team Structure

Destination Playground
Review Stage: Schematic Design
Proponent: Waterfront Toronto
Design Team: MVVA

Landscape Lead Designer

- Landscape and Play Design
- O+M Strategy
- Support WT fundraising initiative

MVVA

Pavilion Architect

- Architectural professional services for the Pavilion located in Promontory Park South

LGA

Play Equipment Design & Supply

- Design, manufacture, deliver and certify play equipment, including both custom-built pieces and standard equipment

**Monstrum, APE Studio,
Earthscape & Wholetrees**

Anticipated Project Timeline

Destination Playground
Review Stage: Schematic Design
Proponent: Waterfront Toronto
Design Team: MVVA

Schematic Design (30%): January 2021- March 2023

Design Development (60%): April 2023 - October 2023

Construction Documentation (100%): November 2023 – June 2024

Bidding and Negotiations: July 2024 – September 2024

Construction –October 2024 – October 2026

Fall 2026 Playground Opening

Project Approval Stage

DRP Stream 2: Public land – Agency Sign-off

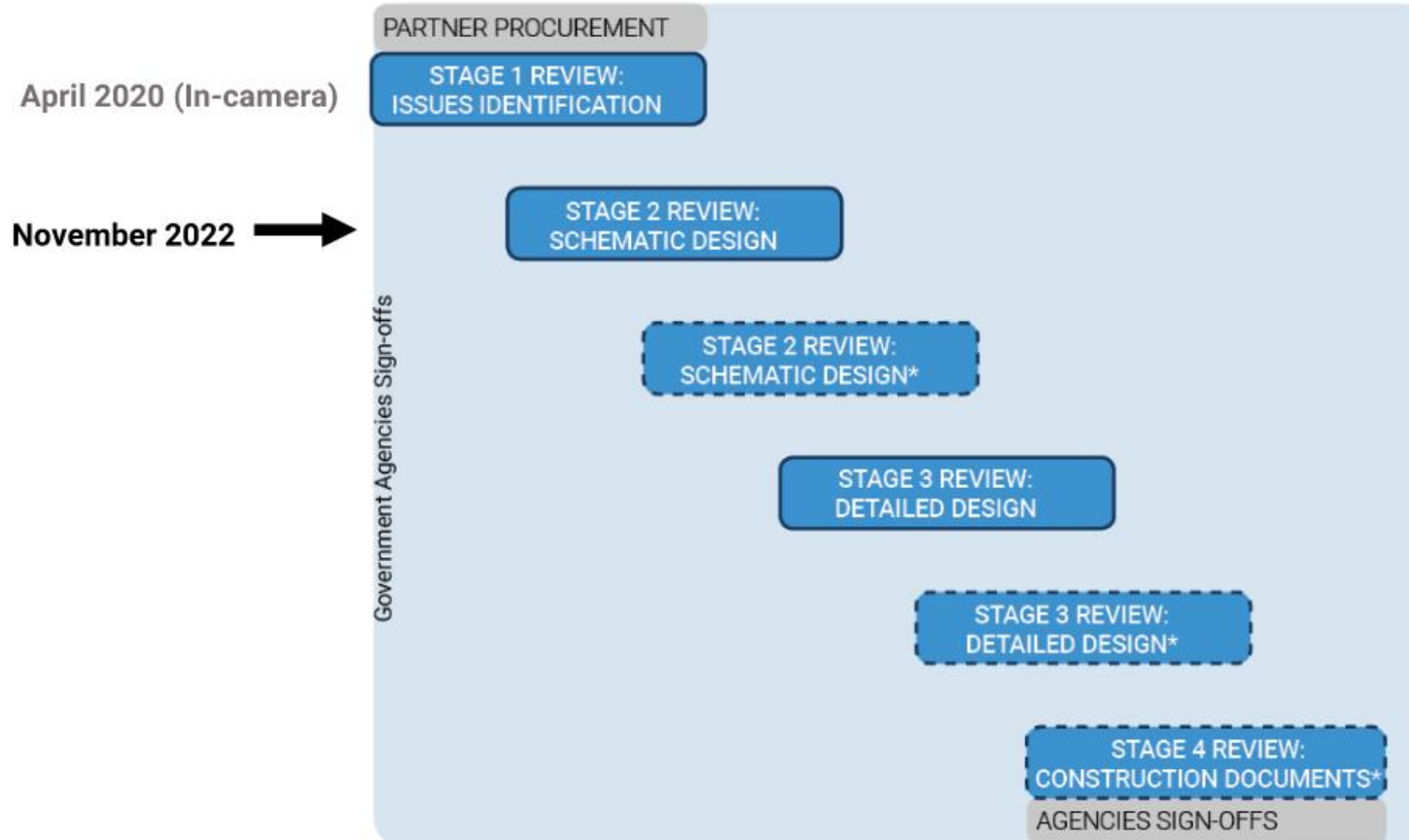

*This review will only be required if the project has changed significantly since the previous review, or the Panel, Waterfront Toronto, or City staff have significant outstanding concerns.

Previous WDRP

April 2020 Issues Identification (Playground)

Destination Playground

Review Stage: Schematic Design

Proponent: Waterfront Toronto

Design Team: MVVA



Consensus Comments

April 2020 Issues Identification (Playground)

- Appreciative of the work that has taken place.
- Further clarification of the themes is needed, while keeping in mind the fundraising requirements and considerations.
- Seek ways to integrate nature into the play areas.
- Ensure the play area themes will appeal to not only the Toronto market but beyond. Consider the heritage and iconography of the site (industry, infrastructure, previous ownership and occupation), and the value of play for a wider demographic – both kids and adults!
- Consider seasonal impacts in the design and operation of the play areas.
- Provide management strategy with the anticipation that the areas will be highly used and visited.
- Consider harmonizing the colors of the various play areas.

Areas for Panel Consideration

Waterfront Toronto

Destination Playground
Review Stage: Schematic Design
Proponent: Waterfront Toronto
Design Team: MVVA

- Reconfiguration of garden rooms and integration of increased landscape elements
- Addition of garden rooms including contemplation garden, swing garden and sunrise garden
- Integration of Pavilion into the landscape
- Conceptual expansion to include play areas in River Valley Park North
- Introduction of topographical variation throughout the playground

Destination Playground Design Review Submission Phase 2

Prepared for Waterfront Toronto Design Review Panel
30 November 2022

Michael Van Valkenburgh Associates, Inc.
Landscape Architects

The Port Lands - Under Construction



Play Areas within the The Port Lands

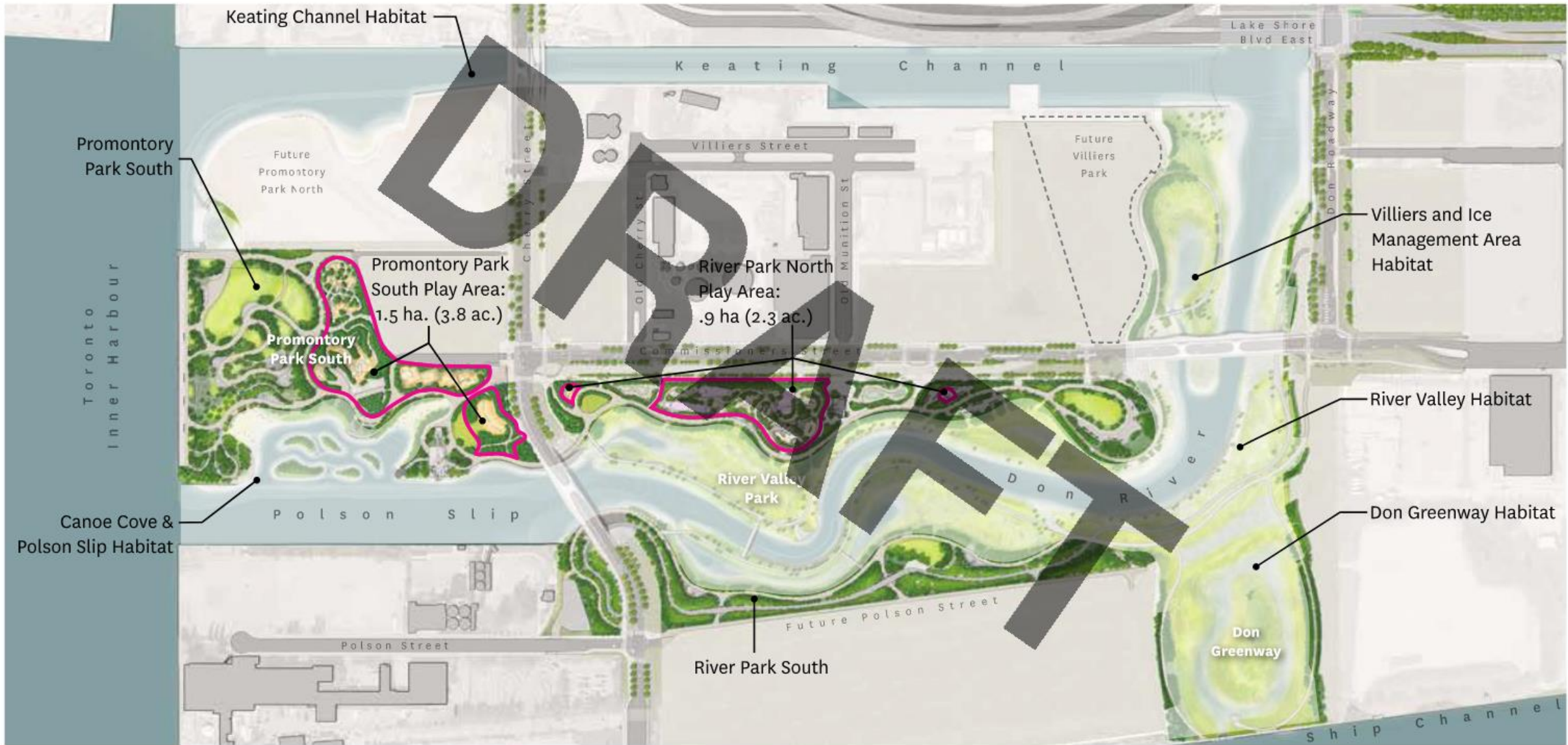

Project Feedback

Design Review Panel (4/22/2020)

- Impressed with the current iteration and looks forward to review the project again in the near future.
- Ensure the play area themes will **appeal to not only the Toronto market but beyond**
- **Consider seasonal impacts** in the design and operation of play areas
- Provide management strategy with anticipation that areas will be highly used and visited
- Consider **harmonizing the colors of the various play areas**
- Further clarification of the themes is needed, while keeping in mind the fundraising requirements and considerations.
- **Consider the heritage and iconography of the site** (industry, infrastructure, previous ownership and occupation), and the value of play for a wider demographic – both kids and adults!
- Appreciative of the work that has taken place.

Design Review Panel (5/25/2022)

- Appreciated concept of **embedding the building in the landscape.**
- Final buildout of Villiers Island will be a very popular destination with both local and outside visitors
- **Consider strategies in crowd control** for the pavilion and adjacent open space, especially during popular summer and winter events.
- Consider an interim park access strategy including transit and parking.
- Continue **meaningful consultation with Indigenous groups.**
- Reconsider the name “Winter Garden” to help clarify its function.
- Consider including a fire pit.
- **Ensure the space is flexible and can accommodate seasonal functions** to ensure year-round success.
- Consider opportunities in the design that will **highlight the ecological benefits** of the park and the building

Destination Playground Plan - Design Advancement



22 April 2020



30 November 2022



Design Vision for Destination Playground

Framing a Comprehensive Vision

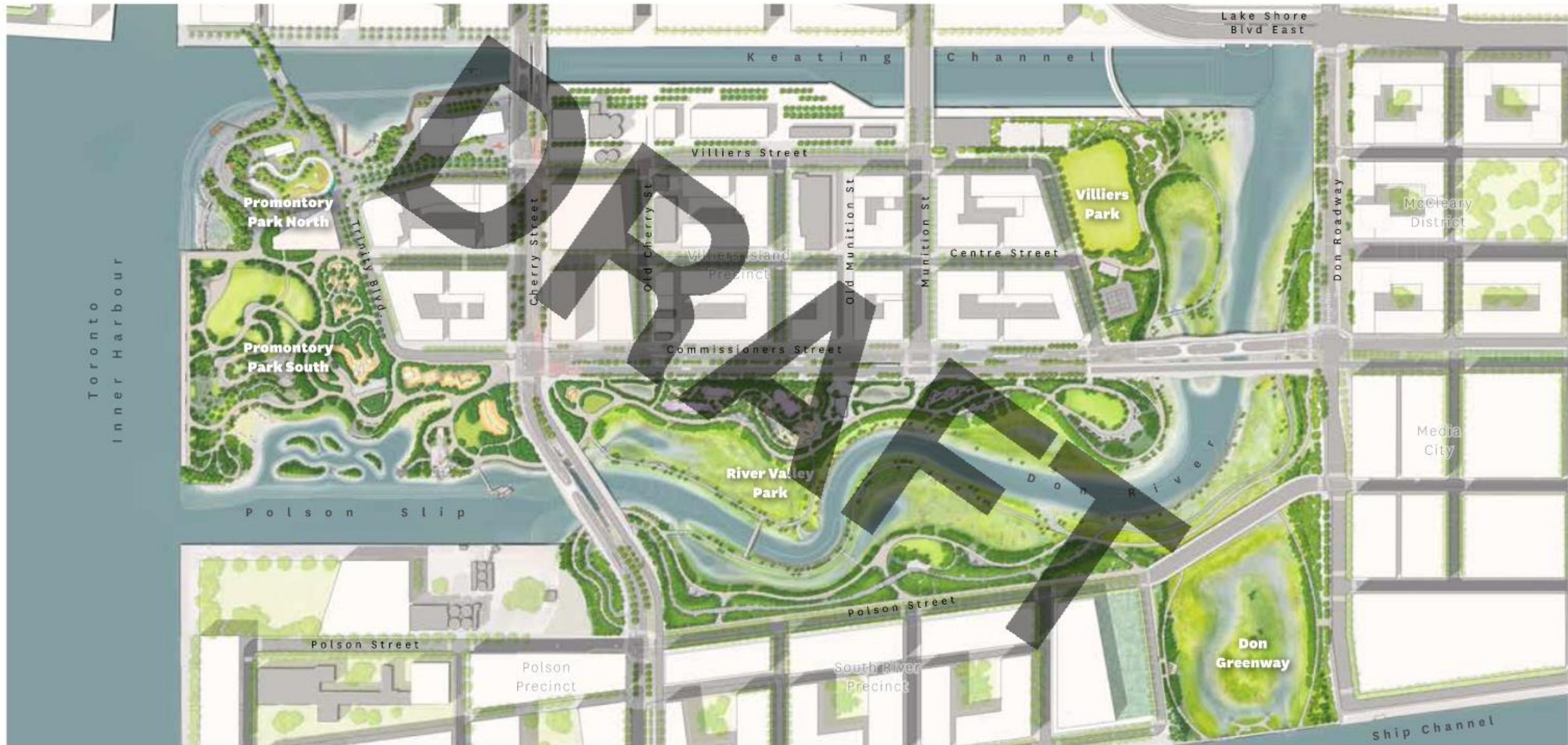

Contextual Analysis of Future Neighborhood



- Employment/Commercial
- Destination/Catalytic Use
- Community Facility
- Residential
- Heritage Structure
- Parks and Open Spaces
- Priority Retail Streets and Frontages
- Secondary Priority Retail Streets

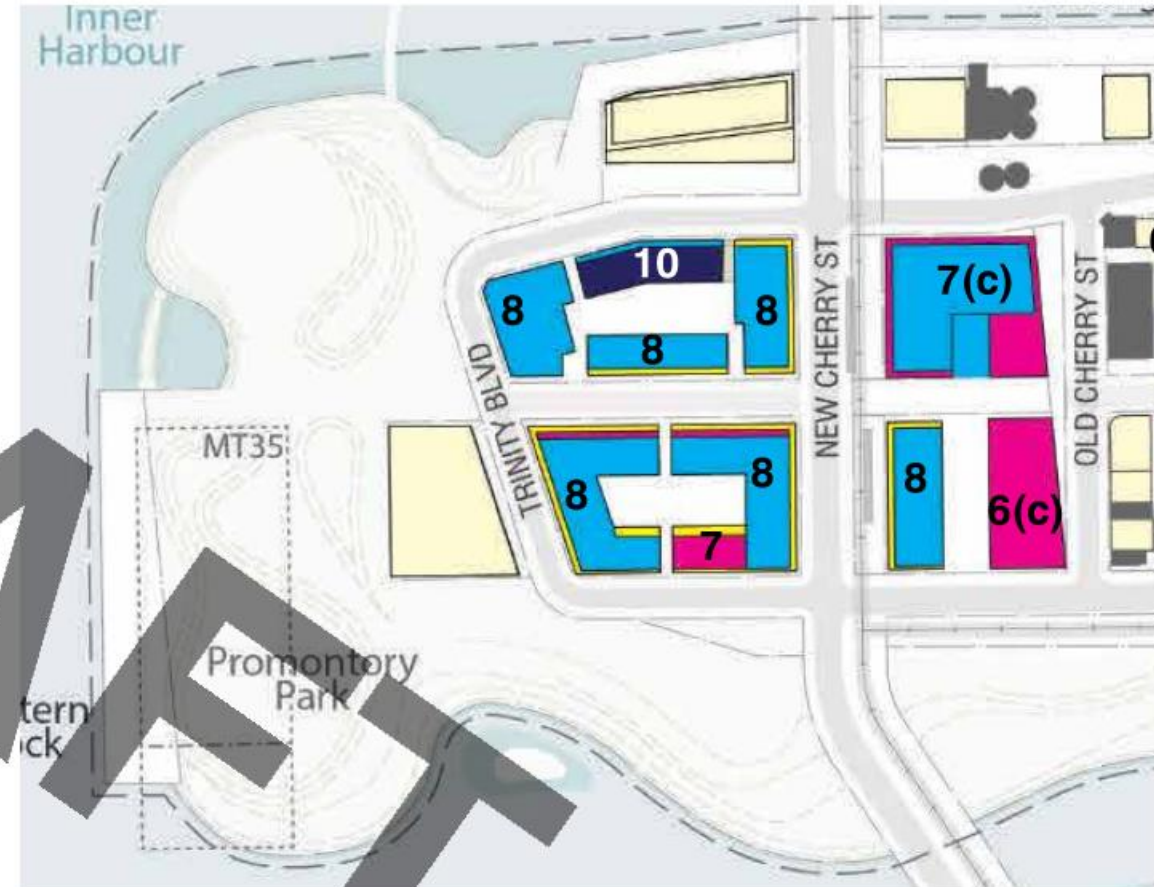

- Low Rise - up to 3 st (commercial) or 5st
- Mid Rise - up to 6 st
- Mid Rise - up to 7 st
- Mid Rise - up to 8 st
- Mid Rise - up to 10 st
- ★ Catalytic Use Building
- Heritage Building

Port Lands Park Programming Types - 2024

- Play Areas
- Dogs Off Leash Area
- Overlook
- Picnic Area
- Urban Esplanade
- Plaza
- Event Lawn
- Passive Use Lawn
- Rocky Edge
- Submergent Marsh
- Emergent Marsh
- Vernal Pool
- Planted Armour Stone
- Wooded Upland
- Gravel Beach
- Canoe/Kayak Access
- Bird Watching
- Overlook
 - Eco Education / Interpretation
- Fishing Node
- Nature Exploration
 - Nature Trail
 - Snowshoeing
 - Cross Country Skiing



PLFP Parks Systems Diagrams

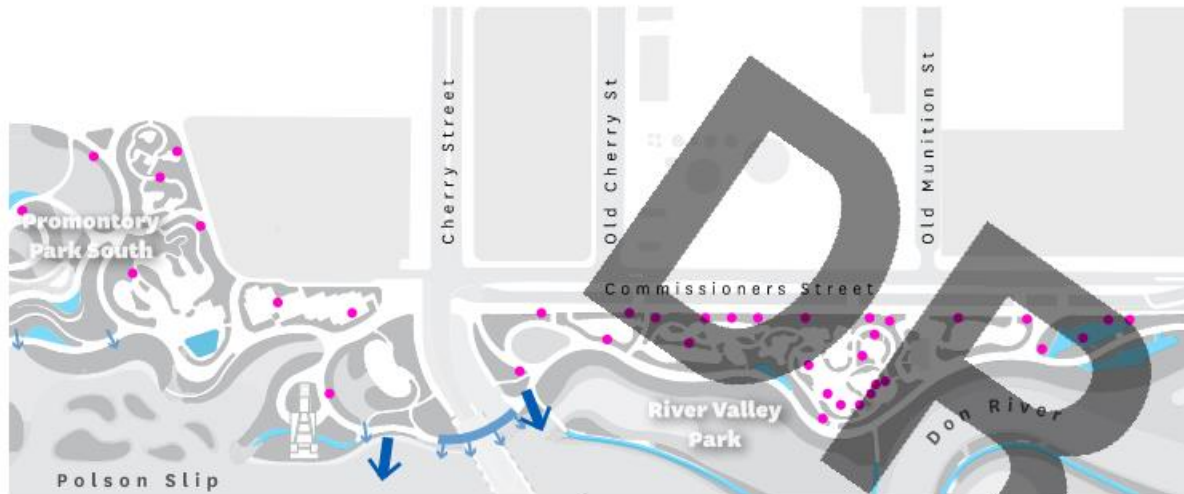

Stormwater Management Infrastructure

- Park Outfall
- Seeps

- Permeable Pavement
- Storm Inlet



Waste Servicing Access

- Waste Receptacles
- Pavilion Waste Collection

- Access Routes
- Park Access Routes



Park Planting Zones

- Garden
- Glade
- Mixed Forest
- Grove
- Hedgerow
- Lawn



Public Art

- Temporary Art - Served
- Permanent Art - Served
- Temporary Art - Not Served
- Art Walk



PLFP Indigenous Design Approaches



Indigenous Plantings

- Garden (Hopi Tobacco, White Sagebrush, Staghorn Sumac, eg.)
- Grove (White Birch, Eastern Cottonwood, Eastern White Cedar, eg.)
- Glade (Black Oak, Black Willow, White Pine, eg.)
- Hedgerow (Eastern Red Cedar, Eastern Redbud, St. John's Wort, eg.)
- Mixed Forest (Tulip Poplar, Yellow Birch, Black Walnut, eg.)
- Wetland (Swamp Milkweed, Sweet Grass, Prairie Cordgrass, eg.)

- Plants selected that have medicinal and cultural significance for Local Indigenous Peoples are integrated into the overall planning approach.

Potential Indigenous Design Site Features



directional compass



fire holder space



cultural markers
(Location TBD)



Interpretive Signage
(Location TBD)



River Interpretation Path
(Location TBD)



pow wow location



Indigenous public art



clan totem in play areas



Sunrise Garden

Indigenous Design Consultation Process

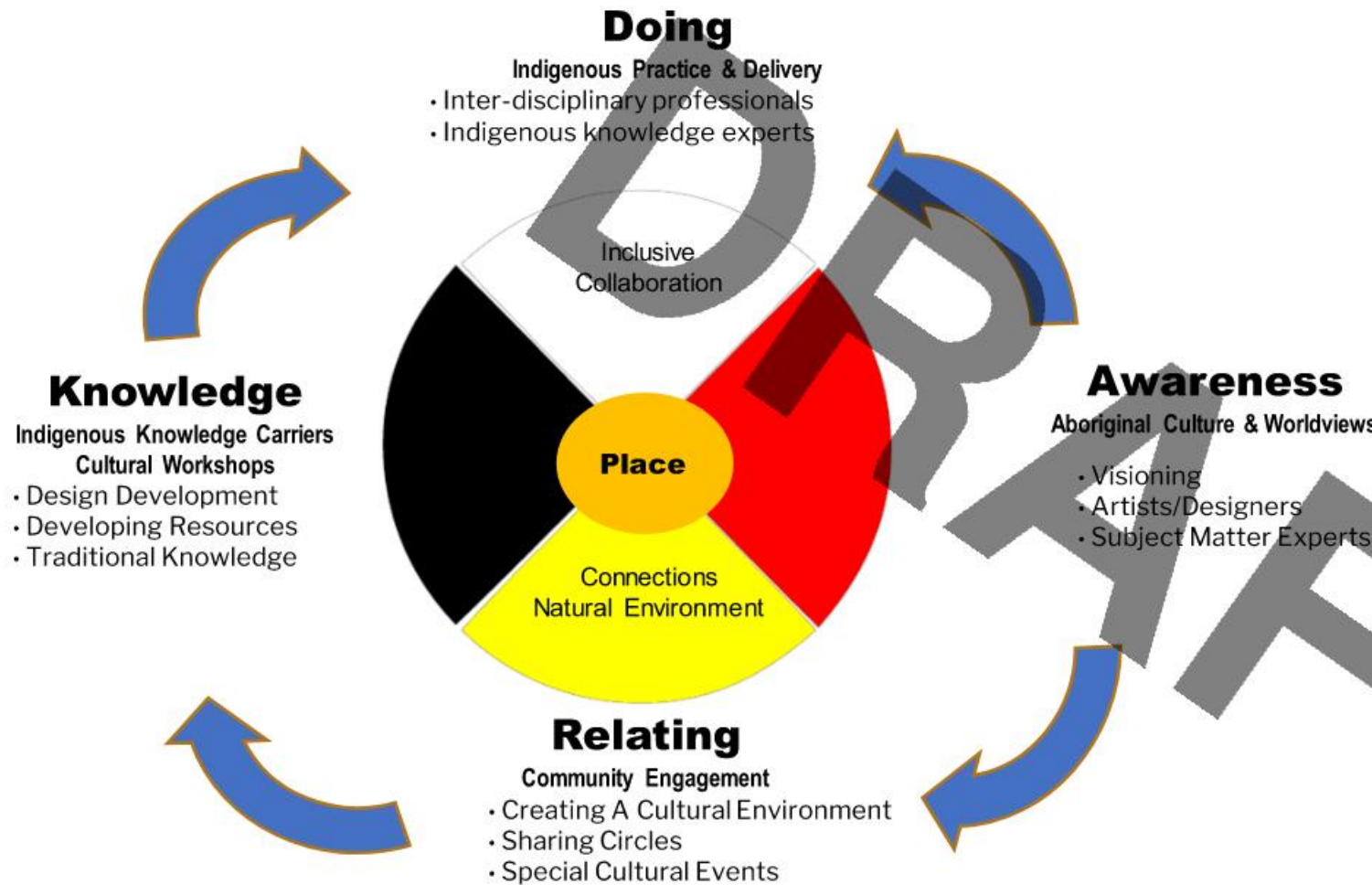

Community Engagement Includes:

- Mississaugas of the Credit
- Alderville, Curve Lake, Scugog
- Beausoleil, Georgina Island, Rama
- Huron Wendat
- Native Canadian Centre of Toronto
- MiziweBiik, Torontoto York Metis Council

Initial Design Responses:

- History - Land Acknowledgements, The Migration Story, Turtle Island Story
- Identity - Clan Based Family Structure, Multiple Languages, Sacred Symbols, Cultural Narratives
- Stewardship - Renewing of the land, water and wildlife
- Inclusion - Indigenous ceremonies shared w/public, access to water's edge



Site Visit and Ceremony

Grounded in WT's Sustainability Principles



Climate Positive

- Support a C40 climate positive development
- Consider renewable energy generation
- Increase carbon sequestration strategies
- Reduce Heat Island Effect



Inclusive Resilience

- Protect 290 hectares of the city from flooding
- Develop inclusive programming to relieve the stresses of city living



Intelligent + Connected

- Explore opportunities for WIFI in Parks and Public Realm
- Connect to larger transportation systems
- Use innovative, sustainable materials and systems



Human Experience-Driven

- Enhance physical, mental and social well-being for the Port Lands community
- Provide access to the Don River and Inner Harbour



Biophilic

- Improve and augment ecosystem health and rehabilitate fish and wildlife habitat

Providing a Variety of Play Value and Character in a Series of Garden Rooms



31 March 2020



30 November 2022



Increasing the Forest Frame to Embed Play in Nature

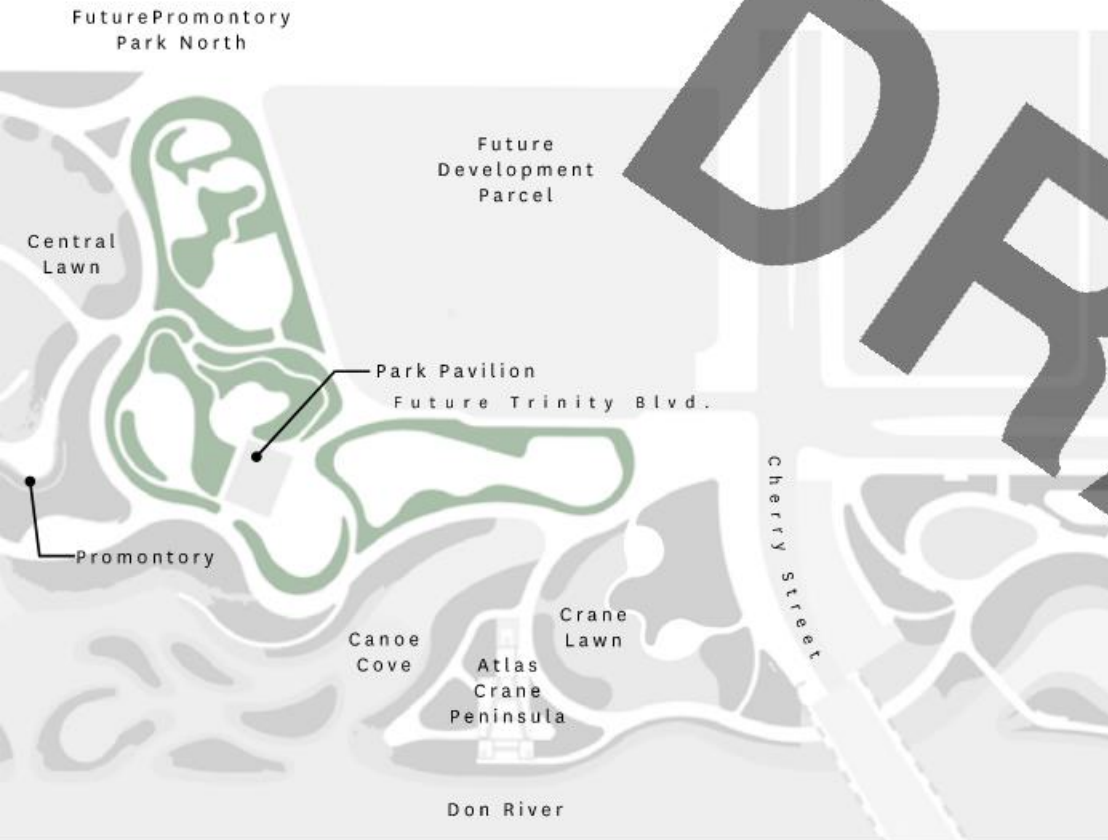

31 March 2020



30 November 2022

0 25 50M

DRAFT

Advancing Play Design

Complimenting the Existing Playgrounds of Toronto With a New Typology



High Park



Dufferin Grove Park



Grange Park



Corktown Common

Bringing a New Playground Design Approach to Toronto



Precedent Playground Research - Scale Comparison



Four Play Types



Kinetic Play



Narrative Play



Nature Play



Water Play

Key Principles in Creating a Cohesive Park Design

Reinforcing the Forest Frame
Integrating into Park Circulation
Creating Inclusive Spaces for Play

DRAFT

Reinforcing the Forest Frame

Park Planting Moments - Diagram

- Hedgerow Spine
- Mixed Hedgerow Spine
- Mixed Forest
- Spire Garden
- Hardwood Forest
- Pollarded Bosque
- Coastal Meadow
- Entry Tunnel
- Sugar Hill
- Poplar Grove



A Range of Landscape Experiences in the Playgrounds



Entrance Tunnel



Mixed Forest



Hedgerow

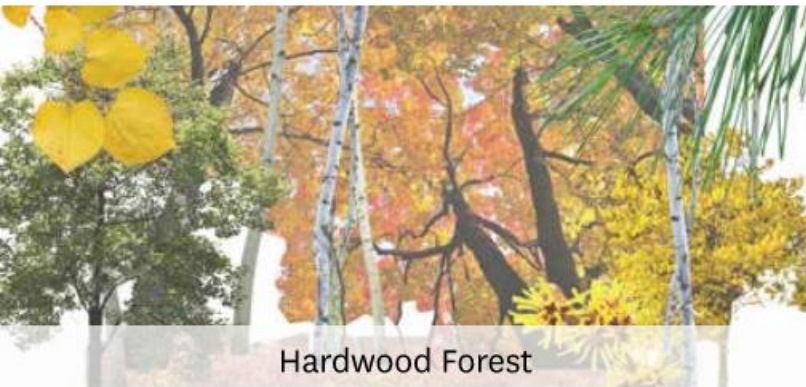

Hardwood Forest



Spire Garden



Pollarded Bosque



Coastal Meadow



Sugar Hill



Poplar Grove

Creating Spaces for Play Immersed Within The Natural Environment



Site Section Through Northern Play Area

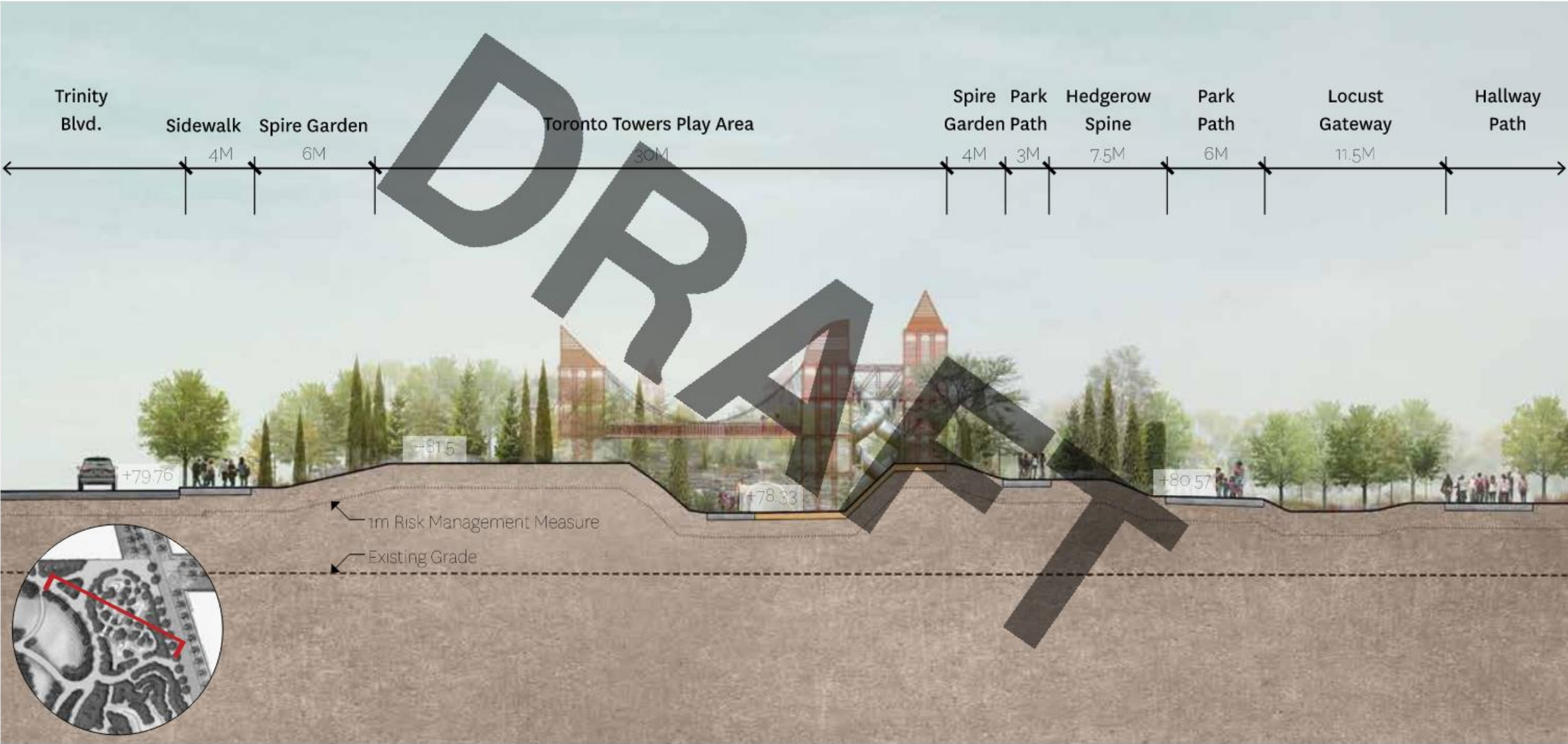

Site Section Through Central Play Area

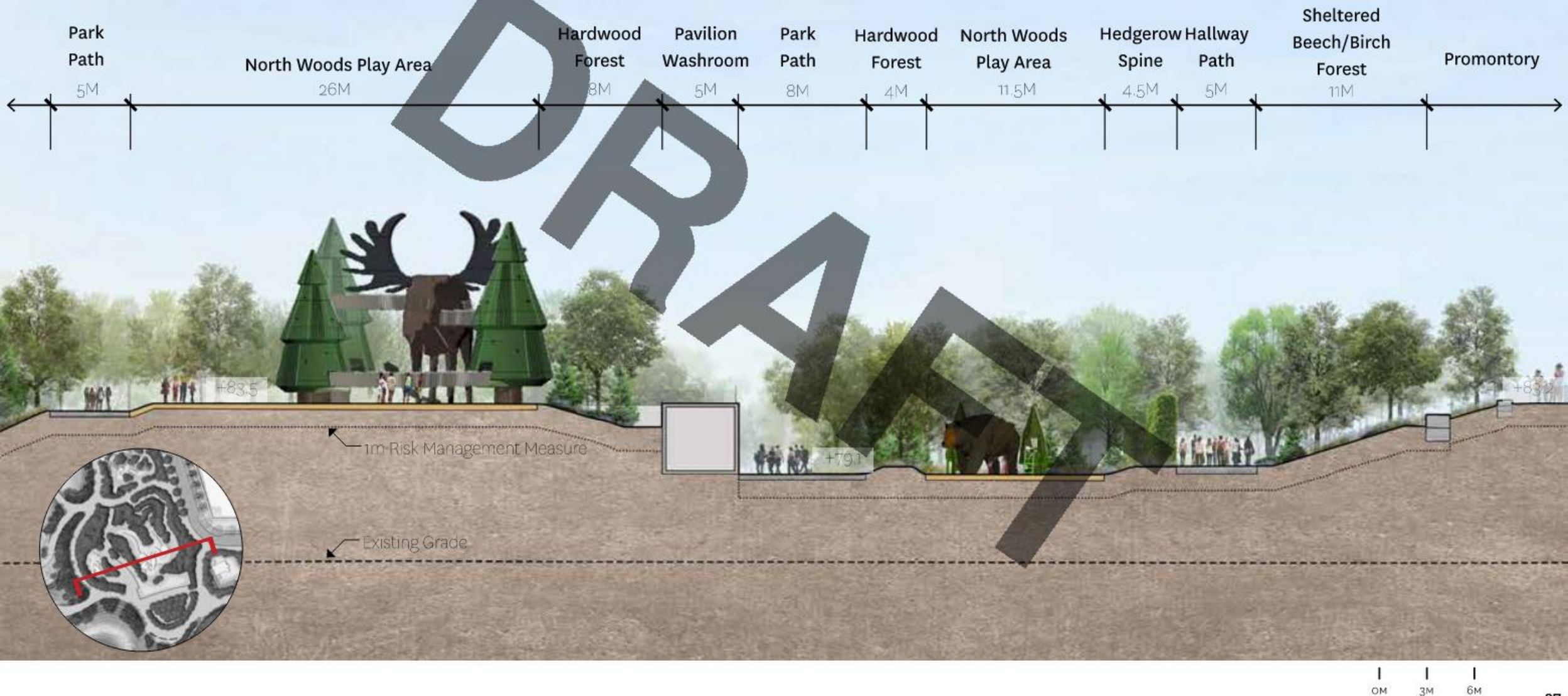

Site Section Through Southern Play Areas

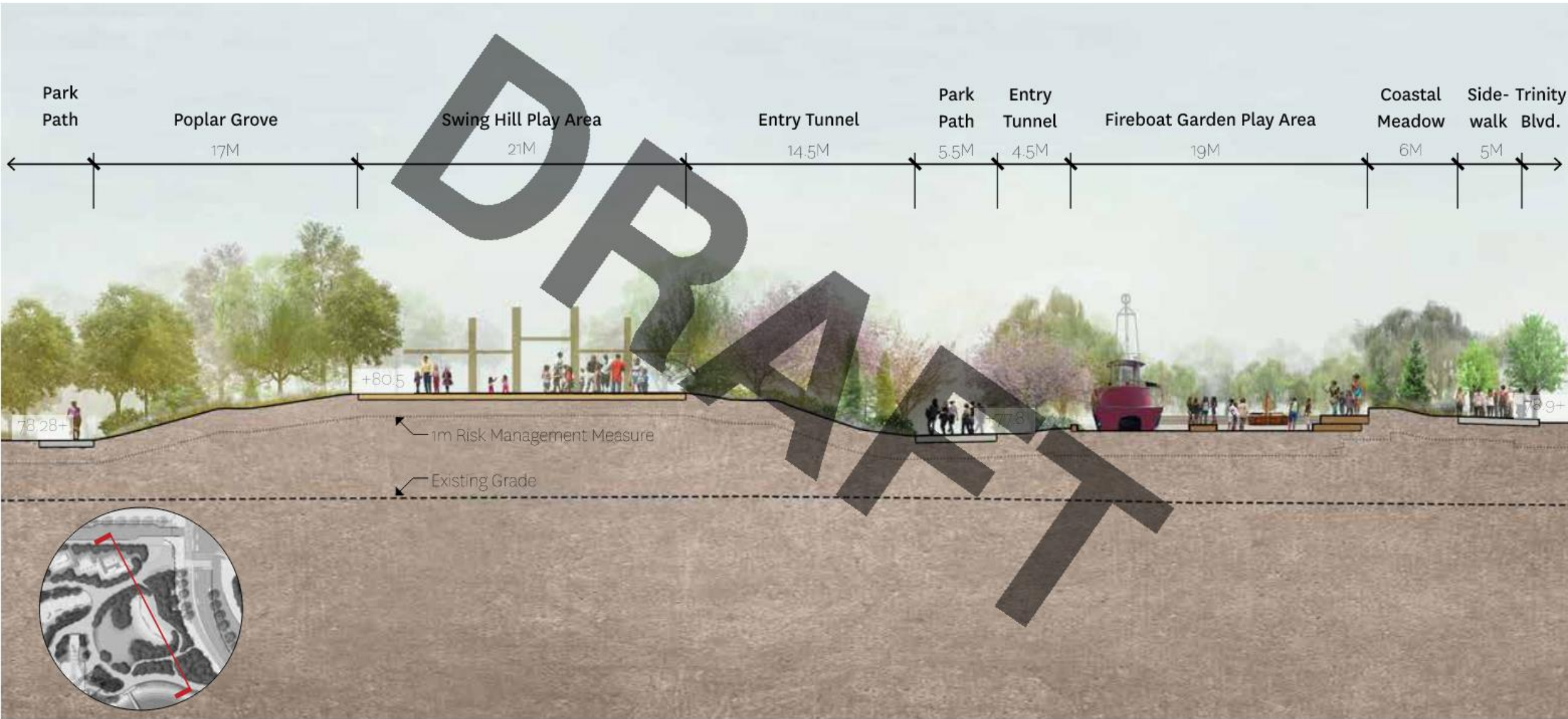

DRAFT

Integrating Into Park Circulation

Circulation Diagram

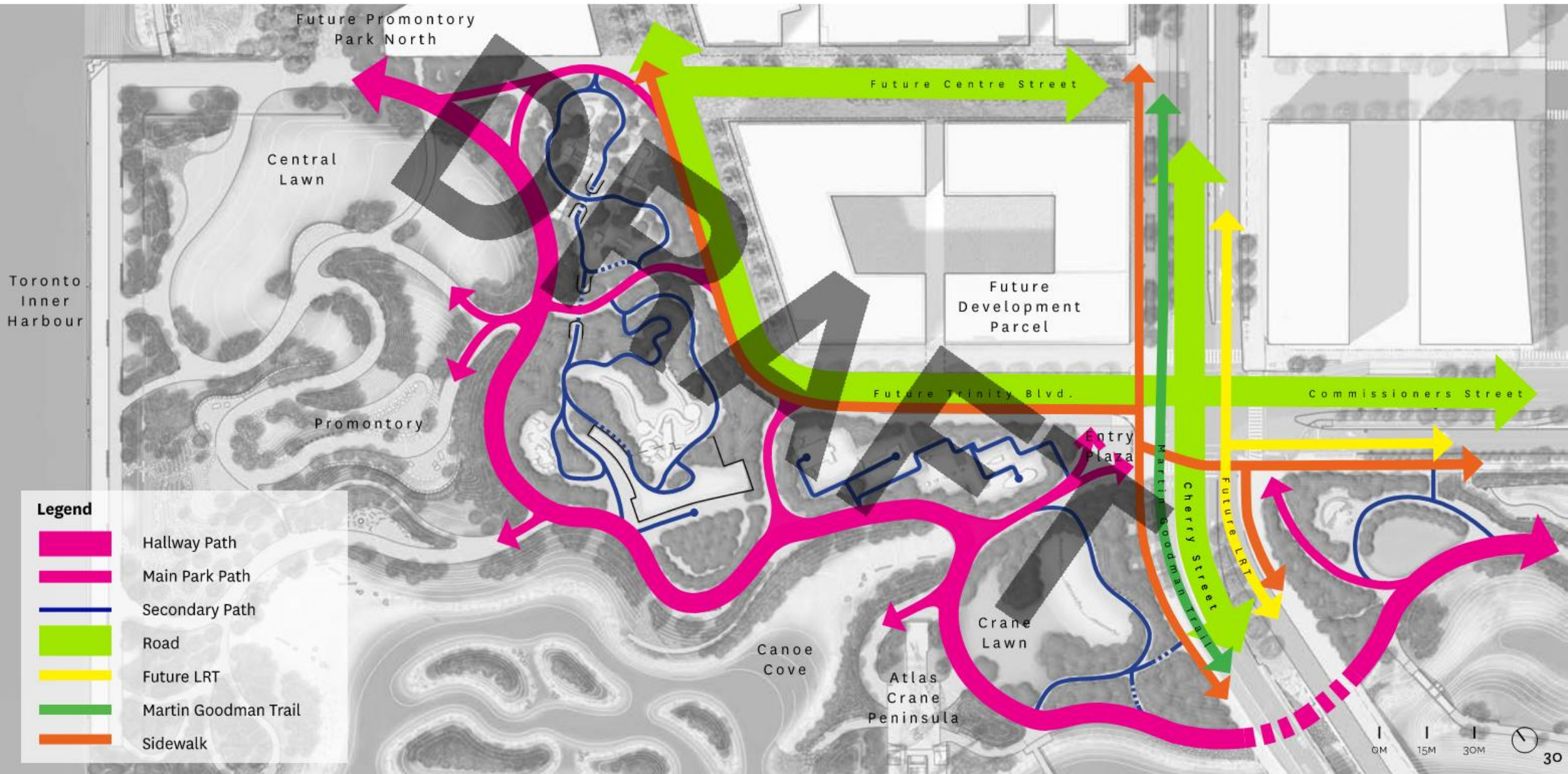

A Walk Through the Play Areas

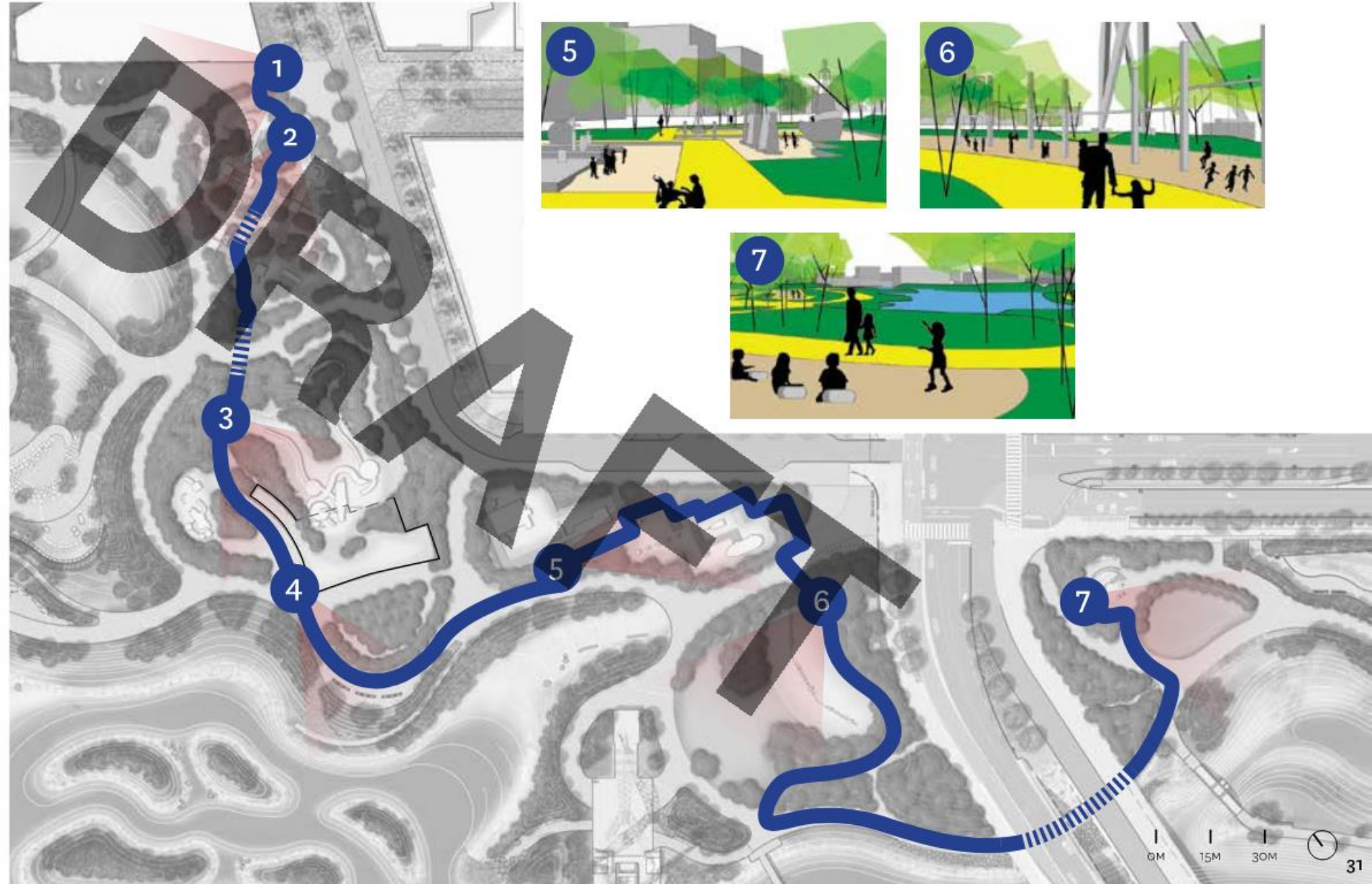

Creating Inclusive Spaces for Play

Destination Playground Character



Northern Play Area

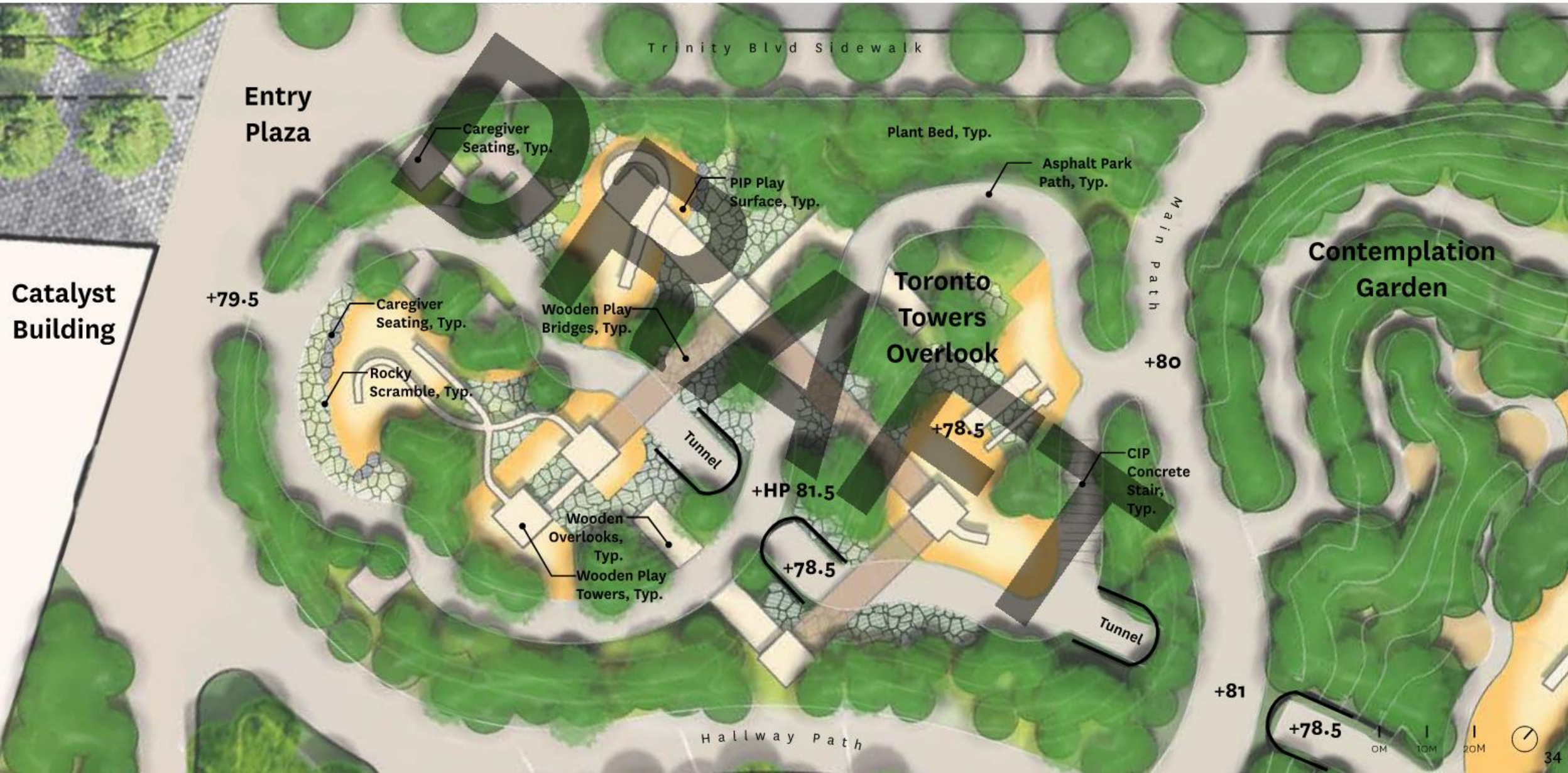

Northern Play Area Circulation



Toronto Towers Overlook Concept

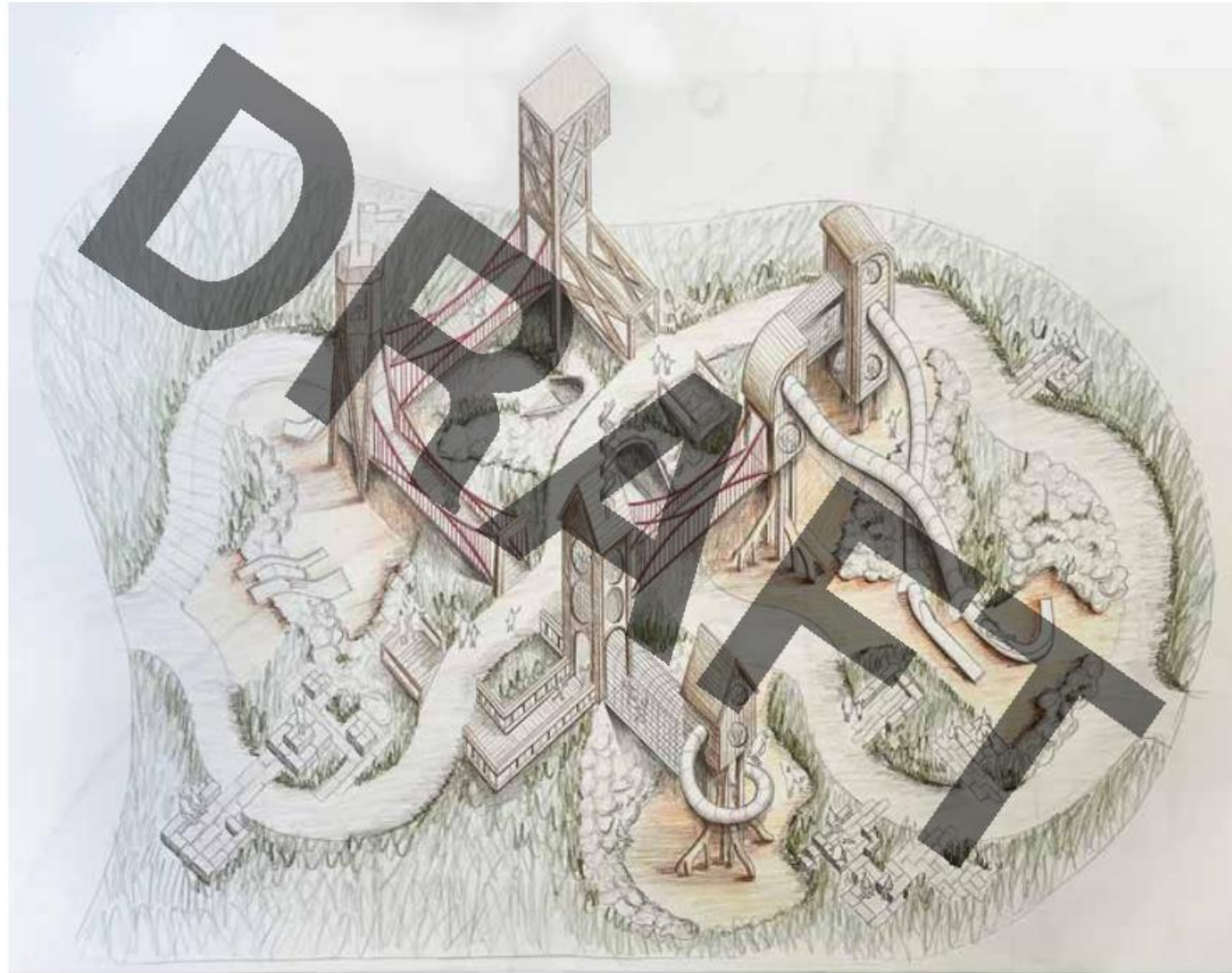

Northern Play Area Play Circulation

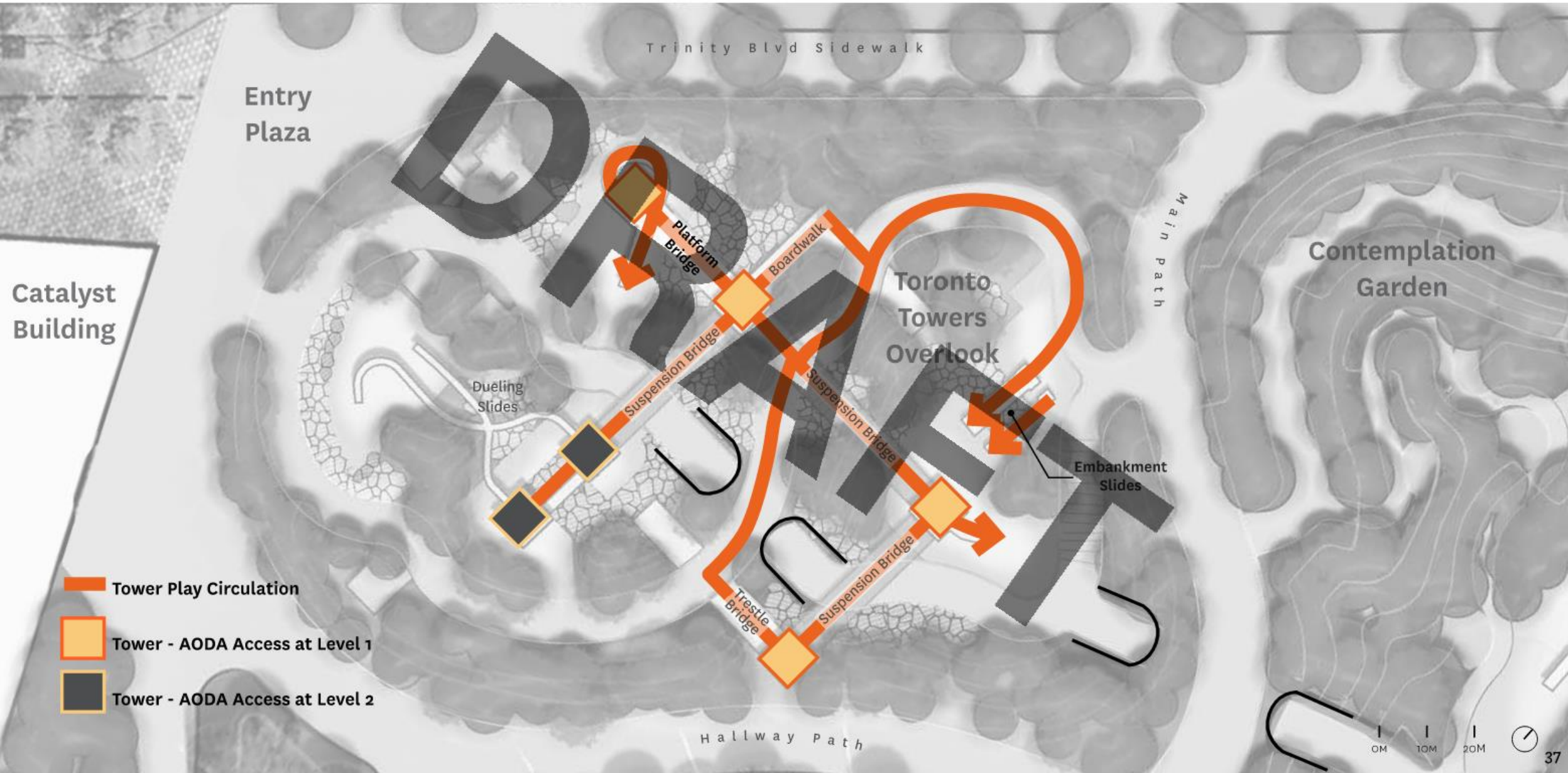

Central Play Area



Central Play Area Circulation

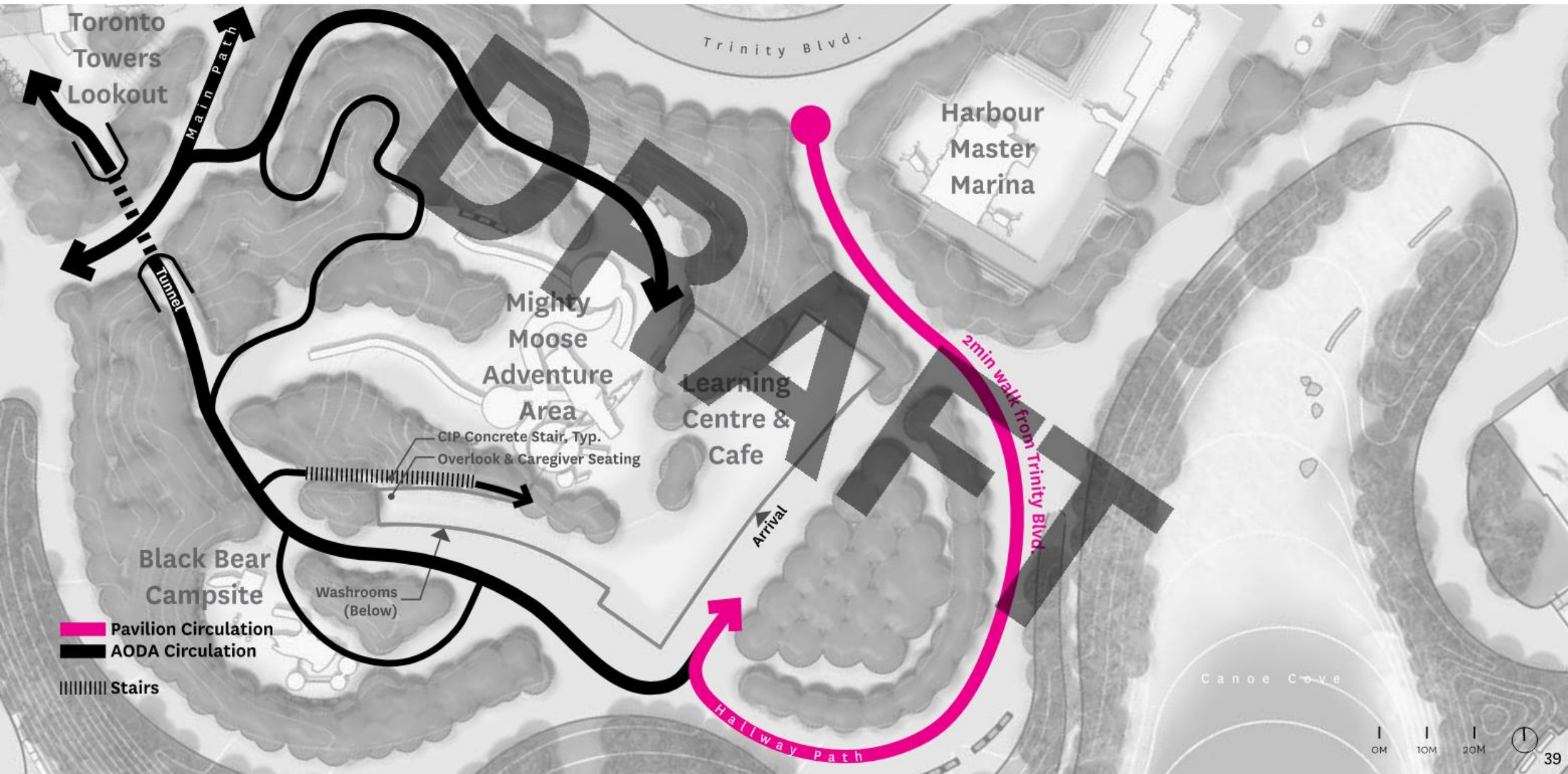

Central Play Area Washroom Access

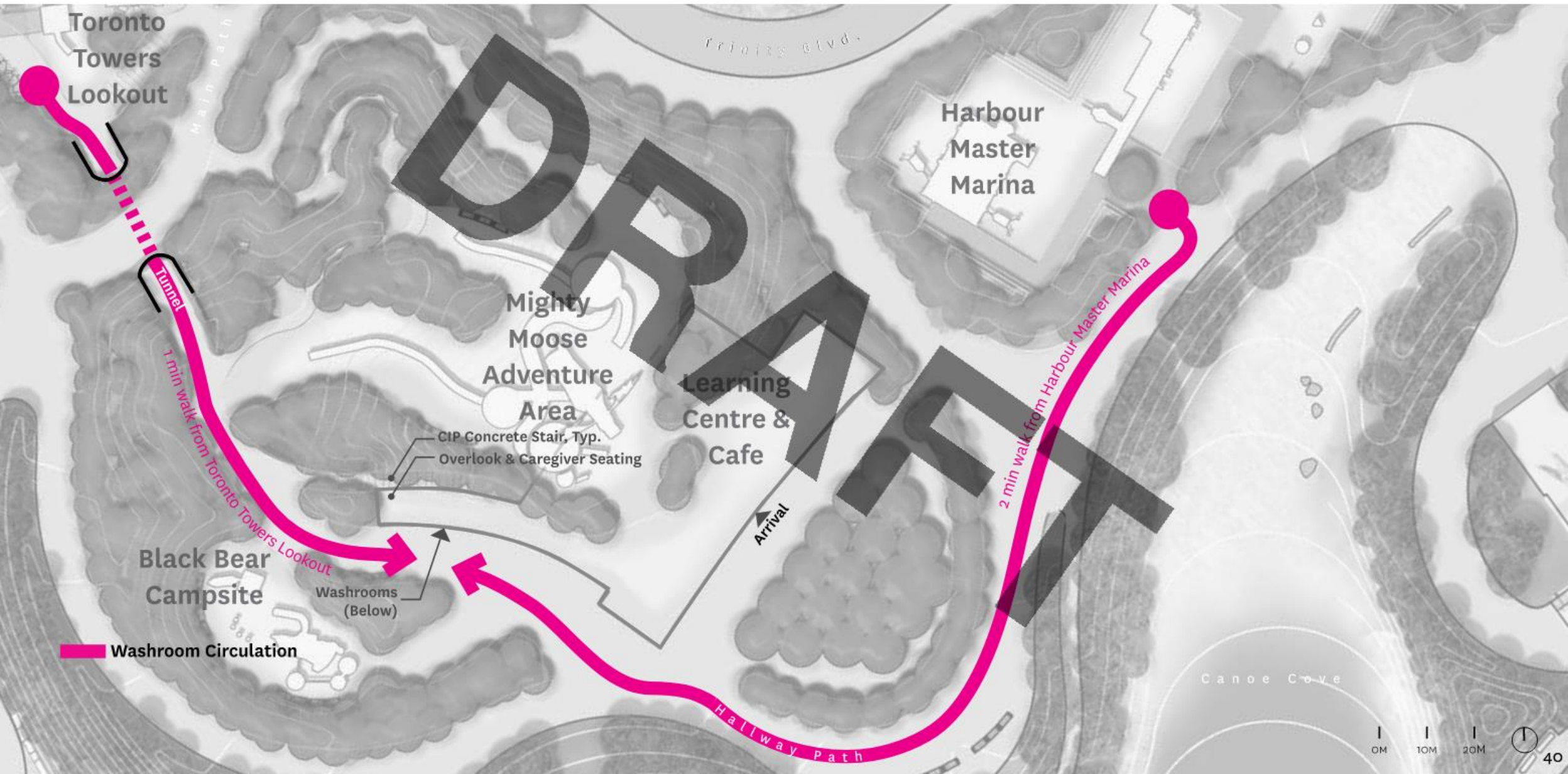

Southern Play Area



Southern Play Area Circulation

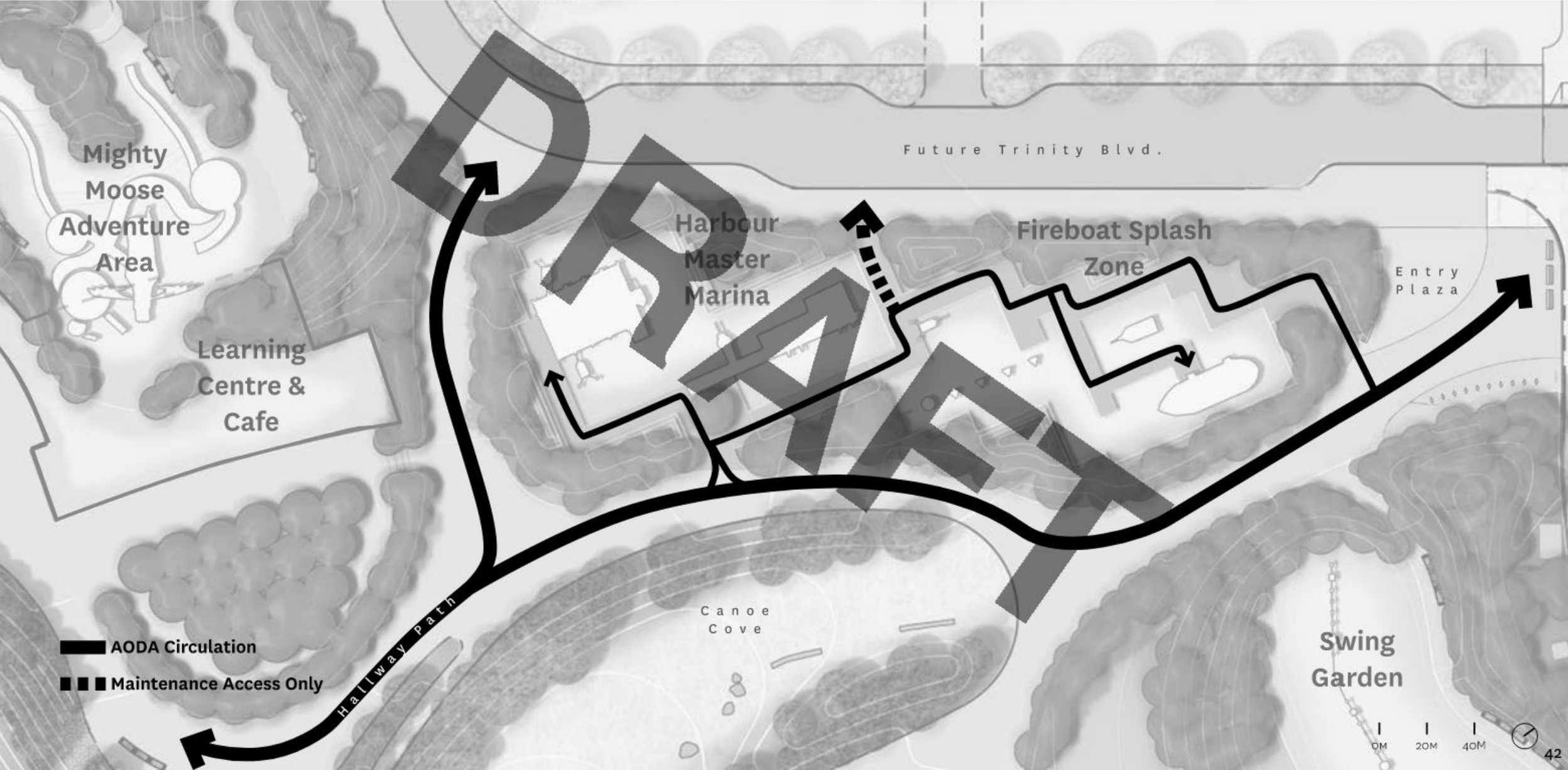

Southern Play Area

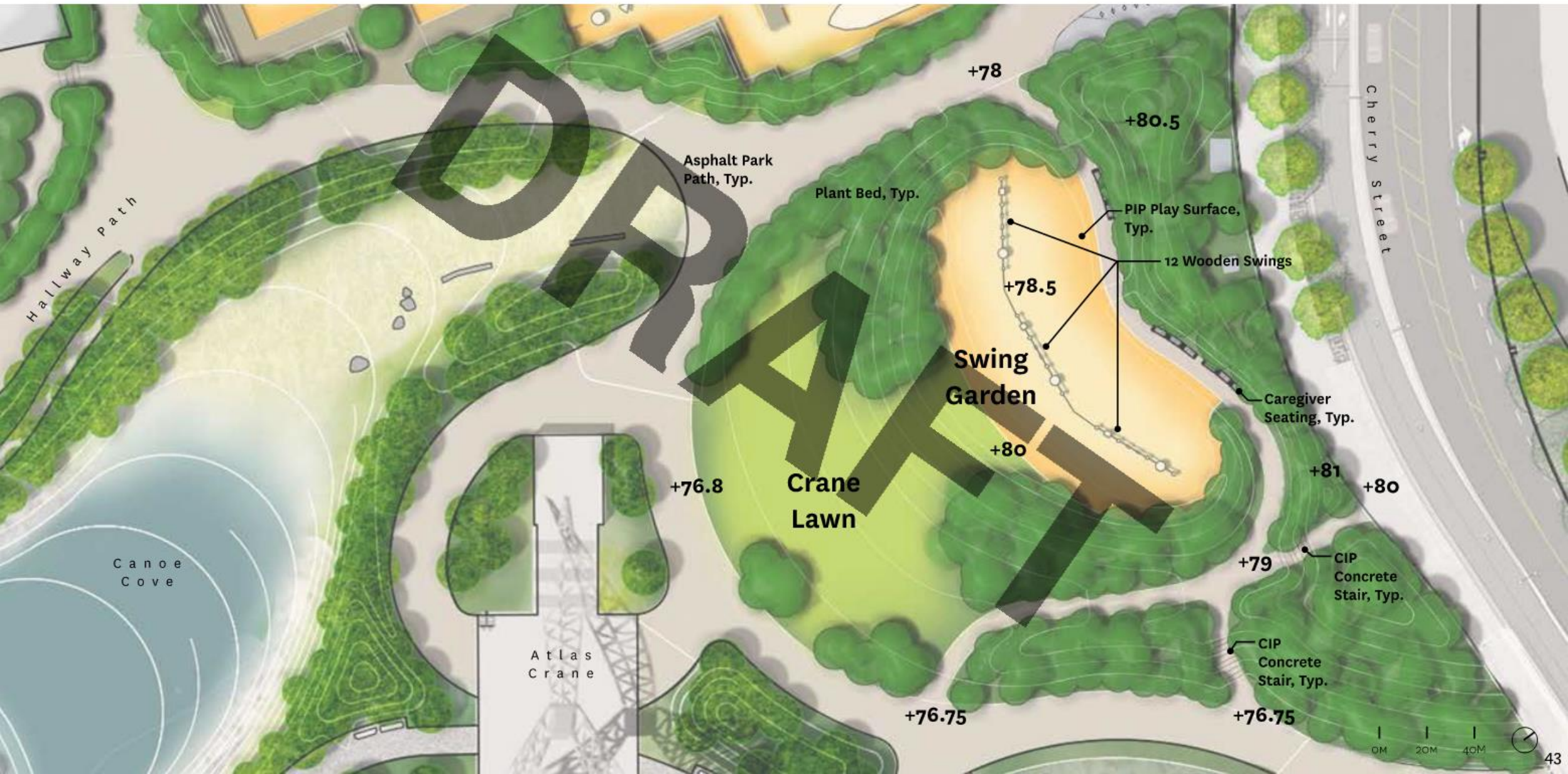

Southern Play Area Circulation

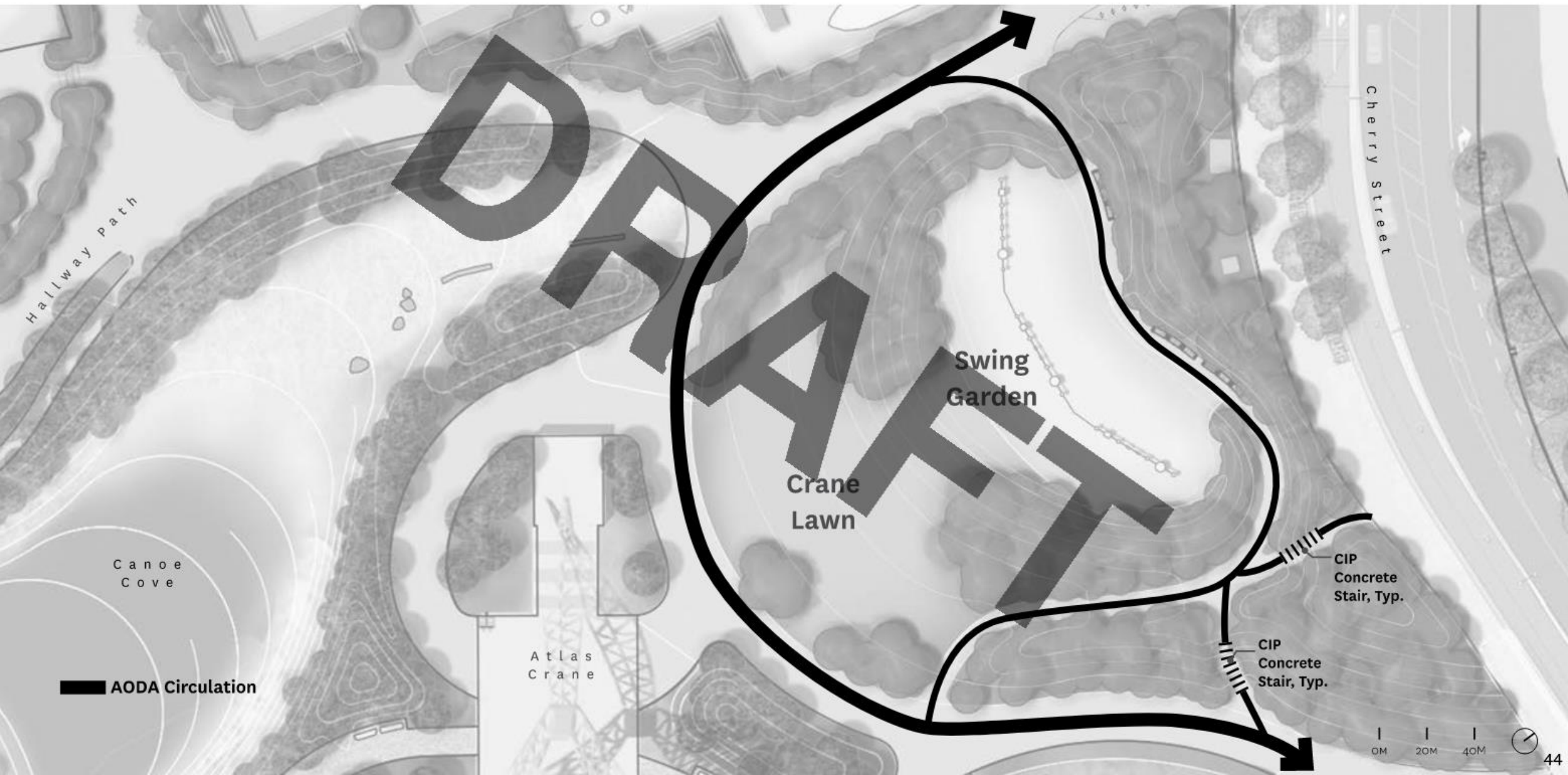

Expanding Park Amenities



Fire Hall #30



River Valley Park North Picnic Grove

Complimenting River Valley Park North

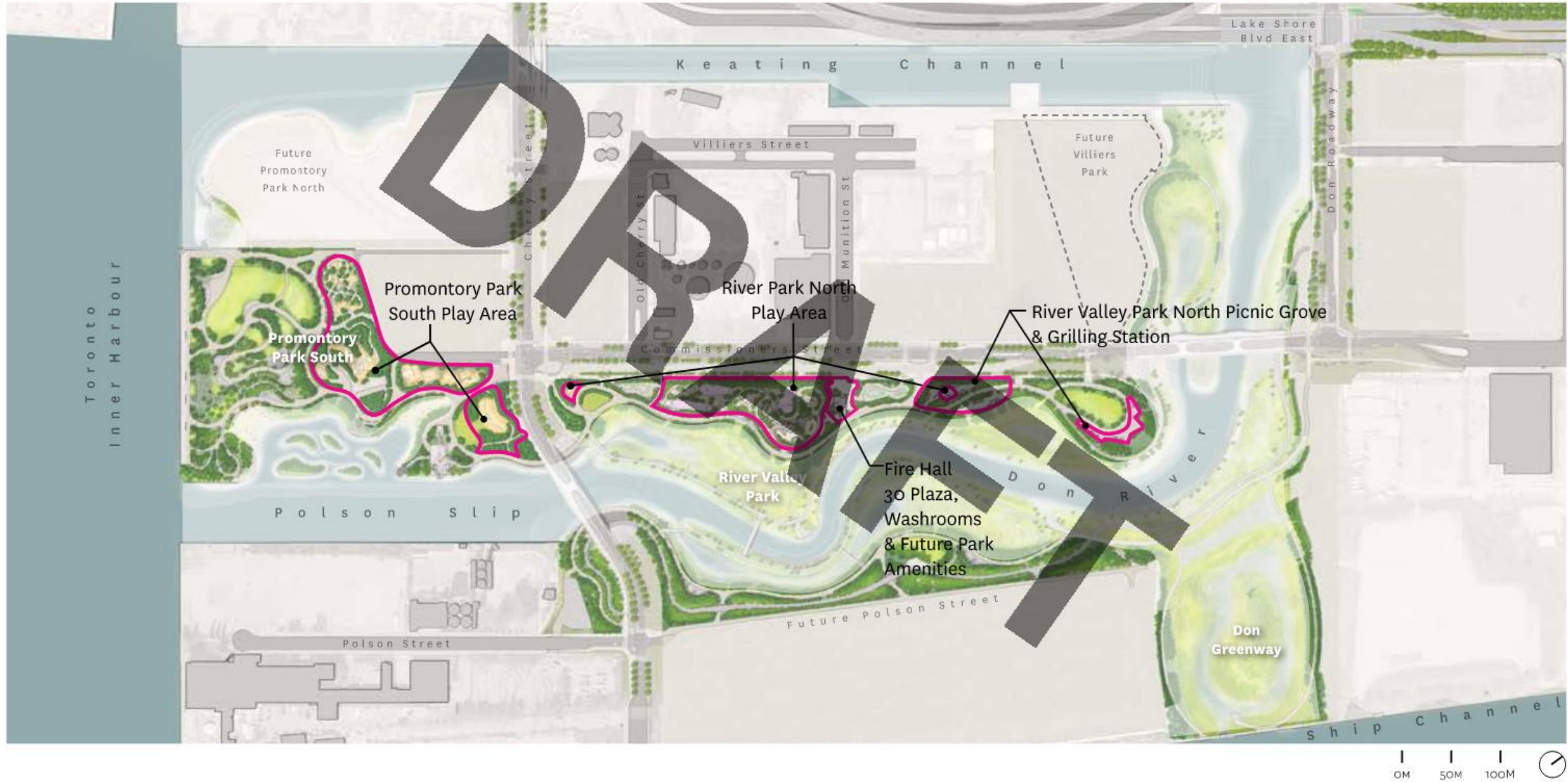

Centrally Located Park Amenity and Gathering Area

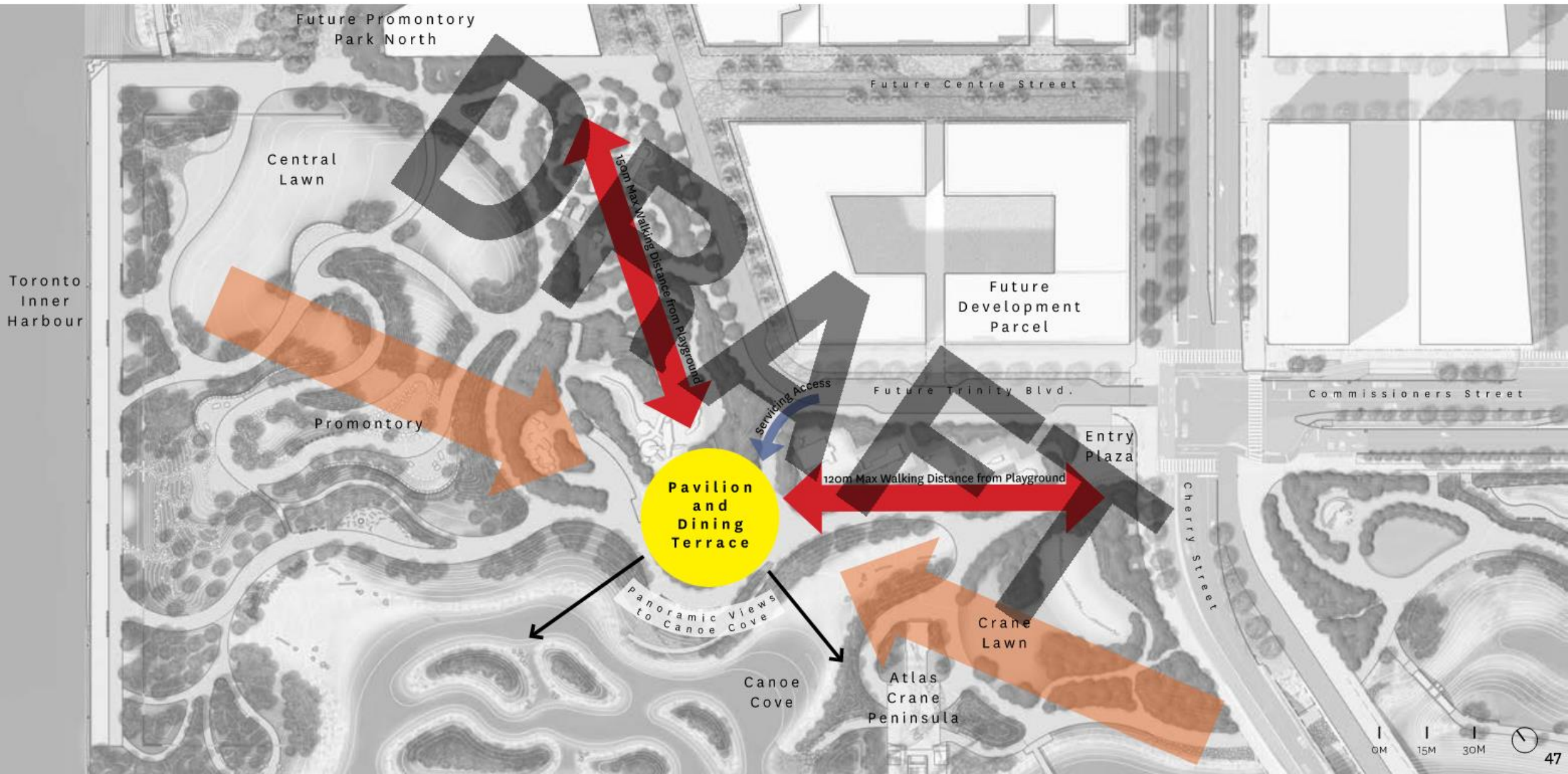

Comfortable Spaces



Constructed with Natural Materials



Providing Challenges for All Abilities



Dynamic Play Spaces



Nature Based Play



Sensory Play



Imaginative Play Spaces



High Quality Craftsmanship



Garden Walks



Site Concept Plan

