

# Promontory Park Pavilion & Winter Garden

## Issues Identification

May 25, 2022



# Site Context – Existing Conditions





# Site Context – Full Buildout





# Project Background

- Through the development of the design of the parks at PLFP it was identified that a facilities building including washrooms in Promontory Park South was desirable
- Programming for the pavilion was identified through workshops with PFR staff in order to respond to park user needs along with PFR staff needs. The pavilion programming will include washrooms, food concessions, and flexible areas for PFR camps.
- The Pavilion and adjacent Winter Garden are situated within Promontory Park South in the Port Lands
- Promontory Park South will be delivered as part of the larger Port Lands Flood Protection project. The Pavilion and Winter Garden are currently unfunded and anticipated to be delivered through philanthropic funding.
- The Winter Garden is an extension of the pavilion and will allow for year-round activation.



# Anticipated Project Timeline

Promontory Park Pavilion & Winter Garden

Review Stage: Issues Identification

Proponent: Waterfront Toronto

Design Team: MVVA and LGA

DESIGN - (May 2022 – Jan 2024)

DRP #1 Issues Identification – May 2022

DRP#2 Schematic Design – July 2022

DRP #3 Detailed Design – Spring 2023

TENDER - February 2024 – March 2024

CONSTRUCTION February 2024 - January 2026

April 2026 - Project Opening



# Team Structure





# Project Approval Stage

DRP Stream 2: Public land – Site Plan Application

Promontory Park South Pavilion & Winter Garden

Review Stage: Issues Identification

Proponent: Waterfront Toronto

Design Team: MVVA and LGA

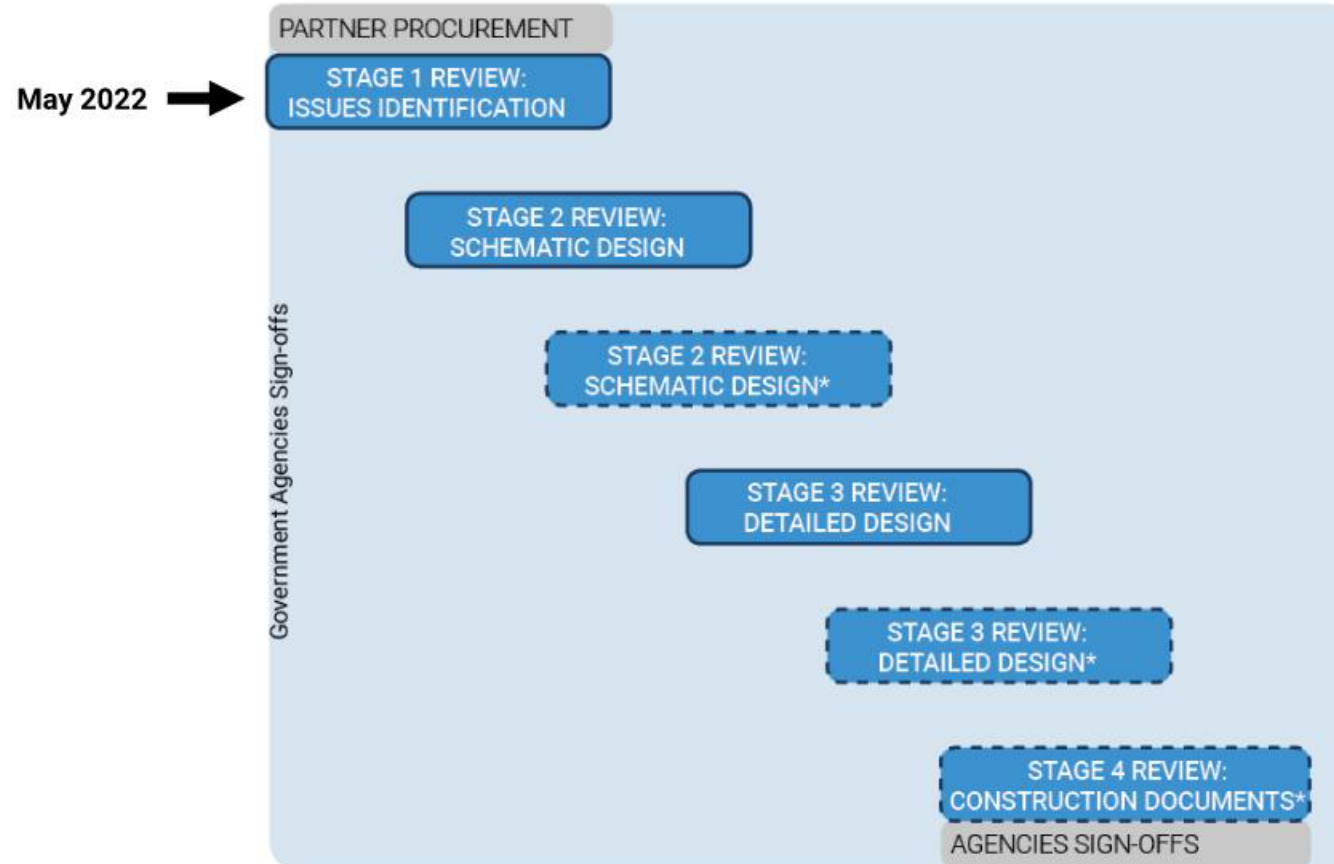

\*This review will only be required if the project has changed significantly since the previous review, or the Panel, Waterfront Toronto, or City staff have significant outstanding concerns.

# Areas for Panel Consideration

- Proposed program for the pavilion
- Integration of Pavilion with the Winter Garden
- Accessible roof uses
- Circulation and access for the Pavilion within the greater Park network



# Promontory Park Pavilion and Winter Garden Design Review Submission Phase 1

Prepared for Waterfront Toronto Design Review Panel  
25 May 2022

Michael Van Valkenburgh Associates, Inc.  
Landscape Architects

LGA Architectural Partners



# The Port Lands - Under Construction

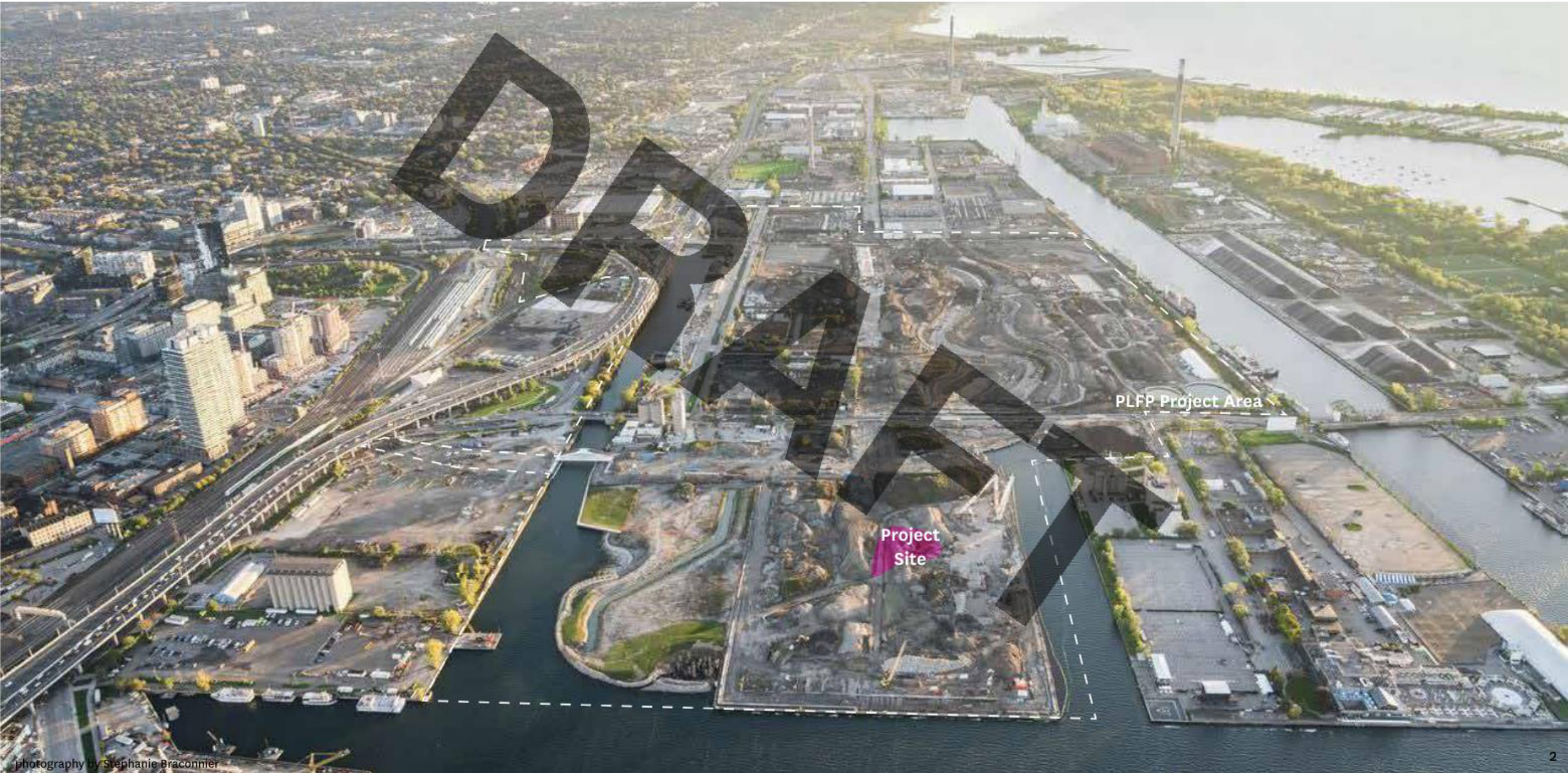

PLFP Project Area

Project Site



# The Port Lands - 2024

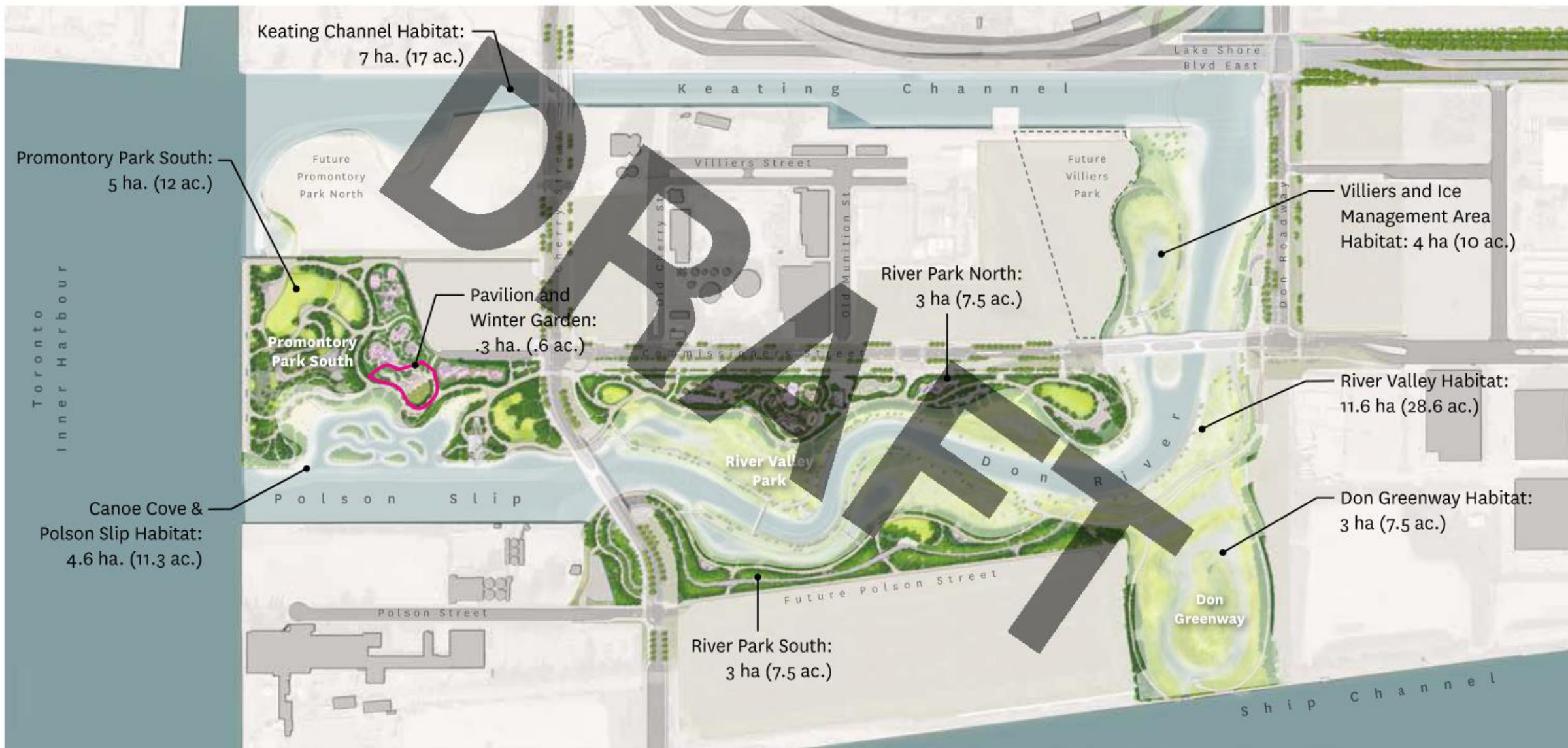

## The 3 Big Questions

- 1. What is the vision for the Promontory Park South?**
- 2. How is the Pavilion and Winter Garden Integrated into the PLFP project?**
- 3. How can a Pavilion support the Promontory Playground and the overall PLFP Project?**



**What is the vision for Promontory Park South?**

# Toronto's Large Urban Parks





# Framing a Comprehensive Vision





# Port Lands Park Programming Types - 2024

- Play Areas
- Dogs Off Leash Area
- Overlook
- Picnic Area
- Urban Esplanade
- Plaza
- Event Lawn
- Passive Use Lawn
- Rocky Edge
- Submergent Marsh
- Emergent Marsh
- Vernal Pool
- Planted Armour Stone
- Wooded Upland
- Gravel Beach
- Canoe/Kayak Access
- Bird Watching
- Overlook  
- Eco Education / Interpretation

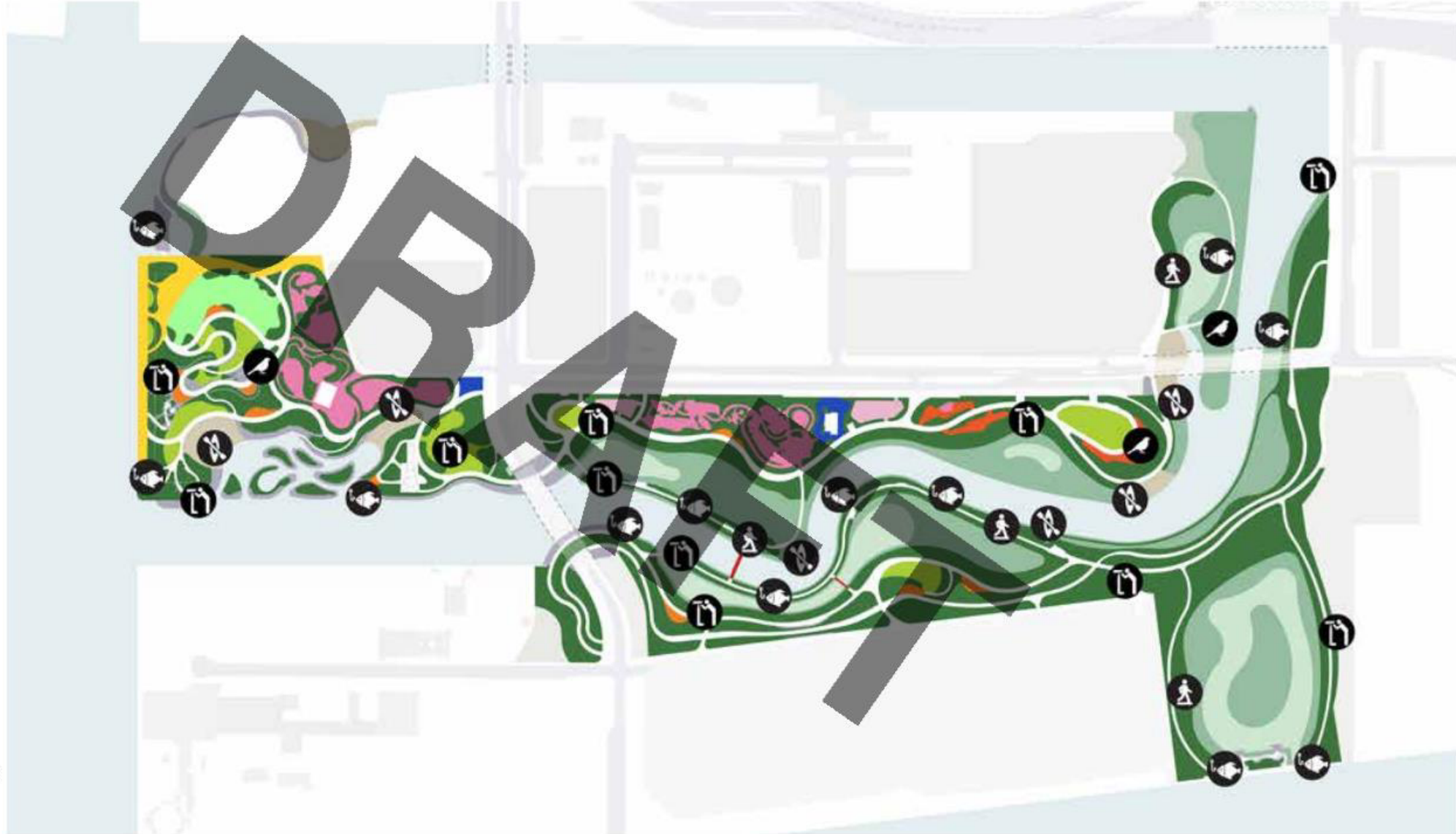



# Promontory Park South Character

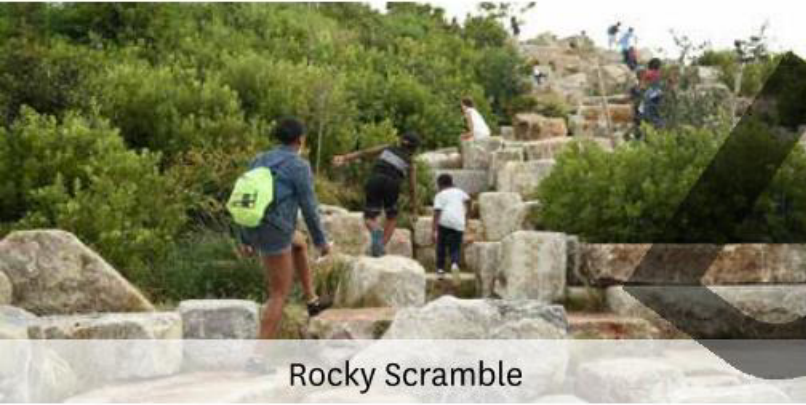



# Promontory Park South - Bird's Eye View





# PLFP Art Trail - Diagram

- ▲ Temporary Art - Serviced
- ▲ Permanent Art - Serviced
- ▢ Temporary Art - Not Serviced
- Art Walk



Art impression of Central Lawn with *Environnement de Transchromie Circulaire*, 1965-2017 by Carlos Cruz-Diez, *Liverpool Mountain* by Ugo Rondinone, and *Look into my Dreams* by Jaume Plensa

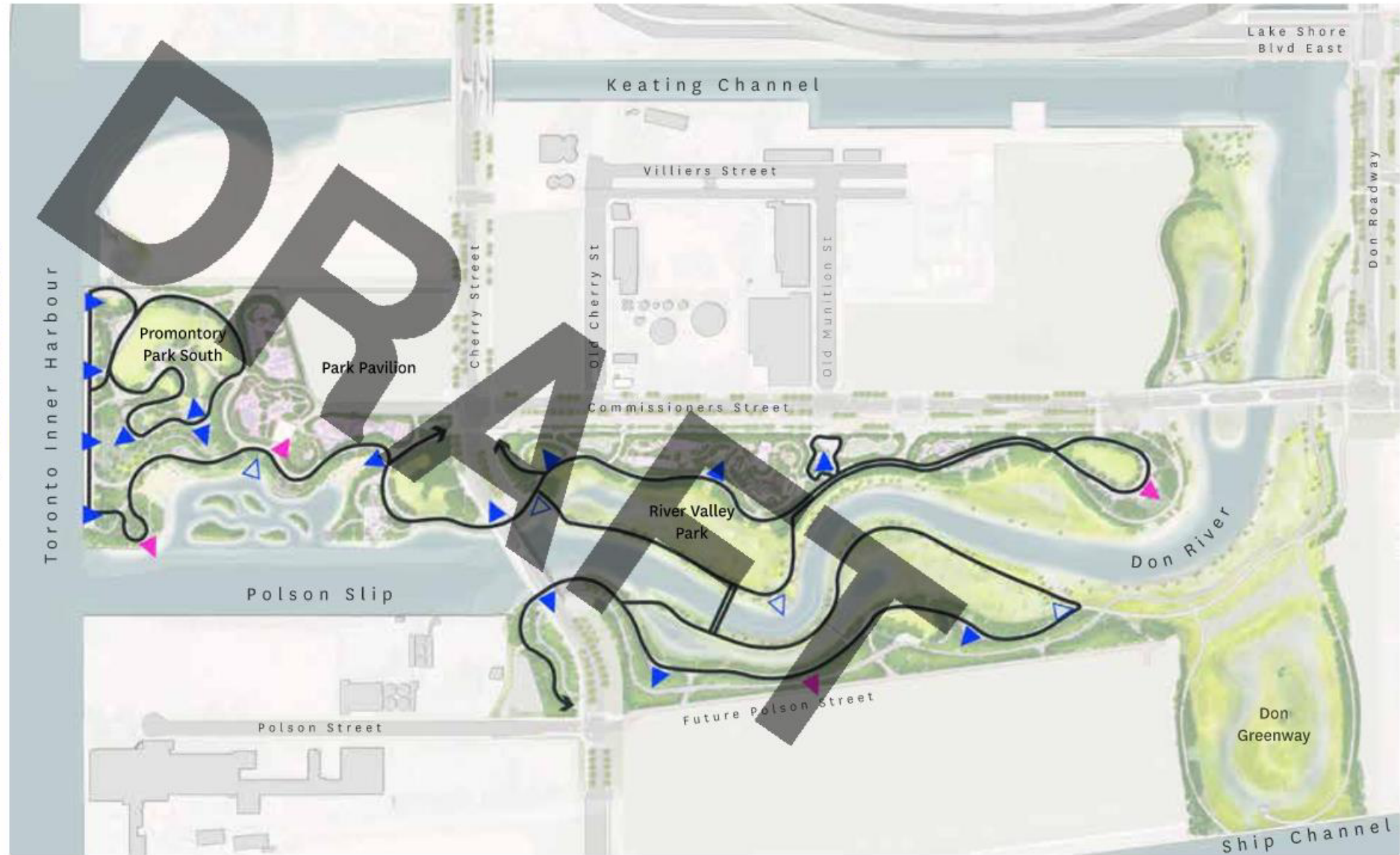

# PLFP Indigenous Design Approaches



## Indigenous Plantings

- Garden (Hopi Tobacco, White Sagebrush, Staghorn Sumac, eg.)
- Grove (White Birch, Eastern Cottonwood, Eastern White Cedar, eg.)
- Glade (Black Oak, Black Willow, White Pine, eg.)
- Hedgerow (Eastern Red Cedar, Eastern Redbud, St. John's Wort, eg.)
- Mixed Forest (Tulip Poplar, Yellow Birch, Black Walnut, eg.)
- Wetland (Swamp Milkweed, Sweet Grass, Prairie Cordgrass, eg.)

## Potential Indigenous Design Site Features



directional compass



fire holder space



cultural markers (Location TBD)



Interpretive Signage (Location TBD)



River Interpretation Path (Location TBD)



pow wow location



Indigenous public art



clan totem in play areas



Sunrise Garden

Plants selected that have medicinal and cultural significance for Local Indigenous Peoples are integrated into the overall planning approach.



# View from Centre St looking Southwest towards Central Lawn





View from Cherry St Park Entry looking Southwest towards Canoe Cove





# View from Polson Slip Overlook looking Northwest towards Harbour Promontory





# View from Trinity Blvd looking West towards Future Promontory Playground





# Existing Conditions - Aerial View of Construction Progress



# Siting Based on Topography and Microclimates

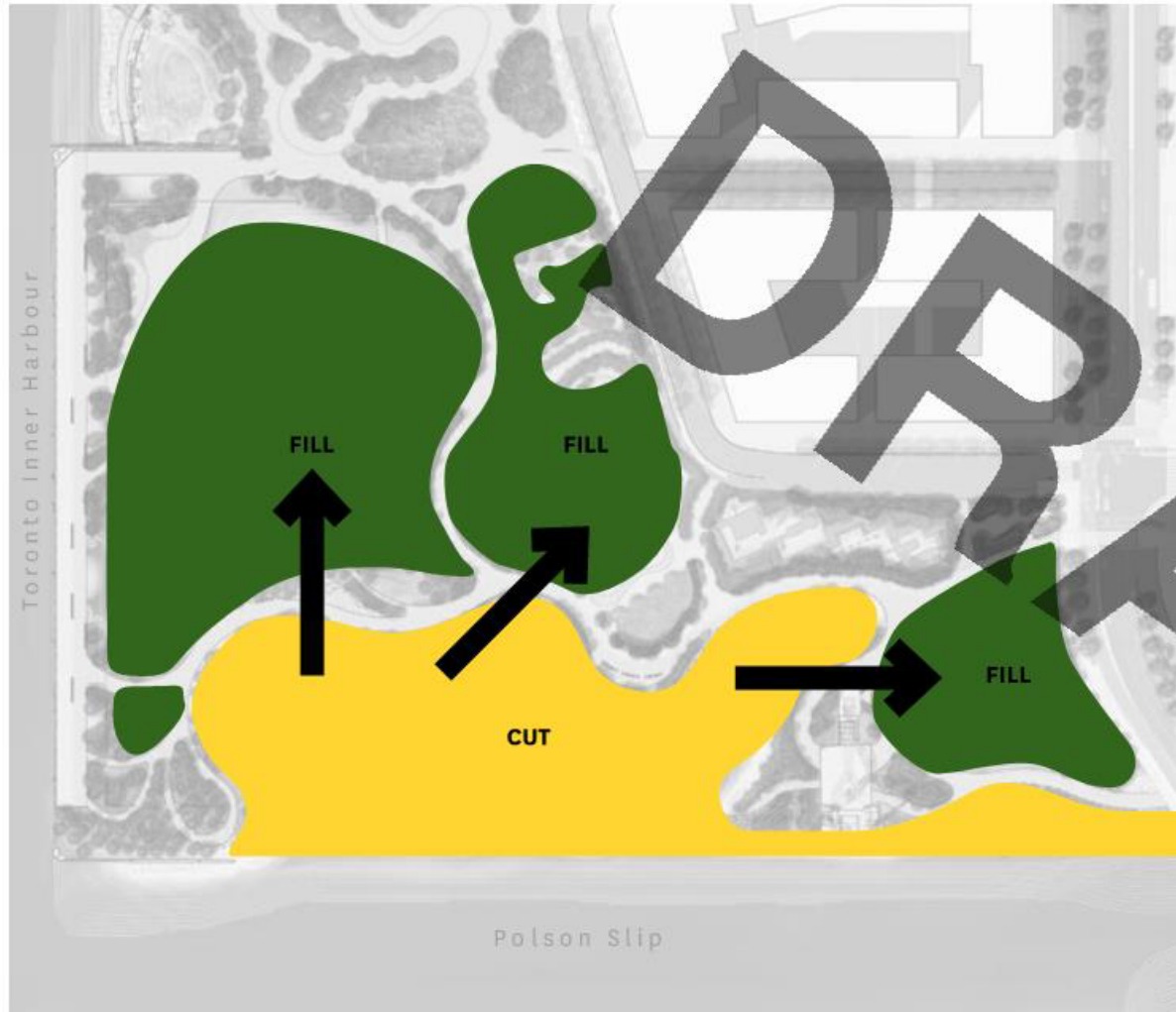

Topography



Wind

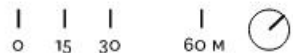



# Site Concept Plan





# Circulation Diagram



## Legend

- Primary Pedestrian Access
- Hallway Path
- Playground Access
- Primary Bike Trail
- Vehicular Access
- Future LRT



# Centrally Located Park Amenity and Gathering Area

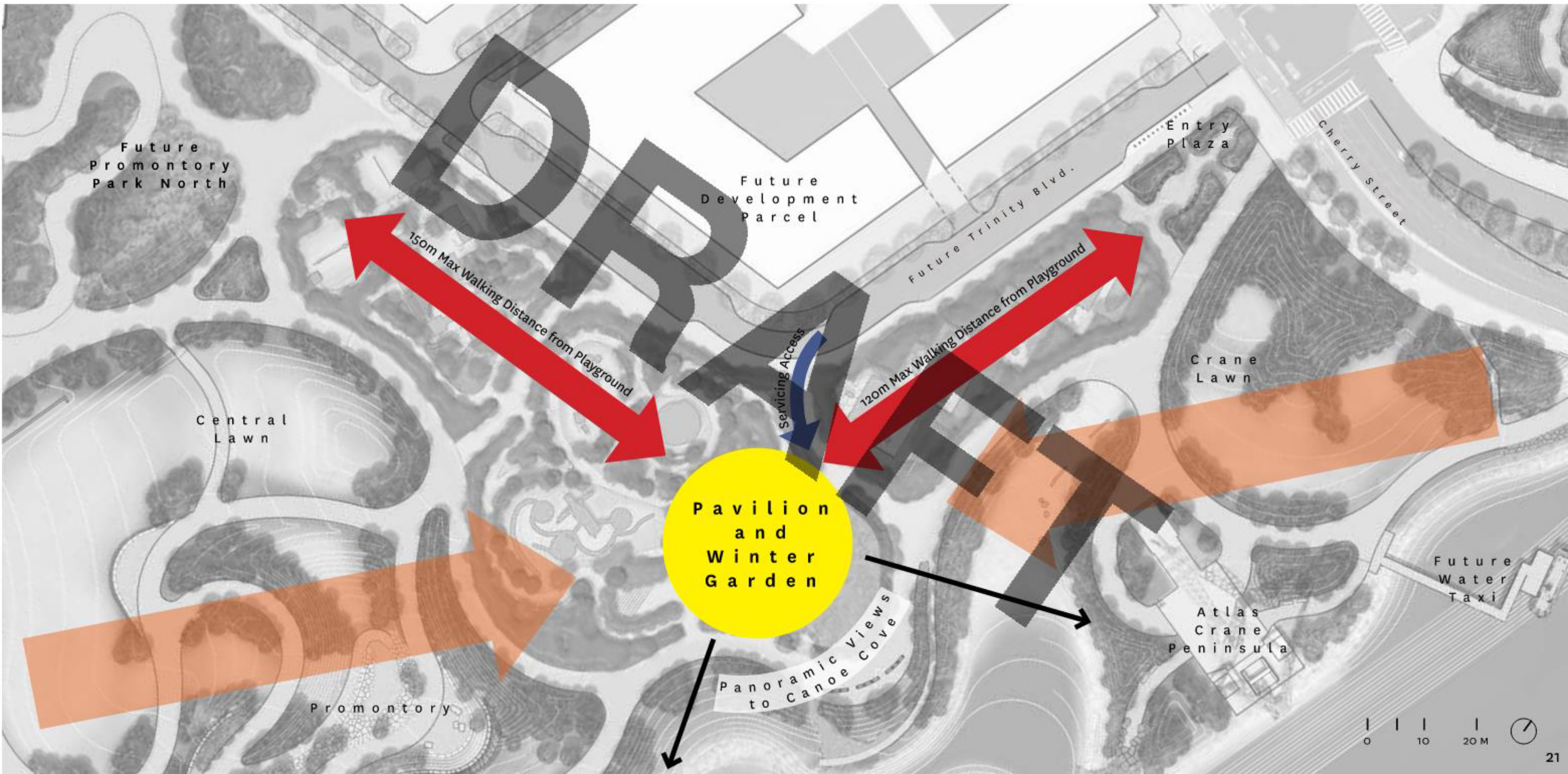



**How is the Pavilion and Winter Garden Integrated into  
the PLFP project?**



# Complimenting River Valley Park North

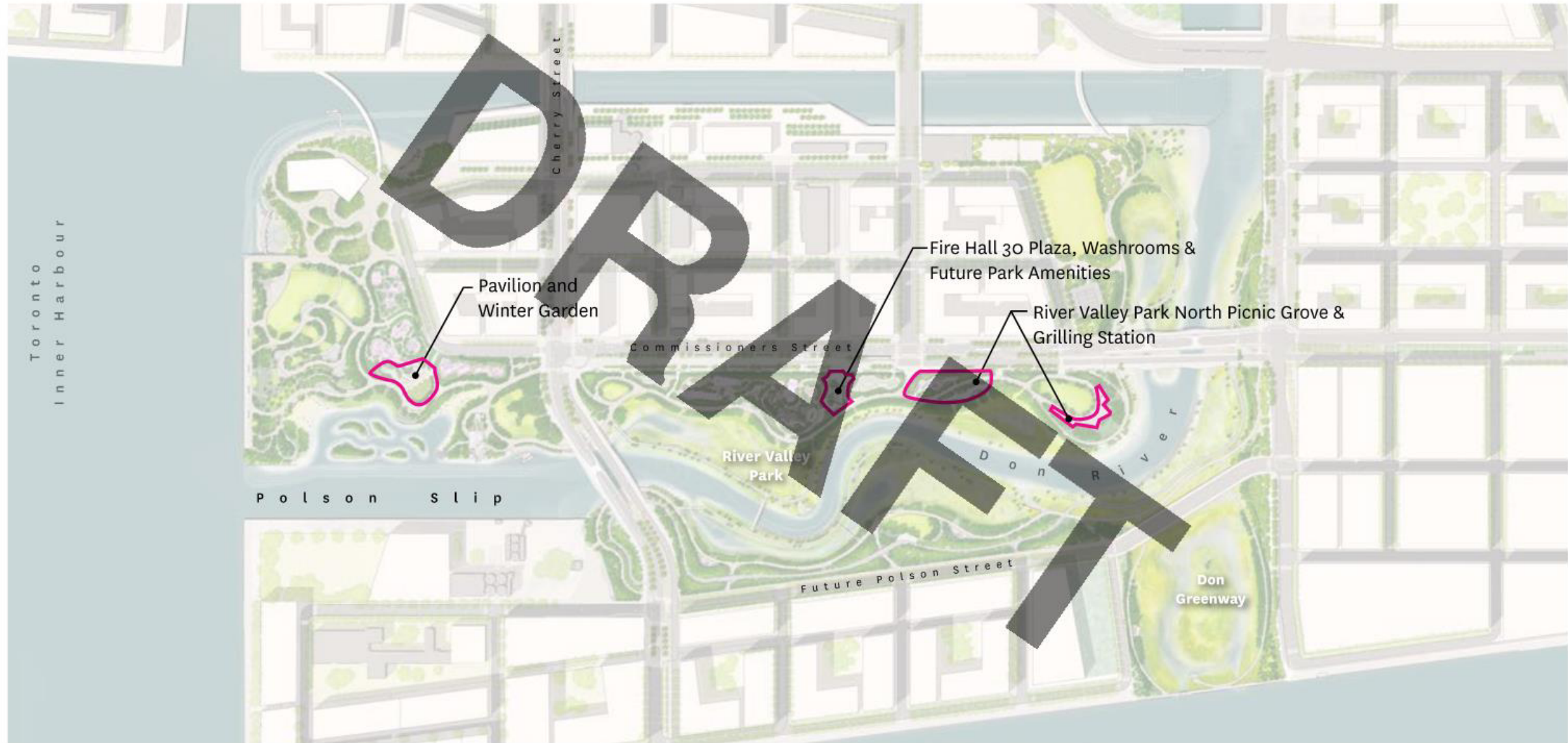



## Expanding Park Amenities



Fire Hall #30



River Valley Park North Picnic Grove



# Winter Programming

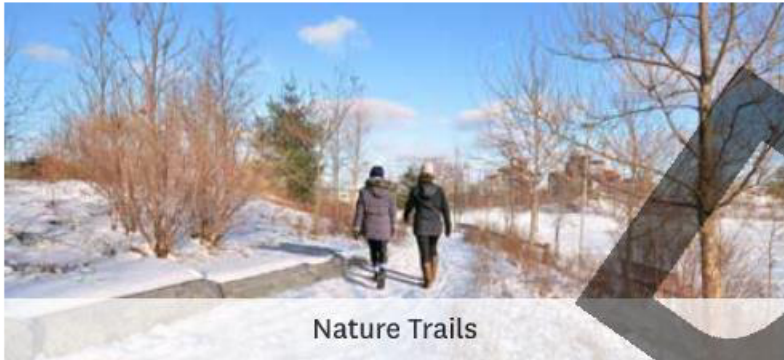

Nature Trails



Snowshoeing



Fire Pit



Winter Festivals



Crosscountry Skiing



Sledding Hill



Winter Birding / Wildlife Viewing



Outdoor Dining / Program Area



Sheltered Play Area



# Winter Activity Diagram

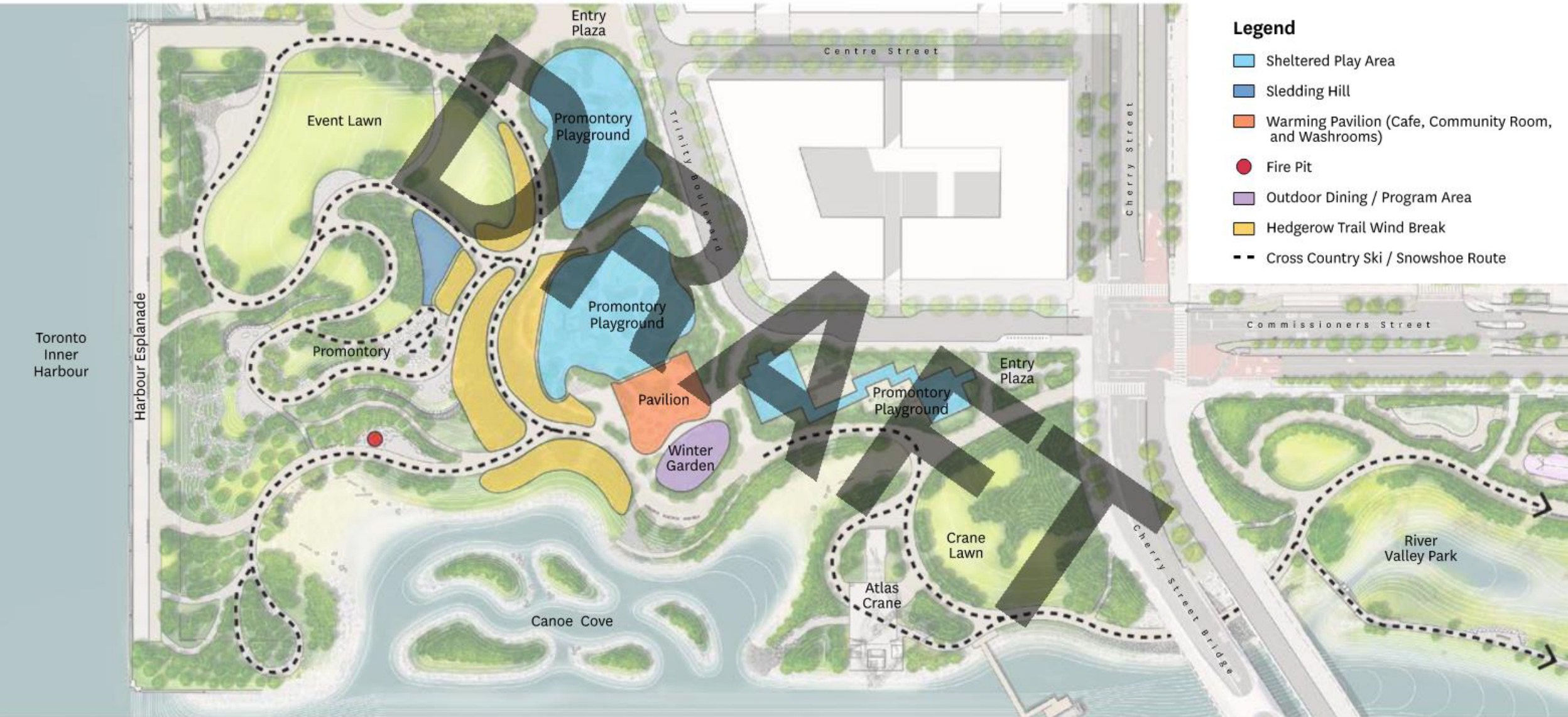

## Legend

- Sheltered Play Area
- Sledding Hill
- Warming Pavilion (Cafe, Community Room, and Washrooms)
- Fire Pit
- Outdoor Dining / Program Area
- Hedgerow Trail Wind Break
- Cross Country Ski / Snowshoe Route



**How can a Pavilion support the Promontory Park  
Playground and the overall PLFP project?**



# Design Aspirations

## Goals and Objectives:

The Promontory Park Pavilion will be the architectural corollary of this exemplary new park. With its simple form and expressive timber structure, this public building will provide amenity to all visitors. Embodying principles of regeneration and resilience, the Pavilion will be near Passive House, All-Electric and Low Carbon systems to maximize energy conservation; its plant-based material palette will address the need for carbon sequestering and material carbon reduction in a way that complements the natural world of Promontory Park.



# Pavilion and Washroom Benchmarking



Brooklyn Bridge Park Harbourview Cafe, New York



Tulsa Gathering Place Pavilion, Tulsa



Corktown Common Plaza, Toronto



**Park:** 85 acres  
**Building:** 333m<sup>2</sup>  
**Bathrooms:** 2 Bathrooms (4 Stalls)  
**Other:** Cafe, Rooftop Seating Area, Bathrooms



**Park:** 66 acres  
**Building:** 110m<sup>2</sup>  
**Bathrooms:** 7 Individual Bathrooms (7 Stalls)  
**Other:** Janitor's Closet, Viewing Deck, Adjacent Waiting Area, Water Fountain

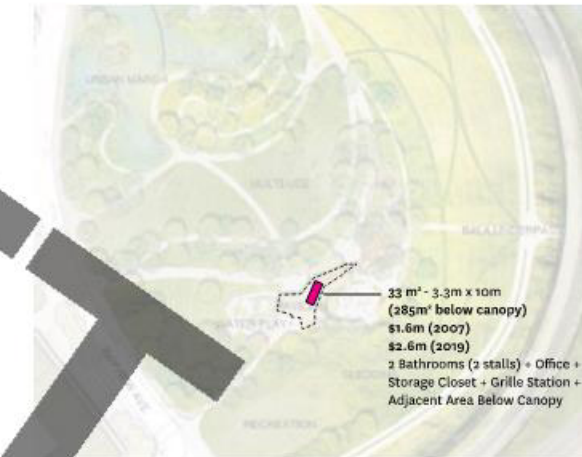

**Park:** 16 acres  
**Building:** 33 m<sup>2</sup> Pavilion / 285m<sup>2</sup> below Canopy  
**Bathrooms:** 2 Bathrooms (2 stalls)  
**Other:** Office, Storage Closet, Grille Station, Adjacent Area Below Canopy



# Arrival and Gathering Benchmarking



Fort York Visitor Center, Toronto



Evergreen Center for Green Cities, Toronto



Qualico Family Center, Assiniboine Park, Winnipeg

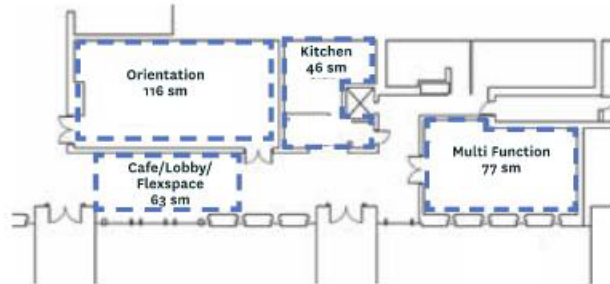

**Multi-Function Room:** 77 sm (35 seated)  
**Orientation Room:** 116 sm (72 seated)  
**Kitchen:** 46 sm  
**Cafe:** 63 sm

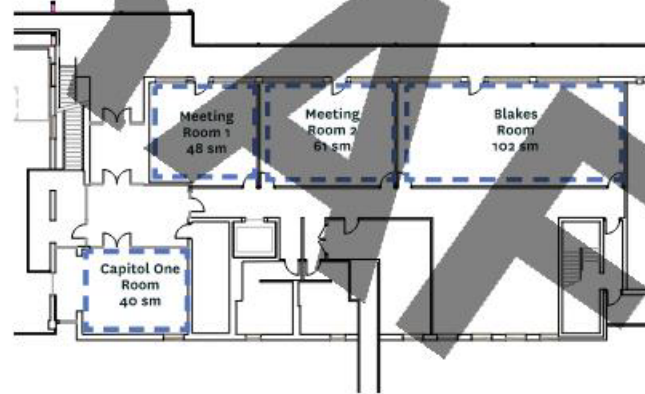

**Meeting Room 1:** 48 sm (15 seated)  
**Meeting Room 2:** 61 sm (40 seated)  
**Blakes Room:** 102 sm (70 seated)  
**Capitol One Room:** 40 sm (15 seated)

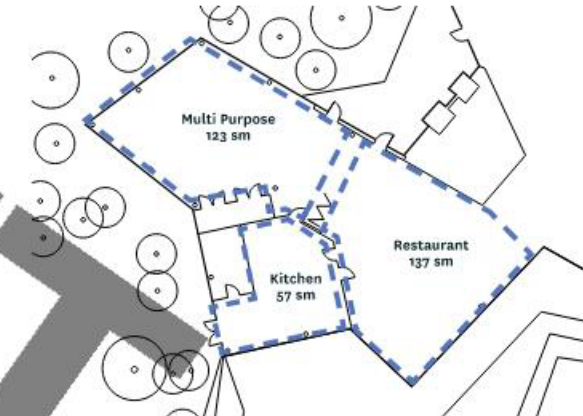

**Multi-Purpose Room:** 123 sm (80 seated)  
**Restaurant:** 137 sm (80 seated)  
**Kitchen:** 57 sm



# Foodservice Benchmarking



Balzacs, Stratford



IQ Foods, Yorkdale



Cafe Belong, Evergreen Brickworks

KITCHEN SERVING POINTS  
SEATING AREA : 1.7 sm/person

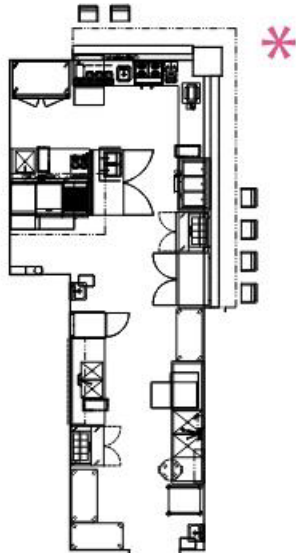

**CONCESSION KITCHEN**

Small Commercial or Warming Kitchen  
+/- 43 sm

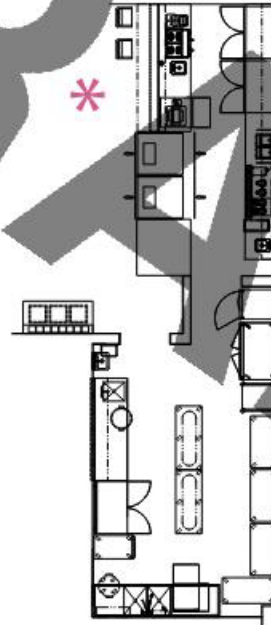

**CAFE KITCHEN**

Medium Commercial or Warming Kitchen  
& Offsite Caterer Capacity  
+/- 52 sm

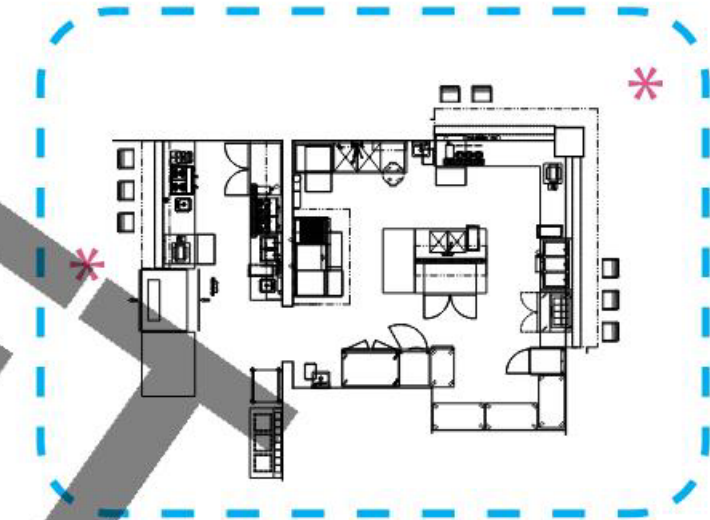

**RECOMMENDED BY  
FOODSERVICE**

**FAST CASUAL KITCHEN**

Full Commercial Kitchen,  
w. Concession & Cafe Service  
+/- 67 sm



# Proposed Program

## PFR Program Room

- 90 ppl. lecture or 60 ppl. table/chairs

## PFR Storage

## Staff Offices x 2

## Fast Casual Restaurant:

- Full Commercial Kitchen
- Interior Dining Room (50 ppl Seated)
- Event Catering Capacity ( +/-130 ppl)

## B.F. / Family Washroom x 5

## Universal Washroom

## Restaurant Washroom - Male (3 Stalls)

## Restaurant Washroom - Female (3 Stalls)

## PFR All Gender Washroom

## First Aid Room

## Reception

## Elevator and Waiting Area

## Mechanical Rm / Electrical Room

## Waste Storage

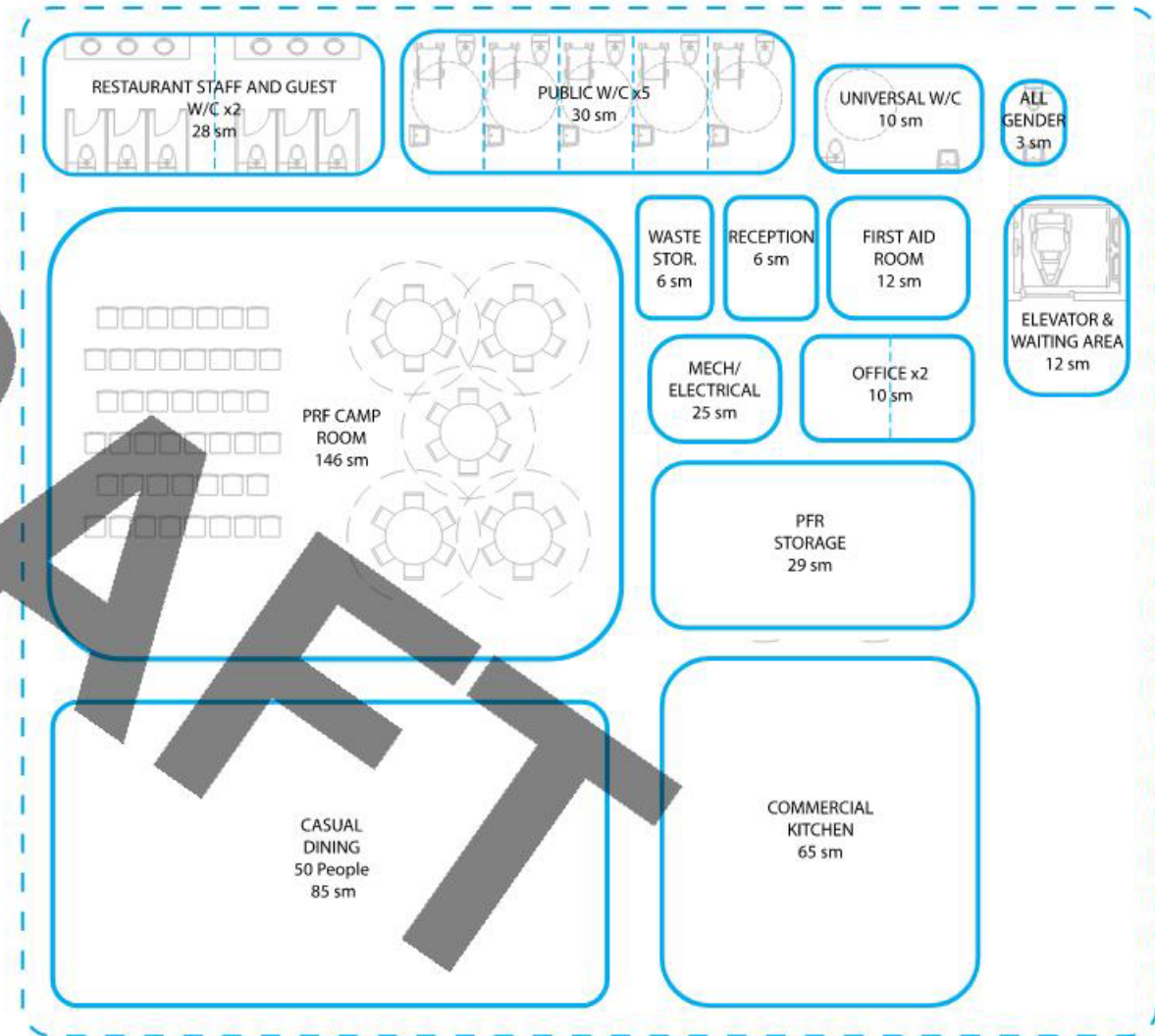

**DESIGN PROGRAM SIZE**  
550 sm

\* INCLUDES 20% GROSS UP



# Opportunities and Considerations



Information Center Archäopark Vogelherd, Ritter Jockisch Architects



Wildernesse Restaurant Pavilion, Morris + Company



Visitor Center at the Kyffhäuser-Denkmal Monument, Cobe



Ortello Visitor Center, De Zwarte Hond & Monadnock

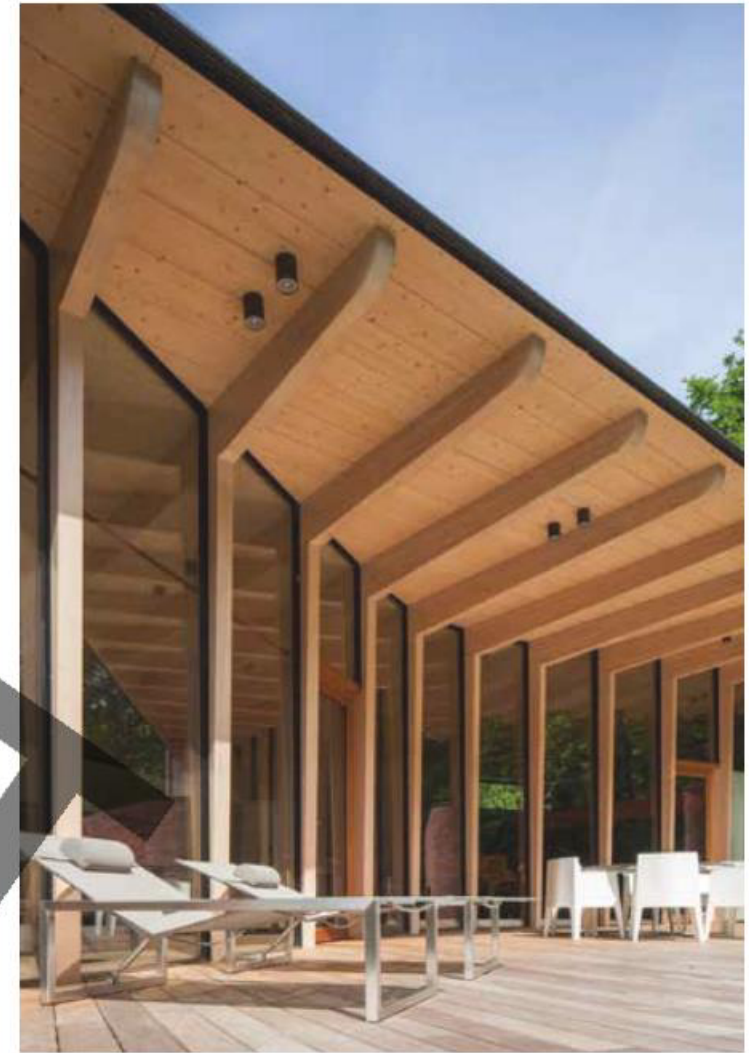

Boomerang House, DMOA



# Opportunities and Considerations

## PRIVACY



Triangle Toilets, Tokyo

## AMENITY



Sanchakou, China

## ROBUST MATERIALS



Assiniboine Park, Winnipeg



Triangle Toilets Plan, Tokyo



Tete d'Or Park, France



Concrete Toilet, Tokyo



# Ground and Plaza

- \* Point Of Service / Info
- ▶ Entry / Access
- GFA - 550sm

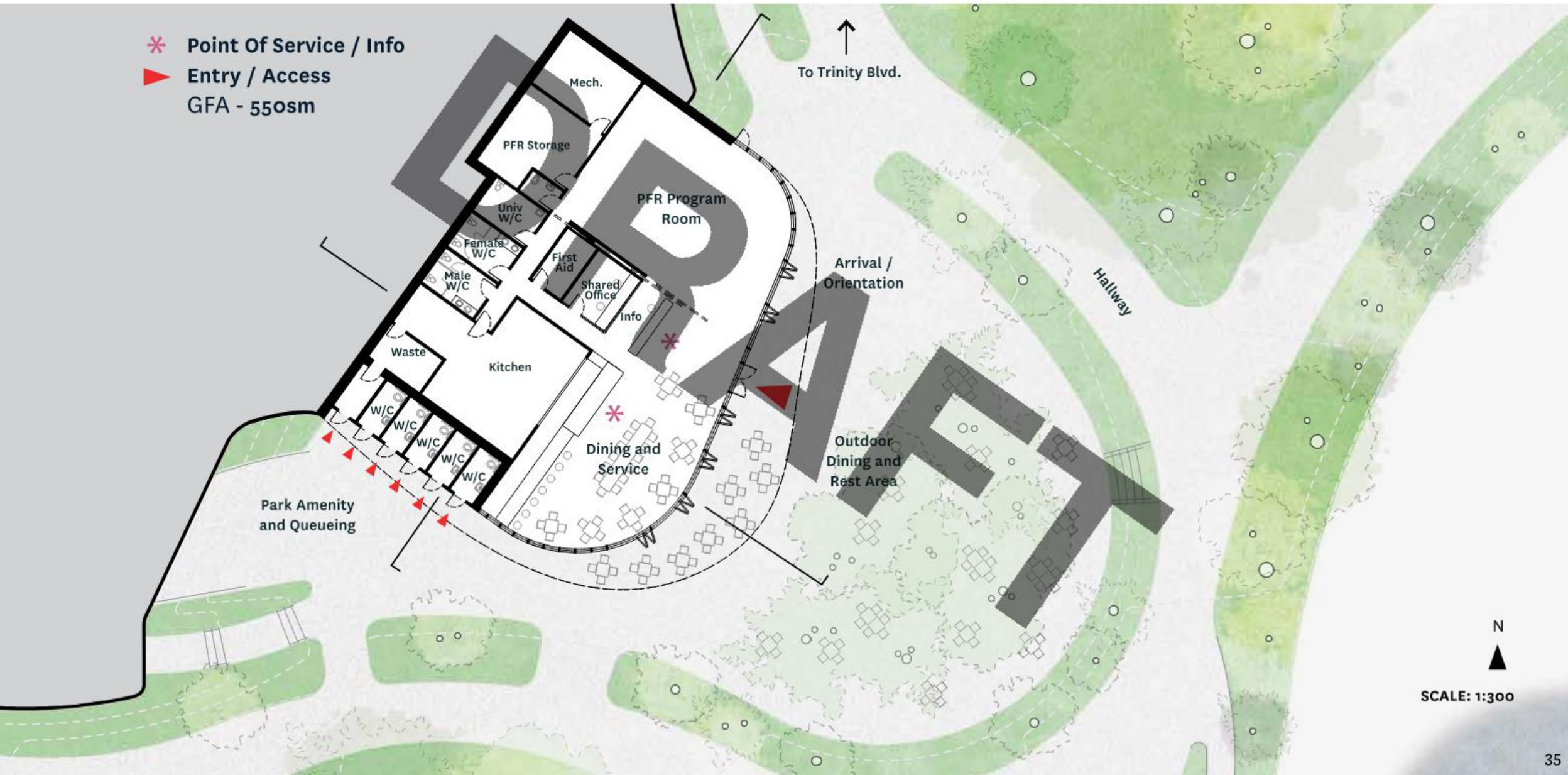

N  
SCALE: 1:300



# Program Relationship Diagram

- \* Point Of Service / Info
- ▶ Entry / Access
- GFA - 550sm

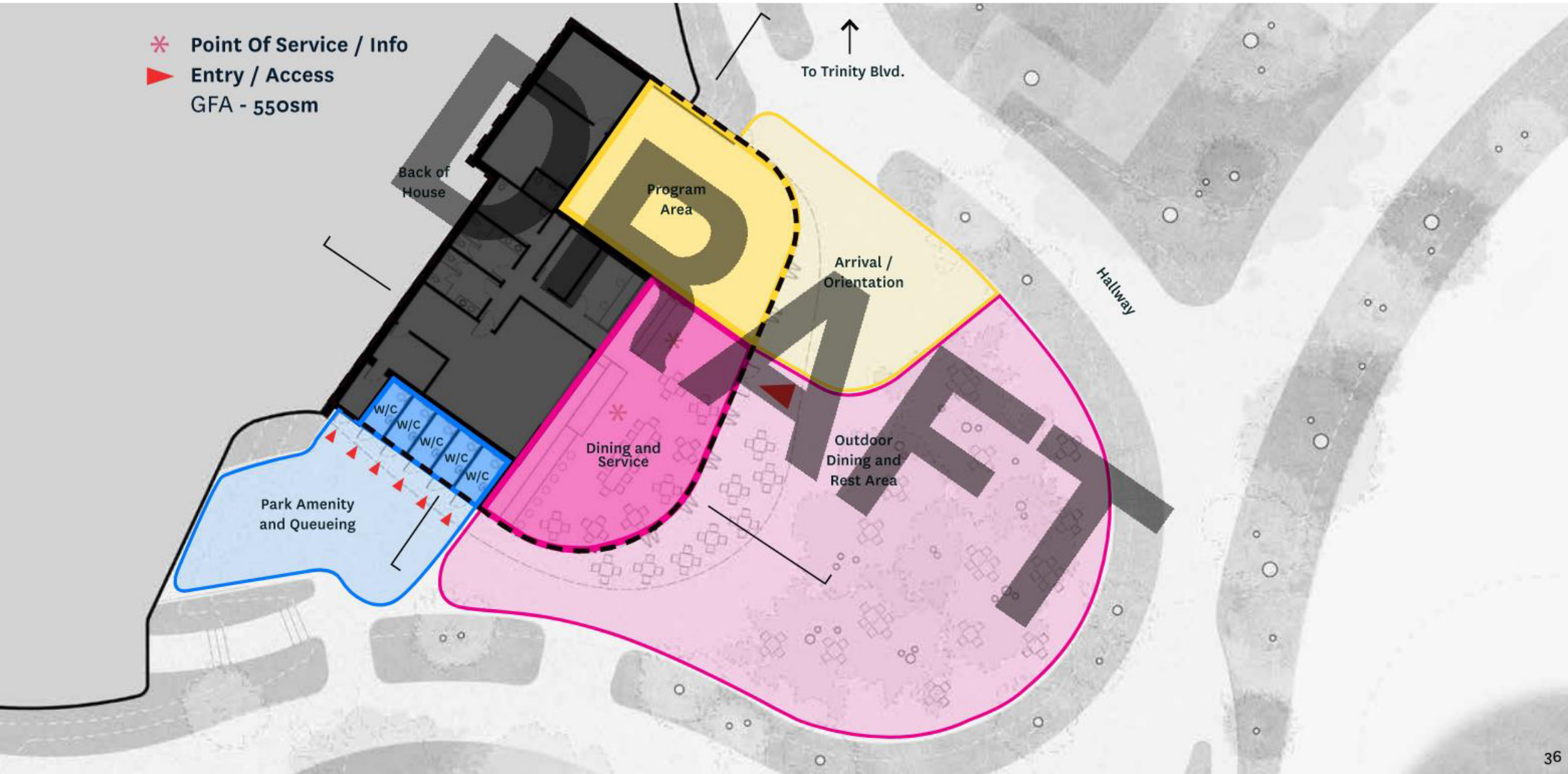



# Roof Plan





# North/South Site Section



SCALE: 1:300



## East/West Site Section



SCALE: 1:300



# Opportunities

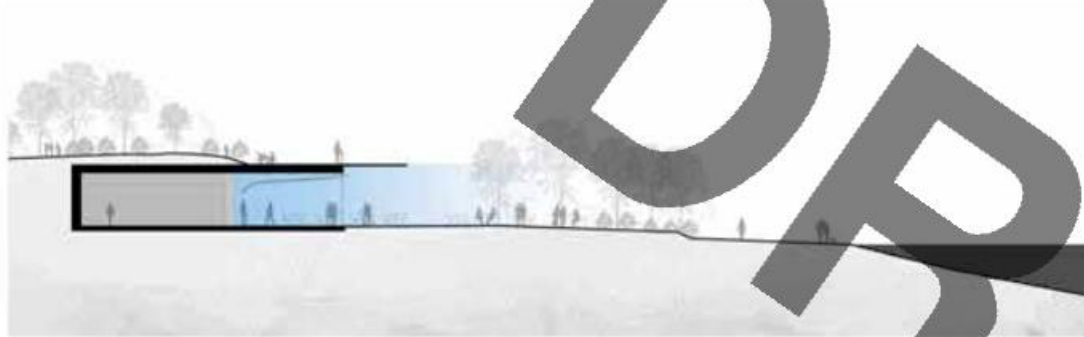

Landscape Integration

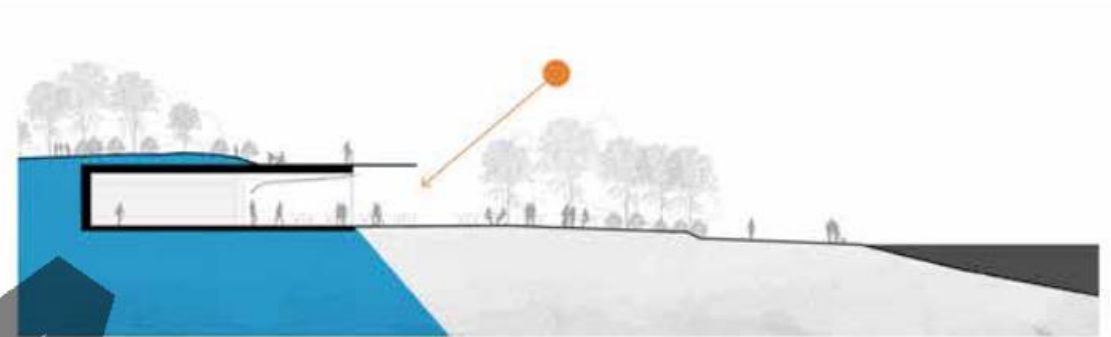

Passive Sustainability

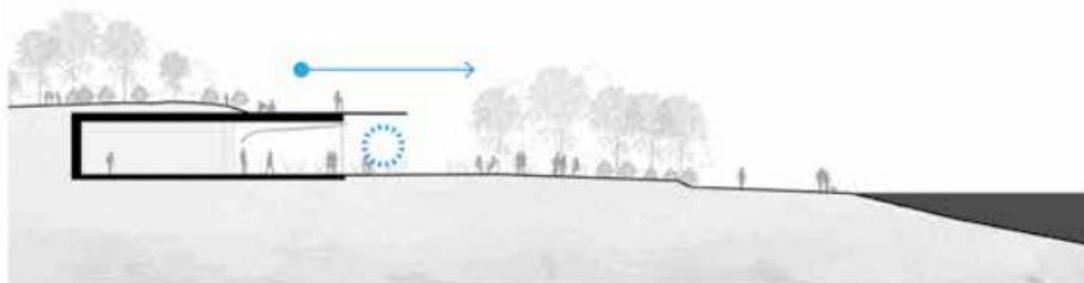

Experiences



Terracing



# Context



## Pavilion Overview

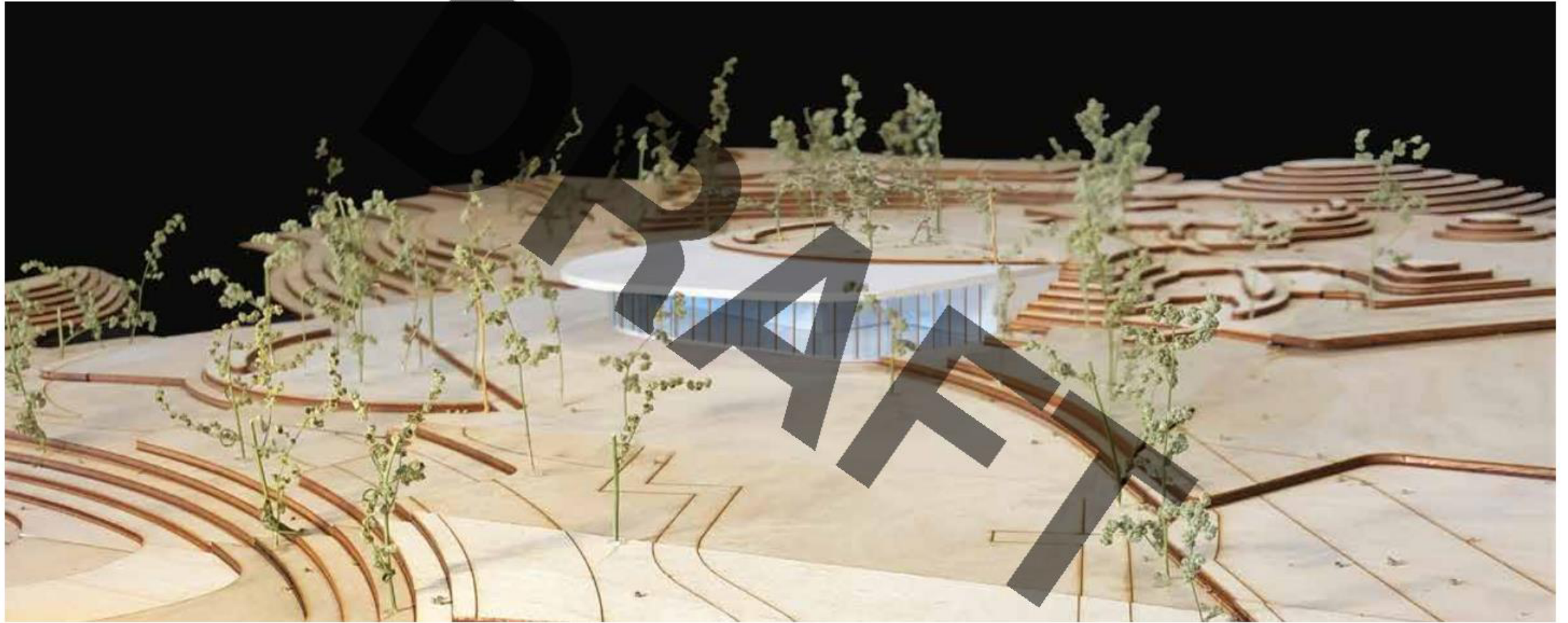



## View to Pavilion from Trinity Blvd.



## View to Pavilion from Winter Garden

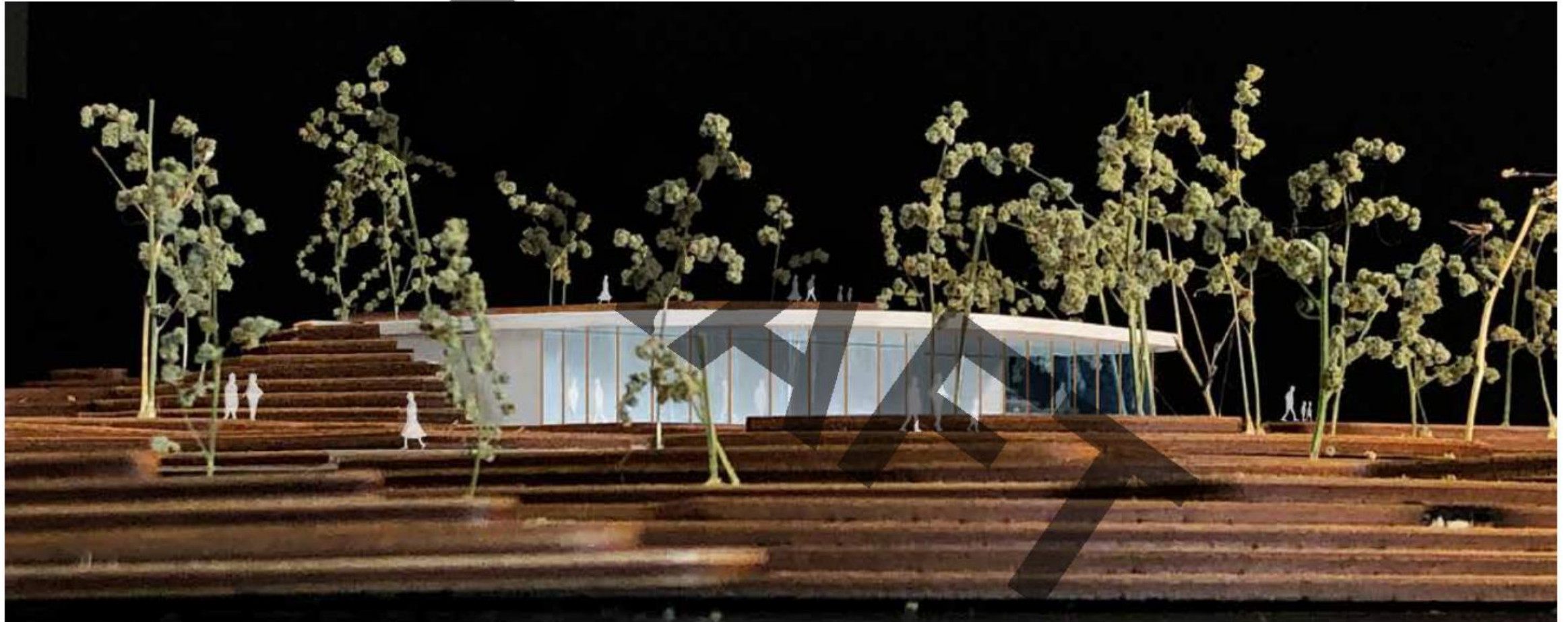



## View to Pavilion from Southwest



# Structural Exploration

Above Grade

Below Grade

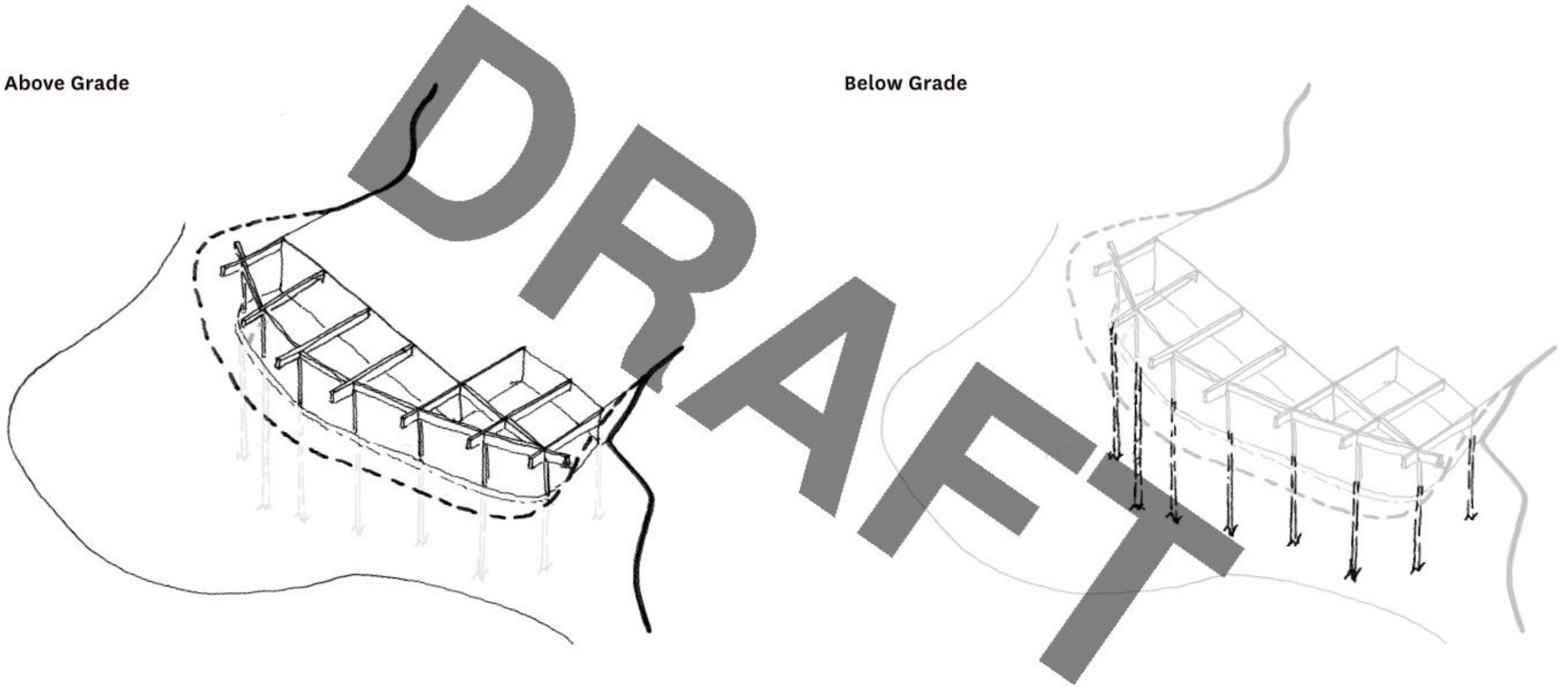



# Sustainability Strategy

## Material / Embodied Carbon

- By 2030, 70%-80% of all carbon from buildings will come from embodied materials, not energy use.
- Our goal is to realize a more fulsome climate-positive building by minimizing embodied carbon and maximizing carbon sequestering.



Concrete Mix Designs  
(SCM's, Type GUL, time, etc.)

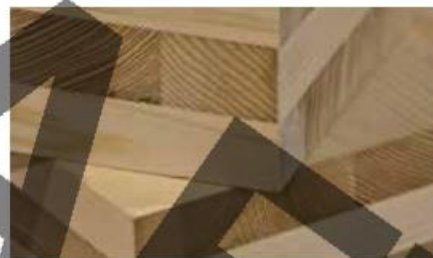

Heavy Timber Structure



Low Carbon Envelope

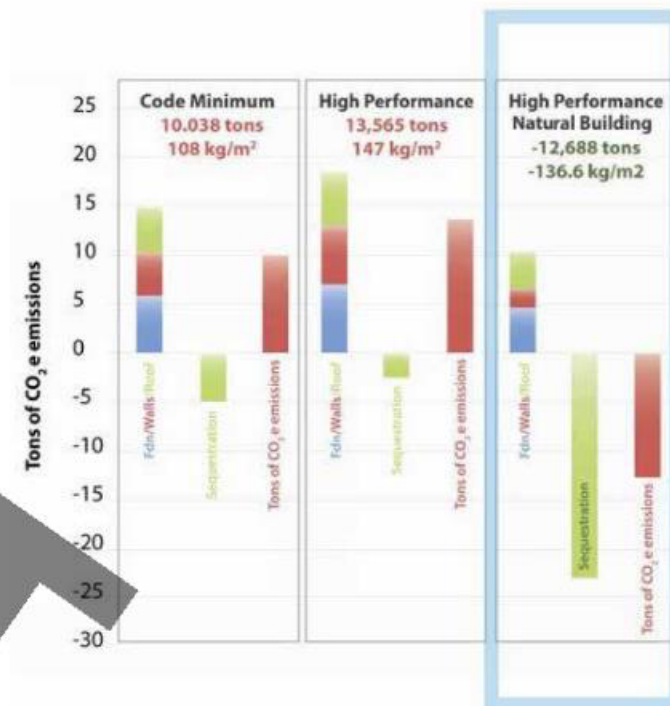

# Sustainability Strategy

## Energy / Operating Carbon

- near Passive House, All-Electric, Low Carbon
- Toronto Green Standard v.4 Tier 4
- WT Green Building Requirements V3 \*\*

\*\* Will have exception to WT Green Building Requirements, V3 EUI and TEDI targets due to outsize impact of kitchen.

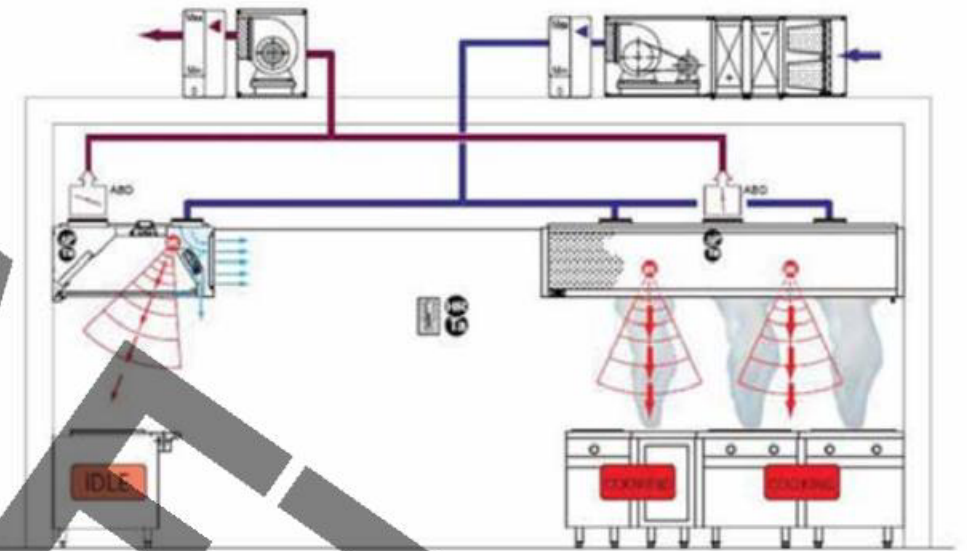

### Kitchen Strategies Exploration:

- High efficiency equipment including Induction Cooking
- Demand Controlled Ventilation with Heat Recovery using Ecologizer
- Compensating Exhaust Hood with Infrared Exhaust sensors



# Park Pavilion and Winter Garden - Full Vision Plan

