

SPECIAL QUEENS QUAY CONSTRUCTION NOTICE

Upcoming Track Work – Spadina and Queens Quay

Construction activities for the rebuild of the remaining two sections of the Spadina Loop will begin on May 3 with track delivery and installation scheduled throughout the month of May. The loop, which is located around the 410 Queens Quay condominiums at Lower Spadina Avenue, is an important piece of TTC infrastructure which allows both the 509 Harbourfront and 510 Spadina streetcars to reverse direction.

Crews have completed two major sections of the loop – the installation of streetcar track on Lower Spadina/Lake Shore (Section A) and the area within the inner loop (Section B). Overhead wiring is also well underway in those areas.

During the month of May, crews will rebuild the two remaining sections (Sections C and D) of the loop.

- Section D:** On May 3, crews will remove the existing asphalt roadway and begin excavating the new TTC trackbed. Crews will work a 24-hour shift (though the night) to complete these excavation activities. Crews will deliver and install the track for this section during the week of May 5.
- Section C:** On May 13, crews will remove the existing asphalt roadway and begin excavating the new TTC trackbed. Crews will work a 24-hour shift (though the night) to complete these excavation activities. Crews will deliver and install the track for this section during the week of May 20.

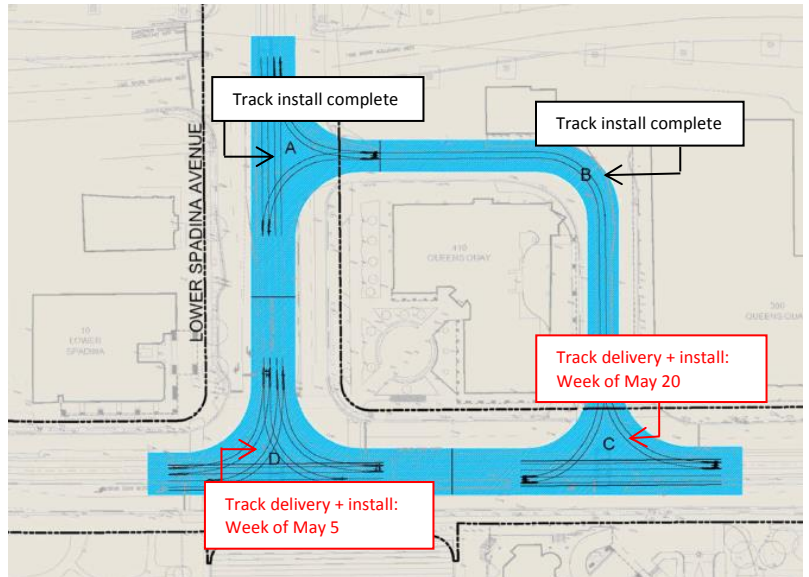

The last phase of work by the TTC at this intersection will be the installation of overhead wiring above the newly installed track. The resumption of streetcar service is targeted for August 31, 2014.

WHAT TO EXPECT

Motor Vehicles

Traffic Plan

Westbound traffic will be diverted along the south side of Queens Quay to avoid the track construction zone. There will be only one lane of traffic available which may result in some traffic slowdowns in the area. Lower Spadina will be closed to northbound traffic between Queens Quay and Lake Shore Blvd throughout this work because construction activities cross the Queens Quay/Spadina intersection. Northbound traffic will be diverted via Dan Leckie Way and Fort York Blvd. One lane of southbound traffic will be maintained on Lower Spadina Avenue.

Impacts Due to Rail Delivery

TTC crews will deliver rail during the **overnight night shift** on May 4/5 for the Spadina/Queens Quay intersection. The special curved rail panels will be delivered by large flatbed trucks between **midnight and 5am** to help mitigate traffic impacts. Paid-duty police officers and flagmen will be used to direct the deliveries however traffic may need to be held for up to 20 minutes in some areas on Queens Quay to enable the large vehicles to unload the specialized track. Overnight deliveries of rail panels will also be made on May 19/20 – and traffic impacts may occur between **midnight and 5am**.

TTC Bus Service

There will be no change to the current routing for the 509 Harbourfront or 510 Spadina bus service during this work.

Pedestrian Access

Pedestrian access will be maintained to all storefronts and residences in the construction area at all times. Diversions will be required as follows:

- **Queens Quay:** East/west pedestrian traffic will be maintained on the north side but a pedestrian diversion path will be implemented around the back of the 410 building. Pedestrians may also use the south side of Queens Quay but must cross at the signalized intersection at Rees or Lower Spadina.
- **Lower Spadina:** Pedestrian traffic on the east side will be required to divert around the construction zone or use the west side of Spadina.

Cyclists

- Access to the detour bike route – an asphalt trail located in the boulevard area on the south side of Lake Shore Blvd. between Lower Spadina Ave. and York St. – will be maintained.
- Slight diversions on Queens Quay and Lower Spadina Avenue may be required to bypass the construction zone.

LOCAL IMPACTS

Night/Weekend Work

Night work/weekend work will be required for all phases of this work including excavation, concrete work, rail delivery and installation. Given the size of the TTC rails, it is common practice for TTC crews to move the rails overnight. Crews are accompanied by Paid Duty Police Officers who help guide the crews through intersections and protect the public.

Residents of 410 Queens Quay

- The driveway and front entrance to the building will be maintained.
- Intermittent temporary closures of Queens Quay and the driveway area (of approximately 20 minutes in duration) may be required at times during overnight rail delivery and installation.
- If a temporary closure is required overnight, it will be coordinated in advance with the building's property management and special accommodations will be made for those wishing to enter or exit the garage between midnight and 5am.

Residents of Maple Leaf Quay/Shoppers Drug Mart Laneway

- The west driveway access at Shoppers Drug Mart will be closed starting April 28 but vehicles exiting Maple Leaf Quay will continue to have an exit from the west side of the building. Eastern Construction will extend the Maple Leaf Quay laneway west behind the 410 condominium allowing vehicles to exit onto Lower Spadina. This lane will be exit only – and it will only be available during this phase of construction. The east driveway entrance and exit to Maple Leaf Quay will not be impacted.
- There may be intermittent overnight traffic slowdowns (between midnight and 5am) when rail is delivered.

Residents of 401 Queens Quay

- The driveway and front entrance to the building will be maintained.
- There may be intermittent overnight traffic slowdowns (between midnight and 5am) when rail is delivered.

MORE INFO

Detailed information will be included in the weekly Queens Quay construction update. You may subscribe online at www.waterfrontoronto.ca/qqconstruction. Email info@waterfrontoronto.ca with questions or call the Queens Quay hotline 416-214-9990. For urgent construction issues, contact Robert Pasut - Eastern Construction Community Liaison Officer at RPasut@easternconstruction.com or 416-505-3073.